

THE FINIAL COMPANY™

Modern Metal Tiebacks Assembly Instructions

Modern Metal Tiebacks

Thank you for purchasing your new Modern Metal Tiebacks. With proper installation and care, they will provide you with many years of beauty and trouble-free use. Clean with a soft cloth. Do not use harsh or abrasive cleaning supplies or polishes which may damage the finish.

Parts Included:

- Tieback Base
- Tieback Base Cover
- Tieback Stem
- Tieback Finial Adapter
- Tieback Stem Extension (Sold Separately)

Tools and Hardware Needed:

- Wall Attachment Screws
- Drill or Screwdriver for Wall Attachment Screws
- Hollow Wall Anchors (if needed)



1. Attach the Tieback base to the wall. Use hollow wall anchors if not screwing directly into a wall stud.

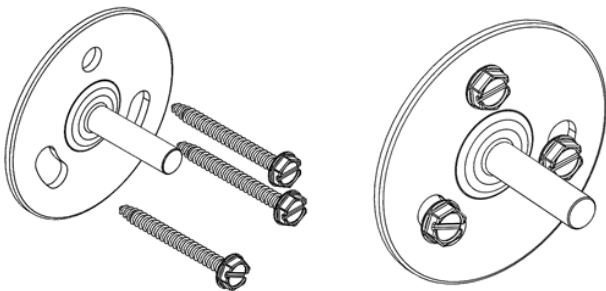

2. Screw the Tieback Finial Adapter onto the holdback stem.

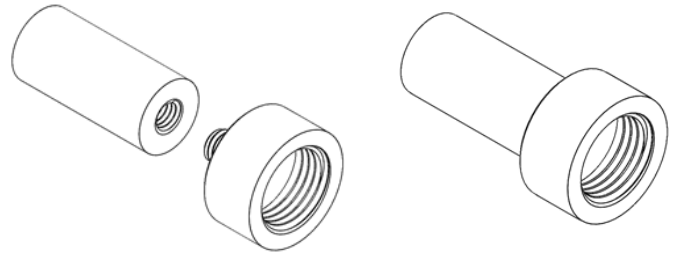

OPTIONAL: To add 2 inches of length to the Tieback stem. Screw the Tieback Stem Extension into the Tieback stem, and then screw the finial adapter into the stem extension.

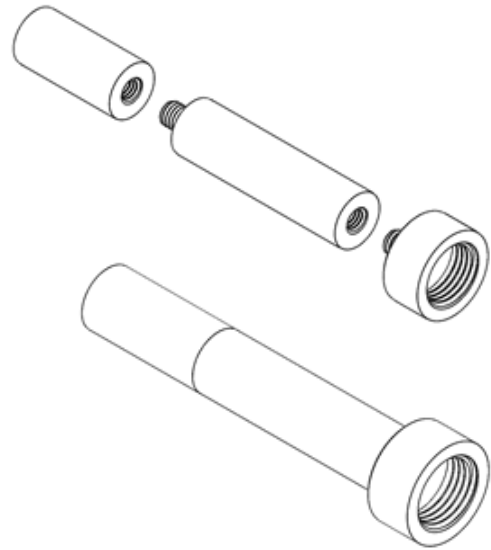

3. Place the base cover over the base and hold in place while screwing the stem assembly onto the base. Tighten to hand tight only. (Shown without the stem extension option).

