



230 Meek Rd  
Gastonia, NC USA 28056  
704-866-0650, FAX 704-868-9787

# Horizontal Blind Cutter Spring Instructions Updated 4/29/99

To determine the correct spring for installation please compare your tool to the diagrams below.

**Diagram A** demonstrates an **Old Style Spring** inserted straight into the tool and secured with an Allen set screw on top.

**Diagram B** demonstrates a **New Style Spring** with a **Tang** inserted into the tool from the side and secured with a round head Allen screw.

## Old Style Spring

Diagram A

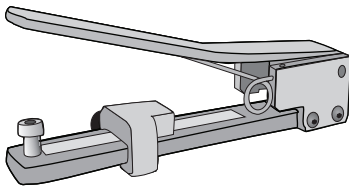
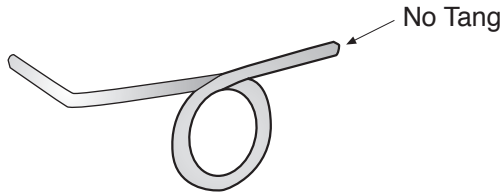

Spring Locking Screw

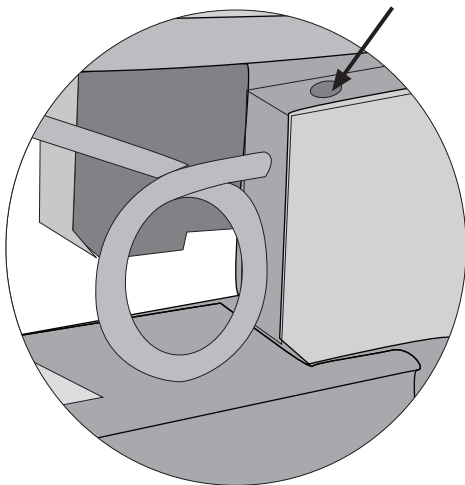

## New Style Spring

Diagram B

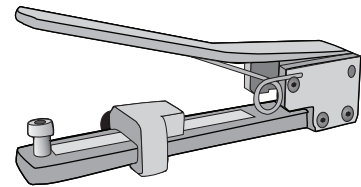
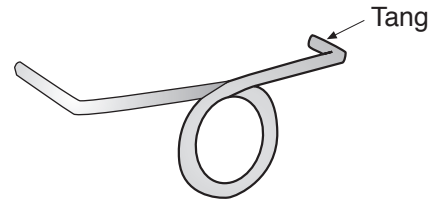

Spring Locking Screw

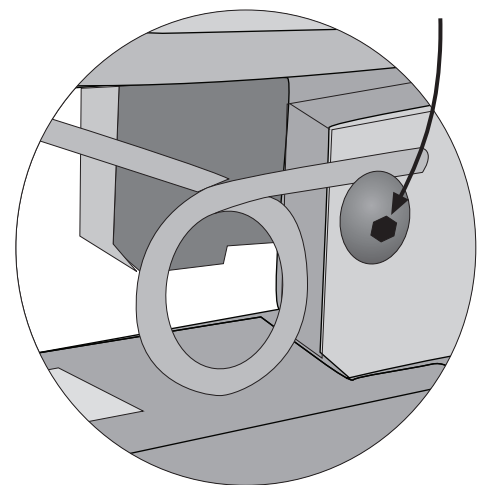

**Note:** A **New Style Spring** can be adapted to fit an **Old Style Spring** by grinding off the **Tang** to make it straight, as shown in the diagram below.

