

### Rowley project list: **Slip Cover for a Vanity Chair**

Enable your clients to pamper and primp in style by slip-covering an elegant vanity chair that complements their dressing table or vanity. This slip cover has romantic pleats falling through the skirt and added detail on the back closure for a truly custom look.

#### MATERIALS & SUPPLIES

##### Rowley Products

Glass Head Straight Pins

Scissors

Snap Tape, 2" Spacing

John James Hand Sewing Needles

A&E Upholstery Thread

Hanes Classic Napped Sateen Lining

Tape Measure, 120" Flat

Finestra® Decorative Buttons

Lining Scraps for Pattern Pieces

##### SKU

[TP49](#)

[CU22](#)

[ST30/N](#)

[TP118](#)

[TU6K/](#)

[LN48/](#)

[DT8](#)

[FN1230BT/](#)

#### SLIP COVER FOR A VANITY CHAIR: STEP-BY-STEP INSTRUCTIONS

This project guide covers the steps to fabricate a quick, pleated slip-cover with a back opening decorated with Finestra buttons. It is made to fit the existing chair so no measurements will be given.



#### Cutting and Prepping the Chair Pieces:

- 1 Measure existing chair for pieces or trace around areas to make a loose pattern.
- 2 Lay measurements out (or pattern out) on fabric and cut, adding at least 4" all the way around the needed amount.
- 3 Be sure to cut an Inside Back and a Seat.



- 4** For the Outside back, cut two pattern-matched pieces wide enough to fold into an inverted pleat at the center back.
- 5** Fold in pleat; mark and sew in join seam. Cut away any excess from join. Pin folds.

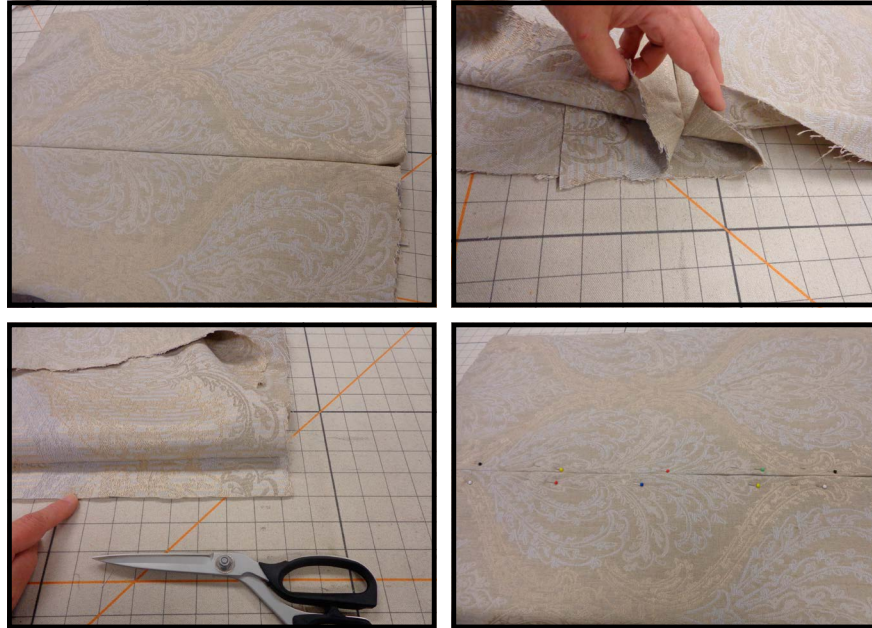

## Making the Slip Cover:

- 1** Place the Inside back and the Outside back, face in, on the chair, adjusting placement for pattern.
- 2** Pulling from both pieces, pin at joins.
- 3** On the Inside Back, cut relief cuts in the bottom where it meets the chair seat so it will lay flat.





- 4 Pin on the Seat. Remove from chair.
- 5 At the machine, sew on all pin lines to join the Inside back, Outside back and Seat.



## Making the Skirt:

- 1 Measure for amount needed both for height and width, plus hems and seam allowances.
- 2 Cut face fabric and lining.
- 3 Join fabric and lining at the bottom seam.
- 4 Iron the seam toward the fabric.
- 5 Fold up lining so a 2" bottom face fabric hem shows to the back.
- 6 Iron to set a crease.



- 7 Measure and mark for finished length; trim away any excess length.  
A. Optional: serge across top to hold all layers together.
- 8 Fold into pleats and pin well.



## Attaching the Skirt to the chair:

- 1 Place right side of Skirt to right side of Seat.
- 2 Pin, adjusting pleats as needed to cover sides, front and back.
  - A. Remember to leave the back pleat open so you can remove the skirt.
  - B. You will also need to remember to adjust the Seat corners so the fabric will fall over the side to the skirt – this may involve small pleats or small gathers.
- 3 Sew Skirt to Seat.



- 4 At the back opening, mark for snaps.
- 5 Sew on snaps.



## Adding Decorative Detail:

- 1 Sew Finestra® Decorative Button Embellishments to the back pleat opening, spacing as needed.

