

## Rowley project list: **Pleated Pillows**

The quickest way to add color to a room is by adding pillows. While adding welt around the outside is standard, why not kick it up a notch and add a second layer – a row of pleated fabric.

### MATERIALS & SUPPLIES

#### Rowley Products

Tapered Corner Pillow Template  
 Polyester Iron-On Batting  
 ¼" Polyester Welt Cord  
 Perfect Pleating Tape  
 Fringe Adhesive

#### SKU

[PF08](#)  
[PA20/](#)  
[WCP2/](#)  
[DYC85](#)  
[FA10](#)



### PLEATED PILLOWS: STEP-BY-STEP INSTRUCTIONS:

This project guide covers the steps to fabricate a welted and pleated pillow. These pillows finish at 17" square.

#### Cutting and Prepping the Face and Lining:

- 1 Cut the pillow face at 17", following the 17" marks on the tapered pillow template.
  - A. This template includes seam allowances already.
- 2 Cut the back from the front piece so they are the same size.
- 3 Iron on a layer of Iron-On Batting to the front and the back.



- 4 Cut and make enough welt cord to go around the pillow front, approximately 72".
- 5 Cut 4 strips at 54" x 3". These do not have to be cut on the bias.
- 6 Fold each strip in half, lengthwise and iron to set a crease. Fold in ends and iron.

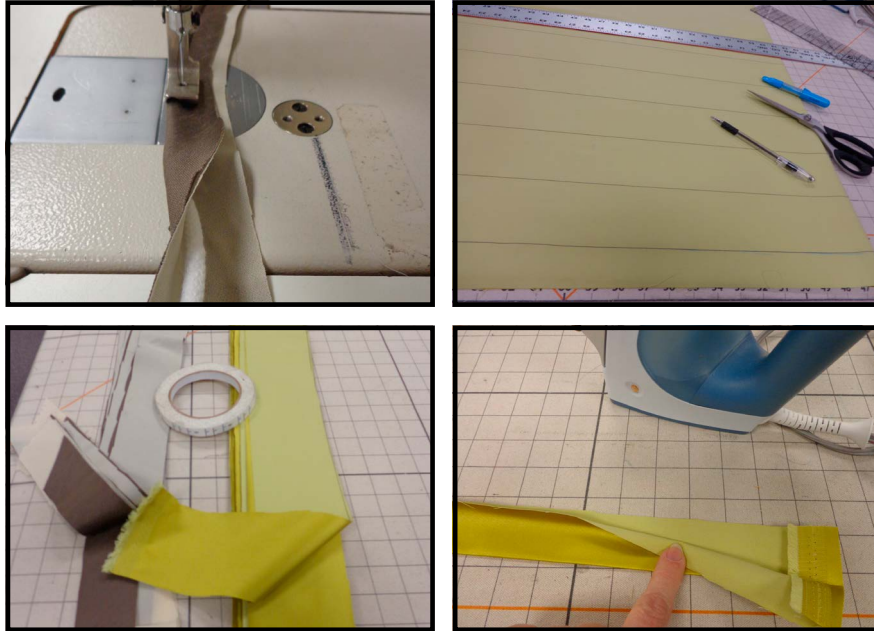

- 7 Decide on the pleating pattern you want to use and pleat each strip to 15", making sure the ends are turned under so no raw edges show.
  - A. Using the Perfect Pleating tape takes less time than and gives neat, even pleats.

- 8 Staple or sew, within the seam allowance to secure pleats.

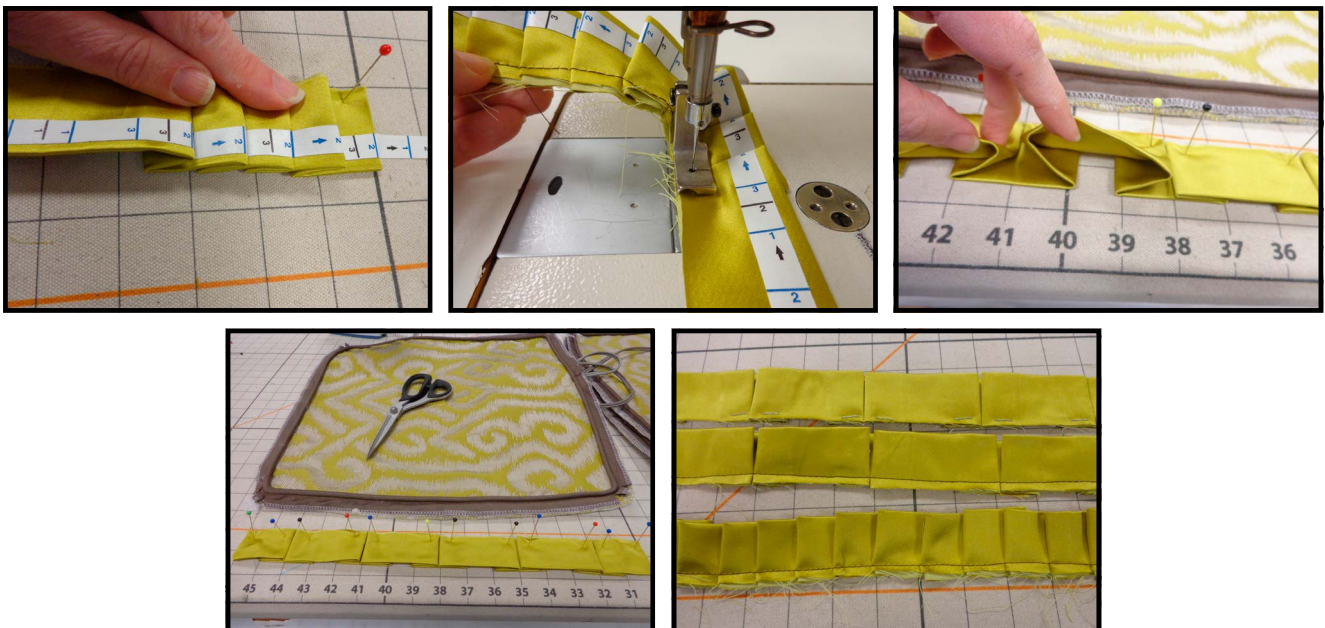

## Making the Pillow:

- 1 Glue-baste welt to the outside edges of the pillow, making the join at the bottom.
  - A. Join the welt at the table or at the machine.
- 2 Sew welt to pillow front.
- 3 On each side of the pillow, lay a pleated strip on top of the welt, face side down and pin.
- 4 Sew pleated strip to each side of the pillow.



- 5 Lay the prepared back on the front, right sides together and sew around edges, leaving a small opening for turning.
- 6 Turn right sides out and stuff.
- 7 Hand close.

