

Upholstered Headboard featuring Finestra® Decorative Hardware

This classic upholstered headboard design has been updated with hand-finished Finestra® Decorative Hardware and was created using many time-saving steps and products.

Materials and Supplies:

FirmaFlex™ - BP48/72Z

High Temperature Glue Gun and Sticks – DT50 and DT55

Upholstery Air Stapler - NSG10 and Staples NS33/E and NS35/E

Safety Glasses – SG01

Headboard Cleat - AG76

Polyester Upholstery Batting – PA50

Polyester Welt Cord 5/32" – WCPO/S or WCPO/L

Cardboard Tack Strip – CS38 or CS50

Gimp Trim – G20S or G22S

Lining, OutBlack® Lyte – LN32 or LN33

Finestra® Decorative Hardware – 3" smooth pole rod (split in half) with *Isabella* Finials in the *Tusk* finish.



Headboard Step-by-Step:

1. Unfold FirmaFlex™ and join scored seams together by adding hot glue or fringe adhesive in the join and stapling perpendicular to the seam. Photo 1.
2. Draw headboard shape and cut using a jig saw with a fine tooth wood cutting blade. Photo 2.
3. Cut matching frame pieces from Firmaflex™ 3" wide. Attach to the back of the headboard around all edges using hot melt glue and long staples. Photo 3. Add an additional support cut from FirmaFlex™ horizontally behind the top arch. Note: Wood can also be used.

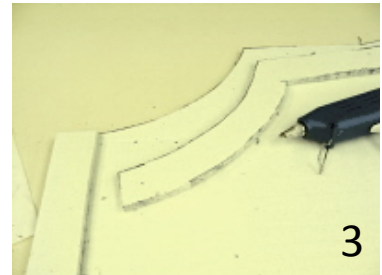
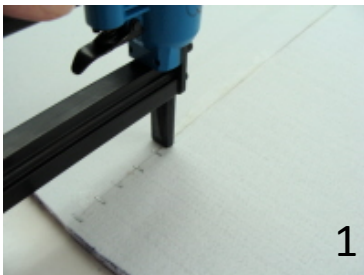

4. Add Headboard Cleat under horizontal support on the back of the headboard. Photo 4.
5. Reinforce the screws by adding small blocks of FirmaFlex™ on the headboard face with Hot Glue at each screw, providing more support and covering the ends of the screws. Photo 5.
6. Mark where each decorative pole will be placed on the face of the headboard. Cut 1" foam to fit each section between where the poles will be placed and staple around the edges for all sections. Photo 6.

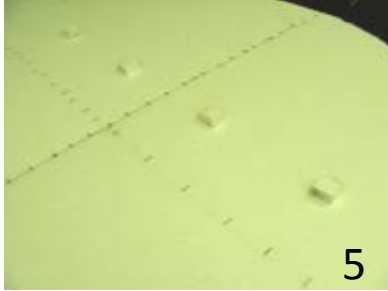

7. Cover each foam section with Upholstery Batting, wrapping around edges and trimming away excess batting at corners. Staple in place. Photo 7.
8. Place fabric over headboard. Photo 8. Note: If seaming fabric hide seams under decorative pole rods.
9. Pin fabric to headboard with push pins and turn over the headboard on the worktable. Photo 9. Staple along the bottom edge.

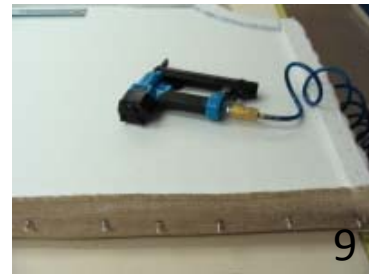

10. Continue stapling fabric to back, keeping fabric taut and smooth on the headboard face. Do not pull too tight. Photo 10. Add a row of staples down the center of each pole rod section.
11. After fabric has been stapled, attach hardware by screwing into the wooden pole rods from the reverse side of the headboard. Photo 11.
12. Cut bias strips 5" wide, seam together and cover welt cord by folding in an "S" shape, and tucking welt cord inside the fold and sew using a cording foot. Photo 12.



13. Staple welt cord around outer edge of the headboard using Cardboard Tack Strip. Photo 13.
14. Turn bias edge to reverse side and staple in place. Photo 14.
15. Cover reverse side with lining. Remove Headboard Cleat and smooth lining over back of headboard, marking where the Headboard Cleat is attached. Reattach Headboard Cleat after lining is in place. Trim lining 1" from the edges and staple in place along edge of lining. Photo 15.

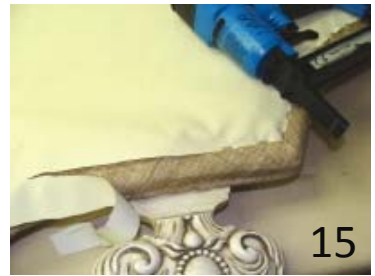
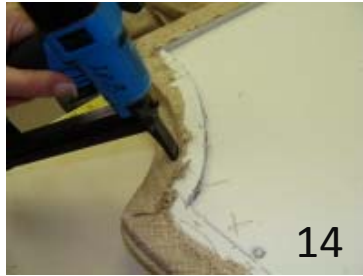

16. Apply gimp trim over staples using High Temperature Glue or Fringe Adhesive. Photo 16.
 17. Install opposite side of the Headboard Cleat to the wall securing into studs or by using anchors. Photo 17.
 18. Hang headboard on the wall by dropping the Headboard Cleat on the back of the headboard into the wall mounted portion of the Headboard Cleat. Photo 18.
- Note: Use one Headboard Cleat for Twin, Full or Queen Size headboard and two for King.

