

RTAHR16CV1W

16-channel LCD Remote Controller with Percent Closed Buttons

User Manual

1. PRODUCT DIAGRAM

Check remote diagram below to ensure you have the correct model.

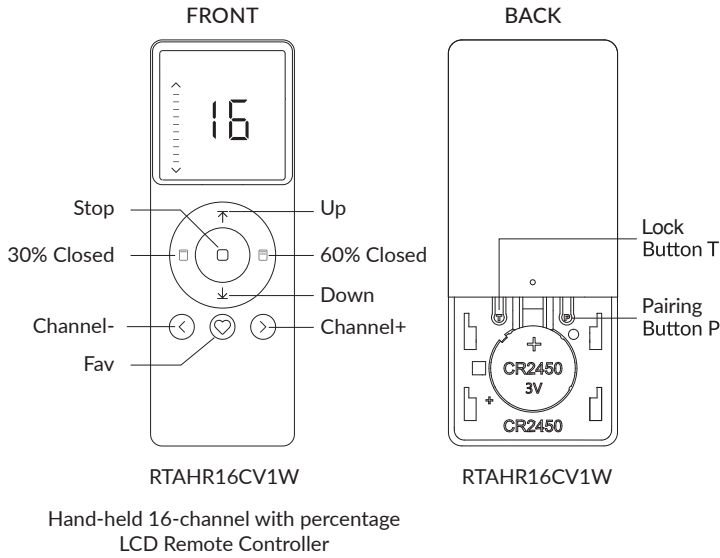

2. REMOTE SPECIFICATIONS

Battery Type	CR2450*3V*1
Work Temperature	14°-122°F
Radio Frequency	433.92M±100KHz
Transmit Distance	>=98.5' indoor

3. CAUTION

WARNING: Important safety and operation instructions to be read before installation and use.

1. This product is intended for indoor use only. Do not expose the remote to moisture or extreme temperatures.
2. If the remote becomes less responsive and has a shorter transmission range, please check whether the battery needs to be replaced.
3. Use or modification outside the scope of this instruction manual will void warranty.
4. When the battery voltage is too low, the orange LED will flicker during operation.
5. Please properly dispose of used batteries and replace with only the specified battery type.

⚠ WARNING

- **INGESTION HAZARD:** This product contains a button cell or coin battery
- **DEATH** or serious injury can occur if ingested.
- A swallowed button cell or coin battery can cause **Internal Chemical Burns** in as little as **2 hours**.
- **KEEP** new and used batteries **OUT OF REACH of CHILDREN**
- **Seek immediate medical attention** if a battery is suspected to be swallowed or inserted inside any part of the body.

4. INSTRUCTIONS

A. CHANNELS & GROUPS TOGGING

First select the desired channel to pair with your motor(s). Motors cannot be added to Groups yet. First, pair all motors to Channels only.

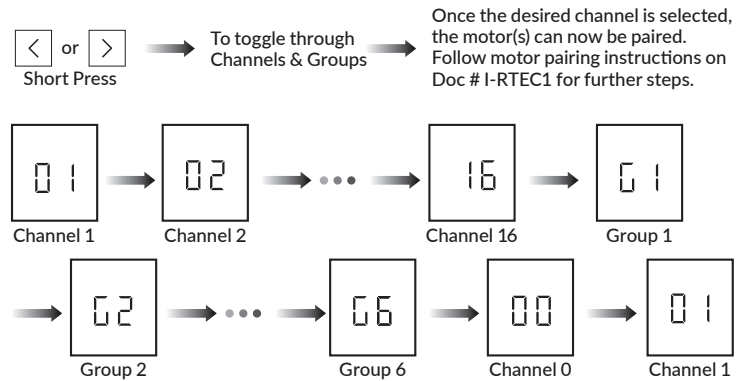

Note: A maximum of 15 motors can be added to one channel. All motors added to the same channel will operate simultaneously. Channel 0 is the group control for all the channels.

Follow the motor pairing instructions on Doc # I-RTEC1 first before completing the following steps below:

B. HIDE UNUSED CHANNELS

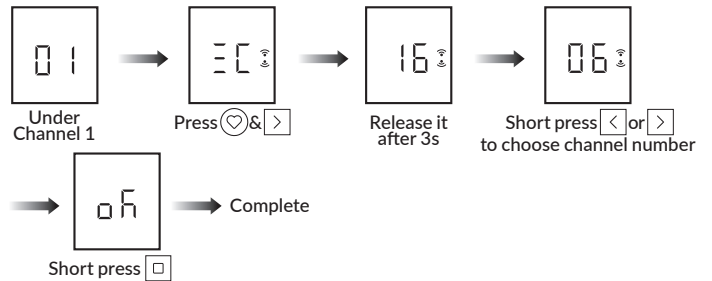

NOTE: Max&Min number is 16&1 when it's set under channel 1-16.

16-channel LCD Remote Controller

User Manual

C. REMOVE CHANNEL IN GROUP SETTING

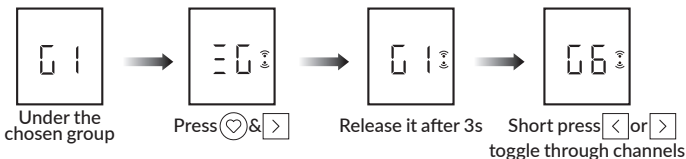

All channels are automatically added to the group. Short press [P] to remove channels, channel will start flashing once removed. To add the channel back short press [P] again, channel will now become steady lit when added.

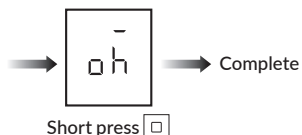

Note: Channel in groups setting is under GROUP 1-6.

D. HIDE UNUSED GROUPS

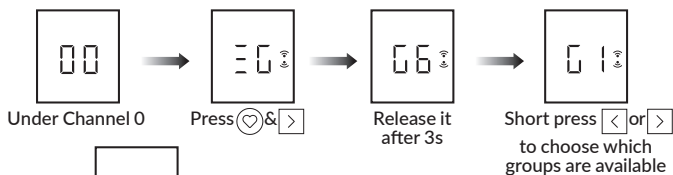

Short press [P] to select visible groups. All other groups will be hidden.

Note: Max&Min number is 6&0 when it's set under channel 0

E. CHECK THE CHANNELS IN GROUPS

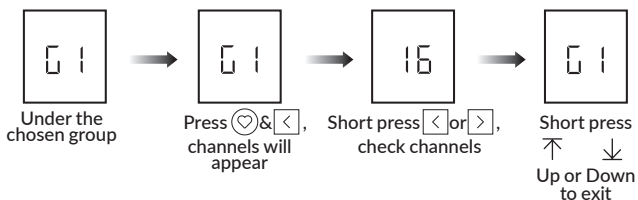

Note: LCD will show "EC" if there is no channel in group.

F. POSITION PERCENT SETTING

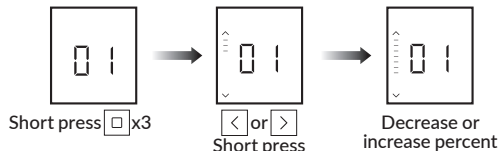

Stop on the desired percentage down and wait 3s. The shades will move to the chosen percentage down position.

Note: All the shades under same channel or group will run to same position after percentage setting.

G. LOCK REMOTE

Locking the Remote: Prohibits any programming or settings from being changed on the Remote.

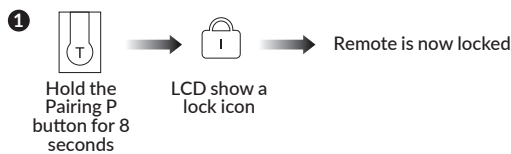

2 To unlock the remote and allow programming once again, repeat the steps above. The Lock icon will disappear.

H. FOR OTHER OPERATIONS, PLEASE REFER TO THE MOTOR OPERATION INSTRUCTION ON DOC# I-RTEC1.