

DECEMBER 2025

REFERENCE GUIDE



ELEMENTS®
— SHADE COLLECTION —

OUR STORY

ELEMENTS® — SHADE COLLECTION —

As an independently owned US company established in 1962, Rowley has played a significant role in supporting drapery and upholstery workrooms, installers, designers, and retailers for over 60 years. Throughout our growth and evolution, we have maintained a steadfast commitment to providing excellent customer service and exceeding customer expectations.

The Elements Custom Shade Collection by Rowley is assembled in our state-of-the-art manufacturing facility located in Dallas, TX and offers a level of personalization and flexibility that allows customers to create window treatments that perfectly match their unique style preferences, design requirements, and functional needs.

Our leadership team brings a wealth of experience to the table, with 50+ years of collective expertise across all facets of the industry including manufacturing, product development, marketing, sales, and operations. Our extensive experience in the window covering industry positioned us to enter the custom shades market by leveraging our expertise, swift turnaround, dependable service & personalized customization options.

We promise to deliver on the premise that Rowley was founded on, as the go-to resource for all our customers' window covering needs, empowering you to better serve your clients and grow your business.

Sincerely,
Your Rowley Team



TABLE OF CONTENTS

Best For Kids	5
Measuring Instructions	6-8
Depth Requirements	9-10
Terms and Conditions, Freight	11-15
Motor Warranty	16-17

MOTORIZATION

Why Motorization	19
Motor Brand Options.....	19
FAQ	20
Key Terms and Descriptions.....	21
Lithium Ion Rechargeable Motorization	22
Bond Bridge Pro.....	23
Solar Panel Battery Charger.....	24
RTEC Automation by Rowley	25
Available Components	26
Motor Comparison Charts	27-28
Automate by Rollease	29
Motor Comparison.....	30
DC Wired Motorization.....	31
Automate Hub	32
Available Components	33
DC Power Distribution Panel.....	34
Distribution Panel Power Specs.....	35
Motor Comparison Charts	36-38

ROLLER SOLAR SHADES

Product Characteristics	40-41
Product Specifications	
Motorized Shades.....	42
Product Specifications	
Non-Motorized Shades.....	43
Product Specifications.....	44-45
Operating Options	46
Design Options.....	47
Side Channels.....	48-49
Privacy Strips	50
Specifications by Fabric or Screen	51-52
Specifications by Tube Size	
and Top Treatment	53-54
Product Components.....	55-58

TWINLIGHT

Product Specifications	60
Operating Options	61
Design Options.....	62
Product Components.....	63

DECORATIVE TEXTILE FILM

Product Specifications	65
Installation Instructions.....	66-67

CELLULAR SHADES

Product Specifications	69
Operating Options	70
Fabric Width, Rail Coordination Chart,	
Price Group	71-75
Stack Chart.....	75
Product Components.....	76-77

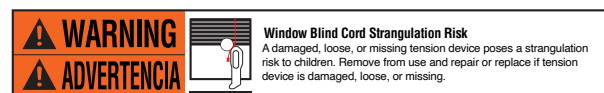

The window coverings industry uses warning tags, labels and other methods to communicate the potential hazard of corded window coverings. Pay attention to these warnings.

For example, the warning shown here communicates the critical message about cords being a potential strangulation hazard and suggests selecting a cordless alternative. Along with the Window Covering Safety Council, we strongly encourage you to install only cordless window coverings in homes where children play and sleep need to add warning notification and label.



BEST FOR KIDS



The Window covering Manufacturers Association (WCMA) has introduced the industry's first third party certification program designed to help consumers and retailers identify window covering products that are best suited for use in homes with young children. The new Best for Kids™ program will require the manufactures who want to be part of the program meet stringent criteria, and submit those appropriate products to Bureau Veritas, a third-party testing laboratory recognized by WCMA.

THESE PRODUCTS ARE CERTIFIED BEST FOR KIDS™

ROLLER/SOLAR SHADES

- Cordless Lift
- Motorized Shades

TWINLIGHT SHADES

- Motorized Shades

CELLULAR SHADES

- Cordless Lift (including TD/BU)
- Motorized Shades



MEASURE INSTRUCTIONS

INSIDE MOUNT

Please use a steel tape measure to ensure the proper measurements. Measure to the nearest eighth of an inch (1/8"). Measure each window individually even if they look the same. Always measure and record the width first, then height. Reversing the width measurement for the height measurement is the most common ordering mistake.

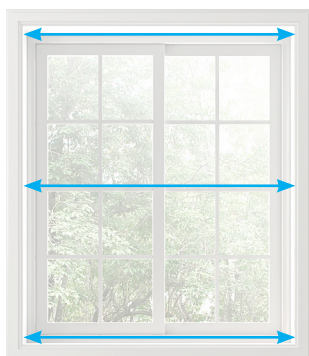

Step 1

MEASURE THE INSIDE

WIDTH of the opening at the top, middle, and bottom of window. Use the narrowest measurement when ordering.

ROLLER SHADES

Measure the exact width of the opening where the roller shade will be installed, to the nearest 1/8". Use this measurement when ordering.

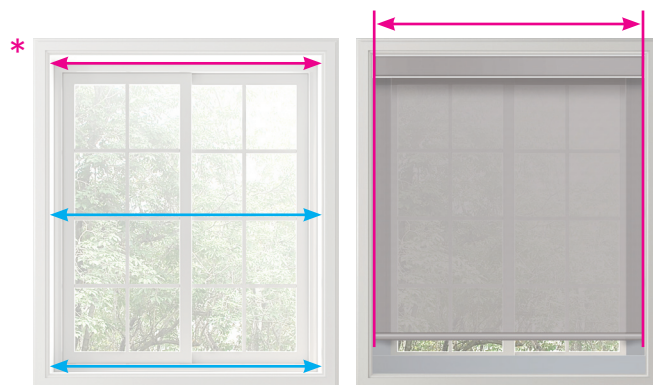

***PLEASE NOTE:** For Roller Shades, measure width where the shade will be installed. Inside mount measurements represent the exact window opening, do not add or subtract from your measurements. The factory will make the standard deductions to ensure a proper fit based on the measurements provided.

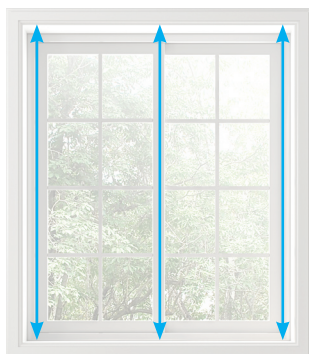

Step 2

MEASURE HEIGHT of opening on left, center, and right. In most cases, you will use the largest measurement when ordering.

Wall-to-wall or ceiling-to-floor measurements should be treated as an inside mount measurement.

MINIMUM DEPTH

You will need this much unobstructed depth, including cranks, handles, locks, etc., to inside mount the window treatment. Depth requirements for all products can be found on **pages 8-10**.



Extra Step

MEASURE THE WINDOW ON THE DIAGONAL.

If the two diagonal dimensions are not exactly the same, it may be more appropriate to specify an outside mount shade for optimal light control and privacy. Outside mount is recommended for windows greater than 1/2" out of square. Measure the top of the window opening front to back to verify depth variances.

FLUSH MOUNT

The Headrail or Top Treatment will be mounted flush with the surface of the wall or casement.

Flush Mount requirements can be found on **page 10**.

MEASURE INSTRUCTIONS

OUTSIDE MOUNT

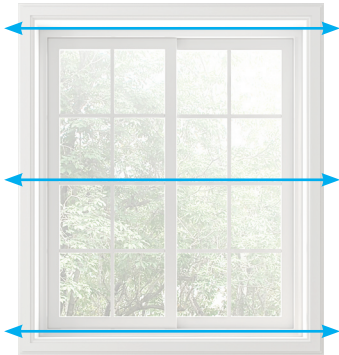

Step 1

MEASURE THE WIDTH of the area you wish to cover. Measure across the top, center and bottom of the window. Use the largest measurement when ordering. We recommend adding overlap to reduce light leakage around the blind.

ROLLER SHADES

Finished roller shade sizes are based on tip-to-tip measurements. When ordering an outside mount shade, determine the width you desire the fabric to be and add for the tip-to-tip measurement. See Roller and Solar Shades section for additional information.



Step 2

Decide if the headrail will be installed on or above the window molding. You will need a flat surface area. Measure the height of the area you wish to cover and provide exact dimensions.



PLEASE NOTE:

Outside Mount (OM) measurements represent the exact blind size needed. No allowances will be made by the factory.

MINIMUM MOUNTING SURFACE

You will need this much unobstructed flat space to outside mount the window treatment. OM flat mounting surface requirements can be found on **pages 8-10**.

FLUSH MOUNT

The headrail or top treatment will be mounted flush with the surface of the wall casement. Flush mount requirements can be found on **page 10**.

ELEMENTS® SHADE COLLECTION

PRODUCT	OM WIDTH AND HEIGHT ALLOWANCE	IM WIDTH AND HEIGHT DEDUCTION	RECOMMENDED OVERLAP WIDTH	RECOMMENDED OVERLAP HEIGHT
Roller Shades (1 1/2" Tube)	None	+1/8"	1 1/2" each side or 3" total	2"
Twinlight	None	1/8" headrail unit	2"	3"
Cellular Shades (Headrail)	None	3/8"	1 1/2"	1 1/2"



DEPTH REQUIREMENTS

Roller/Solar Shades

SHADE TYPE	MIN DEPTH	INSIDE FLUSH MOUNT	OUTSIDE MOUNTING SURFACE
------------	-----------	-----------------------	--------------------------------

CORDLESS LIFT

	1 1/2"	up to 3" (varies by pattern)	2"
--	--------	---------------------------------	----

OPEN ROLL CLUTCH

	1/2" side 1 1/2" back, top or ceiling	2 3/8"	1 5/8"
	5/8" side 1 1/2" back, top or ceiling	2 5/8"	2 1/2"
	5/8" side 2 5/8" back, top or ceiling	3"	2 1/2"

SHADES WITH CASSETTES

Cassette 100	1 1/8"	3 7/8"	1 1/2"
Cassette 110	1 1/8"	3 7/8"	1 1/2"
Cassette 120	1 1/4"	4 1/4"	2 3/8"

SHADES WITH FASCIA

3" Square Fascia	7/8"	3 3/4"	3 1/8"
4" Square Fascia	7/8"	4 1/4"	4 1/8"
5" Square Fascia	4"	5 1/4"	4"

DUAL SHADE WITH 5" FASCIA

up to 132"	4"	5 1/4"	4"
4" Deco Valance	2"	3 1/2"	+1" returns 3 5/8"
4" Fabric Wrapped Deco	2"	3 3/4"	+1" returns 3 5/8"

DEPTH REQUIREMENTS

Cellular Shades

PRODUCT	MINIMUM DEPTH REQUIREMENT	FLUSH DEPTH REQUIREMENT	OM MINIMUM MOUNTING SURFACE HEIGHT
Cellular Shades	7/8"	2 ³ / ₈ "	1 ⁵ / ₈ "
Top Down / Bottom Up	7/8"	2 ³ / ₈ "	1 ⁵ / ₈ "
Motorized	7/8"	2 ³ / ₈ "	1 ⁵ / ₈ "

Twinlight Shades

PRODUCT	MINIMUM DEPTH REQUIREMENT	FLUSH DEPTH REQUIREMENT	OM MINIMUM MOUNTING SURFACE HEIGHT
Cassette 100	1 ¹ / ₈ "	3 ⁷ / ₈ "	1 ¹ / ₂ "
Cassette 120	1 ¹ / ₄ "	4 ¹ / ₄ "	2 ³ / ₈ "

TERMS AND CONDITIONS

ORDER PROCESS

We encourage all dealers to place orders through our Dealer Portal for the most accurate and efficient processing. You can access the portal here:

rowleyshades.com/dealerportal

Orders are also accepted by phone or email, and all such orders are considered the dealer's responsibility. Phone orders are recorded to help ensure accuracy; however, it remains the customer's responsibility to verify the correctness of the information provided.

Once an order has been submitted and confirmed, Rowley cannot be held responsible for duplicate orders submitted via phone or email that are not clearly marked as "Do Not Duplicate."

If you have any questions or need assistance, please contact us at:

CUSTOMER SERVICE: (833) 743-1314

EMAIL: shades@rowleycompany.com

Sales Quote vs Sales Order

When a quote is placed, a "Quote Confirmation" is sent via email. You must contact Customer Service to process your orders. It will not be placed into production until you have received a sales order confirmation.

Please Note

All requests for orders receive a quote confirmation to review for accuracy and approval. All quotes require approval from an authorized purchaser to convert into an order. Please email or call customer service to process your orders.

ORDER COMPLETION DATES

All orders are assigned an estimated completion date at the time of order. This is automatically calculated based on current production schedule and may be subject to change. Please be aware that any orders currently under credit review may experience delays depending on the account, status.

Product Specification may change or be updated.

Although we attempt to notify customers in advance of any product specification changes, the product information contained in the Reference Guide are subject to change without notice.

Backorders

From time to time our suppliers are unable to ship the necessary materials or provide specific ship dates to fulfill your order.

We will provide backorder notification as quickly as possible so you may re-select or notify your customer of any delays.

Color Consistency

To ensure color consistency, all shades must be ordered at the same time. This will eliminate possible dye lot variations. The availability of colors and styles is subject to change without notice.

TERMS AND CONDITIONS

CHANGES AND CANCELLATIONS

Our products are custom made to your specifications and may not be cancelled if the order is in the process of fabrication. If changes or cancellation are required, please contact Customer Service immediately. They will advise if the order can be changed or cancelled.

Missing Parts

In the event you have missing or damaged parts, please contact customer service at **833-743-1314** with the sales order number or line number.

CARE AND CLEANING

Due to the differences in ultrasonic cleaning methods, we cannot recommend this method of cleaning. Do NOT use strong detergents or spot removers. Dry cleaning is not recommended and is not covered by the warranty. Do NOT fully immerse blinds or shades. Most fabrics are inherently anti-static and repel dust. Periodic feather dusting or vacuuming with a soft brush attachment and low suction will keep your shades clean and fresh. Spills or stains can be lightly blotted with a damp cloth and water. Take care not to crease the fabric.

Cellular Shades & Twilight Shades

Vacuum in a sweeping motion side-to-side parallel with the cells.

Roller Shades/Solar Shades

Solar screen fabrics may be cleaned using a mild detergent. Do NOT use solvent based cleaners. Allow fabric to dry completely before raising the shade.

Decorative Textile Film

Remove excess liquids using an absorbent cloth and/or carefully scrape away hardened particles. Remove grease-free stains using a lukewarm microfiber cloth. Remove grease stains using a solvent-free stain remover. Solvents should not be used, as they reduce the strength of the glue.

REMAKES AND REPAIRS

Remakes and Return Authorizations

Should you experience a problem with any product, please call Customer Service. No-charge remakes will be processed due to factory error, product quality, or shipping damage issues. All no-charge remakes are entered under your account, you will find them in your account history. You will receive an order confirmation and a shipping notice, and you will be able to check status on the remake order by calling customer service at 833-743-1314. No-charge remake orders can be initiated with anyone in customer service. You can help speed up the remake process by supplying pictures of quality issues or damage. Our goal is to prevent repeating the error and a good picture will tell us what the issue is and eliminate the need for blinds to be returned.

In certain instances, a new order may be placed, and an RMA number will be assigned. You will be invoiced for the replacement order, and a credit will be issued upon return and inspection of the product. We will send return labels if required.

TERMS AND CONDITIONS

Product must be returned within 30 days. Please be sure that any blinds returned to Rowley Company are properly packaged to prevent soiling or damage while in transit.

Damage incurred during shipping must be reported within 30 days or credit will be denied.

MUST CONTACT CUSTOMER SERVICE FOR AUTHORIZATION NUMBER AND REPAIR LABEL

STEP 1 Clean product to return for repair.

Do not send brackets, keep them installed, or any separate valances for, roller shades. Blinds or shades soiled with hazardous materials will be refused and returned, at your expense, with no repairs made. Hazardous materials include mold, animal/human waste/debris, nicotine tar, or other toxic chemicals. If the product is simply dusty, please use a feather duster or vacuum upholstery brush.

STEP 2 Use a corrugated box to return all products.

Choose a box size and strength suitable for the contents you are shipping. If the original box is not available, you may consider having your product boxed at a local packaging store. **IMPORTANT!** Box cannot exceed 90" in length and 12" x 12" in girth.

STEP 3 Do not over pack your box with too many blinds.

If you reuse the box, make sure it is free of holes and damages. Remove old shipping labels and use packing material to fill unused spaces in the box.

Properly protect the product being returned

Use bubble wrap to protect each item, wrap separately. Newspaper or colored paper should not be used as they will soil the product. Raise the blind or shade if possible and secure the cords with a rubber band.

Do not wrap the cords around the product as this will damage the product. If the blind or shade cannot be raised and secured - please contact customer service for instructions.

STEP 4 Securely fasten repair label with order number to the box.

Take box to local shipping store of your choice. For any questions or concerns, please contact customer service.

FREIGHT DAMAGE

INSPECT IMMEDIATELY! BEFORE SIGNING FOR MERCHANDISE

Visible Damage

Please receive the shipment but note damages on the freight bill.

It is recommended that you receive the shipment as opposed to refusing it. It is YOUR responsibility to note the damage on all copies of freight bill. Freight Bill must be signed by both the driver and consignee.

Concealed Damage

- Pictures of damaged goods are required
- Keep carton and packaging materials
- Call carrier within 7 days of delivery & request inspection
- Do not remove from premises before inspection is made
- Retain copy of inspection report

TERMS AND CONDITIONS

FREIGHT POLICY

Rowley shipping and handling policy:

- Handling Fee: \$25 for first unit; \$8/unit for each additional shade.
- Oversized Fee: Handling fee plus (+) \$80 for the first unit; \$50 for each additional shade.

Rowley ships product within the continental states. You will be charged a handling fee surcharge per shade shipped by commercial carriers within the continental USA. Shipments to Alaska & Hawaii will incur additional freight charges. In addition to the per blind shipping & handling fee, there will be a net common carrier charge on any shipment containing blinds and/or valances exceeding 90" in width and/or length for cellular, roller shades and Twinlight.

Customers must provide a Freight Forwarder within the continental US for shipment destinations outside the US. Rowley cannot ship directly to customers located outside the US. All Marketing Materials & Samples ship FOB from Dallas, TX.

Expedited shipping is available within the 48 contiguous states. Next Day Air, 2nd Day Air and 3rd Day Air service is available. Pricing upon request.

WARRANTY

Cellular Shades	Lifetime Limited Warranty
Roller & Solar Shades	Lifetime Limited Warranty
Twinlight Shades	Lifetime Limited Warranty
Motors	Motor Warranty (page 16)
Decorative Textile Film	5 Year Limited Warranty

Rowley Company, at our discretion, will repair or replace, any part of our custom-made window coverings of the following types- ROLLER, TWINLIGHT, CELLULAR SHADES; (herein called "blinds") found to be defective as a result of faulty workmanship or materials for as long as the original retail purchaser owns the blind (unless a shorter period is provided below).

Repairs and/or replacements will be made with like or similar parts or products. This Warranty does not apply to any blind or parts thereof, which fail due to:

- accident
- alteration
- abuse or neglect
- improper care
- normal wear and tear
- discoloration due to sunlight or passage of time
- direct exposure to moisture, salt air, corrosive material
- warpage due to high humidity or excessive heat
- failure to follow proper instructions for measuring, installing, or operating the blind

Some wrinkling or puckering is inherent to textile products and should be considered normal, acceptable quality.

Consumers should be aware that colors vary from dye lot to dye lot and may not match sample swatches or colors from previous purchases. In the event, there are multiple blinds in the same room, only the defective blind will be repaired or replaced

This warranty is limited to blinds installed in residential dwellings and only those blinds manufactured by Rowley Company. Different warranty periods and terms apply for commercial applications.

For warranty service, you must ship or deliver the shade(s) to Rowley Company at the address provided below. You will bear the cost of shipping/ delivery the shade(s) to Rowley Company and return shipment or delivery to you. Rowley Company is not responsible for costs associated with taking down or reinstalling the product if you have any questions about our warranty, please contact us at the address below.

8801 Ambassador Row
Dallas, Texas 75247

TERMS AND CONDITIONS

Rowley Company will not have any liability for defective blinds other than repair or replacement provided for in this Warranty, which is your sole remedy under this Warranty.

Note: In no event shall Rowley Company be liable or responsible for incidental or consequential damages or for any other indirect loss, damage, cost or expense. Some states do not allow the exclusion or limitation of incidental or consequential damages, so the above limitation or exclusion may not apply to you. This Warranty gives you specific legal rights, and you may also have other rights which vary from state to state.

- Normal wear and tear is the expected decline in the condition of a blind/shade due to normal everyday use, not caused by abuse or neglect. All moving parts, such as cords (internal and external), will eventually wear out and fabric may fray.
- It is recommended to periodically raise and lower cellular shades to retain pleat structure.
- Discontinued components or color selections will be replaced with the closest equivalent current product.
- Loose fibers may appear on material edges from time to time. This is normal and does not affect the overall integrity of the shade. Simply trim off the loose fibers with a pair of sharp scissors. Do NOT pull threads.
- Roller Shade material edges may curl inward (hourglass). This is especially noticeable on long narrow shades. Refer to warranty on **page 16**.

Warranty Guidelines

Cellular cords	3 Years
----------------	---------

Motorization

Motors	See pages 16-17
Remote Controls, Switches, Etc.	90 Days

Decorative Textile Film Warranty

Rowley Company provides a 5-year Warranty for Decorative Textile Film.

This warranty is contingent on the correct installation (via the Installation Instructions for Decorative Textile Film) on a vertical glass without any removal and repositioning of the film after activation of the glue.

Strict compliance with the storage, application, installation and maintenance instructions, is necessary to ensure the service life and Warranty of the Decorative Textile Film.

For additional Warranty information, questions or service, please contact our Customer Service Department.

833-743-1314
shades@rowleycompany.com

MOTOR WARRANTY



DURATION OF WARRANTY

- Motors, Internal Batteries, Remote Controls and Accessories used for interior shades and drapery systems are covered for 5 years from date of manufacture under normal use.
- Basic Motors, Internal Batteries and Remote Controls used for interior shades are covered for 3 years from date of manufacture under normal use.

WARRANTY DETAILS

ROWLEY COMPANY OBLIGATIONS:

Rowley Company's obligations under this warranty are limited to, at Rowley Company's discretion, the repair or replacement of defective parts or products. Repairs and replacements will be made with like or similar components.

WHO IS COVERED:

Only the original manufacturing purchaser. The warranty is not transferable to subsequent owners of the products; provided, however, the manufacturing purchaser may offer a warranty with similar or lesser terms and conditions to direct and indirect customers.

WHAT IS COVERED:

Lithium-ion motors & Batteries, Basic Motors, and AC/DC Wired motors including, accessories, components, hardware, and internal electronics. This warranty covers defects in materials and workmanship under normal use.

WHAT IS NOT COVERED:

Any conditions or damage caused by or resulting from misuse, abuse, alterations, or failure to follow instructions for measurement, installation, use, cleaning, or maintenance. Abnormal environmental conditions such as exposure to foreign materials, corrosive/salt-fog environments, unauthorized cleaning agents, chemical stress attack, excessive humidity, extreme temperature, abnormal RF frequency-related issues or abnormal electric stress including surge or over-voltage. Lithium-ion battery motor failures due to non-compliance of the minimum recommended charging intervals of battery motors (one full charge per twelve-month period). Shipping and labor costs for the measuring and taking down of products and/or the re-installation of products. Injury, loss, or damage, direct or consequential, arising out of, or the inability to use, the equipment. Installation and usage not in accordance with our installation and operating instructions. Product has been opened, dismantled, or returned with clear evidence of abuse or other damage. If the product has been used to perform any functions other than the functions it was designed to handle. Product used with electrical accessories (switches, relays, etc.) that have not been previously approved in writing by Rowley Company.

WARRANTY SERVICE:

Warranty claims must be accompanied by the original sales information as well as relevant details regarding the claim, including the nature of the problem, the location of the product, fabrication and installation details, cleaning/maintenance history, and any other relevant information. To return products for inspection and, if the condition or damage is covered by the warranty, repair, or replacement, contact us for a return goods authorization (RGA) number, and then ship the parts in question back to Rowley Company. Rowley will inspect and repair or replace any covered, defective items and return them. Freight pre-paid.

LIMITATION OF DAMAGES:

THIS WARRANTY DOES NOT COVER, AND EXPRESSLY EXCLUDES, ANY AND ALL LIABILITY OF THE ROWLEY COMPANY, WHETHER UNDER THIS WARRANTY OR UNDER ANY WARRANTY IMPLIED BY LAW, FOR ANY INDIRECT OR CONSEQUENTIAL INDIRECT OR CONSEQUENTIAL DAMAGES. EXCEPT AS EXPRESSLY PROVIDED IN THIS LIMITED WARRANTY, ROWLEY COMPANY HEREBY DISCLAIMS ALL WARRANTIES TO THE EXTENT PERMITTED BY LAW. ANY IMPLIED WARRANTIES THAT CANNOT BE DISCLAIMED ARE, TO THE EXTENT PERMITTED BY LAW, LIMITED IN DURATION TO FIVE YEARS.

Some states do not allow the foregoing exclusion or limitation of incidental or consequential damages, so the foregoing limitation or exclusion may not apply to you, and you may have other rights available in your state. No person employed by Rowley or otherwise is authorized to extend or alter this limited warranty, except for a duly authorized corporate officer of the company. Rowley is also not responsible for Shipping or labor costs associated with measuring, removing, or reinstalling products. Costs associated with import/export duties or broker fees or taxes associated with the shipment of replacements.

For additional Warranty information or service, please contact our Customer Service Department.
833-743-1314
shades@rowleycompany.com

TABLE OF
CONTENTS



Motorization

Why Motorization	19	Automate by Rollease®	29
Motor Brand Options	19	Available Components	26
FAQ	20	Motor Comparison	30
Key Terms and Descriptions	21	DC Wired Motorization	31
Lithium Ion Rechargeable Motorization	22	Automate Hub	32
Bond Bridge Pro	23	Available Components	33
Solar Panel Battery Charger	24	DC Power Distribution Panel	34
RTEC Automation® by Rowley	25	Distribution Panel Power Specs	35
Available Components	26	Motor Comparison Charts	36-38
Motor Comparison Charts	27-28		

WHY MOTORIZATION?

Technology for residential applications is continuously evolving. Movements that seem natural to us, such as opening and closing a blind manually by hand, are considered old fashioned today. Motorization provides users with a new choice of practical and reliable alternatives.

Convenience Effortlessly control hard to reach window coverings.

Safety! Eliminate dangling cords as a safety hazard for children and pets.

Privacy & Light Control Manage glare, UV rays and temperature with the touch of a button creating instant privacy and protecting valuable furnishings.

MOTOR BRAND OPTIONS



The R-TEC Automation® motorization line is a fusion of cutting-edge technology, sleek design, and exceptional quality. Engineered with precision, R-TEC Automation® offers innovative control solutions, making it the ideal choice for modern, efficient, and safe window treatments.



We are a proud distributor of Automate® products, offering innovative motorization solutions with smart control and reliable performance for any window treatment.

FAQ

Are the New and Original Versions of R-TEC motors and accessories compatible with the Bond Bridge Pro Hub?

Yes, both the Shade and Drapery, motors and accessories, from the New 2025 R-TEC (Rowley Automation) and the Original R-TEC (Rollease Automate) are compatible with the Bond Bridge Pro Hub and the Bond Home App.

What Shade and Drapery Motors and accessories are currently available in the New Version 2025 R-TEC system?

The Shade motors and accessories in the New Version 2025 R-TEC system is currently active. The Drapery motor will be added later.

Do the New Version 2025 R-TEC, and the Original Version R-TEC, systems communicate with each other?

No, the New Version 2025 R-TEC (Rowley Automation) motors, accessories, and hubs do not communicate directly with the Original Version R-TEC (Rollease Automate) motors, accessories, and hubs.

Are there any integration limitations with the Bond Bridge Pro Hub?

Yes, the Bond Bridge Pro Hub cannot integrate communication between the New Version 2025 R-TEC and the Original Version R-TEC motors and accessories.

What does this mean for users of both systems?

Users will need to separate the New Version R Tec systems from the Original Version R Tec systems, when using the Bond Bridge Pro Hub, as it will not unify these versions into a single integrated system.

Where can I find more information about how this impacts setup or usage?

For more details on the setup, integration and compatibility, please refer to our control and integration compatibility chart.

What are the available options under the R-TEC Automation® and Rollease Automate® brands?

Please refer to our R-TEC Automation® vs. Rollease Automate® comparison chart for a detailed breakdown of available options under each brand.

HOW do i place an order for Rowley R-TEC Automation® and Rollease Automate® products?

All item numbers have been updated in our 2025 catalog, and you can continue to place orders through our website or customer service team using the same process as before.

Does the rebrand affect compatibility with my existing R-TEC Automation® Hub and Motors?

No, your existing hub and motors remain fully compatible. The motors in use are Rollease motors, remotes, and an app branded under Automate® —with no changes to service levels or warranty.

My existing hub still shows the R-TEC Automation® brand. Will it still work?

Yes! The hub's functionality remains the same. While the app is now branded as Rollease Automate®, it continues to work seamlessly with your existing motors and remotes.

- Same hub, new item number: MT02-0401-067001

What if i need to order additional motors or accessories for a home using the previous R-TEC Automation® branded products?

If your customer's existing remotes, motors, and app are branded under Rollease Automate®, you should now order compatible motors and accessories using the Rollease Automate® item numbers found in the 2025 catalog.

KEY TERMS AND DESCRIPTIONS

Rechargeable

Requires no electrical wiring, no external battery pack and no complicated installation. Simple and affordable! Motors will operate 6-9 months between charges based on average size and daily use. Li-Ion batteries can be recharged up to 500 times. Takes approximately 5 hours to fully recharge. Remember to purchase at least one charger!

Battery / Wire Free

Cellular shades have external rechargeable battery pack.

DC Wired/Battery Motorization

Shades are powered by an external battery or 12v DC transformer/plug similar to a cell phone charger. Low voltage wires are used so an electrician is not required, keeping installation costs minimal. Most DC motors can also be wired to a central distribution panel eliminating the need for multiple power adapters.

AC Wired Motorization

Great for homes with large windows. AC motors provide a larger lifting capacity. These use a grounded plug or in many cases can be hard-wired by an electrician into the home's electrical system.

Radio Frequency (RF)™

Powerful radio frequency means shades can be operated from virtually anywhere in the house without direct line of sight. Radio signal travels through walls similar to a garage door opener.

Solar Charging

Harness the sun's energy to power battery operated motorized window coverings. Simply attach a solar panel to the motor and install in the window. The solar panel will keep your shades charged and ready for operation!

Remotes and Wall Switches and App Controls

A multitude of options are available from handheld remotes, wall switches that can be installed for easy access when entering or leaving a room, and app controls that allow you operate your window coverings from a smartphone or tablet.

Li-ion Rechargeable Motorization

- Available for these products: Roller & Solar Shades, Twinlight, and Cellular Shades (DC only)
- Motor options for even the largest shades!
- Radio Frequency motor with rechargeable battery is concealed inside the headrail or roller tube.
- Motor charging cable port is located on the motorhead.
- A charger is required. Order at least one charger.
Note: Consider ordering 1 charger for every 5 shades as recharging can take several hours.
- Windows with metal casing may reduce radio frequency range or cause interference. Do not let the antenna touch any metal objects.
- Rollease Automate motors are compatible with Google Assistant, Amazon Alexa, IFTTT (If This Then That) and Apple® HomeKit.
- Smart Home Automation Systems: Savant, Control4®, Crestron®, AMX, Elan®, HomeSeer.
- 5 Year Warranty on Li-Ion motors. 3 Year Warranty on Basics Motors.
- Introducing Bond Bridge Pro.

LITHIUM ION RECHARGEABLE MOTORIZATION

Li-ion battery powered motorized shades are a perfect retro fit for existing homes or small commercial projects. Li-ion powered motors require no electrical wiring, no external battery pack and no complicated installation.

- 1-way and 2-way RF communication for simple programming
- 3 operational speed settings
- Leveling control

- Electronic limit setting and adjustment
- Favorite position
- Rechargeable built-in Li-ion Battery
- Li-ion Battery operates up to 500 up and down cycles per charge (based on recommended shade size)
- Requires Battery Charger or Solar Panel Battery Charger

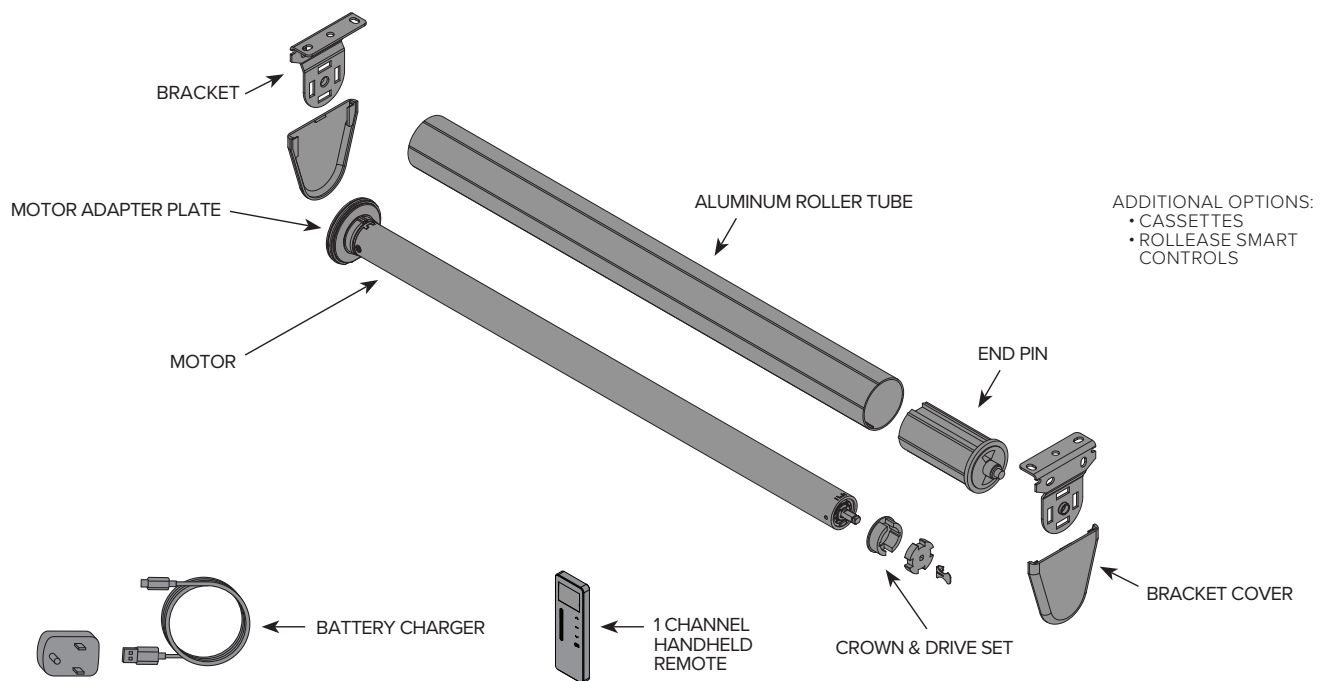

FEATURES



POWER OPTIONS



SOLAR

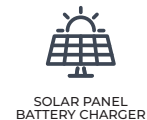



NOTE

Compatible with both
RTEC Automation® by
Rowley and AUTOMATE®
by Rollease

BOND BRIDGE PRO

- Smart home functionality adds Wi-Fi to your shades, enabling seamless control.
- Shade slider easily opens and closes your shades to desired percentage.
- Ethernet port & Power Over Ethernet (PoE) technology, creating less cords.
- No installation or hardwiring needed. Setup is fast and easy.
- Ceiling or wall mount.
- 1.4" H x 5.7" W x 6.2" D.
- White
- Range: 3,500 sq. ft.

SOLAR PANEL BATTERY CHARGER



NOTE

Compatible with both
RTEC Automation® by
Rowley and AUTOMATE®
by Rollease

With a slim design and improved performance in low light, the Solar Panel offers an energy efficient upgrade for the entire Wirefree Li-ion range of motors and is compatible with either the R-TEC Automation or the Automate System.



RENEWABLE POWER

Environmentally friendly power maintains motor energy without the need of regularly charging.



CRYSTAL TECHNOLOGY

Substantially increases solar ray absorption and efficiency of power conversion.



LOW LIGHT EFFICIENCY

Optimal performance even in low light circumstances.



USB CHARGE

Easily charge the panel using a standard USB cable before solar ray absorption.



BYPASS DIODE

Ensures a continuous stream of power, even if small sections of the panel are obstructed.



PLUG & PLAY

Harnesses solar power for both 5V and 12V Wireless Li-ion motors.



MULTIPLE MOUNTING POINTS

Quick and easy to install on any window treatment application.



SLEEK DESIGN

A modern, slim profile provides easy incorporation into your window treatment.

R·TEC AUTOMATION® by Rowley®

The R-TEC Automation® motorization line is a fusion of cutting-edge technology, sleek design, and exceptional quality. Engineered with precision, R-TEC Automation® offers innovative control solutions, making it the ideal choice for modern, efficient, and safe window treatments.



WHAT'S NEW IN THE R-TEC AUTOMATION® LINE?

- 3 Li-ion Battery Shade Motors – Designed in-house for long-term performance.
- New Battery Motor Accessories – Including an extended charging cable for added convenience.
- 5 Remote Controls – Featuring LED wall-mount and handheld remotes with a scroll wheel for precise shade adjustments.
- Bond Bridge Pro & Bond Home App – Enhancing Smart Home automation and installation options.
- R-TEC Automation® Roller / Roman Shade Starter Kit – Pre-packaged; includes components needed to assemble one 4' R-TEC Motor Roller / Roman Shade.
- Custom Solutions R-TEC Automation® Li-ion Battery Soft Shade System – Let our in-house experts assemble your system for you.

AVAILABLE COMPONENTS

MOTORS



25 MM, STD, 1.1 NM, 2-CELL
25 MM, STD, 2 NM, 3-CELL
28 MM, STD, 2 NM, 3-CELL

HUB

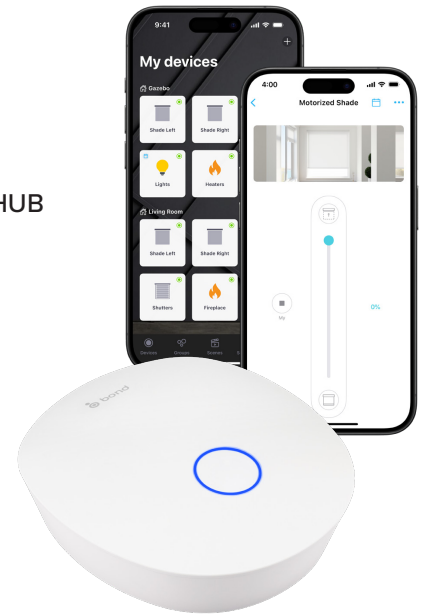

BOND BRIDGE PRO AND APP

WALL CONTROLLERS

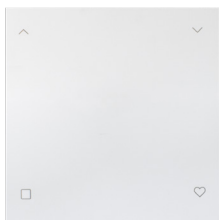

LED WALL
MOUNT REMOTE
1 CHANNEL, WHITE
RANGE: 98.5'



LED WALL MOUNT REMOTE
2 CHANNEL, WHITE
RANGE: 98.5'

REMOTES



LED HANDHELD
REMOTE WITH WALL
MOUNT
6 CHANNEL, WHITE
RANGE: 98.5'



LCD HANDHELD REMOTE
WITH WALL MOUNT
16 CHANNEL, WHITE
RANGE: 98.5'



HANDHELD REMOTE
WITH SCROLL WHEEL
ADJUSTMENT
6 CHANNEL, WHITE
RANGE: 98.5'

ACCESSORIES



USB WALL CHARGER
AC ADAPTER, WHITE



SOLAR PANEL BATTERY CHARGER (INCLUDES L-BRACKET,
FASTENERS, MICRO USB & USB C CABLES)

MOTOR COMPARISON

MOTOR SPECS & FEATURES

	25 MM SHORT LI-ION BATTERY RTA25L2C1WA	25 MM LI-ION BATTERY RTA25L3C1WA	28 MM LI-ION BATTERY RTA28L3C1WA
Power Source	Li-ion 2-cell	Li-ion 3-cell	Li-ion 3-cell
Motor Diameter	25 mm	25 mm	28 mm
Compatible Roller Tube Size	1 1/4" & 1 1/2"	1 1/4" & 1 1/2"	1 1/2" & 2"
Bracket Type	Skyline	Skyline	Skyline
Antenna Type	Internal COB	Internal COB	Internal COB
Physical Button	Yes	Yes	Yes
Charge Port Type	USB-C	USB-C	USB-C
Pairing/Functionality Feedback (sound, light, jog)	All	All	All
Voltage	5V	5V	5V
Torque	1.1 Nm	2.0 Nm	2.0 Nm
Max Run Time	6 min	6 min	6 min
Speed / Adjustable	20/25/30 rpm	20/24/28 rpm	20/24/28 rpm
Temp Working Range	14° - 131° F	14° - 131° F	14° - 131° F
Limit Switch Type	Electronic	Electronic	Electronic
Current	1.0 A	1.6 A	1.6 A
Battery Size/Type	2 Cell	3 Cell	3 Cell
Sound Level	32 dBA	32 dBA	32 dBA
Power	9.6 W	18 W	18 W
Maximum Load	15.5 lbs.	23.5 lbs.	23.5 lbs.
Soft Stop	No	No	No
Battery Check (shade level)	No	No	No
Accessories (deco motor head cover, sun sensor)	No	No	No
Charging Options	Standard or Magnetic USB-C	Standard or Magnetic USB-C	Standard or Magnetic USB-C
Radio Communication Technology	1-way RF	1-way RF	1-way RF
Hub/Bridge & App	Bond Bridge Pro & Bond Home App	Bond Bridge Pro & Bond Home App	Bond Bridge Pro & Bond Home App

PRODUCT TYPE	ROLLER TUBE SIZE	MINIMUM WIDTH	MINIMUM HEIGHT	MAXIMUM WIDTH	MAXIMUM HEIGHT	TORQUE	SOUND LEVEL	INSIDE MOUNT ALLOWANCE	OUTSIDE MOUNT ALLOWANCE	OPEN ROLL	CASSETTE 100	CASSETTE 110	CASSETTE 120	3" FASCIA	4" FASCIA	5" FASCIA
--------------	------------------	---------------	----------------	---------------	----------------	--------	-------------	------------------------	-------------------------	-----------	--------------	--------------	--------------	-----------	-----------	-----------

ROLLER & SOLAR SHADES

Li-ion Rechargeable Motorization

R-TEC LI 5v 2 Cell (25mm) 1.1Nm	1 1/4"	21"	12"	72"	96"	1.1 Nm ~32dB	1/8" bracket- to-bracket (1 1/8" fabric)	1" fabric only	Y	Y	Y	Y	Y	Y	Y	Y
R-TEC LI 5v 3 Cell (25mm) 1.1Nm	1 1/2"	29 1/2"	12"	108"	108"		1/8" bracket- to-bracket (1 1/8" fabric)	1" fabric only	Y	Y	Y	Y	Y	Y	Y	Y
R-TEC LI 5v 3 Cell (28mm) 2Nm	1 1/2"	32"	12"	120"	132"		1/8" bracket- to-bracket (1 3/8" fabric)	1 1/4" fabric only	Y					Y	Y	

AUTOMATE®

A DIVISION OF ROLLEASE ACMEDA

We are a proud distributor of Automate® products, offering innovative motorization solutions with smart control and reliable performance for any window treatment.



AUTOMATE. MOTOR COMPARISON

MOTOR SPECS & FEATURES

	25 MM SHORT LI-ION BATTERY MT01-1325- 069029	25 MM LI-ION BATTERY MT01-1325- 069029	28 MM LI-ION BATTERY MT01-1328- 069008	35 MM LI-ION BATTERY MT01-1335- 069001	25 MM DC MT01-1225- 069002	28 MM MT01-1228- 069002	35 MM DC MTDCRF35-3	25 MM BASICS LI-ION BATTERY MT01-1325- 069026
Power Source	Li-ion 5V-DC	Li-ion 5V-DC	Li-ion 5V-DC	Li-ion 5V-DC	12V-DC	12V-DC	12V-DC	12V-DC
Compatible Roller Tube Size	1 1/4" & 1 1/2"	1 1/4" & 1 1/2"	1 1/2" & 2"	2"	1 1/4" & 1 1/2"	1 1/2" & 2"	1 1/2" & 2"	2"
Bracket Type	Skyline	Skyline	Skyline	Skyline	Skyline	Skyline	Skyline	Skyline
Antenna Type	External	External	External	External	External	External	External	External
Physical Button	Yes	Yes	Yes	Yes	Yes	Yes	Yes	Yes
Charge Port Type	Micro USB	Micro USB	Micro USB	Micro USB	N/A		N/A	N/A
Pairing/Functionality Feedback (sound, light, jog)	All	All	All	All	All	N/A	All	All
Voltage	5V-DC	5V-DC	5V-DC	5V-DC	12V-DC	12V-DC	12V-DC	12V-DC
Torque	0.7 Nm	1.1 Nm	2.0 Nm	3.0 Nm	1.1 Nm	2.0 Nm	2.0 Nm	3.0 Nm
Max Run Time	12 min	12 min	12 min	12 min	6 min	10 min	10 min	12 min
Speed / Adjustable	20/24/28 rpm	20/24/28 rpm	20/24/28 rpm	20/24/28 rpm	20/24/28 rpm	20/24/28 rpm	20/24/28 rpm	28/20/24 rpm
Temp Working Range	32° - 140° F	32° - 140° F	32° - 140° F	32° - 140° F	32° - 140° F	32° - 140° F	32° - 140° F	32° - 140° F
Limit Switch Type	Electronic	Electronic	Electronic	Electronic	Electronic	Electronic	Electronic	Electronic
Current	0.73 A	0.83 A	1.25 A	2.2 A	0.83 A	1.16 A	1.16 A	2.2 A
Battery Size/Type	2600 mAH	2600 mAH	2600 mAH	5100 mAH	External Battery Pack or Tube; N/A: Power Supply or Distributor	External Battery Pack; N/A: Power Supply or Distributor	External Battery Pack; N/A: Power Supply or Distributor	N/A: Power Supply or Distributor
Sound Level	35 dB	38 dB	40 dB	40 dB	36 dB	31 dB	31 dB	53 dB
Power	6 W	10 W	15 W	N/A	10 W	13 W	13 W	26 W
Maximum Load	10.5 lbs.	15.5 lbs.	23.5 lbs.	26.5 lbs.	15.5 lbs.	23.5 lbs.	23.5 lbs.	26.5 lbs.
Soft Stop	Yes	Yes	Yes	Yes	Yes	Yes	Yes	No
Battery Check (shade level)	Yes	Yes	Yes	Yes	Yes	Yes	Yes	No
Accessories (deco motor head cover, sun sensor)	All	All	All	All	All	All	All	All
Charging Options	Standard or Magnetic Micro USB, Solar Panel	Standard or Magnetic Micro USB, Solar Panel	Standard or Magnetic Micro USB, Solar Panel	Standard or Magnetic Micro USB, Solar Panel	External Battery Pack or Tube, Power Supply or Distributor, Solar Panel	External Battery Pack, Power Supply or Distributor, Solar Panel	External Battery Pack, Power Supply or Distributor, Solar Panel	Power Supply or Distributor
Radio Communication Technology	2-way RF	2-way RF	2-way RF	2-way RF	2-way RF	2-way RF	2-way RF	2-way RF
Hub/Bridge & App	Bond Bridge Pro & Bond Home App or Automate® Pulse 2 Hub & App	Bond Bridge Pro & Bond Home App or Automate® Pulse 2 Hub & App	Bond Bridge Pro & Bond Home App or Automate® Pulse 2 Hub & App	Bond Bridge Pro & Bond Home App or Automate® Pulse 2 Hub & App	Bond Bridge Pro & Bond Home App or Automate® Pulse 2 Hub & App	Bond Bridge Pro & Bond Home App or Automate® Pulse 2 Hub & App	Bond Bridge Pro & Bond Home App or Automate® Pulse 2 Hub & App	Bond Bridge Pro & Bond Home App or Automate® Pulse 2 Hub & App

DC WIRED MOTORIZATION

DC motorized shades are ideal when designing a new home, motorizing an existing home or planning a commercial project. DC wired shades are maintenance free and the AC power supply adapter keeps installation costs to a minimum.

- 2-way RF communication with ARC™ protocol for simple programming

- 3 operational speed settings
- Leveling control
- Electronic limit setting and adjustment
- Favorite position
- Available with a Li-Ion rechargeable battery or a DC plug in power supply.

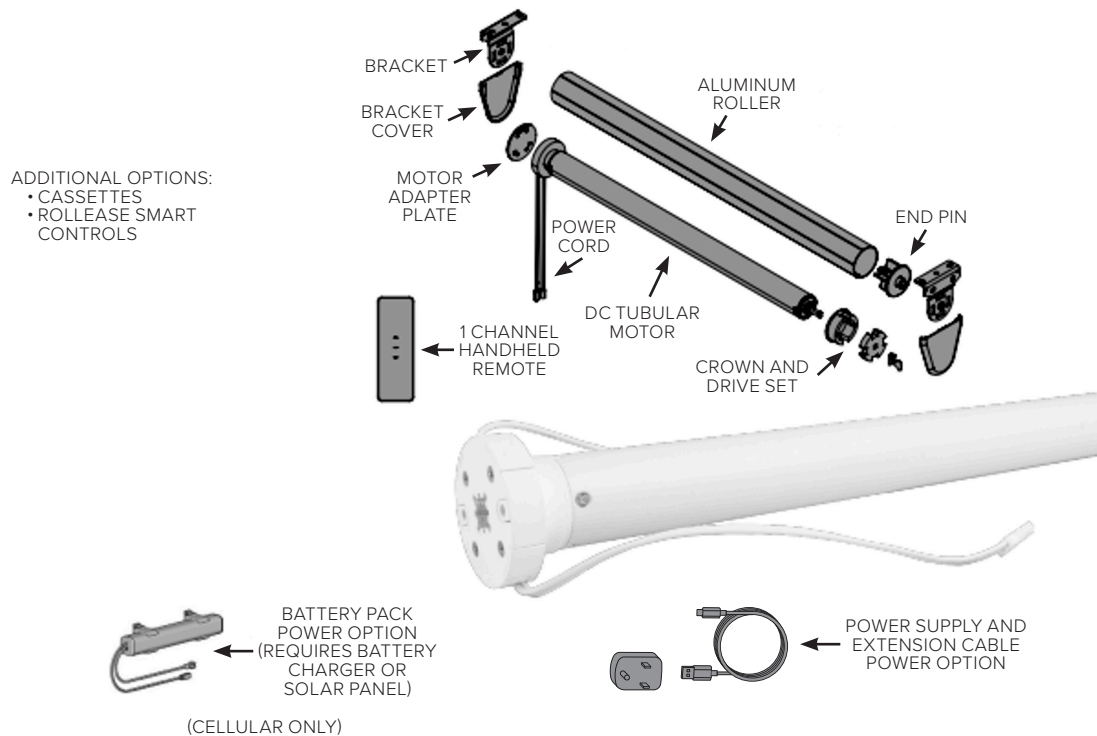

FEATURES



POWER OPTIONS



SOLAR

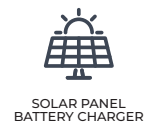

AUTOMATE HUB

SEAMLESS SMART HOME INTEGRATION

The Automate Hub connects to home networks to unlock the luxury of Rollease Automate window treatment control. Experience customization with scene and timer options as well as voice control via Google Assistant, Amazon Alexa, IFTTT (If This Then That) and Apple® HomeKit.

The Bond Bridge Pro Hub is also compatible with the Automate motorization system. See **page 23**.



VOICE CONTROL

Intuitively control Rollease Automate window treatments with simple voice commands through Google Assistant, Amazon Alexa or Apple HomeKit.



ROLLEASE AUTOMATE APP CONTROL

Control window treatments remotely, whether home or away. The Rollease Automate app is available for all Android phones, tablets and iOS devices, including Apple watches & iPads.



SUNRISE & SUNSET DETECTION

Utilizing time zone and location, the Rollease Hub can automatically raise or lower Rollease Automate window treatments according to the position of the sun.



LIVE FEEDBACK

ARC enables live communication between the hub and motors. Check motor battery levels and window treatment positions through the app or smart assistants.



DISTINCT DESIGN

Designed in California, the Rollease Hub embraces elements from modern architecture to ensure it complements the interior of any home.



PERSONALIZED EXPERIENCE

Create custom rooms, scenes, routines and timers to enable efficient or automatic window treatment control based on time, weather or schedule.



HIGH-SPEED CONNECTION

Built-in Wi-Fi or the option of Ethernet connection, ensures the Rollease Hub can connect to any home network and provide swift, wireless control of Rollease Automate window treatments.



3 STEP SETUP

No need to complicate things.

1. Power on.
2. Download the Rollease Automate App.
3. Connect & Enjoy.

AVAILABLE COMPONENTS

MOTORS



LI-ION MOTORS

35 MM, STD
25 MM SKYLINE HEAD, STD
28 MM SKYLINE HEAD, QUIET
35 MM, STD

DC MOTORS

25 MM SKYLINE HEAD, STD
28 MM SKYLINE HEAD, QUIET
35 MM, STD

BASICS MOTOR

25 MM, SHORT

HUBS



AUTOMATE® PULSE 2 HUB



AUTOMATE® PULSE PRO HUB

WALL CONTROLLERS



CUT-IN WALL MOUNT SWITCH,
1 CHANNEL, WHITE
RANGE: 65'



CUT-IN WALL MOUNT SWITCH,
2 CHANNEL, WHITE
RANGE: 65'



SURFACE MOUNT WALL SWITCH,
5 CHANNEL, WHITE
RANGE: 65'



CUT-IN WALL MOUNT SWITCH,
15 CHANNEL, WHITE,
RANGE: 65'

REMOTES



PUSH1 HANDHELD REMOTE
WITH WALL MOUNT
1 CHANNEL, WHITE OR BLACK
RANGE: 65'



PUSH PRO HANDHELD REMOTE
WITH WALL MOUNT
NO. SHADES: UP TO 30
NO. GROUPS: UP TO 15
TIMERS: UP TO 10
WHITE OR BLACK
RANGE: UP TO 328'
(DEPENDENT ON ENVIRONMENT)



PUSH5 HANDHELD REMOTE
WITH WALL MOUNT
5 CHANNEL, WHITE OR BLACK
RANGE: 65'



PUSH15 HANDHELD REMOTE
WITH WALL MOUNT
15 CHANNEL, WHITE OR BLACK
RANGE: 65'



BASICS RF REMOTE CONTROL
5 CHANNEL, WHITE
RANGE: 65' +

ACCESSORIES



USB WALL BATTERY
CHARGER, 5V



REPEATER

CHARGER



5V MICRO USB/MAGNETIC
CABLE KIT, 118"
(1 CABLE & 1 CONNECTOR)



SOLAR PANEL BATTERY CHARGER (INCLUDES L-BRACKET,
FASTENERS, MICRO USB & USB C CABLES)

DC POWER DISTRIBUTION PANEL

Up to 18 individual motor connections. Efficient installation.
The voltage and current output allow for greater cable lengths
from motor to power panel.



RELIABLE, COST EFFECTIVE POWER

Power your Automate DCRF motors from a compact, central location that can service up to 18 motors.



SECURE LOCK

Locking cabinet provides protection from inadvertent or unwanted access to power connections.



LED STATUS

Easily check each individual motors power status, by viewing the prominent green LED's on the DC Power Panel.



DIFFERENT WIRE TYPES

The panel can be used with many different wire types (from 26 to 14 AWG). So any pre-wired installation may readily use DCRF motors and the Power Distribution Panel.



ARC™ (Automate Radio Communication) is Rollease Acmeda's proprietary technology utilising 433MHz radio communication with bi-directional feedback that brings Automate motorised shading systems together.



PRODUCT SPECIFICATIONS

Part #: **MT03-0301-411005** DC POWER DISTRIBUTION PANEL

Input Voltage Range	85V AC ~ 125V AC
Output Voltage Range	15 VDC
Maximum Output Current (all 18 channels)	24 A
Power Output Rating	360 W
Single Channel Maximum Current Output	1.33 A
Ingress Protection	IP20

DIMENSIONS

Note:

Up to 18 motors (22mm / 25mm and 28mm)

Up to 9 motors (35mm and 45mm)

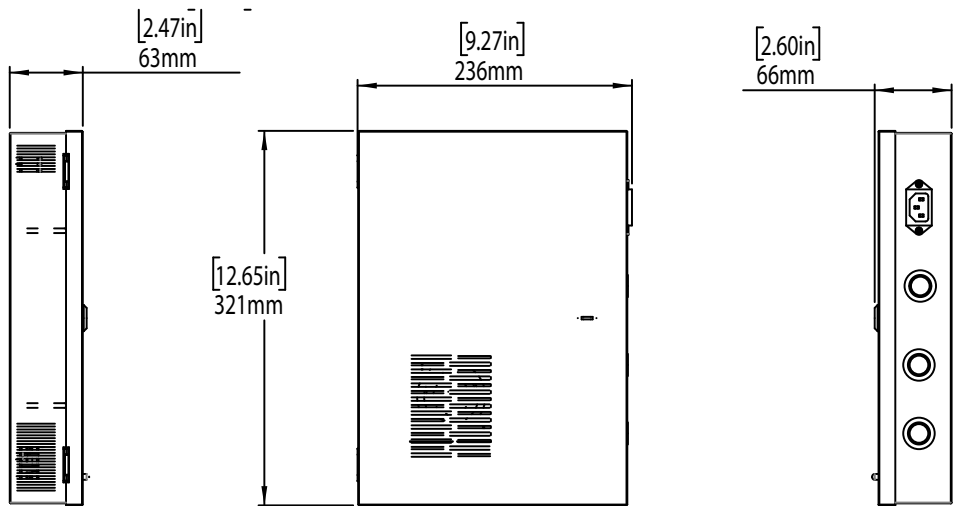

WORKS WITH

- AUTOMATE DC Motors

ACCESSORIES

(sold separately)

ITEMS INCLUDED



Harness Connector
MT03-0301-069012



Power Cord
MT03-0301-411005



Keys



Screws



Wall Plug



Fuse

PRODUCT TYPE	ROLLER TUBE SIZE	MINIMUM WIDTH	MINIMUM HEIGHT	MAXIMUM WIDTH	MAXIMUM HEIGHT	TORQUE	SOUND LEVEL	INSIDE MOUNT ALLOWANCE	OUTSIDE MOUNT ALLOWANCE	OPEN ROLL	CASSETTE 100	CASSETTE 110	CASSETTE 120	3" FASCIA	4" FASCIA	5" FASCIA
--------------	------------------	---------------	----------------	---------------	----------------	--------	-------------	------------------------	-------------------------	-----------	--------------	--------------	--------------	-----------	-----------	-----------

ROLLER & SOLAR SHADES

Li-ion Rechargeable Motorization

Automate® LI 5v Q (25mm) 1.1Nm	1 1/4"	21"	12"	72"	96"	1.1 Nm	~46dB	1/8" bracket-to-bracket (1 1/8" fabric)	1" fabric only	Y	Y	Y	Y	Y	Y	Y
Automate® LI 5v Q (25mm) 1.1Nm	1 1/2"	29 1/2"	12"	108"	108"			1/8" bracket-to-bracket (1 1/8" fabric)	1" fabric only	Y	Y	Y	Y	Y	Y	Y
Automate® LI 5v Q (28mm) 2Nm	1 1/2"	29 1/2"	12"	108"	120"	2 Nm	~44dB	1/8" bracket-to-bracket (1 1/8" fabric)	1" fabric only	Y	Y	Y	Y		Y	Y
Automate® LI 5v Q (28mm) 2Nm	2"	29 1/2"	12"	120"	120"			1/8" bracket-to-bracket (1 1/8" fabric)	1" fabric only	Y	Y	Y	Y	Y	Y	Y
Automate® LI 5v (35mm) 3Nm	2"	32"	12"	120"	132"	3 Nm	~40dB	1/8" bracket-to-bracket (1 3/8" fabric)	1 1/4" fabric only	Y					Y	Y
Automate® LI 5v (45mm) 3Nm	2 3/8"	42"	12"	120"	132"		~42dB	1/8" bracket-to-bracket (2 1/8" fabric)	2" fabric only	Y						Y
Automate® LI 5v (45mm) 3Nm	2 1/2"	42"	12"	144"	144"			1/8" bracket-to-bracket (2 1/8" fabric)	2" fabric only	Y						Y
Automate® LI 5v (45mm) 3Nm	3 1/4"	42"	12"	168"	144"			1/8" bracket-to-bracket (2 1/8" fabric)	2" fabric only	Y						Y
Automate® LI 5v (45mm) 10Nm	2 3/8"	42"	12"	108"	132"	10 Nm	~42dB	1/8" bracket-to-bracket (2 1/8" fabric)	2" fabric only	Y						Y
Automate® LI 5v (45mm) 10Nm	2 1/2"	42"	12"	144"	144"			1/8" bracket-to-bracket (2 1/8" fabric)	2" fabric only	Y						Y
Automate® LI 5v (45mm) 10Nm	3 1/4"	42"	12"	168"	144"			1/8" bracket-to-bracket (2 1/8" fabric)	2" fabric only	Y						Y

PRODUCT TYPE	ROLLER TUBE SIZE	MINIMUM WIDTH	MINIMUM HEIGHT	MAXIMUM WIDTH	MAXIMUM HEIGHT	TORQUE	SOUND LEVEL	INSIDE MOUNT ALLOWANCE	OUTSIDE MOUNT ALLOWANCE	OPEN ROLL	CASSETTE 100	CASSETTE 110	CASSETTE 120	3" FASCIA	4" FASCIA	5" FASCIA
--------------	------------------	---------------	----------------	---------------	----------------	--------	-------------	------------------------	-------------------------	-----------	--------------	--------------	--------------	-----------	-----------	-----------

ROLLER & SOLAR SHADES

DC Wired motorization (continuously powered)

Automate® DC 25mm 1.1Nm	1 1/4"	21"	12"	72"	96"	1.1 Nm	~46dB	1/8" bracket-to-bracket (1 1/8" fabric)	1" fabric only	Y	Y	Y	Y	Y	Y	Y
Automate® DC 25mm 1.1Nm	1 1/2"	29 1/2"	12"	108"	120"			1/8" bracket-to-bracket (1 1/8" fabric)	1" fabric only	Y	Y	Y	Y	Y	Y	Y
Automate® DC 28mm	1 1/2"	29 1/2"	12"	108"	120"	2 Nm	~31dB	1/8" bracket-to-bracket (1 1/8" fabric)	1" fabric only	Y	Y	Y	Y	Y	Y	Y
Automate® DC 28mm	2"	29 1/2"	12"	108"	120"	2 Nm	~31dB	1/8" bracket-to-bracket (1 1/8" fabric)	1" fabric only	Y	Y	Y	Y	Y	Y	Y
Automate® DC 35mm 3Nm	2"	32"	12"	120"	120"	2 Nm	~44dB	1/8" bracket-to-bracket (1 3/8" fabric)	1 1/4" fabric only	Y					Y	Y
Automate® DC 45mm 3Nm	2 3/8"	42"	12"	120"	132"	3 Nm	~40dB	1/8" bracket-to-bracket (2 1/8" fabric)	2" fabric only	Y						Y
Automate® DC 45mm 3Nm	2 1/2"	42"	12"	144"	144"			1/8" bracket-to-bracket (2 1/8" fabric)	2" fabric only	Y					Y	Y
Automate® DC 45mm 3Nm	3 1/4"	42"	12"	168"	144"			1/8" bracket-to-bracket (2 1/8" fabric)	2" fabric only	Y						Y
Automate® DC 45mm 10Nm	2 3/8"	42"	12"	108"	132"	10 Nm	~42dB	1/8" bracket-to-bracket (2 1/8" fabric)	2" fabric only	Y						Y
Automate® DC 45mm 10Nm	2 1/2"	42"	12"	144"	144"			1/8" bracket-to-bracket (2 1/8" fabric)	2" fabric only	Y						Y
Automate® DC 45mm 10Nm	3 1/4"	42"	12"	168"	144"			1/8" bracket-to-bracket (2 1/8" fabric)	2" fabric only	Y						Y

ELEMENTS® SHADE COLLECTION

PRODUCT TYPE	ROLLER TUBE SIZE	MINIMUM WIDTH	MINIMUM HEIGHT	MAXIMUM WIDTH	MAXIMUM HEIGHT	TORQUE	SOUND LEVEL	INSIDE MOUNT ALLOWANCE	OUTSIDE MOUNT ALLOWANCE	OPEN ROLL	CASSETTE 100	CASSETTE 110	CASSETTE 120
--------------	------------------	---------------	----------------	---------------	----------------	--------	-------------	------------------------	-------------------------	-----------	--------------	--------------	--------------

TWINLIGHT SHADES

LI-Ion Rechargeable Motorization

Cassette 100/120

Automate® 25mm 1.1Nm	1 1/2"	29 1/2"	12"	96"	96"	1.1 Nm	~46dB	1/8" bracket-to-bracket (1 1/8" fabric)	1" fabric only	Y	Y
Automate® 28mm 2Nm	1 1/2"	29 1/2"	12"	96"	96"	2 Nm	~44dB	1/8" bracket-to-bracket (1 1/8" fabric)	1" fabric only	Y	Y
Automate® DC 25mm 1.1Nm	1 1/2"	29 1/2"	12"	96"	96"	1.1 Nm	~46dB	1/8" bracket-to-bracket (1 1/4" fabric)	1 1/8" fabric only		Y

CELLULAR SHADES

Automate® Lift		20"	12"	up to 120"	up to 96"	.6 Nm	~48dB						
----------------	--	-----	-----	---------------	--------------	-------	-------	--	--	--	--	--	--

NOTE: RPM listed is default speed. Most motors can be adjusted to run slightly faster or slower.

All Blackout Cellular Fabrics are limited to maximum 55 sq ft.

TABLE OF
CONTENTS



Roller Shades

Product Characteristics 40-41

Product Specifications

 Motorized Shades 42

Product Specifications

 Non-Motorized Shades 43

Product Specifications 44-45

Operating Options 46

Design Options 47

Side Channels 48-49

Privacy Strips 50

Specifications by Fabric or Screen 50

Specifications by Fabric or Screen 51-52

Specifications by Tube Size

 and Top Treatment 53-54

Product Components 56-59

PRODUCT CHARACTERISTICS

Roller Shades are available as decorative fabrics and solar screens.



Roller Shades feature clean lines and a streamlined appearance. Updated colors and options create a traditional shade that will never go out of style. A perfect base when layering window treatments.



Solar Screen shades will preserve your view yet work hard to improve energy efficiency by reducing glare and heat gain. By substantially blocking harmful UV rays, solar screen shades will help protect furniture and carpet from fading.

Although we maintain the strictest quality standards and inspect every shade before it leaves our factory, the following characteristics are considered normal and are not manufacturing defects:

- Loose fibers may appear on material edges from time to time. This is normal and does not affect the overall integrity of the shade. Simply trim off the loose fibers with a pair of sharp scissors.
- Material edges may curl inward (hourglass). This is especially noticeable on long narrow as well as railroad shades.
- Screen material is designed to have a clear view-through when viewing directly or on a slight angle. Waviness and distortion is characteristic when viewing from an angle of approximately 30% or more, depending on the pattern.
- Inside mount shades will have light leaks at the top and around outer edges of shades. This is especially noticeable on blackout and room darkening materials.
- Tube deflection may occur, and a slight V shape may appear in the top and center portion of the shade, especially on shades over 120" wide. This is considered normal, providing that the material does not wrinkle when rolled up onto the tube.
- Please be aware that installing screen shades on windows with insect screens may cause a moire effect.
- Shades where the length exceeds the width by a 3 to 1 ratio may experience telescoping to one side as it is raised and lowered, and will experience curling along the edges, this is not a defect in the product.

Fabric Disclaimers

- Fabric appearance can vary based on changing light conditions in a room and color reflection of the interior décor.
- There may be creases in fabric due to the time rolled up in the packaging material during the transit. To remove creases, unroll the shade completely, and let it hang for several days. Most wrinkles will resolve after a several days.
- Due to the nature of the weaving process, some imperfections in the weave are normal.

Pattern Alignment

- No guarantee on fabric pattern alignment for side by side shades. Under shades with cassettes, vertical alignment of the shade fabric is not possible.
- Fabric with repeat patterns are not centered on the shade.

Straighten Shade

If your shade does not roll straight, check if shade installed level. If not, level shade first then correct as follows:

Figure A — Shade "telescopes" veers toward right, or left. Correct by lowering shade completely exposing the roller tube and wrapping a 1 1/2" long piece of masking tape, as shown in **Figure B**, on the shorter side (opposite of where it's veering). This increases the diameter of the roller slightly, acting as a straightener. Then raise and lower the shade. If shade does not still roll straight, add a second layer of tape and repeat process. Continue to add tape until shade rolls straight as shown in **Figure C**.

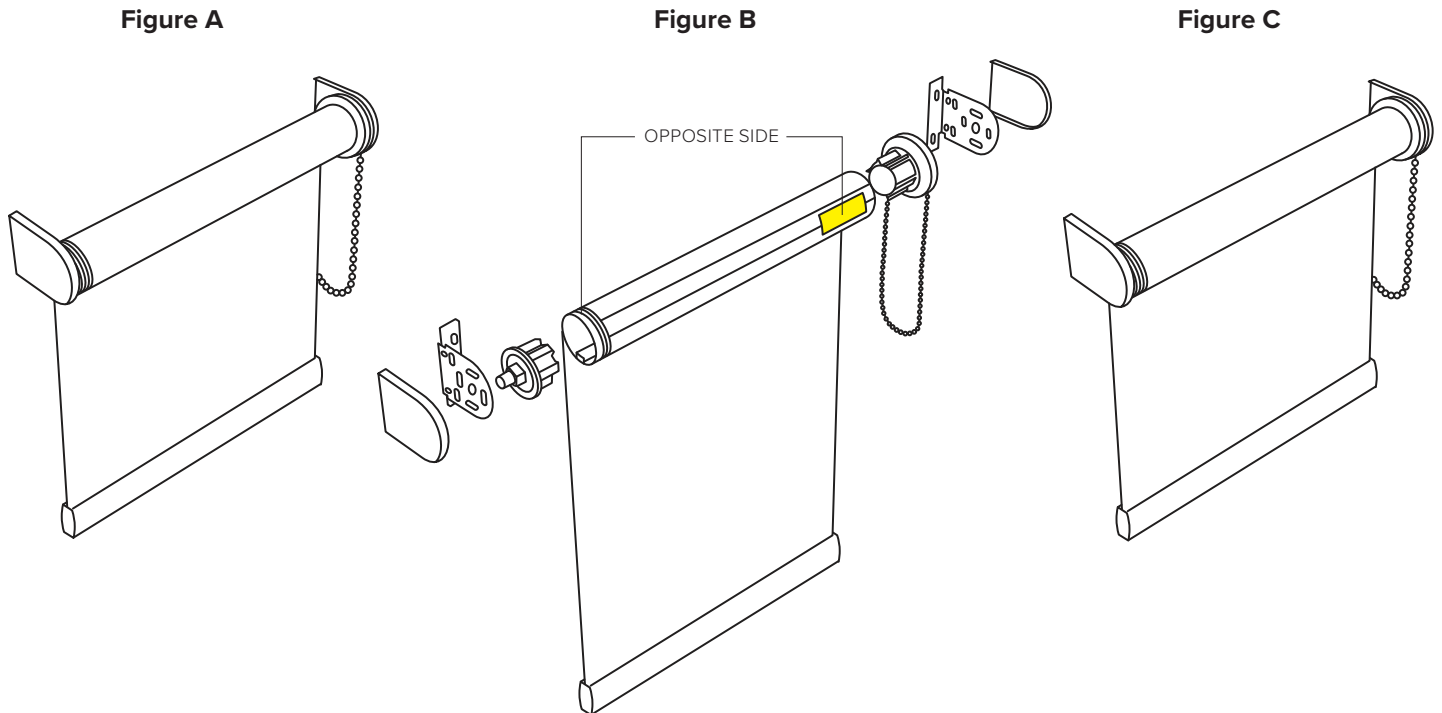

PRODUCT SPECIFICATIONS

MOTORIZED SHADES

PRODUCT TYPE	ROLLER TUBE SIZE	MINIMUM WIDTH	MINIMUM HEIGHT	MAXIMUM WIDTH	MAXIMUM HEIGHT	INSIDE MOUNT ALLOWANCE	OUTSIDE MOUNT ALLOWANCE
--------------	------------------	---------------	----------------	---------------	----------------	------------------------	-------------------------

R-TEC AUTOMATION®

MOTORIZATION (Open Roll)
LI-Ion Rechargeable Motorization

R-TEC LI 25mm 1.1Nm	1 1/4"	21"	12"	72"	84"	1/8" bracket-to-bracket	1 1/8" fabric	1 1/4" fabric only
R-TEC LI 25mm 1.1Nm	1 1/2"	29 1/2"	12"	72"	120"	1/8" bracket-to-bracket	1 1/8" fabric	1 1/4" fabric only
R-TEC LI 28mm 2Nm	1 1/2"	29 1/2"	12"	84"	120"	1/8" bracket-to-bracket	1 1/8" fabric	1 1/4" fabric only
R-TEC LI 28mm 2Nm	2"	32"	12"	112"	132"	1/8" bracket-to-bracket	1 1/8" fabric	1 1/4" fabric only
R-TEC LI 35mm 3Nm	2 3/8"	42"	12"	144"	132"	1/8" bracket-to-bracket	1 1/8" fabric	1" fabric only

AUTOMATE®

MOTORIZATION (Open Roll)
LI-Ion Rechargeable Motorization

Automate® LI 25mm 1.1Nm	1 1/4"	21"	12"	72"	84"	1/8" bracket-to-bracket	1 1/8" fabric	1 1/4" fabric only
Automate® LI 25mm 1.1Nm	1 1/2"	29 1/2"	12"	108"	120"	1/8" bracket-to-bracket	1 1/8" fabric	1 1/4" fabric only
Automate® LI 28mm 2Nm	1 1/2"	29 1/2"	12"	108"	120"	1/8" bracket-to-bracket	1 1/8" fabric	1 1/4" fabric only
Automate® LI 28mm 2Nm	2"	32"	12"	120"	132"	1/8" bracket-to-bracket	1 1/8" fabric	1 1/4" fabric only
Automate® LI 35mm 3Nm	2 3/8"	42"	12"	120"	132"	1/8" bracket-to-bracket	1 1/8" fabric	1" fabric only
Automate® LI 45mm 3Nm	2 1/2"	42"	12"	144"	144"	1/8" bracket-to-bracket	2 1/4" fabric	2 1/8" fabric only
Automate® LI 45mm 3Nm	3 1/4"	42"	12"	165"	144"	1/8" bracket-to-bracket	2 1/4" fabric	2 3/8" fabric only
Automate® LI 45mm 3Nm	1 1/4"	21"	12"	72"	84"	1/8" bracket-to-bracket	1 3/8" fabric	1 1/4" fabric only
Automate® LI 45mm 10Nm	1 1/2"	29 1/2"	12"	108"	120"	1/8" bracket-to-bracket	1 3/8" fabric	1 1/4" fabric only
Automate® LI 45mm 10Nm	2"	32"	12"	120"	120"	1/8" bracket-to-bracket	1 3/8" fabric	1 1/4" fabric only
Automate® LI 45mm 10Nm	3 1/4"	42"	12"	165"	144"	1/8" bracket-to-bracket	2 1/4" fabric	2 3/8" fabric only

PRODUCT SPECIFICATIONS

NON-MOTORIZED SHADES

PRODUCT TYPE	ROLLER TUBE SIZE	MINIMUM WIDTH	MINIMUM HEIGHT	MAXIMUM WIDTH	MAXIMUM HEIGHT	INSIDE MOUNT ALLOWANCE		OUTSIDE MOUNT ALLOWANCE
Clutch Roller (Open Roll)	1¼"	12"	12"	72"	96"	1⁄8" bracket-to-bracket	1⅜" fabric	1" fabric only
	1½"	12"	12"	108"	120"	1⁄8" bracket-to-bracket	1¼" fabric	1⅛" fabric only
	2"	12"	12"	118"	144"	1⁄8" bracket-to-bracket	1¼" fabric	1⅛" fabric only
Cordless Lift (non cassette)	1½"	26"	12"	96"	96"	1⁄8" bracket-to-bracket	⅝" fabric	¾" fabric only
Cordless Lift w/ Cassette 100	1½"	26"	12"	96"	96"	1⁄8" bracket-to-bracket	⅞" fabric	¾" fabric only
Cordless Lift w/ Cassette 120	1½"	width 26"-30" - max height 72"				1⁄8" bracket-to-bracket	N/A	N/A
Cordless Ultra w/ Square Cassette 100	1½"	width 26"-30" - max height 72"				1⁄8" bracket-to-bracket	N/A	N/A

CASSETTE 100

*Clutch – up to 72"w	1 ¹ / ₄ "	12"	12"	72"	84"	1 ¹ / ₈ " endcap-to-endcap	1 ¹ / ₄ " fabric	1 ¹ / ₈ " fabric only
72"-96"w	1 ¹ / ₂ "	12"	12"	108"	96"	1 ¹ / ₈ " endcap-to-endcap	1 ¹ / ₄ " fabric	1 ¹ / ₈ " fabric only

CASSETTE 110/120

*Clutch – up to 72"w	1 ¹ / ₄ "	12"	12"	96"	84"	1 ¹ / ₈ " endcap-to-endcap	1 ¹ / ₈ " fabric	1" fabric only
72"-108"w	1 ¹ / ₂ "	12"	12"	108"	120"	1 ¹ / ₈ " endcap-to-endcap	1 ¹ / ₄ " fabric	1 ¹ / ₈ " fabric only

3" SQUARE FASCIA

*Clutch	1 ¹ / ₄ "	12"	12"	72"	84"	1 ¹ / ₈ " endcap-to-endcap	1 ¹ / ₈ " fabric	1 ¹ / ₈ " fabric only
	1 ¹ / ₂ "	12"	12"	108"	84"	1 ¹ / ₈ " endcap-to-endcap	1 ⁵ / ₈ " fabric	1 ⁵ / ₈ " fabric

4" SQUARE FASCIA

*Clutch	1 ¹ / ₄ "	12"	12"	72"	144"	1 ¹ / ₈ " endcap-to-endcap	1 ¹ / ₄ " fabric	1 ¹ / ₈ " fabric only
	1 ¹ / ₂ "	12"	12"	132"	144"	1 ¹ / ₈ " endcap-to-endcap	1 ¹ / ₄ " fabric	1 ¹ / ₈ " fabric only

5" SQUARE FASCIA (SINGLE SHADES)

*Clutch	1 ¹ / ₄ "	12"	12"	72"	144"	1 ¹ / ₈ " endcap-to-endcap	1 ³ / ₈ " fabric	1 ¹ / ₈ " fabric only
	2"	12"	12"	108"	144"	1 ¹ / ₈ " endcap-to-endcap	1 ¹ / ₂ " fabric	1 ¹ / ₂ " fabric only
	3 ¹ / ₄ "	29 ¹ / ₂ "	12"	108"	144"	1 ¹ / ₈ " endcap-to-endcap	1 ³ / ₈ " fabric	1 ¹ / ₄ " fabric only
FASCIA ONLY - 3-4-5"	N/A	12"	N/A	108"	N/A	1 ¹ / ₈ " endcap-to-endcap	N/A	N/A
4" Deco Valance	N/A	12"	N/A	165"	N/A	1 ¹ / ₈ " endcap-to-endcap	N/A	N/A

PRODUCT SPECIFICATIONS

Endcap-to-Endcap/Bracket-to-Bracket vs. Fabric Measurements

- Finished roller shade sizes are based on bracket-to-bracket measurements.
- When ordering an outside mount shade, determine the width you desire the fabric to be and add for the bracket-to-bracket measurement. Contact customer service to order shades with a specific fabric width.
- Additional fabric is added to ordered height to allow for tube wrap.
- How much to add is determined by options selected. Refer to product specifications on **pages 33-35** and add OM allowance to desired fabric width.

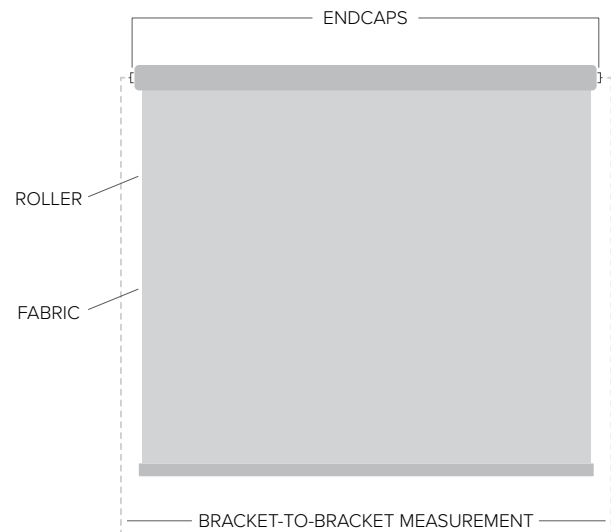

Roller Shade Diameter Consistency

As shades get wider, they require a larger diameter tube roller. When ordering different width shades in the same room the diameter of the raised shade could vary even if the length is similar. If you are not using a valance or fascia and you desire a consistent look, you will need to request the largest roller tube required on your order for all the shades. Price grids outline standard roller tube size.

PRODUCT SPECIFICATIONS

Roll Direction



Standard Roll

- Shade material comes off the back of the roller.
- Recommended for most applications.



Reverse Roll

- Shade material comes off the front of the roller. Leaves noticeable light gap.
- Reverse roll is not available with Facias or Cassette 100/120.

Railroaded Fabrics

Sizes exceeding fabric width are made from railroaded cloth, (when available) using width for height, therefore any pattern will run horizontally. Railroaded fabric will accommodate a wider width shade but will in turn limit the height of the shade to the fabric width minus 12" unless the fabric is seamed. For shades exceeding 132" in width, shade height will be limited to fabric width minus 22".

For multiple shade orders, if one shade on the order is railroaded request factory to railroad all others by room. This is done to ensure the pattern direction will be the same on all shades in the same room.

NOTE: FABRICS THAT ARE RAILROADED MAY CURL ALONG THE EDGES; THIS IS NOT A DEFECT IN THE PRODUCT.

Not all fabrics are suitable for railroading. Check chart on **pages 51-52** for availability.

Seamed Fabrics

Some fabrics are available seamed; two pieces of fabrics are heat-welded together creating a visible horizontal seam toward the top of the shade.

OPERATING OPTIONS

Clutch Roller (Continuous Chain Loop)

- Continuous chain loop clutch system easily lifts large shades while the continuous beaded chain loop remains the same length
- Allows for precise positioning of the shade
- Chain loop is color-coordinated to the fabric or can be coordinated to cassette rail, fascia or hem bar.
- Comes with cord tension device that must be mounted for shade to operate properly. Complies with the new ANSI requirements
- Safety Shroud Chain Cover will come attached to the chain from the factory if requested.



Additional Clutch Options:

Galaxy 200 is a geared clutch that reduces pull force up to approximately 40%

- Requires more rotations to raise and lower the shade.
- Maximum width 132"; 1 1/2" - 2" roller tubes only.
- Bead stops cannot be used with Galaxy clutch.
- Available with 4" fascia and Cassette.

Galaxy 400 is a geared clutch that significantly reduces pull force by 40%.

- Requires more rotations to raise and lower the shade.
- Maximum width 144"; 1 1/2" - 3" roller tubes only.
- Bead stops cannot be used with Galaxy clutch.
- Available with larger tubes, 5" fascia only.

Motorization

- Rechargeable battery options to operate shades up to 144" x 144".
- At least 1 battery charger required per order.
- DC option also available.

Cordless Lift

Great for solar and laminated shades.

Can be ceiling or wall mounted to accommodate all shade installations.

- Minimum 18" x 18". Maximum 96" x 96".
- Uses the 1 1/2" roller tube and can be adjusted for tension and upper limit on site.
- Spring tension is easy to set in shades, will not lose tension as installed and can be easily adjusted on site.
- Available with either cordless lift headrail, cassette 100, 120 or square cassette 110.

DESIGN OPTIONS

Curved Cassette 100/120

Square Cassette 110

Produced as one complete assembly, this system provides easier installation than standard roller and valance options. The rail snaps easily into mounting clips. Shade is concealed when fully raised.

Square cassette 110 available plain or wrapped.

Square cassette 110 dimensions: 3.56" x 3.375"

Available in five colors: white, ivory, black, anodized, and bronze.

Cassette 100 and 120 valance includes a matching fabric insert.

Cassette 100 dimensions: 3.29" d x 3.03" h

Cassette 120 dimensions: 3.93" d x 3.84" h

- Maximum width 108"
- Maximum height – 108"

3", 4" and 5" Square Fascia

Available in five colors: white, ivory, anodized, black and bronze.

- 3" Fascia available up to 108" wide and will accommodate most shades up to 96" in height.
- 4" Fascia available up to 120" wide and will accommodate many shades up to 144" in height.
- 5" Fascia available in white, bronze or anodized. Shades up to 144" wide and will accommodate many shades up to 144" in height. See charts **page 42** for limitations.

- Square fascia cannot get a fabric wrap.

Cordless Lift not available with fascias.

3" Fascia dimensions: 1.5" d x 3.37" h

4" Fascia dimensions: 1.36" d x 3.8" h

5" Fascia dimensions: 2.78" d x 5.15" h

Deco Valance — available in 5 colors: white ivory, anodized, black and bronze

Deco valance provides easier installation than standard roller and valance options. Valance is mounted by snapping onto the T bracket.

- 4" Deco Valance dimensions: 1/4" d x 4 1/4" h
- Corners: 1/4" or 1 7/8"
- Returns: corner piece with tab to connect up to 3 5/8" returns

Internal Heat Sealed Hem Bar - aluminum slat heat-sealed into hem pocket

Aluminum hem - modern aluminum hem bars complete the contemporary look of your roller or solar shade.

Wrapped hem bar - add a matching fabric wrap. The fabric shows on the front while the bar color shows on the back. Wrapped hem bar colors are white, ivory, gray, bronze, and black with a clear end cap.



**INTERNAL
HEAT SEALED
HEM BAR**



**ALUMINUM
HEM BAR**



**FABRIC
WRAPPED
HEM BAR
(AVAILABLE
IN OVAL OR
SQUARE)**

SIDE CHANNELS



*Available for Roller Shades with Internal Hem Bar only

Aluminum Side Channel

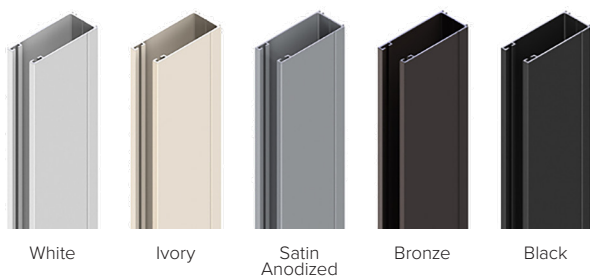

Top and Bottom Endcaps
(Optional)

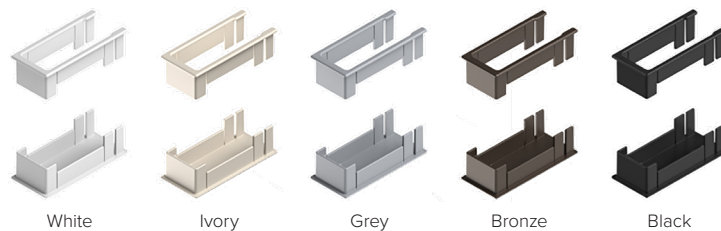

Sill Channel



Minimum & Maximum

Side Channel Length Max	228"
Side Channel Length Min	12" or Min Control Type
Sill Channel Length Max	192"
Side Channel Length Min	12" or Min Control Type

Hardware

(1) Screw Sent for Every 3' of Channel Ordered
Screws are self drilling, channels are not pre-drilled

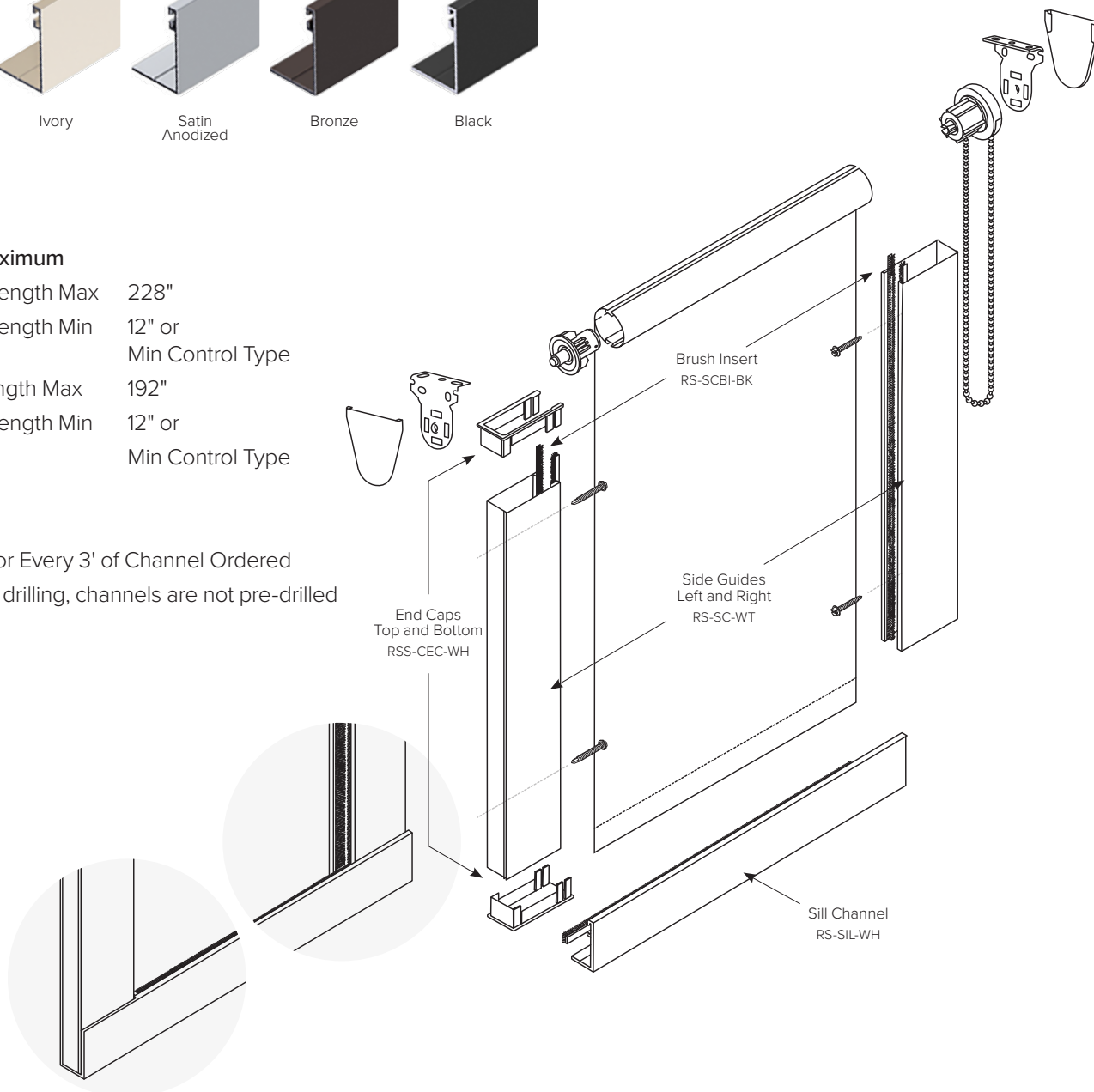

Privacy Strips

Product Information

ELEMENTS® PVC Privacy Strips are a versatile light control and privacy enhancement solution for our ELEMENTS® Custom Roller, Cellular and Twinlight Shades. This rigid PVC material is available in five standard colors and comes with its own (high shear and tack) adhesive foam tape for easy installation on multiple surfaces. The easily removable liner allows for excellent conformability on both smooth and contoured surfaces.

Applications

- Provides additional light block and privacy to most Roller and Cellular Shade window applications.
- Available in five standard colors for coordinating with all of our ELEMENTS® fabrics and colors.
- Includes a factory applied Acrylic Polyethylene Foam Tape for ease of installation (no hardware required).
- Simply order by color, quantity and individual lengths required in inches (min 12"/max 12').

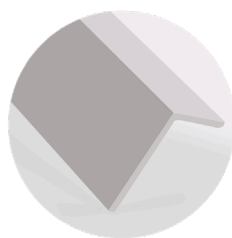
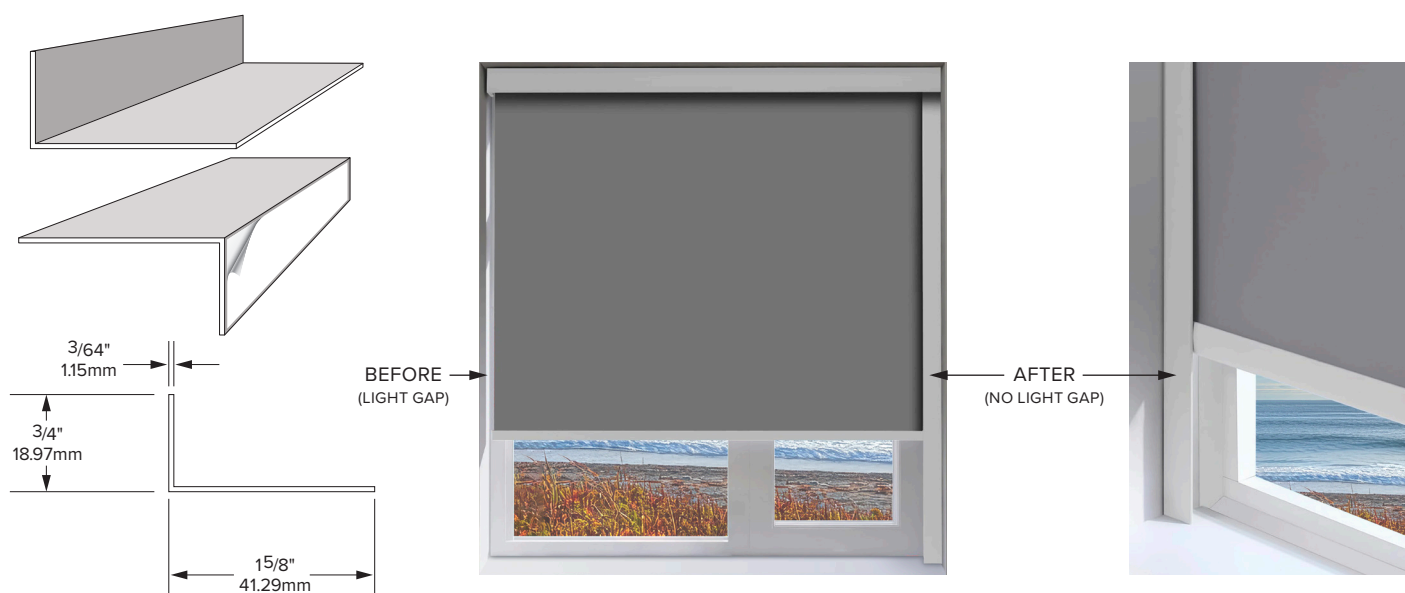

White

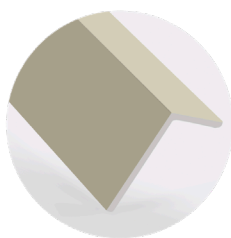

Beige

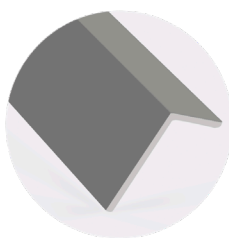

Gray



Dark Bronze

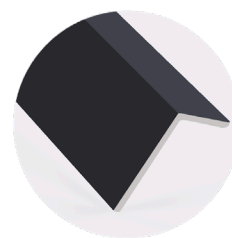

Black

Three year warranty for fading and warping. Ridged PVC that passes 300 hours in QUV using UVA-351 bulbs.

BECOME A
DEALER



SPECIFICATIONS BY FABRIC OR SCREEN

PATTERN	OPACITY						MAXIMUM SHADE SIZE BY FABIC								CORDLESS LIFT		
	LF (LIGHT FILTERING) RD (ROOM DARKENING)	ROLL WIDTH	FABRIC CONTENT	FABRIC WEIGHT OZ PER SQ YD	FLAME RETARDANT	GREENGUARD CERTIFICATIONS	MAXIMUM SHADE SIZE (WITHOUT RAILROADING)	RAILROADING AVAILABLE	MAXIMUM SHADE SIZE 1 1/4" TUBE (NO HORIZONTAL SEAM)	MAXIMUM SHADE SIZE 1 1/2" TUBE (NO HORIZONTAL SEAM)	MAXIMUM SHADE SIZE 2" TUBE (NO HORIZONTAL SEAM)	MAXIMUM SHADE SIZE 2 3/8" TUBE	SEAM AVAILABLE	MAXIMUM SHADE SIZE (VISIBLE HORIZONTAL SEAM)	MAXIMUM SHADE SIZE (RAILROADED AND/OR SEAMED)	MAXIMUM SHADE SIZE (WITHOUT RAILROADING)	MAXIMUM SHADE SIZE (RAILROADED AND/OR SEAMED)

DECORATIVE ROLLER FABRICS (ECHO COLLECTION)

7250	LF	120"	100% Polyester	12	N	Y	114x 96	N	72x 96	108x 120	118x 144	144x 144	N	NA	96x 96	96x 96	96x 96
7200	RD	120"	100% Polyester	12	N	Y	114x 96	N	72x 96	108x 120	118x 144	144x 144	N	NA	96x 96	96x 96	96x 96
7450	LF	120"	100% Polyester	12.5	N	Y	114x 96	N	72x 96	108x 120	118x 144	144x 144	N	NA	96x 96	96x 96	96x 96
7400	RD	120"	100% Polyester	12.5	N	Y	114x 96	N	72x 96	108x 120	118x 144	144x 144	N	NA	96x 96	96x 96	96x 96
7750	LF	120"	100% Polyester	12	N	Y	118x 96	N	72x 96	108x 120	118x 144	144x 144	N	NA	96x 96	96x 96	96x 96
7700	RD	120"	100% Polyester	12	N	Y	118x 96	N	72x 96	108x 120	118x 144	144x 144	N	NA	96x 96	96x 96	96x 96
7850	LF	120"	100% Polyester	4.5	Y	Y	96x 144	N	94x 120	94x 144	94x 144	94x 144	N	144x 144	96x 96	94x 96	96x 96
7800	RD	120"	100% Polyester	4.5	Y	Y	96x 144	N	94x 120	94x 144	94x 144	94x 144	N	144x 144	96x 96	94x 96	96x 96
Balmoral	LF	120"	100% Polyester	9	N	Y	110x 144	N	72x 96	108x 120	110x 144	110x 144	N	NA	NA	96x 96	NA
Balmoral	RD	120"	100% Polyester	9	N	Y	110x 144	N	72x 96	108x 120	110x 144	110x 144	N	NA	NA	96x 96	NA
Bouclé	LF	120"	100% Polyester	12	N	Y	114x 144	N	72x 96	108x 120	110x 144	114x 144	N	NA	NA	96x 96	NA
Bouclé	RD	120"	100% Polyester	12	N	Y	114x 144	N	72x 96	108x 120	110x 144	114x 144	N	NA	NA	96x 96	NA
Lima	LF	120"	100% Polyester	6	N	Y	118x 144	Y	72x 96	108x 120	118x 144	118x 144	Y	144x 144	96x 96	96x 96	96x 96
Lima	RD	120"	100% Polyester	6	N	Y	118x 144	Y	72x 96	108x 120	118x 144	118x 144	Y	144x 144	96x 96	96x 96	96x 96
Lino	LF	120"	100% Polyester	12	N	Y	114x 114	Y	72x 96	108x 120	114x 144	114x 144	Y	144x 144	96x 96	96x 96	96x 96
Lino	RD	120"	100% Polyester	12	N	N	114x 114	Y	72x 96	108x 120	114x 144	114x 144	Y	144x 144	96x 96	96x 96	96x 96
Sanctuary	LF	120"	100% Polyester	12.6	N	Y	118x 96	N	72x 96	108x 120	118x 144	114x 144	N	NA	96x 96	96x 96	96x 96
Sanctuary	RD	120"	100% Polyester	12.6	N	Y	118x 96	N	72x 96	108x 120	118x 144	114x 144	N	NA	96x 96	96x 96	96x 96
Shimmering	LF	120"	100% Polyester	10.9	N	Y	118x 96	N	72x 96	108x 120	118x 144	114x 144	N	NA	96x 96	96x 96	96x 96
Shimmering	RD	120"	100% Polyester	10.9	N	Y	118x 96	N	72x 96	108x 120	118x 144	114x 144	N	NA	96x 96	96x 96	96x 96
Silk Bamboo	LF	120"	100% Polyester	10.6	N	Y	102x 96	Y	72x 96	108x 120	118x 144	114x 144	Y	NA	96x 96	96x 96	96x 96
Silk Bamboo	RD	120"	100% Polyester	10.6	N	Y	102x 96	Y	72x 96	108x 120	118x 144	114x 144	Y	NA	96x 96	96x 96	96x 96
Tusk	LF	120"	100% Polyester	21.9	N	Y	118x 96	Y	72x 96	108x 120	118x 144	114x 144	Y	NA	96x 96	96x 96	96x 96
Tusk	RD	120"	100% Polyester	21.9	N	Y	118x 96	Y	72x 96	108x 120	118x 144	114x 144	Y	NA	96x 96	96x 96	96x 96

SPECIFICATIONS BY FABRIC OR SCREEN

PATTERN	OPACITY	FABRIC SPECS					MAXIMUM SHADE SIZE BY FABIC								CORDLESS LIFT		
	LF (LIGHT FILTERING) RD (ROOM DARKENING)	ROLL WIDTH	FABRIC CONTENT	FABRIC WEIGHT OZ PER SQ YD	FLAME RETARDANT	GREENGUARD CERTIFICATIONS	MAXIMUM SHADE SIZE (WITHOUT RAILROADING)	RAILROADING AVAILABLE	MAXIMUM SHADE SIZE 1 ¼" TUBE (NO HORIZONTAL SEAM)	MAXIMUM SHADE SIZE 1 ½" TUBE (NO HORIZONTAL SEAM)	MAXIMUM SHADE SIZE 2" TUBE (NO HORIZONTAL SEAM)	MAXIMUM SHADE SIZE 2 ⅜" TUBE	SEAM AVAILABLE	MAXIMUM SHADE SIZE (VISIBLE HORIZONTAL SEAM)	MAXIMUM SHADE SIZE (RAILROADED AND/OR SEAMED)	MAXIMUM SHADE SIZE (WITHOUT RAILROADING)	MAXIMUM SHADE SIZE (RAILROADED AND/OR SEAMED)

DECORATIVE ROLLER FABRICS

Bliss	LF	118"	100% Polyester	12		Y	118x 96	N	72x 96	108x 120	118x 144	144x 144	N	NA	96x 96	96x 96	96x 96
Bliss	RD	114"	100% Polyester	12		Y	114x 96	N	72x 96	108x 120	118x 144	144x 144	N	NA	96x 96	96x 96	96x 96
Enlighten BO FR	RD	94"	100% Polyester	9	Y	Y	96x 144	Y	94x 120	94x 144	94x 144	94x 144	Y	NA	96x 96	94x 96	96x 96
Enlighten BO	RD	94"	100% Polyester	9		Y	96x 144	Y	94x 120	94x 144	94x 144	94x 144	Y	144x 144	96x 96	94x 96	96x 96
Enlighten FR	LF	94"	100% Polyester	4.5	Y	Y	96x 144	Y	94x 120	94x 144	94x 144	94x 144	Y	144x 144	96x 96	94x 96	96x 96
Essence	LF	110"	100% Polyester	6.25		Y	110x 144	N	72x 96	108x 120	110x 144	110x 144	N	NA	NA	96x 96	NA
Luminate	LF	110"	100% Polyester	9		Y	110x 144	N	72x 96	108x 120	110x 144	110x 144	N	NA	NA	96x 96	NA
Nightfall	RD	114"	100% Polyester	12		Y	114x 144	N	72x 96	108x 120	110x 144	114x 144	N	NA	NA	96x 96	NA
Visulite	LF	118"	100% Polyester	6		Y	118x 144	Y	72x 96	108x 120	118x 144	118x 144	N	NA	NA	96x 96	96x 96
Visulite	RD	114"	100% Polyester	12		Y	114x 114	Y	72x 96	108x 120	114x 144	114x 144	N	NA	NA	96x 96	96x 96

SOLAR ROLLER FABRICS

Screen 1%*	LF	118"	100% Polyester	14		Y	118x 144	Y	72x 96	108x 120	118x 144	118x 144	Y	168x 144	96x 96	96x 96	NA
Screen 3%*	LF	118"	100% Polyester	13		Y	118x 144	Y	72x 96	108x 120	118x 144	118x 144	Y	168x 144	96x 96	96x 96	NA
Screen 5%*	LF	118"	100% Polyester	14		Y	118x 144	Y	72x 96	108x 120	118x 144	118x 144	Y	168x 144	96x 96	96x 96	NA
Design Screen 5%*	LF	118"	100% Polyester	12	Y	Y	118x 144	Y	72x 96	108x 120	118x 144	118x 144	Y	168x 144	96x 96	96x 96	NA
Linen Screen 5%*	LF	118"	100% Polyester	11	Y	Y	118x 144	N	72x 96	108x 120	118x 144	118x 144	N	NA	96x 96	96x 96	NA



*Anti-microbial

SPECIFICATIONS BY TUBE SIZE AND TOP TREATMENT

PATTERN	SPECS BY TUBE SIZE						SPECS BY CASSETTES AND FASCIAS					
	MAXIMUM SHADE SIZE – 1 ¼" TUBE	MAXIMUM SHADE SIZE 1 ½" TUBE	MAXIMUM SHADE SIZE 2" TUBE	MAXIMUM SHADE SIZE 2 ⅜" TUBE – 2 ½" mm only	MAXIMUM SHADE SIZE 3 ¼" TUBE (NO HORIZONTAL SEAM)	MAXIMUM SHADE SIZE 3 ¼" TUBE (VISIBLE HORIZONTAL SEAM)	CASSETTE 100 MAXIMUM HEIGHT	CASSETTE 110 MAXIMUM HEIGHT	CASSETTE 120 MAXIMUM HEIGHT	3" SQUARE FASCIA MAXIMUM HEIGHT	4" SQUARE FASCIA MAXIMUM HEIGHT	5" SQUARE FASCIA MAXIMUM HEIGHT

DECORATIVE ROLLER FABRICS (ECHO COLLECTION)

7250/7200	72x84	108x120	118x132	118x144	118x144	NA	96	96	120	84	120	144
7450/7400	72x84	108x120	118x132	118x144	118x144	NA	96	96	120	84	120	144
7750/7700	72x84	94x120	94x132	94x144	94x144	168x144	96	96	120	84	120	144
7850/7800	72x84	94x120	94x132	94x144	94x144	168x144	96	96	120	84	120	144
Balmoral	72x84	94x120	94x132	94x144	94x144	168x144	96	96	120	84	120	144
Sanctuary	72x84	108x120	110x132	110x144	110x144	NA	96	96	120	84	120	144
Silk Bamboo	72x84	108x120	110x132	110x144	110x144	NA	96	96	120	84	120	144
Shimmering	72x84	108x120	118x132	118x144	118x144	NA	96	96	120	84	120	144
Lima	72x84	108x120	114x132	114x144	114x144	NA	96	96	120	84	120	144
Lino	72x84	108x120	118x132	118x144	118x144	NA	96	96	120	84	120	144
Bouclé	72x84	108x120	114x132	114x144	114x144	NA	96	96	120	84	120	144

Wrapped Deco Valance: Overall width cannot exceed fabric width when railroading is not available.

SPECIFICATIONS BY TUBE SIZE AND TOP TREATMENT

PATTERN	SPECS BY TUBE SIZE						SPECS BY CASSETTES AND FASCIAS					
	MAXIMUM SHADE SIZE – 1 ¼" TUBE	MAXIMUM SHADE SIZE 1 ½" TUBE	MAXIMUM SHADE SIZE 2" TUBE	MAXIMUM SHADE SIZE 2 ¾" TUBE 2 ½" mm only	MAXIMUM SHADE SIZE 3 ¼" TUBE (NO HORIZONTAL SEAM)	MAXIMUM SHADE SIZE 3 ¼" TUBE (VISIBLE HORIZONTAL SEAM)	CASSETTE 100 MAXIMUM HEIGHT	CASSETTE 110 MAXIMUM HEIGHT	CASSETTE 120 MAXIMUM HEIGHT	3" SQUARE FASCIA MAXIMUM HEIGHT	4" SQUARE FASCIA MAXIMUM HEIGHT	5" SQUARE FASCIA MAXIMUM HEIGHT

DECORATIVE ROLLER FABRICS

Bliss	72x84	108x120	118x132	118x144	118x144	NA	96	96	120	84	120	144
Bliss	72x84	108x120	118x132	118x144	118x144	NA	96	96	120	84	120	144
Enlighten BO FR	72x84	94x120	94x132	94x144	94x144	168x144	96	96	120	84	120	144
Enlighten BO	72x84	94x120	94x132	94x144	94x144	168x144	96	96	120	84	120	144
Enlighten FR	72x84	94x120	94x132	94x144	94x144	168x144	96	96	120	84	120	144
Essence	72x84	108x120	110x132	110x144	110x144	NA	96	96	120	84	120	144
Luminate	72x84	108x120	110x132	110x144	110x144	NA	96	96	120	84	120	144
Visulite	72x84	108x120	118x132	118x144	118x144	NA	96	96	120	84	120	144
Visulite	72x84	108x120	114x132	114x144	114x144	NA	96	96	120	84	120	144

SOLAR ROLLER FABRICS

Screen 1%	72x84	108x120	118x132	118x144	118x144	165x144	96	96	120	84	120	144
Screen 3%	72x84	108x120	118x132	118x144	118x144	165x144	96	96	120	84	120	144
Screen 5%	72x84	108x120	118x132	118x144	118x144	165x144	96	96	120	84	120	144
Design Screen 5%	72x84	108x120	118x132	118x144	118x144	165x144	96	96	120	84	120	144
Linen Screen 5%	72x84	108x120	118x132	118x144	118x144	NA	96	96	120	84	120	144

Wrapped Deco Valance: Overall width cannot exceed fabric width when railroading is not available.

PRODUCT COMPONENTS

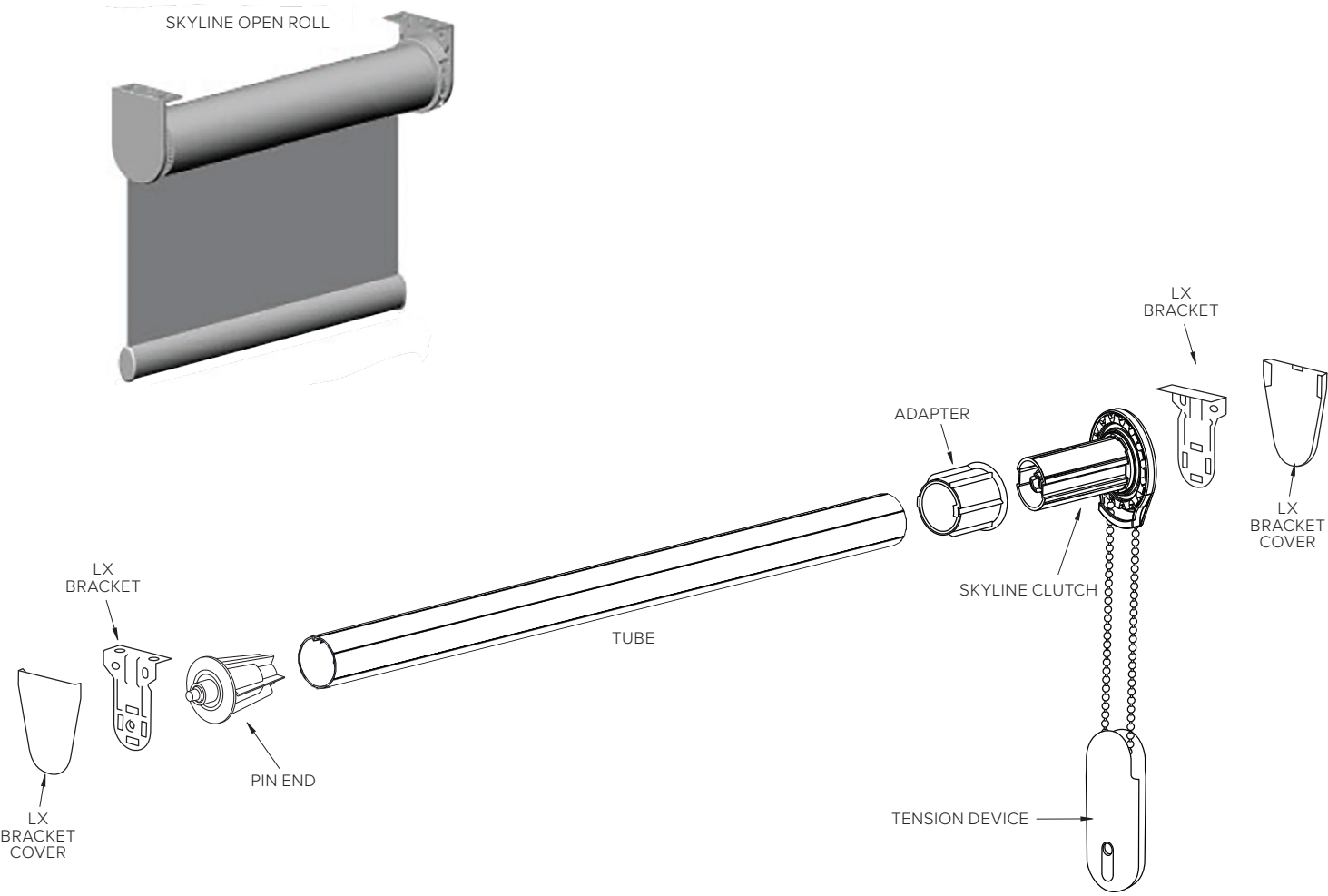

PRODUCT COMPONENTS

Cassette 100/120

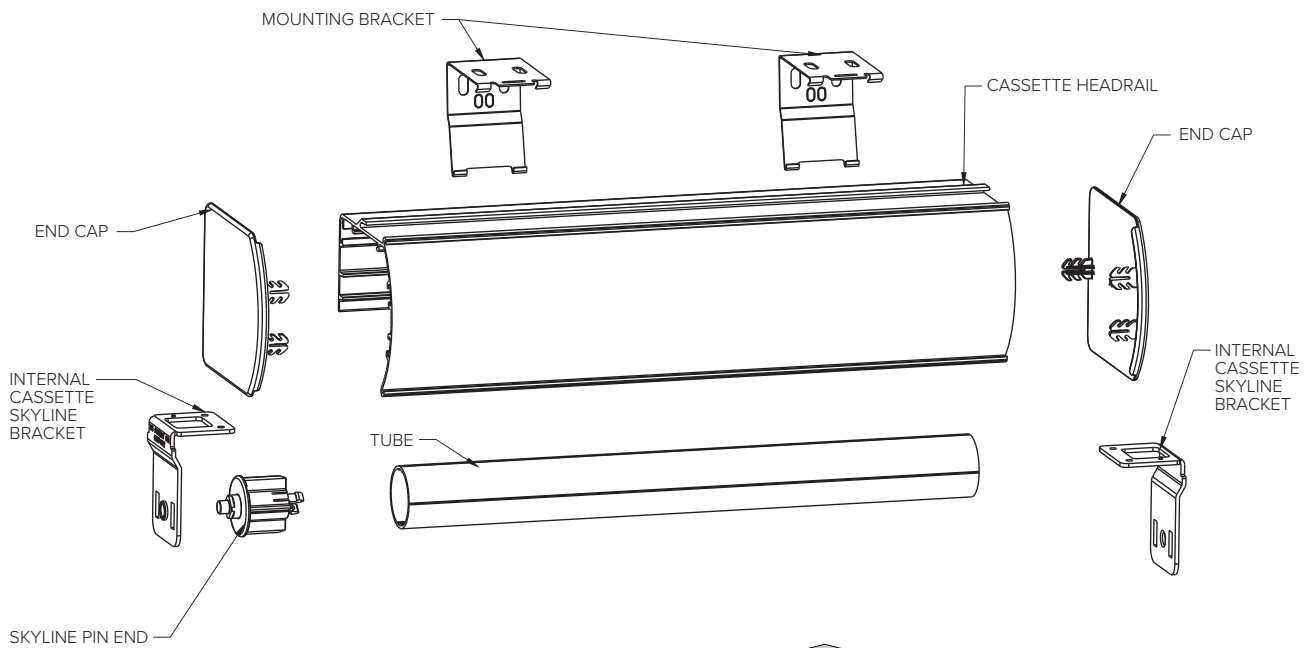

Square Cassette 110

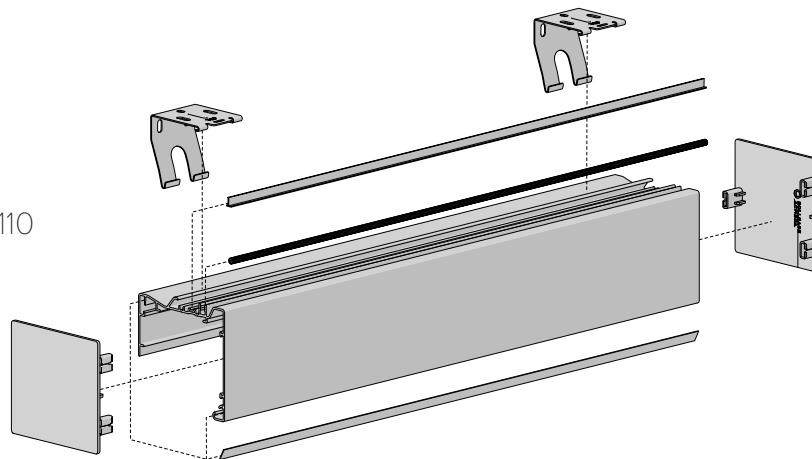

PRODUCT COMPONENTS

3" FASCIA

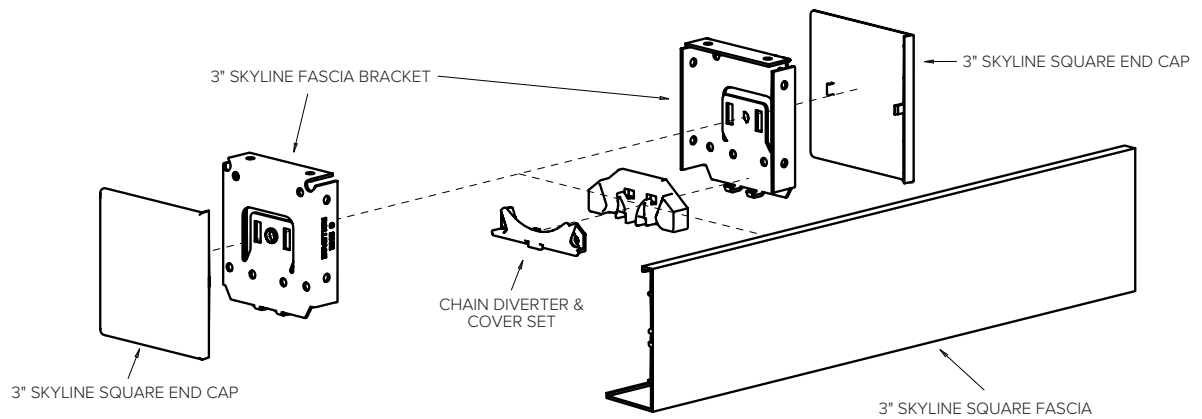

4" FASCIA

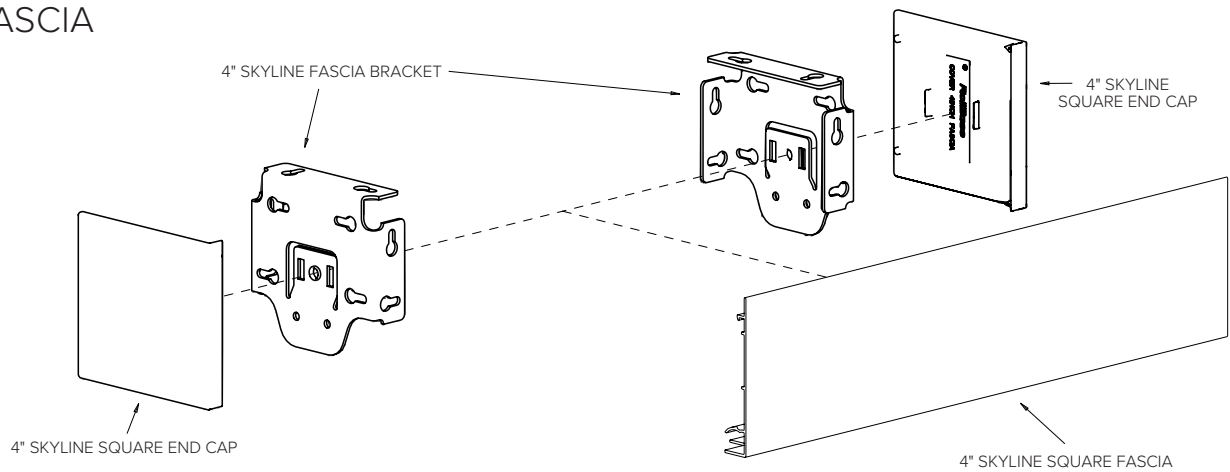

5" FASCIA

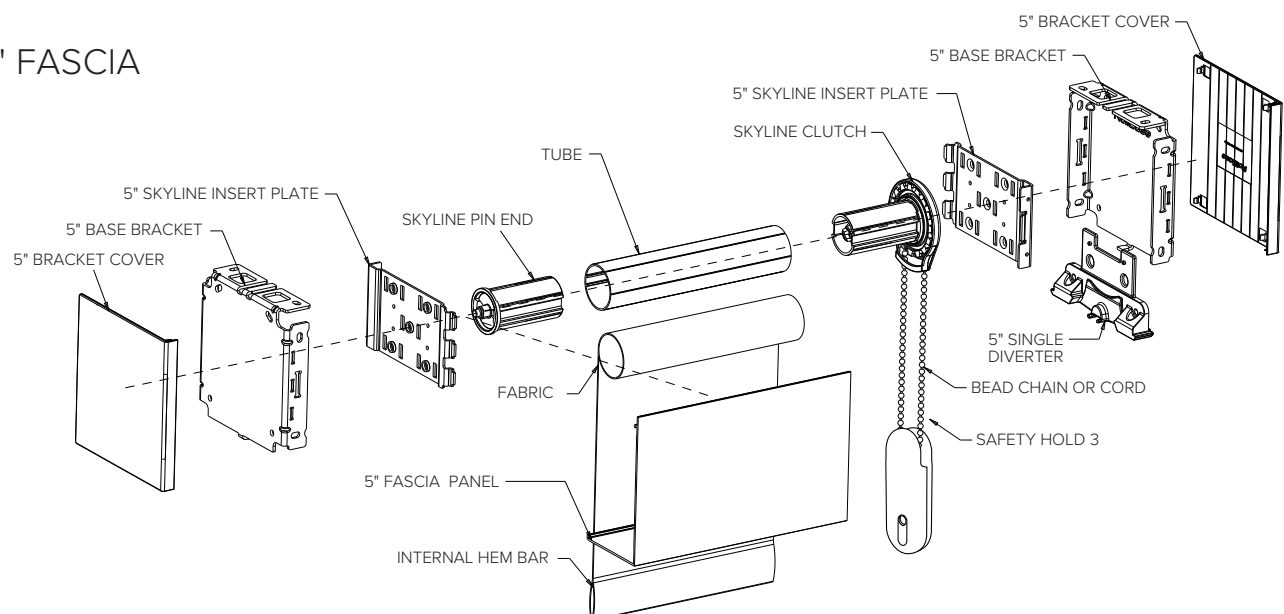

PRODUCT COMPONENTS

CORDLESS LIFT SYSTEM

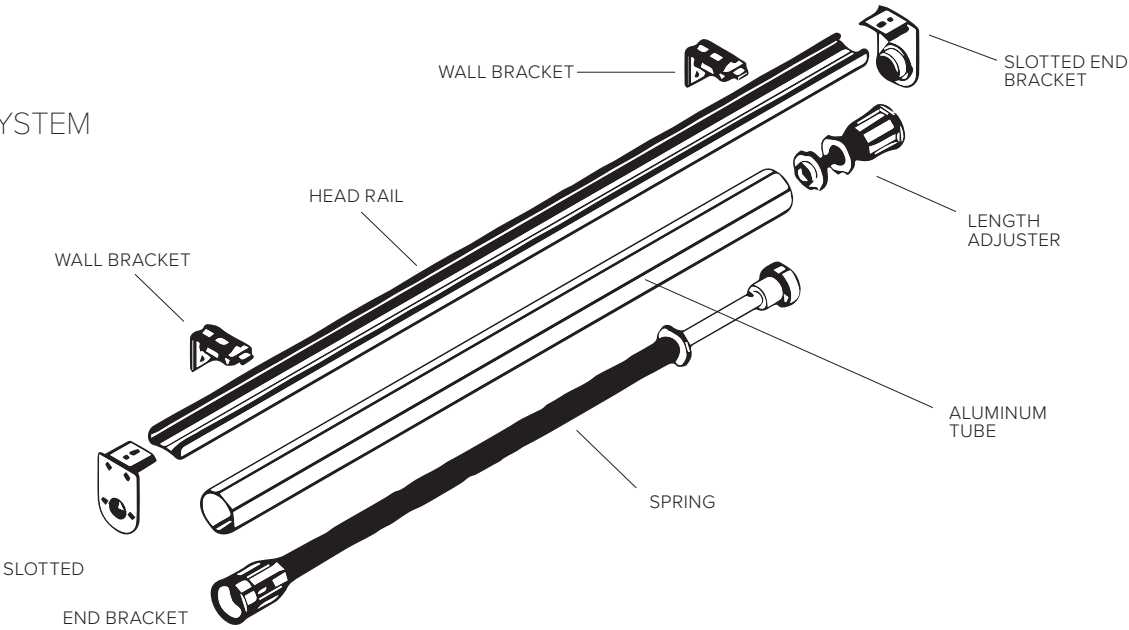

TABLE OF
CONTENTS



Twinlight Shades

Product Specifications 60

Operating Options.....61

Design Options..... 62

Product Components..... 63

PRODUCT SPECIFICATIONS

PRODUCT	MIN WIDTH	MAX WIDTH	MIN HEIGHT	MAX HEIGHT
Clutch Roller	12"	96" *	12"	96"
Rollease Automate 25mm 1.1Nm	29½"	96" *	12"	96"
Two-on-One Headrail – Clutch Roller**	24"	108" – 2 controls	12"	96"
Two-on-One Headrail – Rollease Automate 25mm 1.1Nm	46"	108" – 2 controls	12"	96"

**Two-on-one headrail shades that do not exceed 108" in overall width can achieve alignment within 1/8".

NOTE:

- * We strongly recommend ordering shades larger than 96" wide as two-on-one headrail. This fabric has a natural tendency to have "waves" in either the front or rear fabric in wider shades; this is not considered a defect.
- * Two-on-one shades can be produced to operate with both shades having their own control. 2-on-1 surcharge applies. Control Option Surcharges are double when the shades have two controls.

Shade Deductions

PRODUCT	TUBE SIZE	INSIDE MOUNT ALLOWANCE		OUTSIDE MOUNT ALLOWANCE
Clutch Shades	1½"	1/8" endcap-to-endcap	1⅜" fabric	1¼" fabric only
Motorized Shade	1½"	1/8" endcap-to-endcap	1⅜" fabric	1" fabric only

Depth Requirements

SHADE WIDTH	MIN DEPTH	INSIDE FLUSH MOUNT	OUTSIDE SURFACE
Cassette 100	1⅛"	3⅞"	1½"
Cassette 120	1¼"	4¼"	2½"

*Cassette 100 standard on Twinlight shades

ADJACENT SHADES

- Side-by-side alignment cannot be guaranteed to be an exact match.
- Shades located side-by-side must be specified at time of order to achieve best result.
- Side-by-side shades that do not exceed 108" in overall width can achieve alignment within 1/8".

OPERATING OPTIONS

Clutch Roller (Continuous Chain Loop)

- Provides a smooth, quiet clutch system that aids in operating large shades.
- Allows for precise positioning of the shade.
- Continuous loop control stays the same length (must be secured with cord tension device to operate).
- Sizes up to 108" x 96"
- All cassette options available.

Safety Shroud Chain Cover is optional.

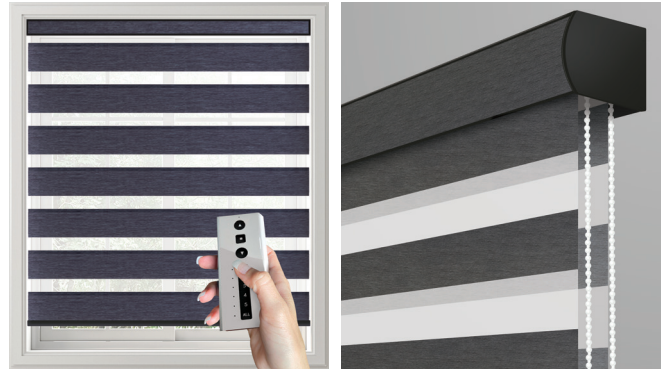

Rechargeable Motorization

- Battery powered motor uses a rechargeable battery hidden inside the roller tube motor.
- Maximum width 108" as a single shade; 108" as 2 independent shades on 1 headrail **
- Maximum height 96". Shade height limitations vary by cassette option. See chart on **pages 53-54**.
- At least 1 battery charger required per order.
- All cassette options available.
- See Motorization pricelist for additional information and pricing.



DESIGN OPTIONS

Cassette 100 & 120

Produced as one complete assembly, this system provides easy installation. The rail snaps easily into mounting clips. Shade is concealed when fully raised.

Cassette valance includes a matching fabric insert and is available in five colors: white, ivory, black, aluminum, and bronze.

Cassette 100 dimensions: 3.29" d x 3.03" h

Cassette 120 dimensions: 3.98" d x 3.84" h

Cassette, chain & hem bar colors are pre-selected.



Hem Options

Aluminum hem bar in five colors: white, ivory, bronze, black and anodized. Standard for most fabrics. There is less gap between the two layers of fabric.



PRODUCT COMPONENTS

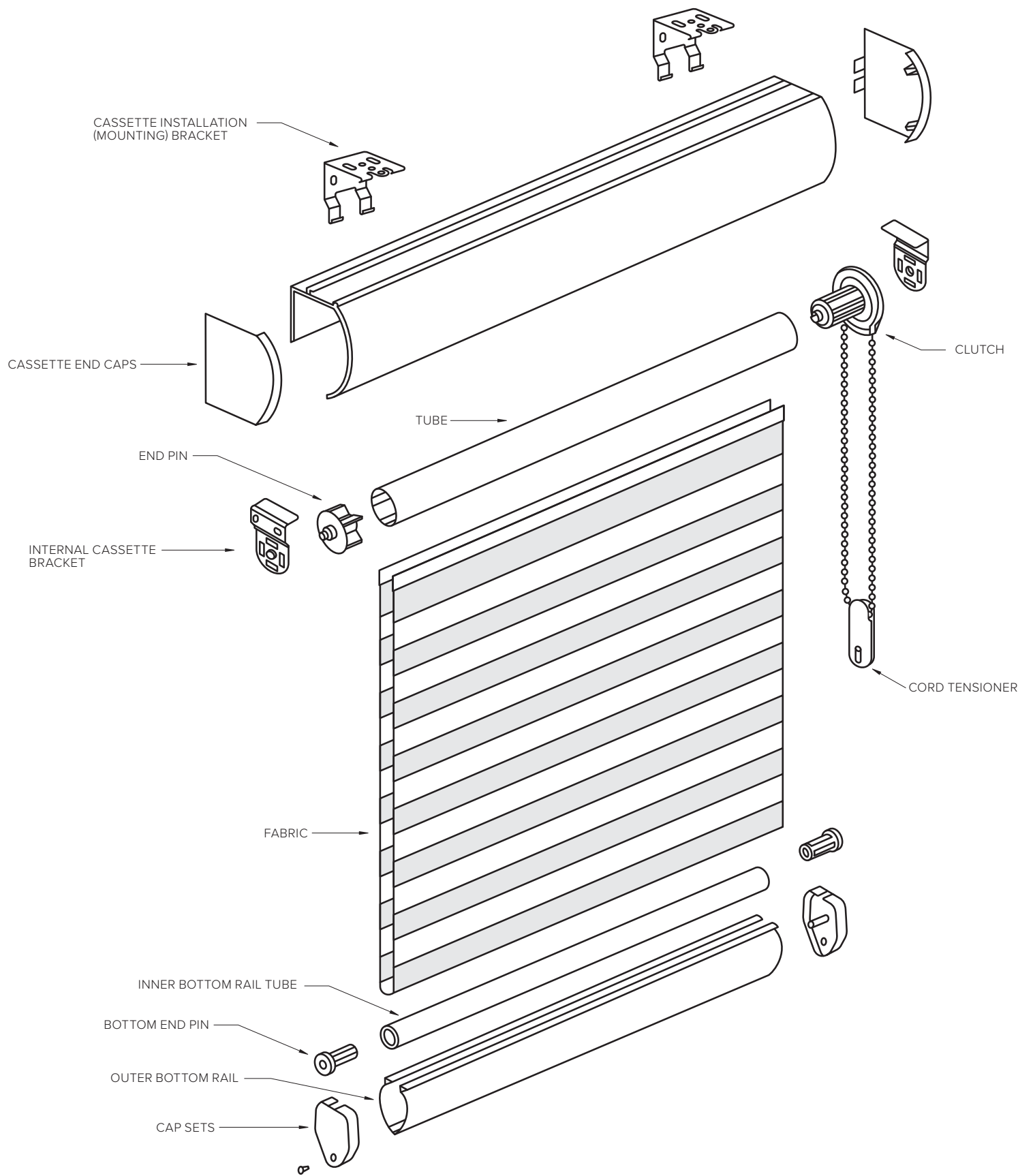

TABLE OF
CONTENTS



Decorative Textile Film

Product Specifications 65

Installation..... 66

PRODUCT SPECIFICATIONS

Why should I use Decorative Textile Film?

Alternative for plastic window foil

- 100% woven fabric with warm and natural feel
- Self-adhesive for fast, easy and quick installation
- Restricts people from looking inside while keeping your outside view

Material

Fabric: 100% woven Polyester

Liner: Polypropylene

Characteristics

- Transparency level: transparent
- Self-adhesive (water-based acrylic pressure sensitive glue)
- Damp-proof
- UV resistant
- Cooling effect
- PVC-free
- Halogen-free
- Interior application only
- Service life: minimum 5 years

Suitable for damp locations

- Fabrics with this finishing ensure the greatest resistance in a warm and humid climate.

Fabric acclimation

Prior to installation, fabric must rest for a least 1 hour outside of its original packaging, at a stable temperature comprised between 59F-71F degrees.

Antibacterial/antifungal

- This fabric has been treated with active agents that prevent the growth of various Micro-organisms and is therefore particularly suitable for application in hospitals, nursing homes, surgeries, laboratories, etc. It can also be used in rooms with high humidity.
- The active agent Sanitized® gets rid of a broad spectrum of the most popular indoor molds and fungi. Sanitized® cannot guarantee that all indoor living mold and fungi species are removed.
- In a very humid environment, the antibacterial properties will deteriorate more quickly.

PVC-free

- For the treatment of this fabric, no use at all was made of PVC, i.e., it's free of any emollients or stabilizers.

Halogen-free

- The fabric has had no treatment containing halogens.

	UV transmission factor					
	Sidewalk	Bone	Linen	Gravity	Stone	Coal
Sheer	46%	49%	42%	42%	38%	38%
Semi-Opaque	16%	13%	10%	10%	7%	7%

DECORATIVE TEXTILE FILM WARRANTY

Rowley Company provides a 5-year Warranty for Decorative Textile Film. This warranty is contingent on the correct installation (via the Installation Instructions for Decorative Textile Film) on a vertical glass surface, without any removal and repositioning of the film after activation of the glue. Strict compliance with the storage, application, installation and maintenance

instructions, is necessary to ensure the service life and Warranty of the Decorative Textile Film.

For additional Warranty information, questions and service, please contact our Customer Service Department. 833-743-1314.

INSTALLATION INSTRUCTIONS



STEP 1 GATHER TOOLS

You will need:

- Alcohol or ammonia based window cleaner and squeegee to degrease the glass
- 30° angle snap blade razor knife
- Sharp scissors
- Smooth, flexible film applicator with both a rounded edge and square edge



STEP 2 CLEAN WINDOW

Carefully clean glass with ammonia or alcohol degreaser and squeegee. Thoroughly dry glass with a fiber-free cloth.

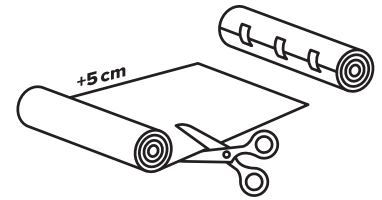

STEP 3 CUT TO SIZE

If installing from a full roll, keep film tightly wrapped on core until ready to cut. Affix tape evenly. Tightly re-wrap any unused film and affix tape evenly.

If installing from pre-cut film, skip to step 4. Measure the glass in height and width. Cut the film evenly, using the grid on the backing, ensuring that the thread is oriented in the same direction for each section of glass.

Keep film tightly wrapped on core until ready to apply. Tightly re-wrap any unused film.

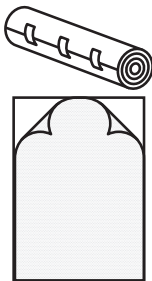

STEP 4 PEEL FILM

Peel off about 8" of the film backing, so that the sticky side is exposed on the back of the film.



Decorative Textile Film is a dry application. **DO NOT** wet glass or film when installing.

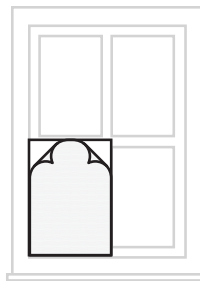

STEP 5 STICK 8" OF FILM

Carefully center and stick the 8" of film, without backing, to the top of the glass. Overlap the silicone or molding approximately 1" to 2" on all sides, so that the film is now hanging on the window freely with backing underneath.

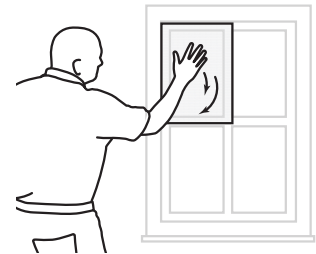

STEP 6 PEEL AND STICK

Peel off the backing incrementally from underneath. About every 8", use your hands to apply pressure from the center outward, and from the top to the bottom of the glass.

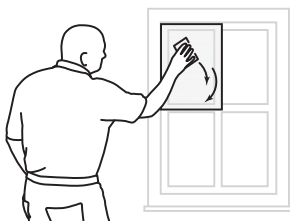

STEP 7 ACTIVATE GLUE

Once all of the backing is gone and the film is perfectly flat to the glass, use the application tool's rounded corner side to press the film against the glass firmly applying approximately 20 lbs of pressure. The pressure of the application tool will activate the glue. Ensure that the entire surface is activated.

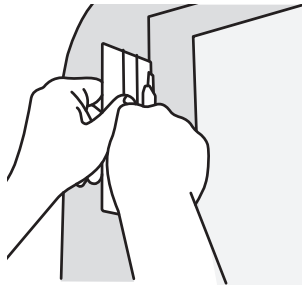

STEP 8 CUT EDGES

Place the application tools square corner side against the silicone edge or molding of the window and hold the blade against the inside of the application tool. Cut off the 1" to 2" of excess film along each side of the window. Do not overlap the silicone with the film.



Use a new blade every 6' to prevent fraying.

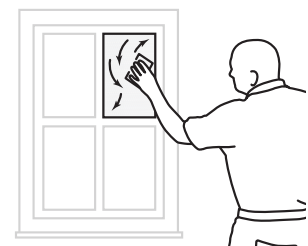

STEP 9 FINISH UP

Press the film again, both horizontally and vertically over the entire surface to activate all the adhesive. Use care not to crease or snag the film.

YOU'RE DONE!

HOW TO PROPERLY SEAM

TRIPLE LAYER METHOD FOR SEAMING OVERSIZED GLASS

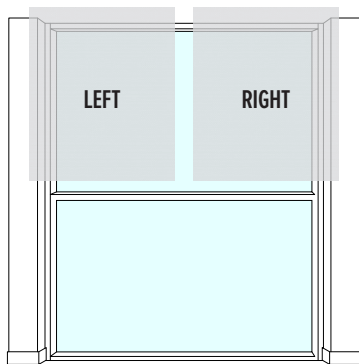
**STEP 1**

Clean and degrease the glass.

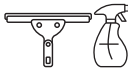

Cut two even sections of film to overlap the sides and center of glass. Ensure that left and right pieces are cut from a single piece of film, and are correctly oriented—fabric is directional and must align.

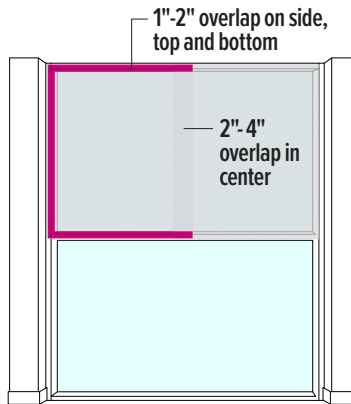
**STEP 2**

Hang the left and right sections ensuring they are even and level. Start with the left side, using the proper installation procedures for film without a seam. Hang the right side, ensuring proper alignment and overlap in the center. There should now be a **total of 2\" to 4\" of overlap** in the center.

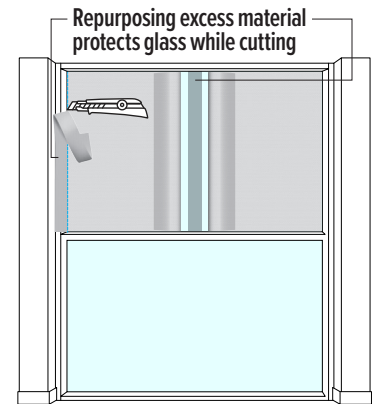
**STEP 3**

Trim the excess film around the glass area and save the left and right pieces of excess film. Carefully peel back the center left and right edges to expose approximately 4\" to 6\" of glass. Use the excess film to piece and apply to the center of the exposed glass. Carefully re-apply the left and right edges of film, evenly overlapping the excess film piece.

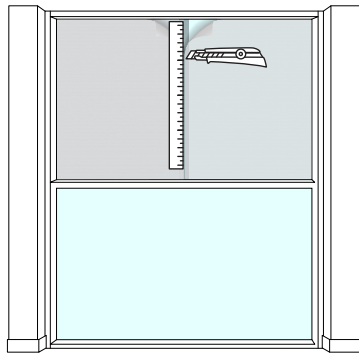
**STEP 4**

Using a straight edge, carefully cut completely through all three layers of fabric at the center.

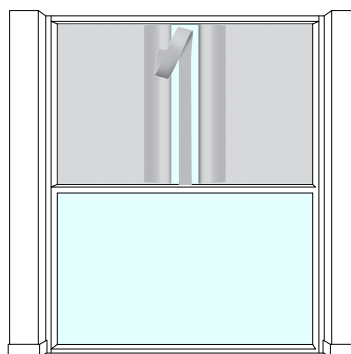
**STEP 5**

Carefully peel back the left and right sides of the cut that was just made and remove the excess film pieces from the center of the exposed glass.

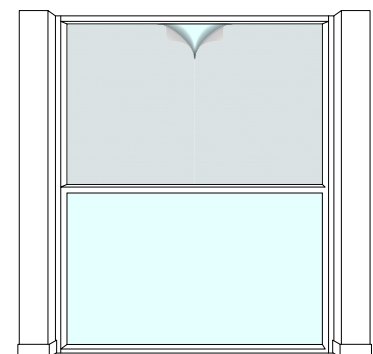
**STEP 6**

Re-apply the left and right pieces of film at the center. Complete steps 1-6 for all openings that are being seamed. Ensure that there are no remaining bubbles or creases.

YOU'RE DONE!

TABLE OF
CONTENTS



Cellular Shades

Product Specifications68

Operating Options.....69

Fabric Width, Rail Coordination Chart,
Price Group70-74

Stack Chart.....74

Product Components.....75-76

PRODUCT SPECIFICATIONS

Cellular Shades

PRODUCT	MIN WIDTH	MAX WIDTH	MIN HEIGHT	MAX HEIGHT
Cordless Lift	12"	96"	12"	84" (Over 84", Motorized Only)
Cordless Lift (TDBU)	18"	96"	8"	84" (Over 84", Motorized Only)
2 on 1 Headrail	24"	up to 144"	12"	84" (Over 84", Motorized Only)
Motorized	20"	120"	18"	96"

*Hold Down brackets, Extension brackets, and Spacer blocks- available upon request

DEPTH REQUIREMENTS

PRODUCT	MIN DEPTH	FLUSH DEPTH REQUIREMENT	OM MINIMUM MOUNTING SURFACE HEIGHT
Cellular Shades	7/8"	2 ³ / ₈ "	1 ⁵ / ₈ "
2 on 1 Headrail	7/8"	2 ³ / ₈ "	1 ⁵ / ₈ "
Motorized	7/8"	2 ³ / ₈ "	1 ⁵ / ₈ "

FACTORY DEDUCTIONS

Inside Mount (IM) measurements represent the exact window opening size, the factory will make the following deductions to ensure a proper fit. Outside Mount (OM) measurements represent the exact blind size needed. No allowances will be made by the factory.

PRODUCT	IM DEDUCTIONS		IM DEDUCTIONS	OM DEDUCTIONS	OM DEDUCTIONS
	WIDTH		HEIGHT	WIDTH	HEIGHT
Cordless	3/8" Rail	1/2" Fabric	None	3/8" Fabric Only	None
Cordless TDBU	3/8" Rail	1/2" Fabric	None	3/8" Fabric Only	None
Motorized	3/8" Rail	1/2" Fabric	None	3/8" Fabric Only	None

*3/8" Rail deduction includes endcaps

OPERATING OPTIONS



Cordless Lift

- Lift and lower the shade by slowly raising or lowering the bottom rail.



Top Down/Bottom UP (TDBU)

Top-Down feature lets you lower the top of the shade while Bottom Up allows the shade to be raised from the bottom at the same time.

Available in:

- Top Down/Bottom Up (TDBU) shades feature a magnetic catch to eliminate light gap between the headrail and moving middle rail.
- Cordless



Motorization

- Rollease Automate available as Standard bottom up only.
- Radio Frequency with Li-Ion DC external battery pack.
- Shades up to 120" x 96"
- At least 1 battery charger required per order.
- See Motorization pricelist for more information and pricing.

PRODUCT STACKING CONSIDERATIONS

The Stacking Chart shows approximately how much of your window area will be covered when your window treatment is fully drawn open. If you feel too much of the window will be covered, consider Outside Mount. If space allows, mounting brackets can be raised higher above the window frame to reduce the area covered by the treatment.

Product stack charts can be found in cellular shade section on **page 63**.

FABRIC WIDTH/RAIL COORDINATION CHART/PRICE GROUP

CELL SIZE	OPACITY	SINGLE CELL	PATTERN NAME	COLOR	COLOR #	FABRIC WIDTH	HEADRAIL COLOR	HEADRAIL COLOR #	BOTTOM RAIL COLOR #
3/4"	Light Filtering	S	Denim LF	Antique White	C1-702	144"	Latte	CH-14	CB-14
3/4"	Light Filtering	S	Denim LF	Mint	C1-701	144"	Fern	CH-27	CB-27
3/4"	Light Filtering	S	Denim LF	Wet Pavement	C1-703	144"	Silver	CH-15	CB-15
3/4"	Room Darkening	S	Denim RD	Bay Sands	C2-802	144"	Rocky Bluffs	CH-23	CB-23
3/4"	Room Darkening	S	Denim RD	Dog Park	C2-801	144"	Fern	CH-27	CB-27
3/4"	Room Darkening	S	Denim RD	Yachtsman	C2-803	144"	Ultra White	CH-20	CB-20
3/4"	Light Filtering	S	Linen LF	City Storm	C1-403	144"	Silver	CH-15	CB-15
3/4"	Light Filtering	S	Linen LF	Filtered Shade	C1-404	144"	Latte	CH-14	CB-14
3/4"	Light Filtering	S	Linen LF	Sidewalk	C1-401	144"	Latte	CH-14	CB-14
3/4"	Light Filtering	S	Linen LF	Stone Manor	C1-405	144"	Muddy Water	CH-19	CB-19
3/4"	Light Filtering	S	Linen LF	Voyage	C1-402	144"	Autumn Fog	CH-11	CB-11
3/4"	Room Darkening	S	Linen RD	Deep Sliver	C2-303	144"	Midnight Fog	CH-17	CB-17
3/4"	Room Darkening	S	Linen RD	Earth	C2-301	144"	Latte	CH-14	CB-14
3/4"	Room Darkening	S	Linen RD	Misty	C2-304	144"	Cream	CH-16	CB-16
3/4"	Room Darkening	S	Linen RD	Pewter	C2-305	144"	Muddy Water	CH-19	CB-19
3/4"	Room Darkening	S	Linen RD	Ship Gray	C2-302	144"	Autumn Fog	CH-11	CB-11
3/4"	Light Filtering	S	Luxe LF	Almond	C1-108	118"	Clay	CH-28	CB-28
3/4"	Light Filtering	S	Luxe LF	Beneva	C1-130	118"	Autumn Fog	CH-11	CB-11
3/4"	Light Filtering	S	Luxe LF	Blanched Time	C1-102	118"	Bistro White	CH-22	CB-22
3/4"	Light Filtering	S	Luxe LF	Blue Ocean	C1-132	118"	Iron Frost	CH-18	CB-18

FABRIC WIDTH/RAIL COORDINATION CHART/PRICE GROUP

CELL SIZE	OPACITY	SINGLE CELL	PATTERN NAME	COLOR	COLOR #	FABRIC WIDTH	HEADRAIL COLOR	HEADRAIL COLOR #	BOTTOM RAIL COLOR #
3/4"	Light Filtering	S	Luxe LF	Bright White	C1-122	118"	Ultra White	CH-20	CB-20
3/4"	Light Filtering	S	Luxe LF	City Storm	C1-129	118"	Silver	CH-15	CB-15
3/4"	Light Filtering	S	Luxe LF	Coastal Villa	C1-120	118"	Coco	CH-24	CB-24
3/4"	Light Filtering	S	Luxe LF	Cream	C1-107	118"	Bistro White	CH-22	CB-22
3/4"	Light Filtering	S	Luxe LF	Deep Walnut	C1-112	118"	Coco	CH-24	CB-24
3/4"	Light Filtering	S	Luxe LF	Dew Kissed	C1-104	118"	Tranquil White	CH-25	CB-25
3/4"	Light Filtering	S	Luxe LF	Fox Trot	C1-105	118"	Tranquil White	CH-25	CB-25
3/4"	Light Filtering	S	Luxe LF	Gray	C1-117	118"	Midnight Fog	CH-17	CB-17
3/4"	Light Filtering	S	Luxe LF	Hopsack	C1-127	118"	Silver	CH-15	CB-15
3/4"	Light Filtering	S	Luxe LF	Khaki	C1-114	118"	Muddy Water	CH-19	CB-19
3/4"	Light Filtering	S	Luxe LF	Lava	C1-121	118"	Midnight Fog	CH-17	CB-17
3/4"	Light Filtering	S	Luxe LF	Leather	C1-109	118"	Latte	CH-14	CB-14
3/4"	Light Filtering	S	Luxe LF	Milk Toast	C1-126	118"	Silver Leaf	CH-21	CB-21
3/4"	Light Filtering	S	Luxe LF	Mudslide	C1-111	118"	Rocky Bluffs	CH-23	CB-23
3/4"	Light Filtering	S	Luxe LF	Mystique	C1-123	118"	Ultra White	CH-20	CB-20
3/4"	Light Filtering	S	Luxe LF	Night Sky	C1-133	118"	Iron Frost	CH-18	CB-18
3/4"	Light Filtering	S	Luxe LF	Parchment Gold	C1-110	118"	Latte	CH-14	CB-14
3/4"	Light Filtering	S	Luxe LF	Sable	C1-113	118"	Black	CH-12	CB-12
3/4"	Light Filtering	S	Luxe LF	Sandcastle	C1-106	118"	Cream	CH-16	CB-16
3/4"	Light Filtering	S	Luxe LF	Silver Bullet	C1-116	118"	Silver	CH-15	CB-15

FABRIC WIDTH/RAIL COORDINATION CHART/PRICE GROUP

CELL SIZE	OPACITY	SINGLE CELL	PATTERN NAME	COLOR	COLOR #	FABRIC WIDTH	HEADRAIL COLOR	HEADRAIL COLOR #	BOTTOM RAIL COLOR #
3/4"	Light Filtering	S	Luxe LF	Sparkling Lake	C1-118	118"	Dewkissed White	CH-26	CB-26
3/4"	Light Filtering	S	Luxe LF	Stillness	C1-103	118"	Dewkissed White	CH-26	CB-26
3/4"	Light Filtering	S	Luxe LF	Subway Tile	C1-101	118"	Ultra White	CH-20	CB-20
3/4"	Light Filtering	S	Luxe LF	Summer Wish	C1-125	118"	Rocky Bluffs	CH-23	CB-23
3/4"	Light Filtering	S	Luxe LF	Twilight	C1-131	118"	Silver Leaf	CH-21	CB-21
3/4"	Light Filtering	S	Luxe LF	Wafer	C1-124	118"	Cream	CH-16	CB-16
3/4"	Light Filtering	S	Luxe LF	Wild Basil	C1-115	118"	Fern	CH-27	CB-27
3/4"	Light Filtering	S	Luxe LF	Wild Hawk	C1-119	118"	Rocky Bluffs	CH-23	CB-23
3/4"	Light Filtering	S	Luxe LF	Withered Moss	C1-128	118"	Mint	CH-13	CB-13
3/4"	Room Darkening	S	Luxe RD	Artic White	C2-203	118"	Dewkissed White	CH-26	CB-26
3/4"	Room Darkening	S	Luxe RD	Balcony	C2-220	118"	Coco	CH-24	CB-24
3/4"	Room Darkening	S	Luxe RD	Borough	C2-227	118"	Silver	CH-15	CB-15
3/4"	Room Darkening	S	Luxe RD	Café Miel	C2-208	118"	Clay	CH-28	CB-28
3/4"	Room Darkening	S	Luxe RD	City Snow	C2-204	118"	Tranquil White	CH-25	CB-25
3/4"	Room Darkening	S	Luxe RD	Color of Money	C2-228	118"	Mint	CH-13	CB-13
3/4"	Room Darkening	S	Luxe RD	Crisp Linen	C2-206	118"	Cream	CH-16	CB-16
3/4"	Room Darkening	S	Luxe RD	Dogwood Petal	C2-207	118"	Bistro White	CH-22	CB-22
3/4"	Room Darkening	S	Luxe RD	Fishermans Warf	C2-216	118"	Silver	CH-15	CB-15
3/4"	Room Darkening	S	Luxe RD	Fleecy	C2-205	118"	Tranquil White	CH-25	CB-25
3/4"	Room Darkening	S	Luxe RD	Foggy Mist	C2-229	118"	Silver	CH-15	CB-15

FABRIC WIDTH/RAIL COORDINATION CHART/PRICE GROUP

CELL SIZE	OPACITY	SINGLE CELL	PATTERN NAME	COLOR	COLOR #	FABRIC WIDTH	HEADRAIL COLOR	HEADRAIL COLOR #	BOTTOM RAIL COLOR #
3/4"	Room Darkening	S	Luxe RD	Granola	C2-209	118"	Latte	CH-14	CB-14
3/4"	Room Darkening	S	Luxe RD	Harbor View	C2-232	118"	Iron Frost	CH-18	CB-18
3/4"	Room Darkening	S	Luxe RD	Irish Pub	C2-215	118"	Fern	CH-27	CB-27
3/4"	Room Darkening	S	Luxe RD	Keystone	C2-225	118"	Rocky Bluffs	CH-23	CB-23
3/4"	Room Darkening	S	Luxe RD	Loft Light	C2-223	118"	Ultra White	CH-20	CB-20
3/4"	Room Darkening	S	Luxe RD	Midnight Bayou	C2-233	118"	Iron Frost	CH-18	CB-18
3/4"	Room Darkening	S	Luxe RD	Mink	C2-214	118"	Muddy Water	CH-19	CB-19
3/4"	Room Darkening	S	Luxe RD	Muted Ebony	C2-213	118"	Black	CH-12	CB-12
3/4"	Room Darkening	S	Luxe RD	Paparazzi	C2-222	118"	Ultra White	CH-20	CB-20
3/4"	Room Darkening	S	Luxe RD	Pier 14	C2-221	118"	Midnight Fog	CH-17	CB-17
3/4"	Room Darkening	S	Luxe RD	Portland	C2-219	118"	Rocky Bluffs	CH-23	CB-23
3/4"	Room Darkening	S	Luxe RD	Rain Puddle	C2-217	118"	Midnight Fog	CH-17	CB-17
3/4"	Room Darkening	S	Luxe RD	Safari Beige	C2-212	118"	Coco	CH-24	CH-24
3/4"	Room Darkening	S	Luxe RD	Sandy Cove	C2-210	118"	Latte	CH-14	CB-14
3/4"	Room Darkening	S	Luxe RD	Sauna	C2-218	118"	Dewkissed White	CH-26	CB-26
3/4"	Room Darkening	S	Luxe RD	Silk	C2-224	118"	Cream	CH-16	CB-16
3/4"	Room Darkening	S	Luxe RD	Smoked Oyster	C2-211	118"	Rocky Bluffs	CH-23	CB-23
3/4"	Room Darkening	S	Luxe RD	Soft White	C2-202	118"	Bistro White	CH-22	CB-22
3/4"	Room Darkening	S	Luxe RD	Studio	C2-230	118"	Autumn Fog	CH-11	CB-11
3/4"	Room Darkening	S	Luxe RD	Twin Cities	C2-231	118"	Silver Leaf	CH-21	CB-21

FABRIC WIDTH/RAIL COORDINATION CHART/PRICE GROUP

CELL SIZE	OPACITY	SINGLE CELL	PATTERN NAME	COLOR	COLOR #	FABRIC WIDTH	HEADRAIL COLOR	HEADRAIL COLOR #	BOTTOM RAIL COLOR #
3/4"	Room Darkening	S	Luxe RD	Upper East Side	C2-226	118"	Silver Leaf	CH-21	CB-21
3/4"	Room Darkening	S	Luxe RD	White	C2-201	118"	Ultra White	CH-20	CB-20
3/4"	Light Filtering	S	Starlight	Alabaster	C1-603	144"	Latte	CH-14	CB-14
3/4"	Light Filtering	S	Starlight	Blue	C1-601	144"	Iron Frost	CH-18	CB-18
3/4"	Light Filtering	S	Starlight	Pewter	C1-602	144"	Muddy Water	CH-19	CB-19
3/4"	Light Filtering	S	Textures	Alabaster	C1-502	144"	Latte	CH-14	CB-14
3/4"	Light Filtering	S	Textures	Bright White	C1-501	144"	Ultra White	CH-20	CB-20
3/4"	Light Filtering	S	Textures	Coffee	C1-504	144"	Cocoa	CH-24	CB-24
3/4"	Light Filtering	S	Textures	Stone	C1-503	144"	Silver Leaf	CH-21	CB-21

STACK CHART

Cordless

PATTERN	SHADE DROP			
	48"	72"	84"	96"
Denim LF	2 ⁷ / ₈ "	3 ¹ / ₈ "	3 ¹ / ₄ "	3 ³ / ₈ "
Linen LF	2 ⁷ / ₈ "	3 ¹ / ₈ "	3 ¹ / ₄ "	3 ³ / ₈ "
Luxe LF	2 ¹ / ₂ "	2 ³ / ₄ "	3"	3"
Starlight LF	3"	3 ³ / ₈ "	3 ⁵ / ₈ "	3 ⁷ / ₈ "
Textures LF	3"	3 ³ / ₈ "	3 ⁵ / ₈ "	3 ⁷ / ₈ "
Denim RD	2 ³ / ₄ "	3 ¹ / ₈ "	3 ¹ / ₄ "	3 ³ / ₈ "
Linen RD	2 ³ / ₄ "	3 ¹ / ₈ "	3 ¹ / ₄ "	3 ³ / ₈ "
Luxe RD	2 ³ / ₈ "	3"	3 ¹ / ₈ "	3 ¹ / ₂ "

Top Down / Bottom Up

PATTERN	SHADE DROP			
	48"	72"	84"	96"
Denim LF	3 ¹ / ₂ "	3 ⁵ / ₈ "	3 ³ / ₄ "	3 ⁷ / ₈ "
Linen LF	3 ¹ / ₂ "	3 ⁵ / ₈ "	3 ³ / ₄ "	3 ⁷ / ₈ "
Luxe LF	3"	3 ¹ / ₄ "	3 ¹ / ₂ "	3 ¹ / ₂ "
Starlight LF	3 ¹ / ₂ "	3 ⁷ / ₈ "	4 ¹ / ₈ "	4 ³ / ₈ "
Textures LF	3 ¹ / ₂ "	3 ⁷ / ₈ "	4 ¹ / ₈ "	4 ³ / ₈ "
Denim RD	3 ¹ / ₄ "	3 ⁵ / ₈ "	3 ³ / ₄ "	3 ⁷ / ₈ "
Linen RD	3 ¹ / ₄ "	3 ⁵ / ₈ "	3 ³ / ₄ "	3 ⁷ / ₈ "
Luxe RD	2 ⁷ / ₈ "	3 ¹ / ₂ "	3 ⁵ / ₈ "	4"

PRODUCT
COMPONENTS
MOTORIZED

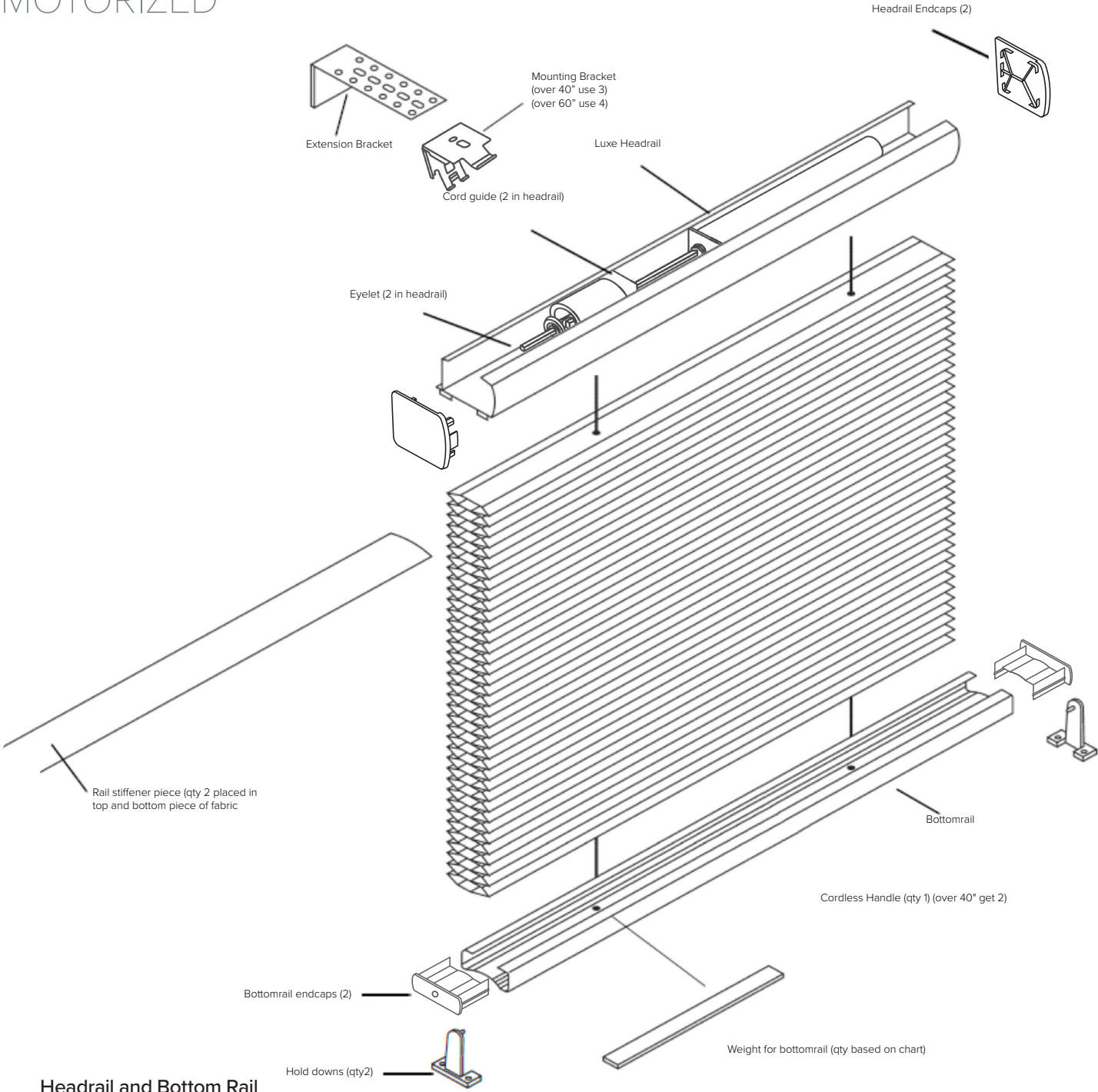

Headrail and Bottom Rail

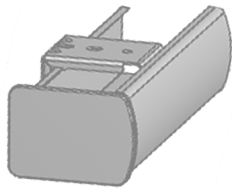

Luxe Cellular Headrail
2 7/16" D x 1 7/16" H

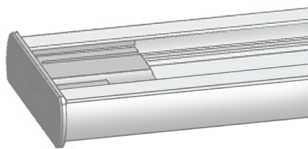

Bottom Rail
1 1/2" D x 9/16" H

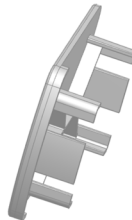

Headrail Endcaps

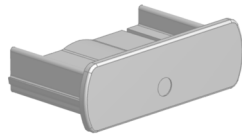

Bottom Rail Endcaps

PRODUCT
COMPONENTS
CORDLESS

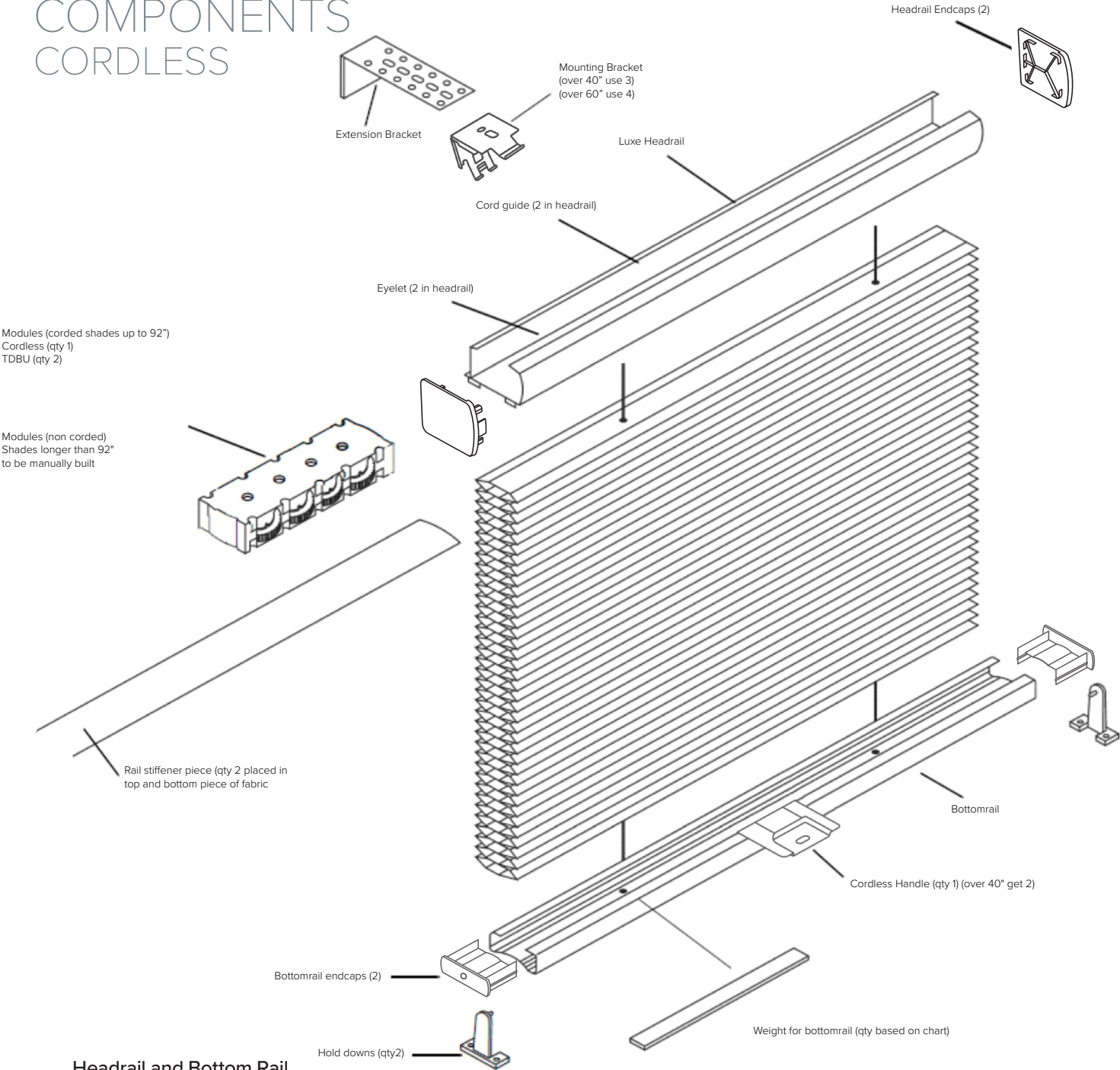

Headrail and Bottom Rail

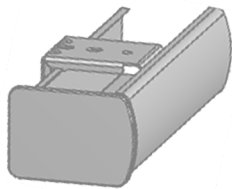

Luxe Cellular Headrail
2 7/16" D x 1 7/16" H

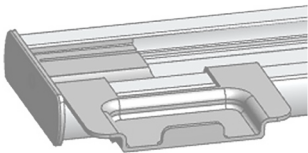

Bottom Rail
1 1/2" D x 9/16" H

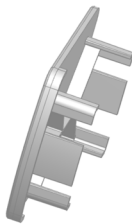

Headrail Endcaps

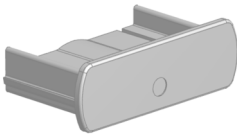

Bottom Rail Endcaps

Cordless Handle
2 7/16" W x 7/8" H

