

# Meetings & Incentives

*Phulay Bay*  
A RITZ-CARLTON RESERVE



# Meetings & Incentives at Phulay Bay

Beyond the limestone mountains rising from Thailand’s Andaman Sea, virgin rainforests, ethereal beaches and crystal clear waterfalls, a secluded paradise awaits you in one of the world’s most spellbinding destinations. Phulay Bay, a Ritz-Carlton Reserve has easy accessibility from either Krabi or Phuket International Airports. Our resort is situated in a privileged location which offers unique venues for incentives or corporate retreats.

## Arriving Here

### Phulay Bay by Land

Phulay Bay is strategically located 30km away from Krabi Airport and accessible by land from Phuket Airport through a scenic route along Phang Nga Bay (2 hours drive).

### Phulay Bay by Sea

Discover the Andaman Sea from the very first moment with a unique transfer by luxury speed boat from Phuket International Airport, a 45 minute cruise to our exclusive Phulay Bay beach

### Phulay Bay by Air

Take a helicopter transfer to Phulay Bay for a memorable sense of arrival. Travel time is around 20 minutes, overlooking the dramatic limestone karsts of the Andaman Sea crystal waters from the sky.





# Phulay Bay, a Ritz-Carlton Reserve

We invite you to experience the hidden retreat and peaceful surroundings of our resort. With only 54 spacious rooms, you will feel immersed in a private sanctuary that is the perfect place to host your meeting or incentive. At Phulay Bay, personal attention to your every need is of utmost importance.







RESERVE PAVILION



OCEAN PAVILION

# Pavilions

Our pavilions welcome you to a peaceful haven of Thai décor and luxurious amenities, complete with private verandahs overlooking tropical gardens or ocean views.

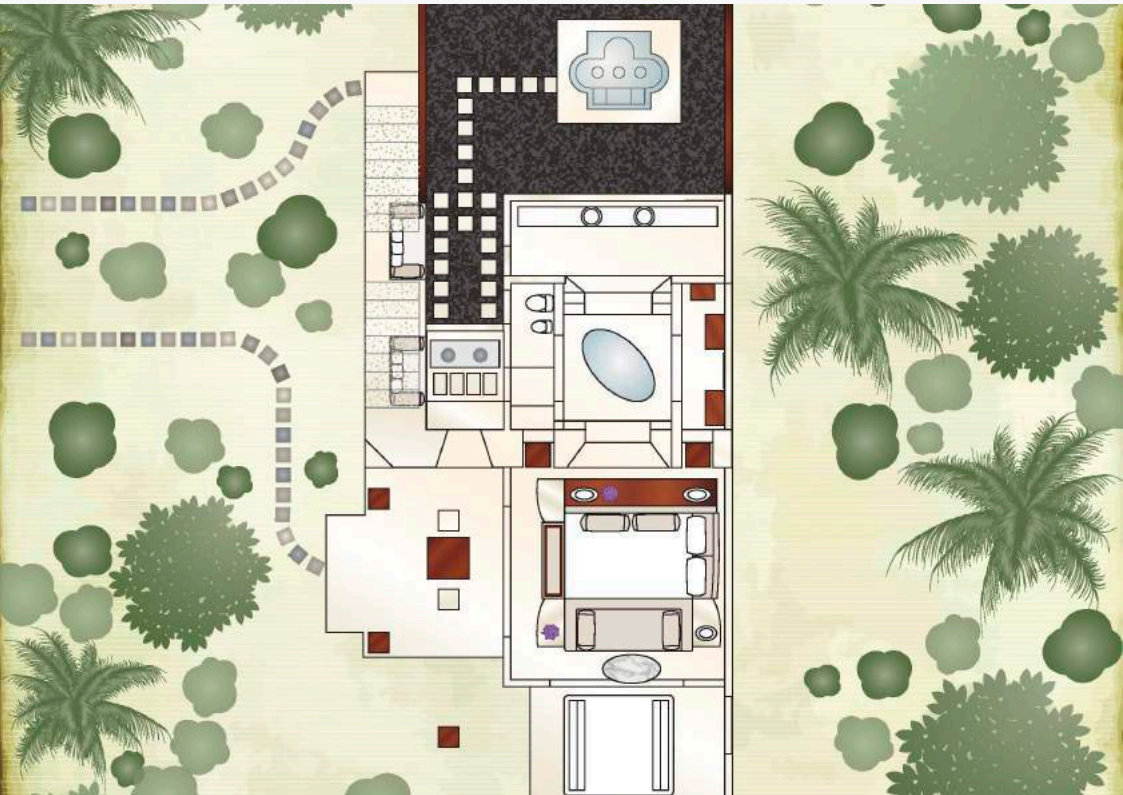

Room Type	Room Count	Room Size (sqm)	Room Size (sqft)
RESERVE PAVILION	13	179	1926
OCEAN PAVILION	11	108	1162





BEACH VILLA



RESERVE POOL VILLA



## Villas

The elegant and spacious Reserve Villas feature private pools with sea views and gardens, while the Beach Villas are situated adjacent to the seafront. Each accommodation provides exclusive privacy and a relaxing atmosphere for a luxurious experience.

Room Type	Room Count	Room Size (sqm)	Room Size (sqft)
BEACH VILLA	8	415	4467
RESERVE POOL VILLA	12	352	3788
RESERVE POOL VILLA SEA VIEW	4	352	3788





ROYAL BEACH VILLA

# Royal Beach Villas

Our most impressive villa offers an infinity pool with a view of the Andaman Sea, indoor and outdoor baths with rainforest showers, and a private garden complete with verandah and lounge beds. Here you can experience the ultimate tropical sanctuary.



Room Type	Room Count	Room Size (sqm)	Room Size (sqft)
ROYAL BEACH VILLA	6	588	6329





# Traditional Meeting Venues

The unique traditional venues at our resort provide a refreshing new perspective to your meeting setup. The spacious surroundings and Thai-style décor creates a lively and inspiring atmosphere for your meeting or incentive.

*Nature holds the key to our intellectual and spiritual awakening.*



## Thung Fah

Our spacious traditional meeting room can accommodate up to 70 people with a variety of table setups, and includes a screen projector and space for catering.

### Setup & Capacity

U Shape	Classroom
25	40
Boardroom	Theatre
50	70

## Chef's Table

Take your meeting out of the meeting room. Surrounded by traditional Lanna wall paintings and a view of our Chefs at work, this room provides a stimulating atmosphere for any group meeting.

### Setup & Capacity

U Shape	Classroom
14	20
Boardroom	Theatre
18	55





LAE LAY



SRI TRANG

## Meetings Beyond

Step out and take your meeting to an unexpected venue where you can be inspired by the nature and landscape surrounding Phulay Bay. The fresh air and stunning ocean views are a perfect setting for your meeting or incentive that will encourage new ideas.

*Look deep into nature, and then you will understand everything better.*



SALA SRICHAN



POOL LAWN

### Lae Lay

The floor-to-ceiling windows and sea view from the deck of our seafood restaurant provides a refreshing location to inspire your meetings and discussions.

### Sala Srichan

The soft sounds of water and traditional music at our Thai-style welcome pavilion adds a touch of elegance and tranquility to your important meeting.

### Sri Trang

With its subtle Thai decor and intimate space, our signature Thai restaurant offers a quiet place for you to host your meeting.

### Pool Lawn

Host your meeting or incentive in the open air with a view of the Andaman Sea on our Pool Lawn. The fresh breeze and relaxing surroundings will welcome new ideas.





# Event Venues

Celebrate the accomplishments of the day at one of our unique and breathtaking venues. Whether your event is big or small, memories here will last a lifetime.

*The more you praise and celebrate your life, the more there is in life to celebrate.*

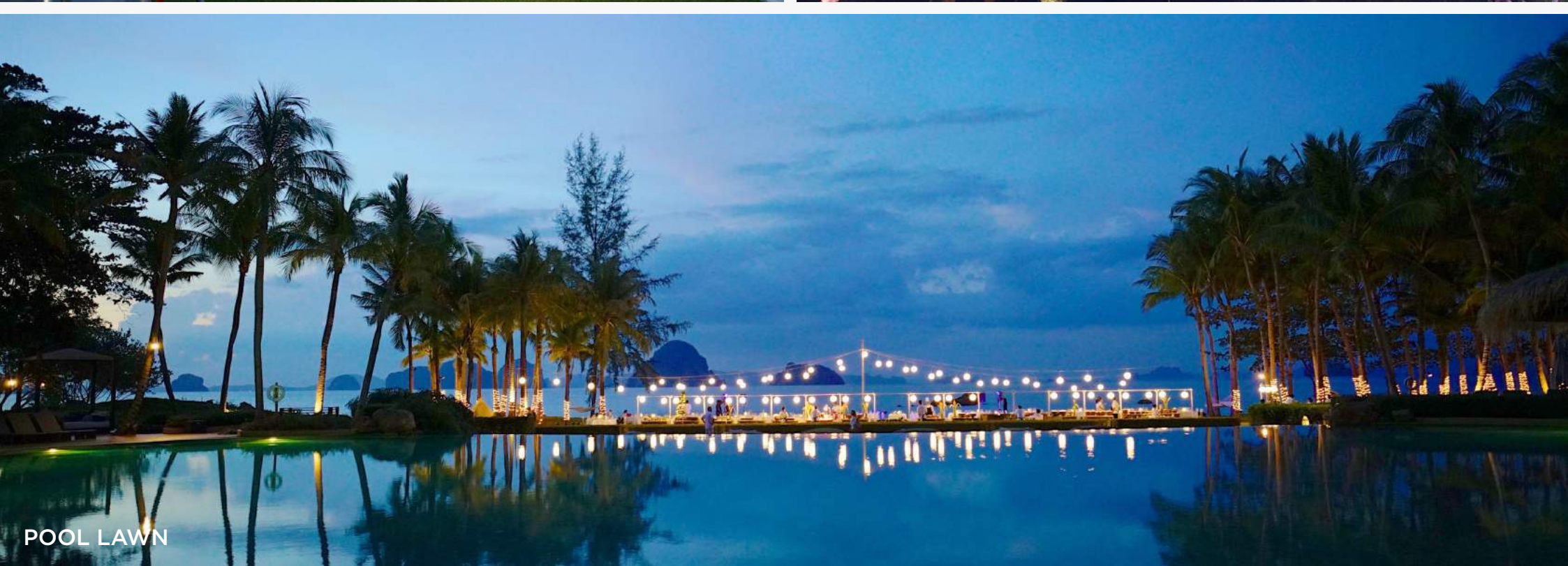

Setup & Capacity	Banquet	Buffet	Standing Heavy Reception
JAMPOON	75	75	110
SRI TRANG	45	30	50
LAE LAY	26	26	60
SALA SRICHAN	20	10	30
POOL LAWN	120	120	150
JAMPOON LAWN	100	100	100
CHOMTAWAN BEACH	—	90	120





# Meeting Packages

## Half Day Package

Complimentary use of the meeting room from 08:00-12:00 or 13:00-17:00 hrs.

Morning **OR** afternoon coffee break with assorted sweets and savouries

Freshly brewed coffee and selection of teas throughout the meeting

Choice of lunch between a 3-course Western set lunch or Thai set lunch

Complimentary bottled water and mints

State of the art audio visual package include: LCD projector, screen, wireless microphone

Complimentary meeting stationery including flip charts, markers, etc.

Wireless internet access in meeting room

Complimentary writing pad and pen

Standard flower decoration

Signage in front of meeting room

Event Specialist service and technician services throughout the meeting

*THB 2,700 per person*

## Full Day Package

Complimentary use of the meeting room from 08:00-17:00 hrs.

Morning **AND** afternoon coffee break with assorted sweets and savouries

Freshly brewed coffee and selection of teas throughout the meeting

Choice of lunch between a 3-course Western set lunch or Thai set lunch

Complimentary bottled water and mints

State of the art audio visual package include: LCD projector, screen, wireless microphone

Complimentary meeting stationery including flip charts, markers, etc.

Wireless internet access in meeting room

Complimentary writing pad and pen

Standard flower decoration

Signage in front of meeting room

Event Specialist service and technician services throughout the meeting

*THB 3,500 per person*

*Subject to 17.7% taxes and service charge*





# Meeting Packages | Coffee Breaks

## Tea Break

### Beverage

Assorted teas and coffee served hot or on ice

### From the pastry

Custards  
Crème caramel jasmine tea infuse  
Green tea pot de crème  
Oolong tea crème brûlée  
Home-made tea infused truffle  
Chocolate

### From the kitchen

Jasmine tea smoked beef  
Cakes  
Green tea madeleine  
Jasmine tea pound cake  
Black tea financier

## Tropical Fruit Break

### Beverage

Fresh fruit juices  
Tea and coffee

### From the orchard

Fresh carved tropical fruit selection  
Home-made dried tropical fruit

### From the pastry

*Assorted poached fruit*  
Rose apple, mango, dragon fruit  
*Pate de fruit*  
Coconut, mango, banana  
*Pudding*  
Guava, dragon fruit, banana

## Chocolate Decadence

### Beverage

Hot and cold chocolate drinks  
Tea and coffee

### From the pastry

Assorted chocolate truffles  
Chocolate fondue selection with fresh fruit  
*Chocolate cake*  
White, dark and milk  
*Chocolate custard*  
Crème brûlée, pot de crème, mousse  
*Ice cream*  
3 assorted chocolate flavors





# Meeting Packages | Set Lunch Menu

## Thai Set Lunch

### Starter

Spicy green papaya salad  
*or*

Chicken pandan leaves with  
caramelized sauce

### Main Course

Deep-fried garlic pepper sea  
bass  
*or*

Green curry with chicken  
with eggplant and red chili

### Dessert

Mango sticky rice with  
coconut

## Western Set Lunch

### Starter

Tomato Gazpacho, with tomato  
and prawns tartar  
*or*

Avocado mango tian salad,  
citrus dressing

### Main Course

Roasted chicken, sautéed  
mushroom, potatoes, lemon,  
thyme, an chicken jus  
*or*

Pan-seared snapper, carrot  
purée, grilled baby eggplant

### Dessert

Tropical fruit with sorbet





# Canapés

## Cold Canapés

### Spoons

Tuna tartar, wasabi cream, crisp wonton  
Shrimp and scallop ceviche  
Smoked salmon rillette croutons

*THB 100 each*

### Forks

Tuna tataki, choo chee curry  
Phuket lobster, mango and chili mayonnaise  
Baby tomatoes, nicoise olives, fresh basil and mozzarella

*THB 125 each*

### Soup Shots

Roasted tomato with basil  
Cucumber gazpacho  
Corn soup with truffle oil

*THB 60 each*

### Thai Clay Pots

Miang kam bites  
Andaman poached prawns with sea food chili sauce  
Vietnamese style rolls: pork, vegetarian, prawns

*THB 95 each*

## Hot Canapés

### Soup Shots

Lobster bisque with cardamom cream  
Tom Ka Gai with prawns skewer  
Ginger carrot soup with cumin gelée

*THB 75 each*

### Thai Clay Pots

Angus beef wontons, Panang nua curry  
Andaman blue crab croquettes, sauce tartar  
Homemade miniature beef ‘Wellington’  
Thai Satay: prawns, chicken, beef, pork with peanut sauce  
Lemongrass pork spring rolls, sweet chili sauce  
Thai shrimp toast with sea food chili sauce  
Choo chee curry salmon skewer

*THB 135 per person*

## Reserve Canapés

### 10 Pieces Per Person

Please choose up to 10 different types of our canapés

*THB 1,200 per person*

*Subject to 17.7% taxes and service charge*





# Menu Inspiration

## Western

### First course

Organic lettuces and roasted beets salad, goat cheese, citrus honey dressing

### Soup

Roasted pumpkin soup truffle chantilly

### Main Course

Tiger prawns risotto with saffron, tomato, bell pepper

### Dessert

Coconut Profiterole  
Valrhona hot chocolate sauce

*THB 2,500 per person*

## Reserve Western

### First course

Oyster, tiger shrimp and crab cocktail sauce, mango mignonette

### Appetizer

Foie gras, mango au Torchon, brioche, Asian pear salad

### Soup

Lemongrass infused lobster broth  
Scallop dumpling

### Main Course

Grilled Wagyu beef strip loin  
Sautéed mushrooms, roasted potatoes, bordelaise sauce

### Dessert

Ultimate Valrhona warm chocolate cake  
Coconut ice cream

*THB 2,500 per person*

## Thai

### First course

Trio of green papaya salad, deep fried fish cake, and deep fried chicken wrapped in home-grown pandan leaves

### Soup

Hot and sour spicy soup with tiger prawns (tom yum goong)

### Main Course (Family Style)

Stir-fried mixed vegetables with oyster sauce  
Panang paste-flavored pan seared ocean prawns, pickled raw vegetable  
Green curry Angus beef, jasmine rice green eggplant and red chili

### Dessert

Black sticky rice with sweet mango, coconut cream sauce

*THB 2,800 per person*

## Thai & Western Fusion

### First course

Green papaya salad, peanut, soft shell crab

### Second course

Oyster, tiger shrimp, prawns and crab, cocktail sauce, mango mignonette

### Fish Course

Blanched Phuket lobster, red curry sauce

### Main Course

Grilled angus beef tenderloin  
Potato gratin  
Roasted tomato  
Red wine and shallots sauce

### Dessert

Vanilla, chocolate baked Alaska

*THB 3,800 per person*

*Subject to 17.7% taxes and service charge*





# Buffet Inspiration

## Mediterranean

### Cold Selection

Grilled eggplant rolled with goat cheese and fresh oregano  
Calamari salad, tomato and basil pesto  
Mini individual Niçoise salad  
Pissaladiere roasted onion tart with anchovies and black olives  
Spanish gazpacho, extra virgin olive oil and garlic croutons

### Hot Selection

Classic seafood paella  
Chicken tagine with olives  
Whole roasted Mediterranean dorade with lemon confit  
Provençal vegetable ratatouille  
Olive oil crushed potatoes

### Carving to Order

Roasted leg of lamb, tapenade and garlic rosemary jus

### Desserts

Pastry chef's Mediterranean dessert selection

*THB 2,500 per person*

## Reserve Barbecue

### Salads

Caesar salad and mix green lettuce  
Spring roll sheets, carrots, mushrooms, cabbage, onions, celery, home-made palm sauce  
Spicy glass noodle salad with seafood  
Tomato Cucumber Salad  
Balsamic dressing  
Green papaya salad

### From the charcoal grill

Phuket lobster  
Sea Bass  
Tiger prawns  
Grilled vegetables  
Beef tenderloin  
Assorted satay  
Assorted sauces and dips  
Baked potato, corn on cob

### Desserts

Assorted sliced fresh fruits  
Buffet of assorted dessert surprise

*THB 5,000 per person*

## Thai Flavours Barbecue

### Appetizer

Spring rolls  
Deep-fried prawn cake  
Green papaya salad  
Chicken satay  
Deep-fried chicken in pandan leaves  
Roasted eggplant salad  
Crispy catfish with mango salad

### Soup

Chicken in coconut milk soup (tom kha gai)  
Hot and sour prawn soup (tom yum goong)  
Fish in turmeric soup

### Main Course

Pad Thai with shrimp  
Fried rice with seafood  
Stir-fried rice noodle with chicken  
Wok fried seafood with basil  
Roasted duck curry  
Stir fried chicken with cashew nut  
Traditional sour curry with deep fried sea bass

### Dessert

Mango with black & white sticky rice, coconut cream  
Banana spring rolls  
Banana poached in coconut milk and pandan leaves  
Chestnut poached in syrup  
Moh gang (egg pudding custard)  
Taro Cake  
Pumpkin custard, black sticky rice  
Tropical fresh fruit  
Local flavors of ice cream and sorbets

*THB 4,500 per person*

*Subject to 17.7% taxes and service charge*





# Beverages

## Pre-Dinner Cocktail

*1 hour service*

- Selection of two cocktails
- Selected red and white wine
- Local beer
- Soft drinks

*THB 1,400 per person*

## Lunch & Dinner Beverage Options

*2.5 hour service*

### Soft Drinks

- Includes soft drinks

*THB 550 per person*

### Soft Drinks and Beer

- Includes local beer and soft drinks

*THB 800 per person*

### Reserve Wine Selection

- Includes selected red and white wine, local beer, and soft drinks

*THB 1,900 per person*

## Reserve Pre-Dinner Cocktail

*1 hour service*

- Selection of vodka, gin, rum, tequila, and whisky
- Selected red and white wine
- Local beer
- Soft drinks

*THB 1,900 per person*

## Open Bar After Lunch & Dinner

*2 hour service*

### Open Bar Selection

- Includes selected red and white wine, vodka, gin, rum, tequila, whisky, local beer, and soft drinks

*THB 2,000 per person*

### Open Bar Reserve Selection

- Includes selected red and white wine, vodka, gin, rum, tequila, whisky (premium brands), local beer, and soft drinks

*THB 3,000 per person*

*Subject to 17.7% taxes and service charge*





# The Spa

Enjoy the ultimate experience in our Spa, which offers aromatherapy steam rooms, outdoor vitality pools, saunas and relaxation rooms. Unwind here and take pleasure in the peaceful, secluded surroundings.

## Facilities

### Spa amenities include:

- Eleven Spa treatment rooms
- Spa vitality pool
- Wellness studio
- Relaxation areas
- VIP treatment area with private outside entrance
- A fully equipped Gym is available 24 hours for our guest convenience

## Treatments

- Holistic Energy Balancing Ritual with Volcanic Stones
- Thai Herbal Infusion Ritual
- Thai Hand & Foot Ritual
- Traditional Thai Massage
- Aromatherapy Massage
- Sun Soothing Ritual

*The schedule can be adjusted to group needs upon request.*





## Reconnecting Teams

Reward your team after a successful meeting or event with various group activities. Explore the stunning natural scenery around Krabi with island cruises and mountain hiking, or discover the essence of Thai culture with a cooking class or mojito workshop.

### Discovering Krabi

#### Four Island Hopping Tour

This exciting day trip will take you on a tour of the beautiful limestone islands that dot the Krabi coastline. Relax on the white sandy beach, snorkel, and explore the jungle scenery and caves.

#### Naga Mountain Discovery Trek

Take an adventurous trek through the natural scenery of Naga Mountain, passing waterfalls and exotic fauna as you climb. The final viewpoint at the mountain peak is 500 meters above sea level, offering a stunning panoramic view of the Andaman Sea.

#### Tiger Cave Temple

Wat Tham Seu (Tiger Cave Temple), 5km from Krabi Town, is a small temple built inside a long shallow limestone cave, surrounded by natural forest. Two staircases wind up the limestone cliffs. The first one leads with 1,237 steps to the top of the mountain.

### Thai Culinary Activities

#### Thai Cooking Class

Spend the day with our Chefs in an immersive lesson where you learn the secrets of traditional Thai cooking.

#### Thai Mojito Workshop

A private lesson with our bartender who will take you through the delights of making our signature Thai mojitos.

#### Fruit & Vegetable Carving

Together with our Chef, learn how to create beautiful fruit carvings that are used as decoration for authentic Thai dishes.





SAHA SANGKHAM  
BETTER FROM PHULAY BAY  
PHULAY BAY RESERVE

Phulay Bay  
A RITZ-CARLTON RESERVE

For enquiries, please contact  
**[kbvrz.leads@ritzcarlton.com](mailto:kbvrz.leads@ritzcarlton.com)**  
[www.ritzcarlton.com/PhulayBay](http://www.ritzcarlton.com/PhulayBay)

111 Moo 3 T. Nongthalay A.  
Muang Krabi  
81180 Thailand

 phulaybayreserve

 Phulay Bay, a Ritz-Carlton Reserve