

MEETING AMENITIES



OVERVIEW

From small-scale executive meetings, to sizeable corporate functions, every event at The Ritz-Carlton, Perth, promises a flawless experience, thanks to immaculate facilities with expert planning, conference concierge services, entertainment and catering available.

With 2,000 square metres of meeting and function space, including 935 square metres of pre-function space, a 550 square metre ballroom, eight meeting rooms and more, our varied amenities are perfectly located and feature stunning views of the Perth skyline, Swan River and The Bell Tower.

- 2,000 square metres of meeting and function space to host meetings, conferences, launches, team building sessions and networking events
- 550 square metre Elizabeth Quay Ballroom and 497 square metre light-filled pre-function foyer with windows and a balcony overlooking Elizabeth Quay
- Meeting rooms with views over the Perth skyline, Swan River or The Bell Tower
- Located within the Perth central business district
- Full portfolio of meeting services including planning, conference concierge, entertainment and catering
- State-of-the-art audiovisual capabilities including teleconferencing, LED screens, in-built projectors and high-speed internet



THE RITZ - CARLTON

PERTH

1 BARRACK STREET, PERTH, WA 6000
RITZCARLTON.COM/PERTH

ROOM SIZES AND CAPACITY

	Square metres	Square feet	Dimensions in metres	Dimensions in feet	Ceiling Height (m)	Ceiling Height (ft)	Banquet	Theatre	Cocktail	Cabaret	Classroom	U-shape	Boardroom
The Elizabeth Quay Ballroom	550	5920	29 x 17	95 x 56	4.8	16	400	460	500	320	360	N/A	N/A
Ballroom 1	125	1345	7 x 17	23 x 56	4.8	16	90	110	120	72	55	38	32
Ballroom 2	236	2540	14 x 17	46 x 56	4.8	16	190	215	230	152	100	73	61
Ballroom 3	120	1291	7 x 17	23 x 56	4.8	16	90	105	100	72	55	37	31
The Elizabeth Quay Ballroom Foyer	497	5349	N/A	N/A	4.8	16	N/A	N/A	500	N/A	N/A	N/A	N/A
Bell Tower 1 & 2	138	1485	11 x 18	36 x 59	2.5	9.5	70	125	130	56	50	40	30
Bell Tower 1	69	742	11 x 9	36 x 30	2.5	9.5	30	60	70	24	25	21	18
Bell Tower 2	69	742	11 x 9	36 x 30	2.5	9.5	30	60	70	24	25	21	18
Bell Tower Foyer	143	1540	N/A	N/A	4.8	16	N/A	N/A	155	N/A	N/A	N/A	N/A
Swan River 1	82	882	7 x 12	23 x 39	4.8	16	50	75	70	32	30	20	18
Swan River 2	63	678	10 x 7	33 x 23	4.8	16	30	40	40	16	20	15	12
Swan River 3	36	387	6 x 5	20 x 16	4.8	16	10	30	20	8	10	8	6
Swan River Foyer	295	3175	N/A	N/A	4.8	16	N/A	N/A	150	N/A	N/A	N/A	N/A
Outdoor Pool Terrace – Level 5	177	1905	8 x 24	26 x 79	N/A	N/A	N/A	N/A	100	N/A	N/A	N/A	N/A

MEETING ROOMS LEVEL TWO

ROOM DETAILS

Featuring ample pre-function areas, eight fully equipped meeting rooms with views over the Perth skyline, Swan River and The Bell Tower, the 2,000 square metres of meeting and function space at The Ritz-Carlton, Perth have flawless amenities for every event to be a success; from meetings, conferences, launches and exhibitions, to team building sessions and networking events.

The spacious amenities comprise The Elizabeth Quay Ballroom Foyer and majestic 550 square metre Elizabeth Quay Ballroom, available as a single large space, or three smaller, private rooms. In addition, the Bell Tower and Swan River rooms are available in a variety of compositions, and overlook the stunning Swan River, Bell Tower or Elizabeth Quay. With comfort, privacy and a professional ambiance assured, this is an ideal Perth city location for a wide range of events.

FLOOR PLAN

LANGLEY PARK AND SWAN RIVER

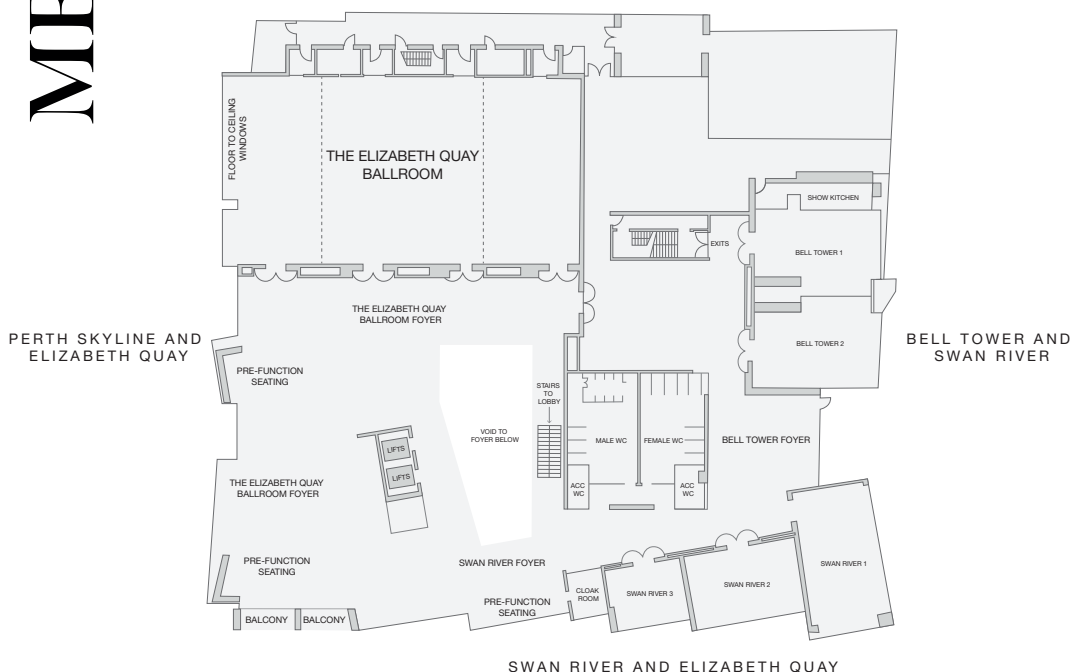

Floorplans do not depict exact scaling, layouts or dimensions



THE RITZ-CARLTON

PERTH

1 BARRACK STREET, PERTH, WA 6000
RITZCARLTON.COM/PERTH