



THE RITZ-CARLTON

JAKARTA, MEGA KUNINGAN



ARRIVE

*Experience the elements
of exceptionality*

Located in the heart of the Mega Kuningan business district, The Ritz-Carlton, Jakarta stands among distinguished embassies and exclusive metropolitan residences. The hotel itself is a study in contrasts designed from Feng Shui principles, its sleek, sophisticated exterior yields to a warm, indulgent interior, welcoming guests to an experience of luxury like no other.

THE RITZ-CARLTON JAKARTA, MEGA KUNINGAN



Surrounded by high-profile corporate offices of Mega Kuningan, Embassies, stately residences and luxury shopping malls, The Ritz-Carlton offers the most desirable address within the Mega Kuningan Business District.



*Create lasting and
meaningful memories*

REST

Each of the 296 guest rooms and 37 suites offers a haven of pampering and distinction. Accommodations are among Jakarta's most spacious and feature floor-to-ceiling windows overlooking the city. Luxury guest room amenities include featherbeds, fine linens, marble baths with European bath essentials, a 55-inch plasma screen television with complimentary movies and high-speed Internet access. Ninety-nine rooms comprise The Ritz-Carlton® Club Level, a special floor with prestigious amenities, including a separate lounge with five complimentary food and beverage presentations throughout the day and evening and a dedicated concierge staff.

THE RITZ-CARLTON JAKARTA, MEGA KUNINGAN



Opulent suites with exquisite city views
our elegant accommodations also
include suites and villas, which are
perfect for those who prefer elevated
levels of privacy and service.

GRAND ROOM



- 63 square meter room
- 3.5 meter/11.5 square foot floor to ceiling window
- Working desk
- High speed broadband internet access
- 55 inch LED screen television
- Featherbeds, down comforters and goose-down, non-allergenic foam pillows
- Complimentary local calls
- Laptop size safe deposit box
- Bathrobes
- Asprey bath essentials
- Walk in wardrobe
- Complimentary two pieces pressing daily on best available rate

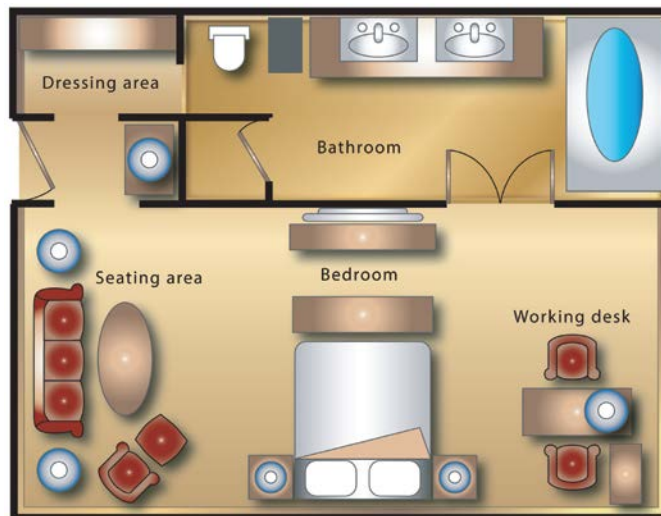

GRAND STUDIO



- 75 square meter room
- 3.5 meter/11.5 square foot floor to ceiling window
- Working desk
- High speed broadband internet access
- 55 inch LED screen television
- Featherbeds, down comforters and goosedown and non-allergenic foam pillows
- Complimentary local calls
- Laptop size safe deposit box
- Bathrobes
- Asprey bath essentials
- Walk in wardrobe
- Complimentary two pieces pressing daily on best available rate

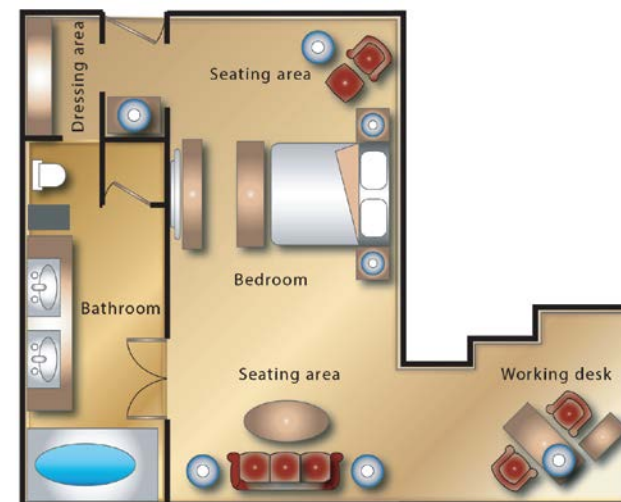

GRAND SPA TERRACE



- 76 square meter room
- 3.5 meter/11.5 square foot floor to ceiling window
- Private Jacuzzi pools
- Working desk
- High speed broadband internet access
- Featherbeds, down comforters and goose-down, non-allergenic foam pillows
- 55 inch LED screen television
- Complimentary local calls
- Laptop size safe deposit box
- Bathrobes
- Plasma television in bathroom
- Asprey bath essentials
- Walk in wardrobe
- Complimentary two pieces pressing daily on best available rate

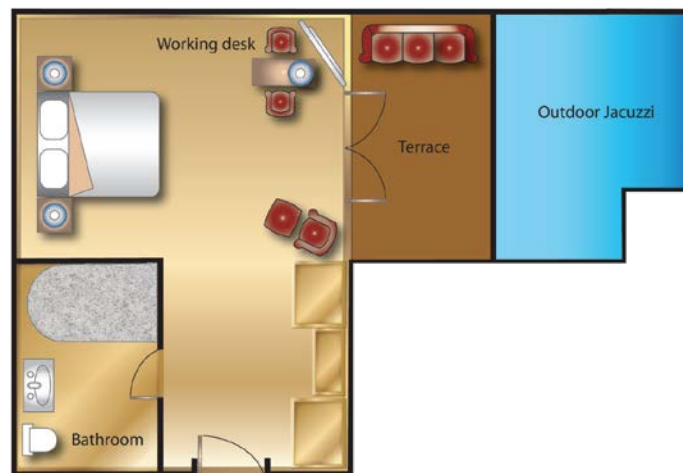

MAYFAIR SUITE



- 110 square meter suite
- 3.5 meter/11.5 square foot floor to ceiling window
- Working desk
- Separate living room and bedroom
- Powder room/guest bathroom
- High speed broad band internet access
- 55 inch LED screen television
- Stereo system with DVD and CD player
- Featherbeds, down comforters, goosedown and non-allergenic foam pillows
- Complimentary local calls
- Laptop size safe deposit box
- Bathrobes
- Walk in wardrobe
- Complimentary two pieces pressing daily on best available rate

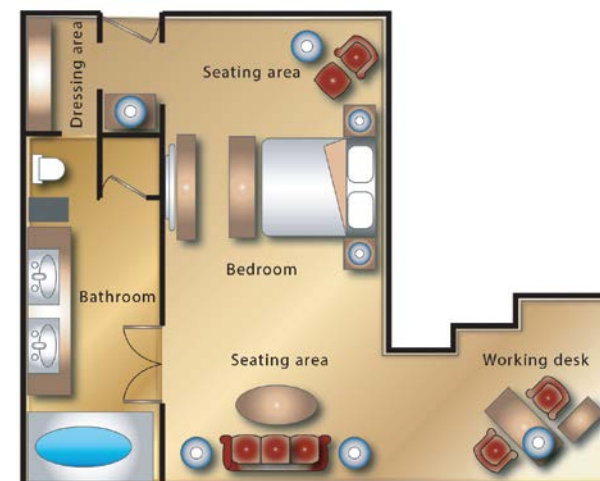

EXECUTIVE SUITE



- 177 square meter room
- 3.5 meter/11.5 square foot floor to ceiling window
- Working desk
- High speed broadband internet access
- 55 inch LED screen television
- Featherbeds, down comforters and goose down and non-allergic foam pillows
- Separate living room and bedroom for master bedroom
- Two separate room entrance that can be locked individually
- Connected to a double-bedded room
- Spacious marble bathrooms
- Separate powder room for the guests
- DVD player in both of the room and game station for twin available upon request
- Dining table for 4 persons in living room
- Kids welcome amenities
- Complimentary local calls
- Laptop size safe deposit box
- Bathrobes
- Asprey bath essentials
- Walk in wardrobe
- Complimentary two pieces pressing daily on best available rate

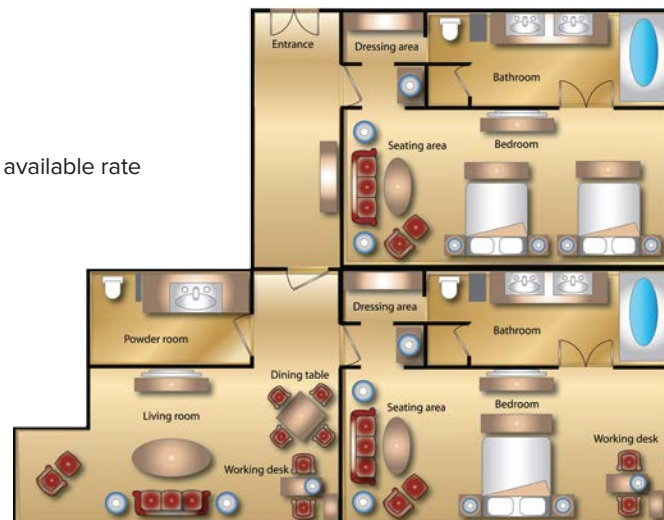

THE RITZ-CARLTON SUITE



- 250 square meter with one bedroom suite
- 3.5 meter/11.5 square foot floor to ceiling window
- Working desk
- Two separate spacious living rooms
- Spacious dining room
- High speed broadband internet access
- 55 inch LED screen television
- Stereo system with DVD and CD player
- 24 hours Private Butler Service
- Complimentary local calls
- Laptop size safe deposit box
- Bathrobes
- Plasma television in bathroom
- Walk in wardrobe
- Complimentary two pieces pressing daily on best available rate



PRESIDENTIAL SUITE



- 400 square meter one bedroom Suite
- 3.5 meter/11.5 square foot floor to ceiling window
- Working desk
- Expansive Lounge and reception area
- 55 inch LED screen television
- Large dining room for up to 40 persons
- Connected with a Grand Room
- Private living room
- Stereo system with DVD and CD player
- Baby grand piano
- 24 hours Private Butler Service
- Complimentary local calls
- Laptop size safe deposit box
- Bathrobes
- Large marble bathroom with whirlpool bathtub and rainforest shower
- Plasma television in bathroom
- Asprey bath essentials
- Walk in wardrobe
- Complimentary two pieces pressing daily on best available rate

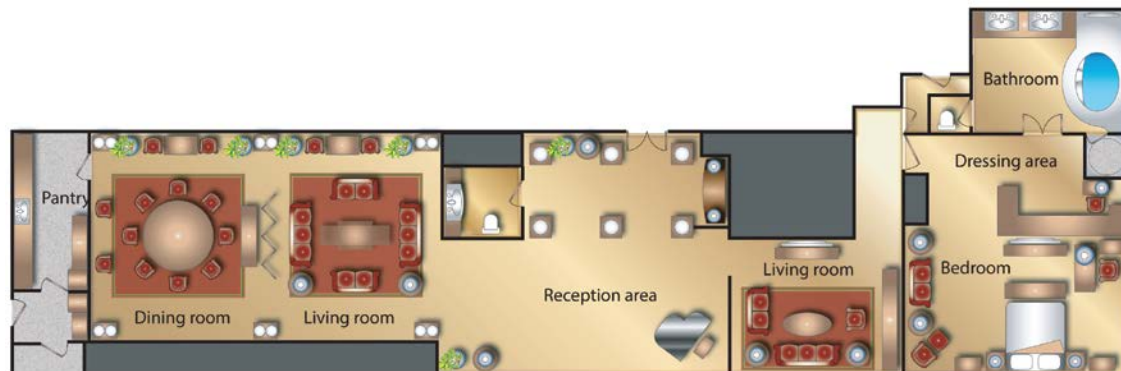

The Ritz-Carlton Club at The Ritz-Carlton Jakarta, Mega Kuningan features 116 Club rooms and 37 Suites with Club access. Providing a “Hotel within the hotel” experience, The Ritz-Carlton Club redefines the luxury hotel experience, combining intimacy, comfort and exclusivity with the personalized service and attention to detail that are the hallmarks of The Ritz-Carlton.

Set on the 26th floor of The Ritz-Carlton, the Club Lounge looks out over Jakarta’s skyline. Guests staying at The Ritz-Carlton club rooms will have direct access to their rooms and only registered guests can access the club floor and club lounge. Appealingly furnished interiors provide a compelling backdrop to enjoy from a classic afternoon tea to a panoramic sunset.

To unwind after a busy day, guests may sip their wines, enjoy a game of pool at The Billiard Room or experience the continuous culinary offerings throughout the day. A complimentary shuttle service within Mega Kuningan area is also available as well as complimentary wireless internet and a business center for all executive needs. While in-house, a personalized stationery is ready to acknowledge them as the “Ladies and Gentlemen” staying at the Club and Suite of The Ritz-Carlton Jakarta, Mega Kuningan.

The showcase includes:

- Full American Breakfast
- Light lunch
- Afternoon tea
- Hors d’Oeuvre and Cocktails
- Desserts and Cordials

06.30am - 11.00am
12.00pm - 02.30pm
02.30pm - 04.30pm
05.00pm - 09.00pm
09.00pm - 10.00pm

THE RITZ-CARLTON CLUB LOUNGE



*Perfect combination where
extraordinary meets flawless*

GATHER





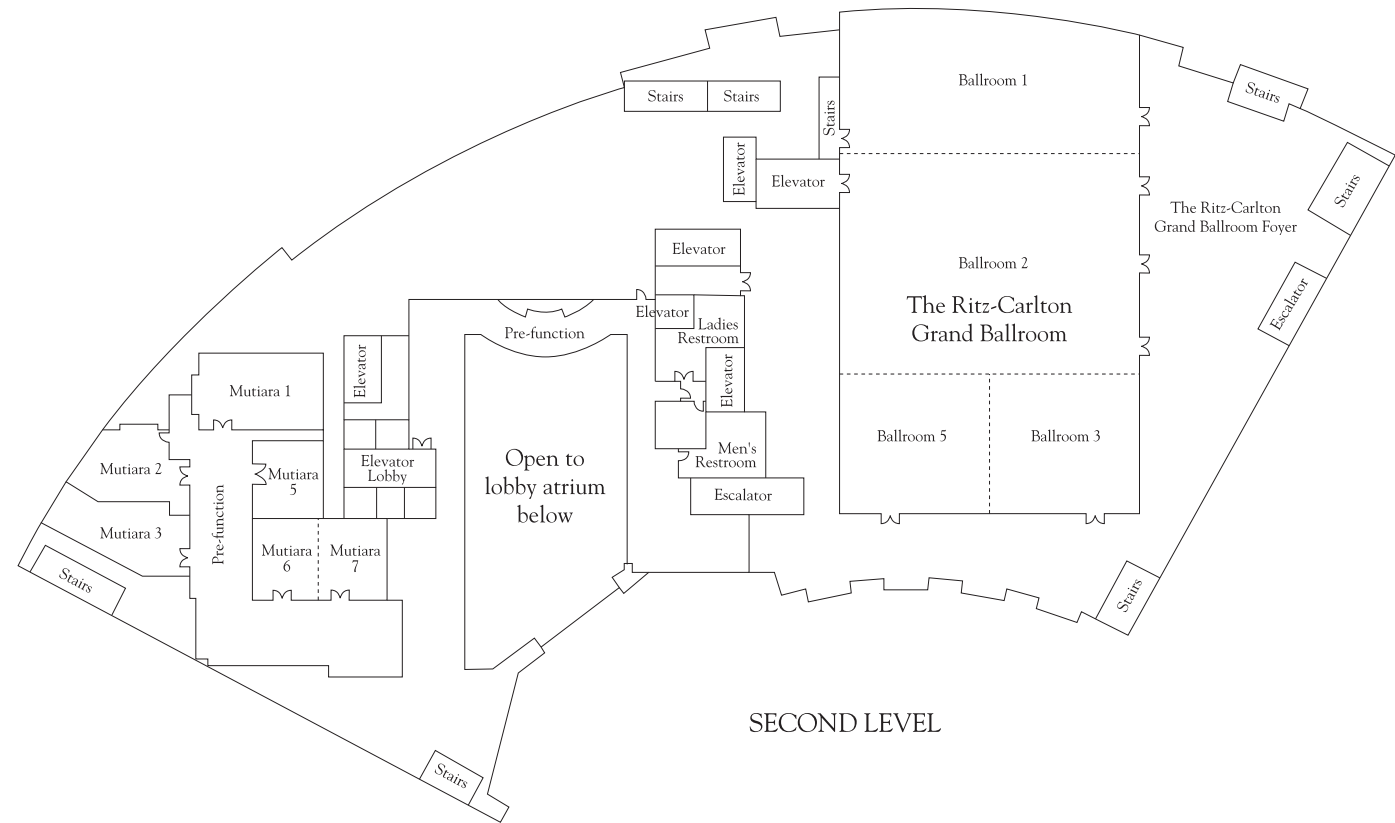

Its convenient location in the Mega Kuningan business district makes the hotel an ideal choice for impressive business and social events. Lavish meeting space ensures unmatched options for flawless execution, featuring the total of 3,934 sqm/42,347 sq ft for Grand Ballroom, Grand Mutiara and other 20 meeting rooms. Impeccable Ritz-Carlton service and amenities include a multilingual conference concierge and staff to attend to every need, a comprehensive Business Center, state-of-the-art audio-visual equipment and technicians, and complete catering and entertainment planning services.









Spacious and exquisite settings enliven the senses. Each guest is a treasured individual who will receive personally tailored attention and customized, immersive experiences creating lasting memories.

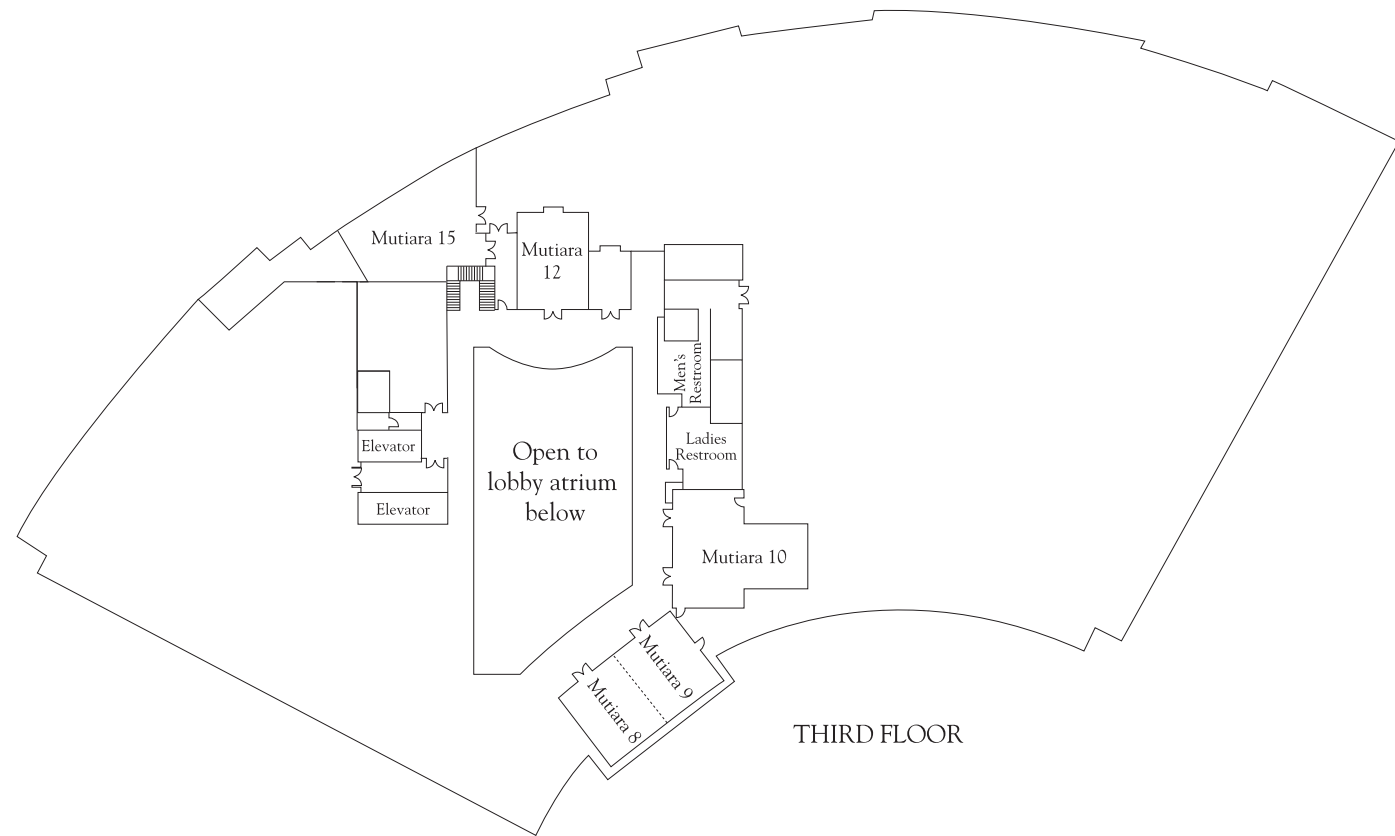



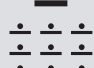

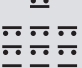

SECOND LEVEL

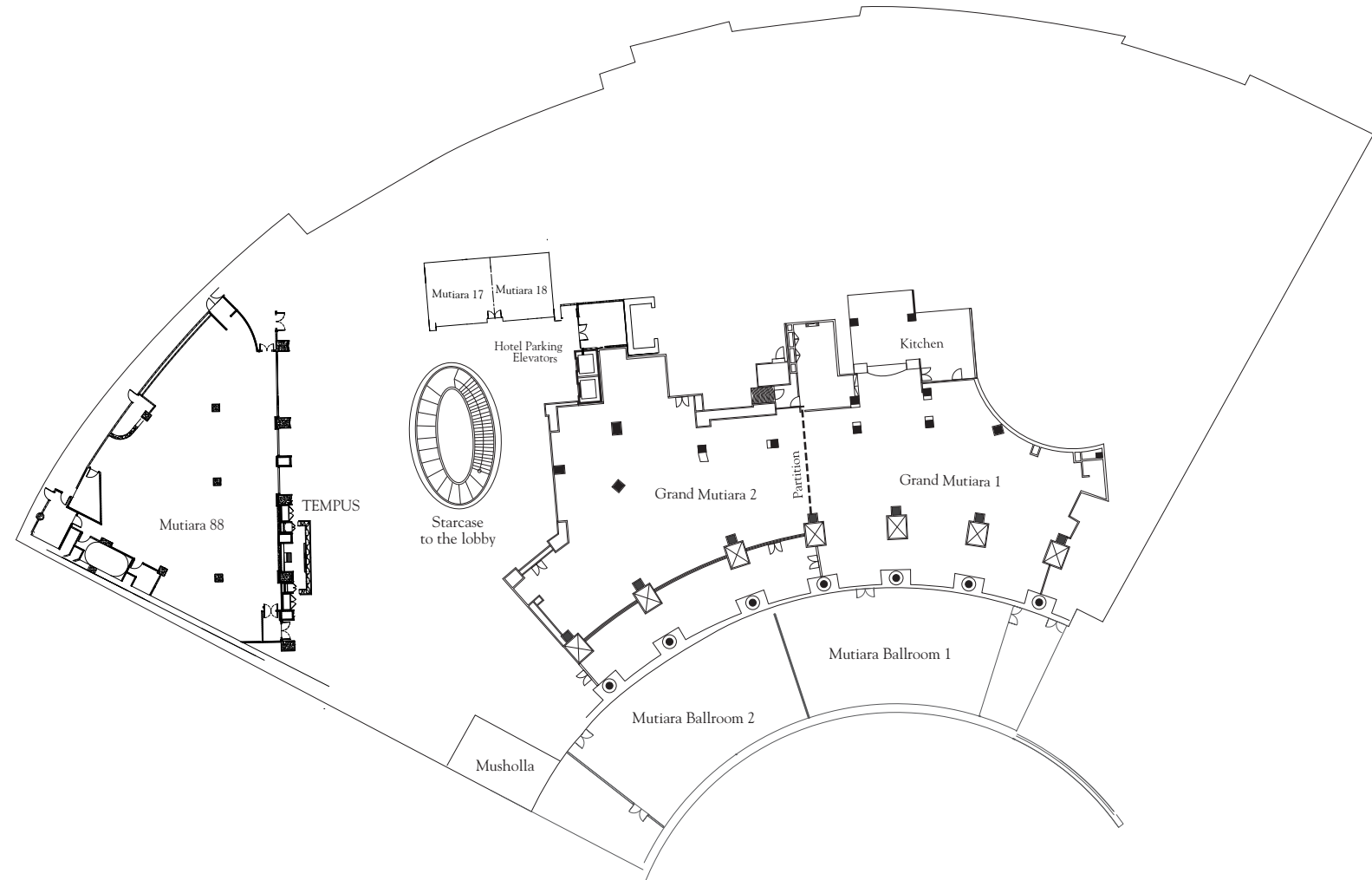
MEETING SPACE	Square Meters	Square Feet	Dimensions Meters	Dimensions Feet	Ceiling Height Meters	Ceiling Height Feet	Reception						
The Ritz-Carlton Grand Ballroom	1,600	15,876	30x50	98x164	6-8	20-26	2,500	900	1,500	-	750	-	-
The Ritz-Carlton Grand Ballroom Foyer	820	8,823	-	-	6	20	500	-	-	-	-	-	-
Ballroom 1	405	4,312	13x30	44x98	6-8	20-26	350	240	400	54	150	78	90
Ballroom 2	675	7,252	22x30	74x98	6-8	20-26	450	280	800	84	270	100	96
											(Double U)		
Ballrooms 1 & 2	1,080	11,564	30x36	98x118	6-8	20-26	900	600	1,000	-	400	-	-
Ballroom 3	210	2,254	12x15	46x49	6-8	20-26	150	120	200	40	90	45	60
Ballroom 5	210	2,254	12x15	46x49	6-8	20-26	150	120	200	40	90	45	60
Ballrooms 3 & 5	420	4,508	12x30	46x98	6-8	20-26	350	240	400	54	150	78	90
Ballrooms 2, 3 & 5	1,095	11,760	30x36.5	98x120	6-8	20-26	900	600	1,000	-	400	-	-
Mutiara 1	108	1,144	8x13.5	26x44	4	14	50	50	80	28	36	27	36
Mutiara 2	56	598	7x8	23x26	4	14	30	20	30	18	18	18	24
Mutiara 3	60	650	7.5x8	25x26	4	14	30	20	30	18	18	18	24
Mutiara 2 & 3	116	1,222	8x14.5	26x47	4	14	60	60	88	36	45	30	36
Mutiara 5	48	520	6x8	20x26	4	14	20	20	40	16	18	18	24
Mutiara 6	48	520	6x8	20x26	4	14	20	20	40	16	18	18	24
Mutiara 7	48	520	6x8	20x26	4	14	20	20	40	16	18	18	24
Mutiara 6 & 7	96	1,014	8x12	26x39	4	14	50	60	100	30	30	30	36

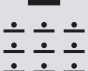

MEETING SPACE	Square Meters	Square Feet	Dimensions		Ceiling Height		Reception						
Mutiara 8	56	598	7x8	23x26	4	14	30	20	30	18	18	18	24
Mutiara 9	56	598	7x8	23x26	4	14	20	20	30	18	18	18	24
Mutiara 8 & 9	112	1,196	8x14	26x46	4	14	60	60	88	36	45	30	36
Mutiara 10	140	832	10x14	32x26	4	14	50	50	100	30	60	36	48
Mutiara 11	24	260	4x6	13x20	4	14	20	10	20	12	12	-	-
Mutiara 12	71	744	7.5x9.5	24x31	4	14	40	40	64	20	24	24	30
Mutiara 15	65	286	10x6.5	11x26	3.8	12	40	45	50	20	35	20	20

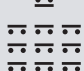

MEETING SPACE	Square Meters	Square Feet	Dimensions Meters Feet		Ceiling Height Meters Feet		Reception						
Grand Mutiara	906	9,752	32x28	102x90	3,3	20	700	230	400	-	220	-	
Grand Mutiara 1	420	4,508	14x30	46x98	3,3	20	300	120	175	35	80	40	50
Grand Mutiara 2	489	5,251	18x27	59x89	3,3	20	350	120	175	35	80	40	50
Mutiara 17 & 18	139,44	1,431	16,6x8,4	53x27	3,3	20	33	70	120	30	65	30	36
Mutiara 88	471	-	-		5	-	300	160	250	30	150	40	50
Mutiara Ballroom	440	-	-		5	-	600	260	350	80	150	80	80
Mutiara Ballroom 1	220	-	-		5	-	300	120	175	40	150	40	40
Mutiara Ballroom 2	220	-	-		5	-	300	120	175	40	150	40	40



SAVOR

*Your culinary journey
begins here*

Asia Restaurant, featuring one of Jakarta's largest island buffet with interactive open-kitchen concept; Lobo, Jakarta's contemporary fine dining restaurant where finest modern European creations are served in a spectacular display of modern interior design for bar, lounge and dining destination.

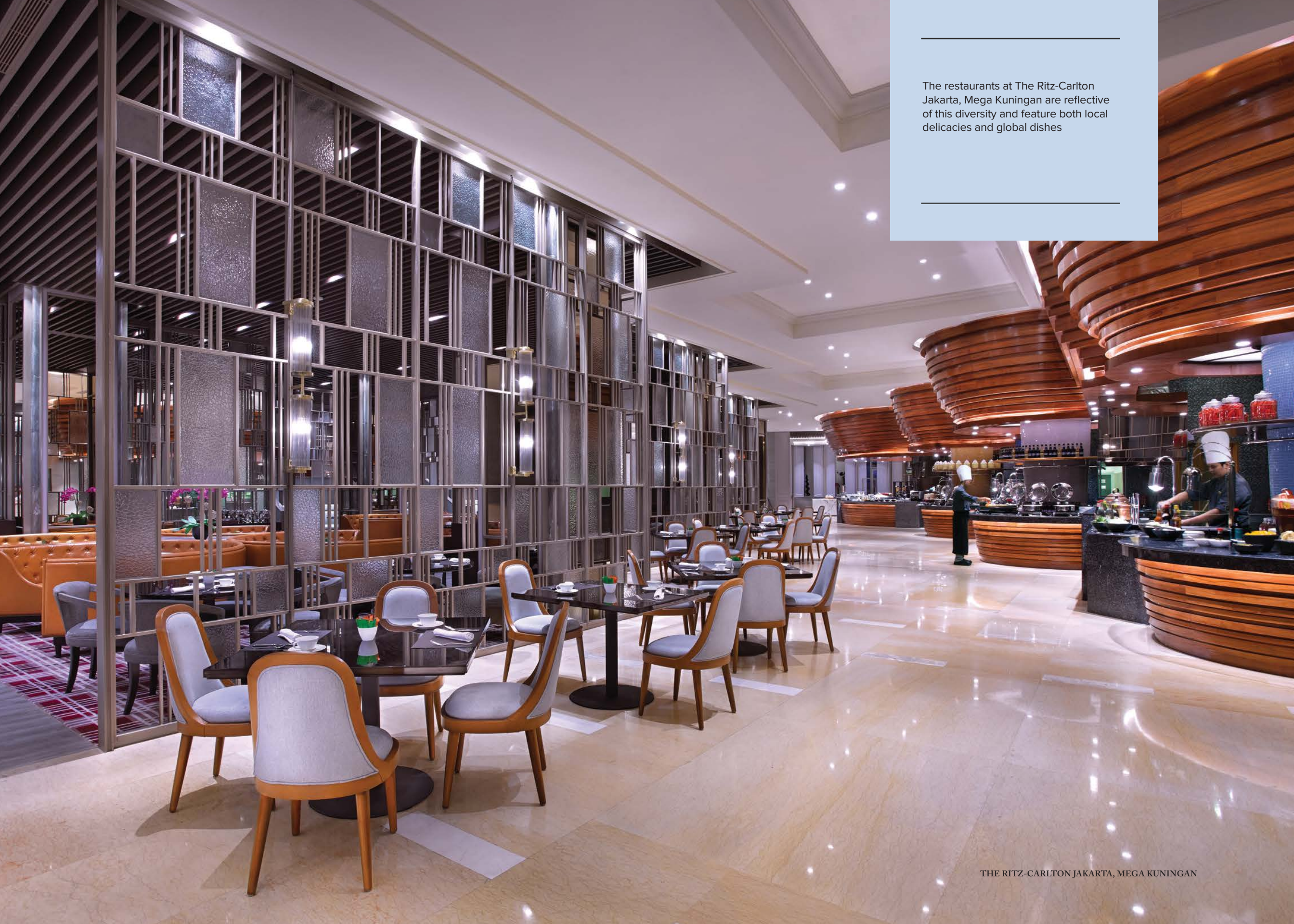

The restaurants at The Ritz-Carlton Jakarta, Mega Kuningan are reflective of this diversity and feature both local delicacies and global dishes

ASIA RESTAURANT



Asia Restaurant offers a blend of distinctive cuisines and vibrant island buffets from Indonesian, Japanese, Chinese, and other Western countries prepared in a relaxed yet sophisticated open kitchen and in the same time allowing guests to see their food prepared on the spot. An emphasis on fresh ingredient ensures flavors of food despite its familiar and uncomplicated style.

The interior of the restaurant mirrored a comfortable and soothing blend that exudes casual elegance. The design element is simple, have granite workshop, with polish and unpolished texture for different finishes. The state-of-the-art induction system keeps the food warm in a stylish manner. The restaurant sitting capacity is able to accommodate more than 292 dining guests, which certain to be Jakarta's most talked about gathering place for informal dining.

Asian restaurants can also provide their personal Wedding Packages with maximum capacity of 300 persons. The package includes Complimentary stay at Mayfair Suite with breakfast, a separate function room for blessing ceremony/tea pai, as well as live music entertainment of 1 pianist and 2 singers.

Asia Restaurant operates seven days a week with buffet:

Breakfast : 06.00 to 10.00

Lunch : 12.00 to 14.30

Dinner : 18.00 to 22.00

A la Cartè : 06.00 to 23.00



LOBO



A fresh and inspiring experience to add to Jakarta's dining out scene.

Situated at the lobby level of the hotel, Lobo features an intimate yet stylish surrounding, positioned as the upscale place 'to see and be seen' that will surely add extra rhythm to the city's pulsating enjoyment of dining out.

The experience begins prior to even entering the restaurant; where guests will be welcomed by the legendary service of the Ritz-Carlton Ladies & Gentlemen. Feel the posh ambiance while the stylish host in elegant long black-dresses will usher guests to the alluring ambiance of the restaurant.

Lobo is classified into three areas, a trendy Bar & Lounge and a well-designed wine cellar offering an attractive setting to every wine and cocktail lover; a restaurant with private dining sections created for guests to savor personalized menus. The panoramic alfresco terrace will allow guests to enjoy a relaxing, under canvas-tented outdoor dining experience, overlooking the city while sipping smooth and trendy cocktails.

Lobo operates seven days a week with buffet:

Lunch : 12.00 to 14.30

Dinner : 18.00 to 23.00





*Embrace soothing luxury
and rejuvenation*

ESCAPE

The Ritz-Carlton Spa® and health club is an 86,100-square-foot/8,000-square-meter facility complete with 19 treatment rooms, relaxation lounges, sauna, steam room, whirlpool and cascading resort-sized pool. The Fitness Center features state-of-the-art weight-training and cardiovascular equipment and a jogging track. 2 couple spa villas with private jacuzzi, decorated with Balinese elements.



spa at The Ritz-Carlton Jakarta, Mega Kuningan offers a peaceful haven where life-enriching treatments bring balance to body, mind, and spirit.

THE RITZ-CARLTON SPA



The Ritz-Carlton, Jakarta which is located in Mega Kuningan proudly offers a haven to guests for reawakening the senses and rediscovering the radiant gently by our own Personal Spa Therapists with their pampering hands and The Ritz-Carlton Spa own luxurious unique recipe.

The Spa Treatments offered are purely crafted by The Ritz-Carlton Spa team and can be tailored to guests' liking. The Spa Treatment features a series of aromatic massage, facials and indulgent fragrant baths for individuals, couples and even family to experience in one of our 19 luxuriously appointed villas including in two private Couple Spa Villas located on the fifth level of The Ritz-Carlton, Jakarta.



FITNESS CENTER



Adjoining The Ritz-Carlton Spa is The Ritz-Carlton Health Club, a state-of-the-art fitness facility which includes a cascading 48.5 meter-long tropical swimming pool, a 350-meter outdoor jogging track and four private Gazebos.

Opening Hours:

Fitness Center: 5 a.m. to 11 p.m.

Swimming Pool : 6.30 a.m. to 9 p.m.

Cardiovascular & Strength Training

- Life Fitness Treadmills
- Life Fitness Elliptical Cross Trainers
- Life Fitness Exercise bikes
- Life Fitness Stair Climber
- Lat Pull Down Pectoral Fly Chest Press
- Shoulder PressCable Cross Over
- Sit Up Table
- Bench PressRow/Rear Deltoid
- Seated Leg Extension
- Seated leg Curl
- Seated Leg Press
- Gluteus
- Smith Press
- Dumbbell racks set
- Rowing Machine
- Adjustable weight bar
- Abdominal Machine
- Back Extensions Pad

Additional Amenities

- 350-meter outdoor jogging track
- Jogging station
- Four private gazebos
- Soft-touch TV screens built in to cardiovascular equipment
- Table tennis
- Dart game

Classes

- Spinning Studio
- Aero Dumbbell
- Step Class
- Flexibility (Yoga)
- Flexi Fusion
- Power Core





*Revel in the inspiring and
exciting surroundings
of Jakarta*

DISCOVER

Jakarta has been called a study in contrasts, yet seamlessly blends a progressive future while embracing rich traditions of the past. With its modern architecture and abundant cultural treasures, this flourishing and diverse capital of Indonesia is the center of commerce, government and entertainment. Its year-round warm climate makes this robust city an ideal destination for both business and leisure travelers.

THE RITZ-CARLTON JAKARTA, MEGA KUNINGAN



Jakarta's top attractions are easily accessible from our Mega Kuningan business district hotel, and our dedicated concierge is happy to assist with a customized itinerary for your stay.



The Rltz-Carlton Jakarta, Mega Kuningan
Jl. DR. Ide Anak Agung Gde Agung Kav. E.1.1 No.1
Kawasan Mega Kuningan Jakarta 12950, Indonesia

Tel: +62 21 2551 8888

 [ritzcarltonjakarta](https://www.instagram.com/ritzcarltonjakarta)



THE RITZ - CARLTON

JAKARTA, MEGA KUNINGAN