

THERMACELL PATIO SHIELD

Mosquito Protection

Patio Shield Multi-Use Torch

KEEP OUT OF REACH OF CHILDREN

CAUTION: See insert for additional
First Aid and Precautions

Active Ingredient:
d-cis/trans allethrin 21.97%
Other Ingredients 78.03%
Total 100.00%
Contains petroleum distillates

Contains:

Mosquito Repeller Unit

Pole

Cover

1 Thermacell Mosquito Repellent Cartridge

3 Thermacell Mosquito Repellent Mats

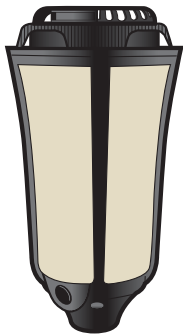

Torch Repeller

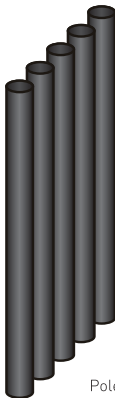

Pole

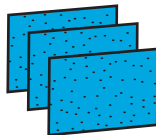

Repellent Mats



Fuel Cartridge

To Use the Mosquito Repellent:

- 1. Insert repellent mat:** Remove cover from torch. Remove one mat from wrapper. Insert mat under grill.



- 2. Insert Thermacell fuel cartridge.** Rotate Torch globe so that arrow points to "OPEN." Remove Thermacell cartridge cap and insert cartridge into opening between battery compartments. Turn cartridge clockwise until it stops. Replace globe onto base, turning until arrow points to "CLOSE".

To Assemble Torch Pole: Assemble the 5 pole pieces by inserting and turning pieces until tight. Insert pole into the ground a minimum of 6 inches until secure. Place torch on pole

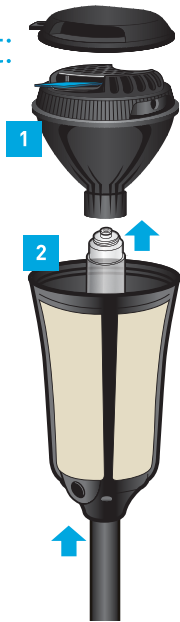

To Use the Mosquito Repellent:

- 3. Turn on:** Rotate torch collar to the right until indicator line points to "ON". The gas will start to flow. Wait 5 to 10 seconds then rotate torch collar until indicator line points to "START" and you hear a clicking sound. To verify that the torch has been activated, look in the oval view hole located on the torch collar to the right of the "START" button. Place torch on pole or lantern stand.
- 4. Turn off:** When finished using, rotate the torch collar to the left until the indicator line points to "OFF". Replace protective cover by inserting cover tab into the small oval cutout on torch top. You may replace protective cover even if grill is still warm. Replacing protective cover on torch ensures product is shut off and protects torch from rain, dirt and debris. Torch cannot be turned on when protective cover is in place. Leave torch outside or store.
- 5. To replace a mat:** When the mat turns white, it is time to replace it. When replacing the mat, make sure indicator line is in the "OFF" position and allow grill to cool. Push the used mat out by inserting a fresh mat.



To Use the Light :

1. Remove torch from torch pole or lantern stand. Rotate torch base so that arrow points to "OPEN" and pull base from globe. Insert 3 AA batteries (not included) in the battery compartments according to the "+ -" signs . The batteries power LED lights and will provide torch light for a maximum of 30 hours.
2. Locate the black button on the side of the torch. Push button to turn light on and off. If torch light does not turn on, check batteries.
3. Replace base, turning until arrow points to "CLOSE". Place torch on pole or lantern stand.

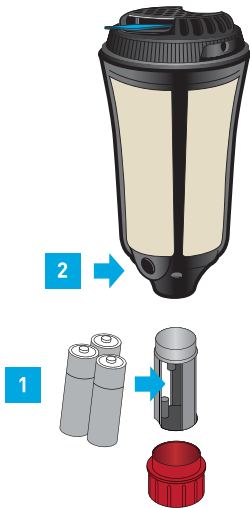

Useful Tips:

Allow 10 to 30 minutes, depending upon the size of the area, for product to take effect. This product works in outdoor areas where there is minimal air movement, such as decks, unenclosed porches, patios, yards and outdoor campsites.

Use one appliance for 15 ft. Use additional devices to cover a larger area.



DIRECTIONS FOR USE

It is a violation of Federal law to use this product in a manner inconsistent with its labeling.

Use Restrictions:

Only for outdoor use as a mosquito repellent.

Do not use indoors, in tents or in any enclosed area. Do not insert anything other than Thermacell® mats into the appliance. Cover or remove all exposed food. Do not leave appliance unattended or use in windy conditions. Do not expose appliance or mats to rain.

Place appliance on a flat, stable surface with the grill facing upward. Do not touch the grill; it will be hot after a couple of minutes. Clean with a damp cloth only when the appliance is cool and inactive. Only Thermacell® mats and cartridges will work in this appliance.

Troubleshooting:

1. If you do not see an orange glow through view window, repeat directions "To Turn ON".
2. If there is still no orange light visible in the view window, make sure the fuel cartridge is completely screwed into place. Repeat "Turn On" directions. Confirm the orange glow is visible.
3. Check the amount of fuel in the cartridge. If cartridge is empty or near empty, remove cartridge and replace with a new cartridge. Repeat "Turn On" directions. Confirm the orange glow is visible.
4. Cartridge may not work at elevations over 7000 ft.

Not sure product is working?

1. Place product upwind for maximum mosquito repellency. Windy conditions can reduce effectiveness.
2. Check the mosquito repellent mat. Mats turn from pale blue to white when it has been depleted. See directions to replace Thermacell mosquito repellent mat.
3. Check the amount of fuel in the cartridge. If cartridge is empty or near empty, remove cartridge and replace with a new Thermacell cartridge. Repeat "Turn On" directions. Confirm the orange glow is visible through view window.
4. Still have questions? Call customer service at 1-866-753-3837 or email service@thermacell.com.

Precautionary Statements:

HAZARDS TO HUMANS & DOMESTIC ANIMALS

CAUTION: Contains petroleum distillates. Harmful if swallowed or absorbed through skin. Causes moderate eye irritation. Avoid contact with skin, eyes or clothing. Wash hands thoroughly with soap and water after handling and before eating, drinking, chewing gum, using tobacco or using the toilet. Remove and wash contaminated clothing before reuse.

FIRST AID

If Swallowed: Call a poison control center or doctor immediately for treatment advice. Do not induce vomiting unless told to do so by a poison control center or doctor. Do not give **any** liquid to the person. Do not give anything by mouth to an unconscious person.

If On Skin Or Clothing: Take off contaminated clothing. Rinse skin immediately with plenty of water for 15-20 minutes. Call a poison control center or doctor for treatment advice.

If In Eyes: Hold eye open and rinse slowly and gently with water for 15-20 minutes. Remove contact lenses, if present, after the first 5 minutes, then continue rinsing eyes. Call a poison control center or doctor for treatment advice.

Have the product container or label with you when calling a poison control center or doctor, or going for treatment. For additional information on this pesticide product (including health concerns, medical emergencies or pesticide incidents), you may call 1-866-753-3837, Monday through Friday, 8:30 AM to 4:30 PM EST.

After 4:30 PM, call your poison control center.

Note to Physician: Contains petroleum distillate. Vomiting may cause aspiration pneumonia.

PHYSICAL AND CHEMICAL HAZARDS

Hazard: Extremely flammable. Contents under pressure. Vapors may cause flash fire. Use only in a well ventilated area. Do not use, store, or dispose near heat, sparks, or flames. Do not puncture or incinerate. Containers exposed to direct sunlight or otherwise heated above 120°F (49°C) may burst. Store in cool, dry area. Intentional misuse by deliberately concentrating and inhaling the contents may be harmful or fatal. If vapors are inhaled, remove person to fresh air.

BATTERIES

Use only with AA batteries. Do not pry battery with any instrument or tool or put in a fire. Battery may burst or release toxic materials.

ENVIRONMENTAL HAZARDS

This product is toxic to fish and aquatic invertebrates. Do not apply directly to water. Do not contaminate water when cleaning equipment or disposing of equipment washwater or rinsate. Drift may be hazardous to aquatic organisms in water adjacent to treated areas.

STORAGE AND DISPOSAL

Do not contaminate water, food or feed by storage or disposal.

Pesticide Storage: Store unused mats in original box in a cool, dry place inaccessible to children and pets. Store appliance and fuel cartridges in original box in a cool, dry place away from sources of heat. Store device on post with cover closed. Store batteries in cool, dry place away from heat or open flame. **Pesticide Disposal and**

Container Handling: Non- refillable container; do not refill or reuse this container. **If cartridge is empty or for used mats:** Do not reuse empty packaging, wrappers or cartridges. Do not puncture or incinerate empty cartridges. Place in trash or offer for recycling if available. **If cartridge is partly filled or for unused mats:** Call your local solid waste agency for disposal instructions. Never place unused mats down any indoor or outdoor drain. **For unwanted appliance:** Place in trash or offer for recycling if available.

WARRANTY AND DISCLAIMERS

To the extent applicable by law, seller will not be held responsible for damage, injury or poor performance caused by use of other fuel cartridges or repellent mats. Seller is not responsible for damage caused by using this fuel cartridge in other fuel products.



Thermacell Repellents, Inc.

26 Crosby Drive,
Bedford, MA 01730

Email: Service@thermacell.com

Toll Free 866-753-3837