



# The Portable Power Pack that can also JUMP START YOUR CAR!

## INSTRUCTION MANUAL

For More Tips and Instructional Videos Please Visit [MiniMaxTips.com](http://MiniMaxTips.com)  
Or Scan The QR Code



Make sure you read all instructions and warnings on this sheet prior to using your MiniMax™ Charger. Keep this instruction sheet for future reference.

### IMPORTANT SAFETY INSTRUCTIONS

- ONLY use the MiniMax™ Charger on vehicles with 12v batteries. Using with any other vehicle is dangerous for you and the vehicle.
- Before use to jump start your vehicle, make sure you read your vehicle's owner's manual to see if the manufacturer allows jump-starts.
- Carefully examine your battery for any damage, cracks, corrosion or leaks. If you notice any damage, or if the battery is frozen, DO NOT jump start the car. JUMP-STARTING A DAMAGED BATTERY IS EXTREMELY DANGEROUS. Call a tow truck or mechanic.
- NEVER expose MiniMax™ Charger to moisture or rain. Do not submerge in water.
- NEVER expose MiniMax™ Charger to heat, fire, or flammable liquids.
- ONLY charge MiniMax™ Charger if the temperature is between 32° F (0° C) and 114° F (46° C).
- Keep this product away from children.
- DO NOT use this product for anything other than its intended use.
- DO NOT insert foreign objects into outputs or inputs.
- Make sure you use this product in a dry, well-ventilated area away from dust or flammable fumes.
- Make sure the metal teeth of the red and black clamps never touch one another to avoid risk of serious injury.
- NEVER connect the black clamp to your vehicle battery's positive (+) terminal or the red clamp to the (-) terminal.
- If the jumper cables are hooked up incorrectly, you could harm yourself, blow a fuse or ruin your car's computer system. This could lead to serious problems and costly repairs.
- DO NOT open the MiniMax™ Charger to try to replace the internal battery or any parts.
- DO NOT store the MiniMax™ Charger in temperatures over 86°F (30°C) or under -4°F (-20°C) as it may decrease performance.
- **Do not expose the MiniMax™ Charger to temperatures over 140°F (60°C), it is a safety hazard.**
- In the rare event that corrosive liquid leaks from the MiniMax™ Charger, discontinue use. Wash skin or eyes with running water and contact a doctor.
- **Your car needs to be off with the keys out of the ignition. If you have a smart key, make sure it is in the OFF mode.**
- Your MiniMax™ Charger has a lithium-ion battery which must be disposed of properly when it no longer performs. Please recycle at an approved facility.
- Before charging your electronic device, check your electronic device's packaging or instructions to make sure it is compatible with a portable device charger like the MiniMax™ Charger.

### CHARGING YOUR MINIMAX™ CHARGER

**Important: Your MiniMax™ Charger will arrive without being fully charged.** We recommend charging the Minimax™ Charger to full capacity before using. Charge the battery using the included Micro-USB cable and plug the USB end into a standard USB outlet, or plug into the included USB car charger. Plug the Micro-USB end of the cable into the bottom Micro-USB adapter input port on the MiniMax™ charger.

**NOTE:** You can also charge the MiniMax™ Charger using a 13V AC Wall Adapter, which is not included. Plug the AC Wall Adapter into a standard wall outlet, and plug the other end of the cable into the top DC adapter input port on the MiniMax™ Charger.

**NOTE:** if using the car adapter, the MiniMax™ Charger may not charge unless your vehicle is running.



**Important: Your MiniMax™ Charger will lose power over time. To ensure that there is always enough power to jump your battery, please fully charge your MiniMax™ Charger every 6 months.**

## JUMP-STARTING YOUR VEHICLE (BOAT, ATV)

**WARNING:** As soon as the jumper cables are connected to the MiniMax™ Charger, the Jumper Cables will be live with 12V of power. Make sure the jumper cables are attached correctly to your vehicle's battery before plugging into your MiniMax™ Charger.

- Put the vehicle in park (neutral if it is a manual transmission) and engage the parking brakes. Turn off the headlights, radio, blinkers, and accessories and disconnect any plugged-in accessories to avoid damage. Turn off the engine and all electrical components, and remove the key. Open the hood and locate the battery.
- Remove all protective battery post covers so that there is an exposed conductive metal post for attaching the cables. Connect the jumper cables one at a time in the following order:

1 Connect the black/negative (-) clamp to the negative (-) post on the car battery.  
2 Connect the red/positive (+) clamp to the positive (+) post on the car battery.

3 Plug the Jumper Cable connector into the Jumper Cable Port on the top of the MiniMax™ Charger by lifting off the top cap and matching the (+) and (-) sides on the connector end to the port holes.

4 Set the MiniMax™ Charger on top of your car battery or on a stable surface away from the engine and turn the MiniMax™ Charger ON.  
**NOTE:** For best results, make sure the MiniMax™ Charger has a full charge and all LEDs are on.

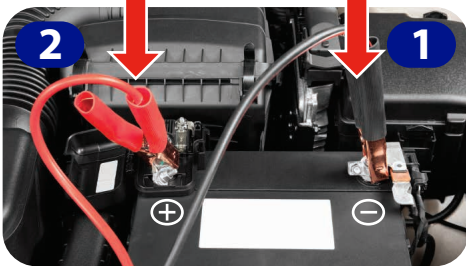

### 5 START THE DISABLED VEHICLE

- Turn the MiniMax™ Charger ON, then start your vehicle. If the engine doesn't start after 3 seconds, turn the engine OFF.
- Disconnect the Jumper Cable from the MiniMax™ Charger, and wait 60 seconds. Try adjusting the clamps slightly to make sure they make a solid connection with metal terminals. Connect the Jumper Cable to the MiniMax™ Charger, and try starting your vehicle again.
- DO NOT leave MiniMax™ Charger connected to the battery for more than 30 seconds as it may become damaged.** If it doesn't start after 30 seconds, the vehicle issue may not be related to the battery. Call a tow truck or mechanic.
- After your vehicle starts, disconnect the Jumper Cable from your MiniMax™ Charger and turn your MiniMax™ Charger OFF. Next, carefully remove the Jumper Cable clamps from your vehicle's battery, removing the black/negative(-) clamp first. Replace all protective battery post covers. Keep your vehicle running for 15 minutes to charge the vehicle's battery.

## CHARGING YOUR PHONE AND DEVICES

Before charging your electronic device, check your electronic device's packaging or instructions to make sure it is compatible with a portable device charger like the MiniMax™ Charger. The MiniMax™ Charger charges your phone, tablet, and other portable electronic devices. Plug the USB cable into the top part of the MiniMax™ Charger, then into your device, to begin charging.

**NOTE:** You can also charge the MiniMax™ Charger using a 13V AC Wall Adapter, which is not included. Plug the AC Wall Adapter into a standard wall outlet, and plug the other end of the cable into the top DC adapter input port on the MiniMax™ Charger.

**NOTE:** if using the car adapter, the MiniMax™ Charger may not charge unless your vehicle is running.

## STORING YOUR MINIMAX™ CHARGER

The MiniMax™ Charger stores in your pocket, purse, or glove box.

**NOTE:** Do not store in a place exposed to direct sunlight.

## USING THE FLASHLIGHT

Press and hold the ON/Off button for about 3 seconds to engage the LED flashlight mode, then press it once to switch to strobe, a 2nd time to go to SOS mode, and a 3rd time to turn it off.



This device complies with part 15 of the FCC Rules. Operation is subject to the following two conditions:

- (1) This device may not cause harmful interference, and
- (2) this device must accept any interference received, including interference that may cause undesired operation.

- Warning: Changes or modifications to this unit not expressly approved by the party responsible for compliance could void the user's authority to operate the equipment.

- NOTE: This equipment has been tested and found to comply with the limits for a Class B digital device, pursuant to Part 15 of the FCC Rules. These limits are designed to provide reasonable protection against harmful interference in a residential installation. This equipment generates, uses, and can radiate radio frequency energy and, if not installed and used in accordance with the instructions, may cause harmful interference to radio communications.

However, there is no guarantee that interference will not occur in a particular installation. If this equipment does cause harmful interference to radio or television reception, which can be determined by turning the equipment off and on, the user is encouraged to try to correct the interference by one or more of the following measures:

- \*Reorient or relocate the receiving antenna.
- \*Increase the separation between the equipment and receiver.
- \*Connect the equipment into an outlet on a circuit different from that to which the receiver is connected.
- \*Consult the dealer or an experienced radio/TV technician for help.