

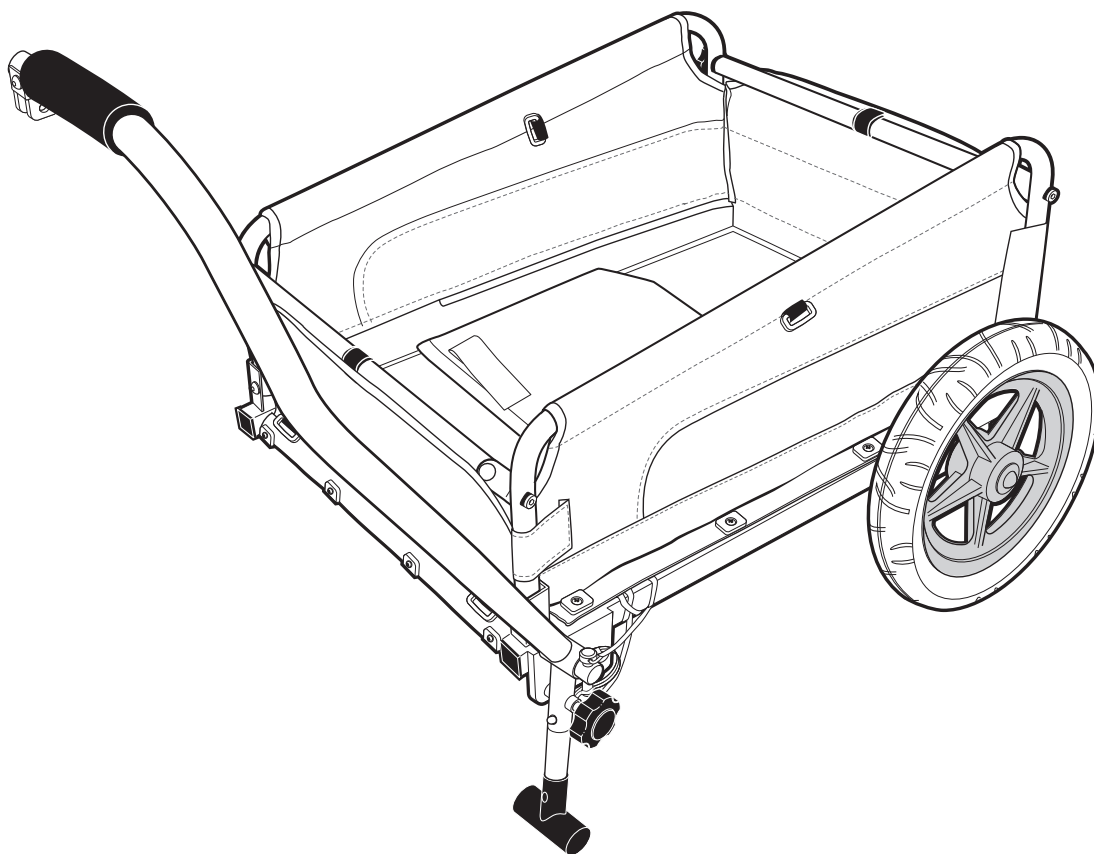

Owner's Instructions and Safety Manual



SwitcharooTM series
Performance Bicycle Trailers

Contents

1. Trailer Components
2. Tow Bar and Hitch Components
3. Assembling Your Trailer
4. Attaching the Wheels
5. Securing the Tow Arm
6. Attaching the Trailer to a Bike
7. Cargo Storage and Configuration
8. Configuring as a Wagon
9. Folding your Trailer
10. Maintenance, Storage and Customer Service
11. Safety Warnings

Caution!

Biking and bicycle touring are increasingly popular recreational activities. Your new trailer is designed and constructed to provide a portable, comfortable and sturdy addition to your outdoor ventures. Please read the instruction manual and all safety warnings closely before using your trailer and keep manuals for future use. For questions or additional information please visit www.cyclicsports.com or email us at service@cyclicsports.com

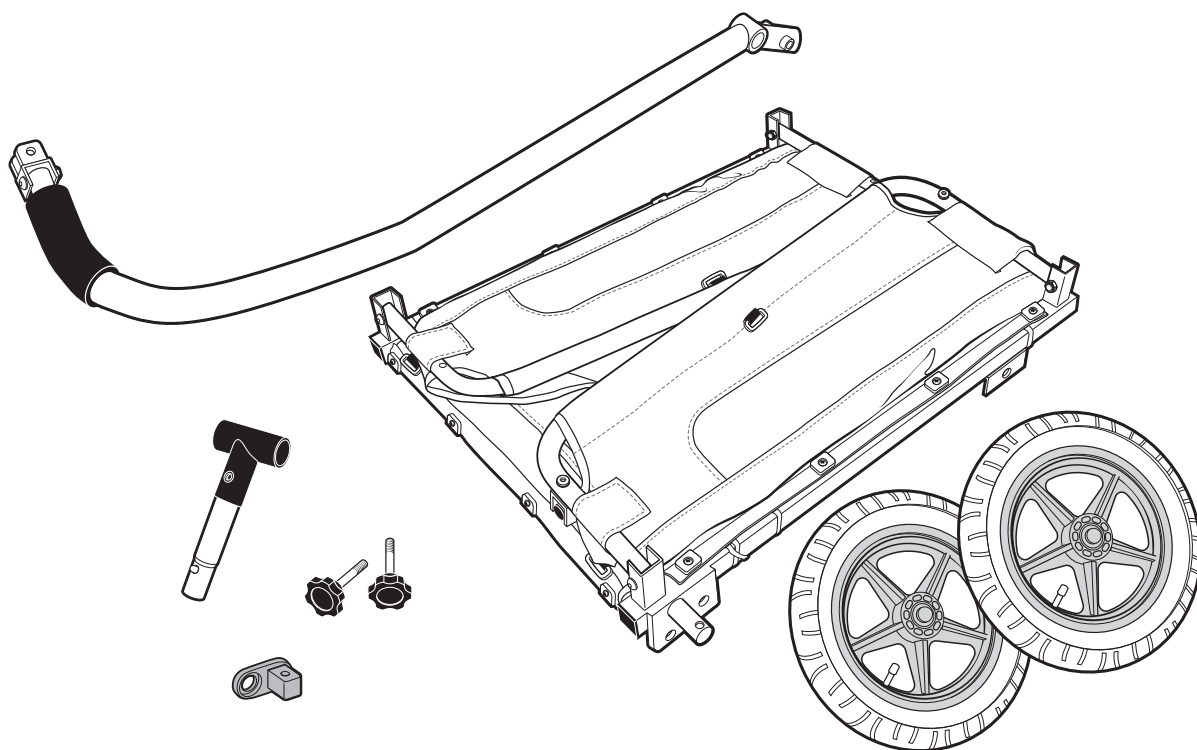

Package Contents:

Trailer body, 2 rear wheels, tow bar with hitch connector, kick-stand, 2 small screw-knobs, one large screw knobs (tethered) and a printed manual

Required Tools:

10mm wrench (for attaching to non quick release bicycles only)

Trailer Mode

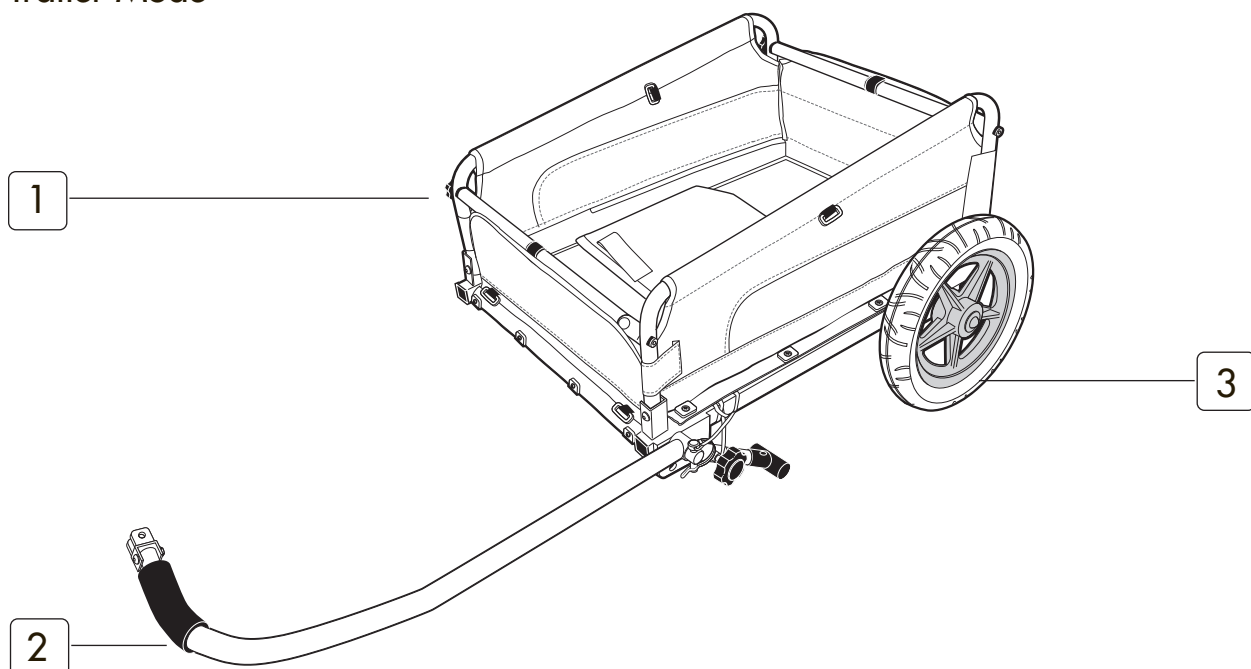

Wagon Mode

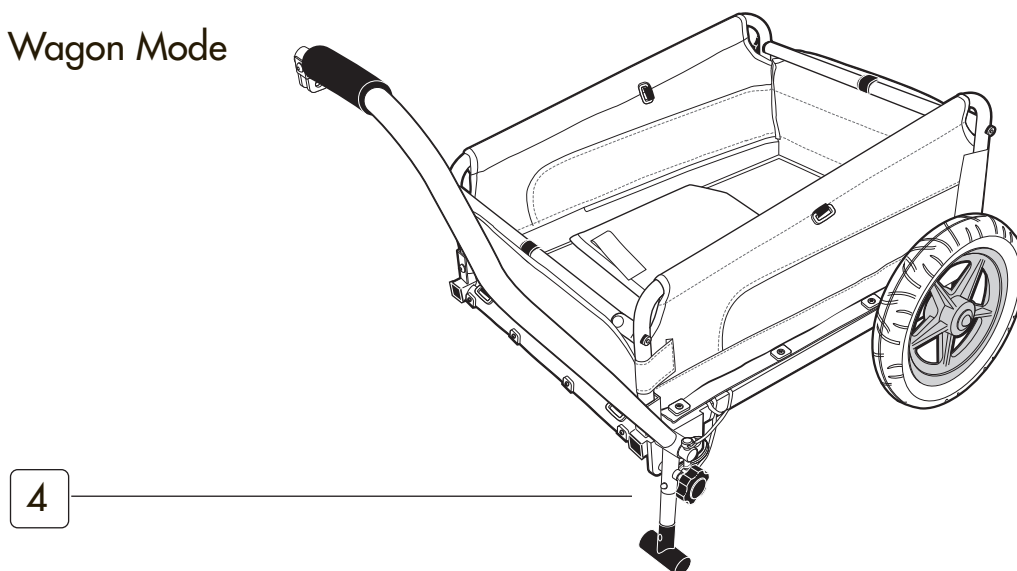

Trailer Components

- 1. Trailer body
- 2. Tow bar and hitch connector
- 3. Rear wheels

Wagon Components

- 4. Kick-stand

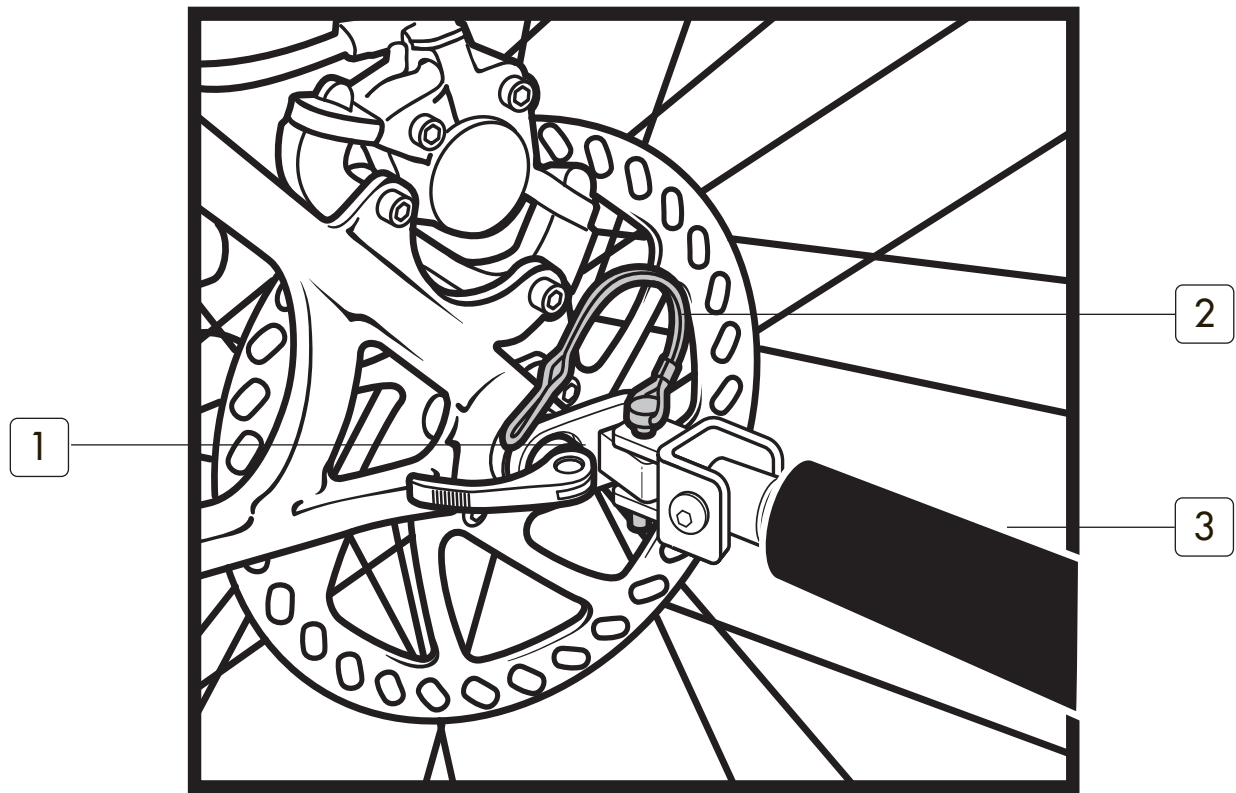

Tow Bar and Hitch Connector Components

1. Hitch connector
2. Lock pin
3. Tow bar

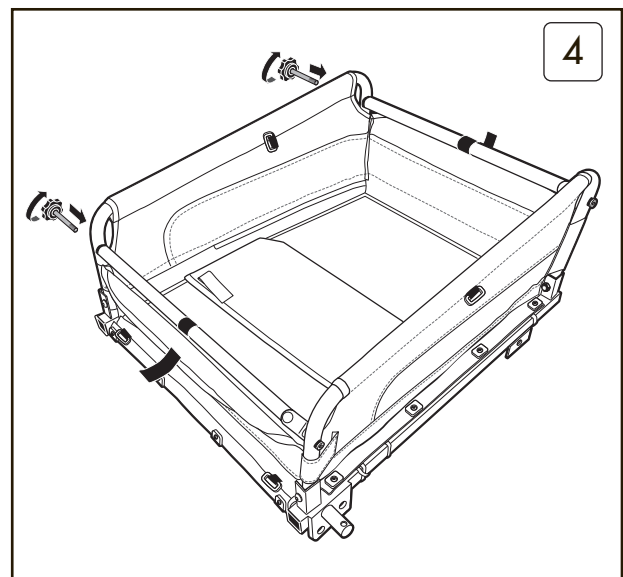
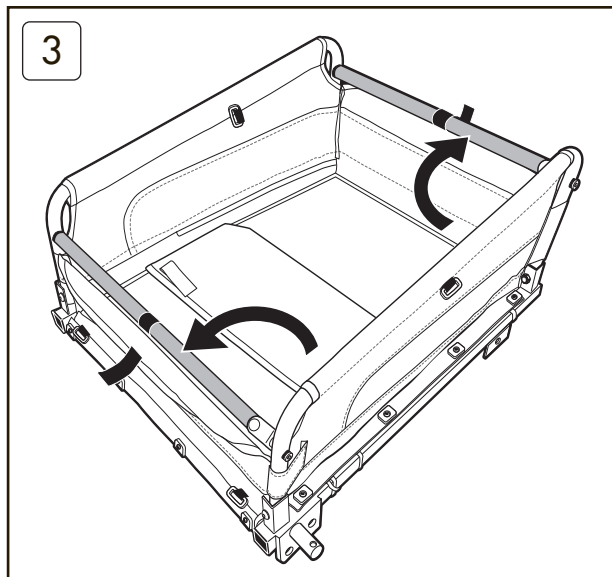
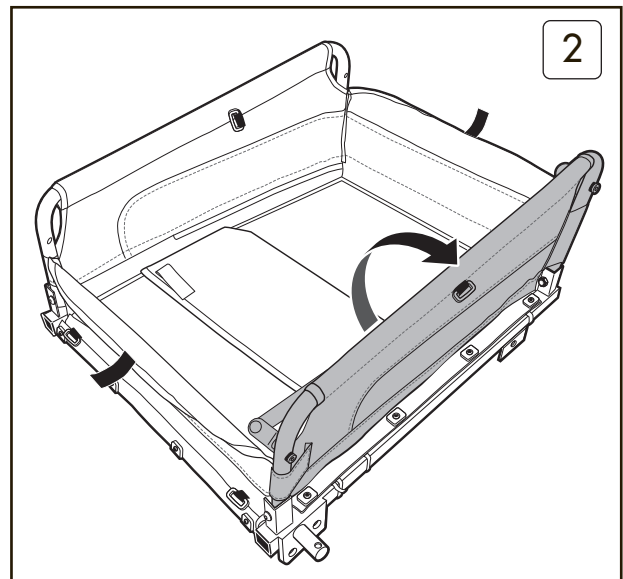
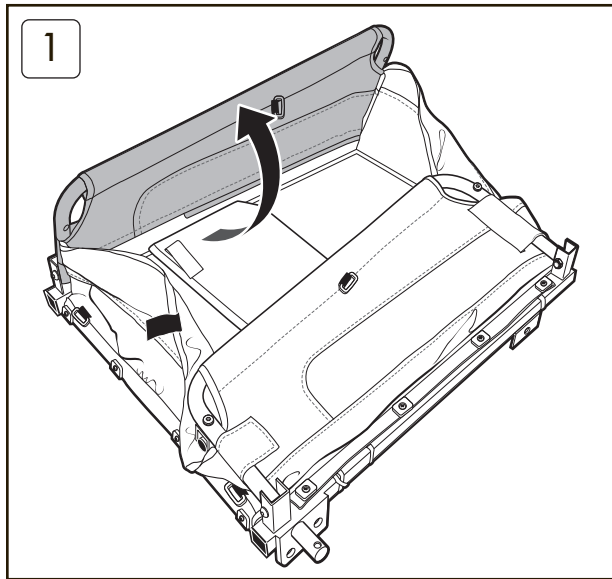

Assembling your Trailer

1. Remove the trailer parts from the box. Set the main trailer body flat on the ground with the black side down.
2. Lift the side wall up (fig 1) and repeat with the opposite side (fig 2).
3. Swing the cross arms into place and locate onto the frame to align with the through hole on the frame. (fig 3)
4. Secure the cross arms with the two screw-knobs as shown. Fasten until hand tight. (fig 4)
5. Secure the front and rear fabric walls onto the crossbars with the velcro tabs.

Using Lock Pin & Spring Clip Fasteners

To use the lock pin and spring clip fasteners, insert the pin at attachment point until it pushes through the opposite hole. Rotate the spring clip up and over until it snaps into place over the pin head. To unlock, reverse order.

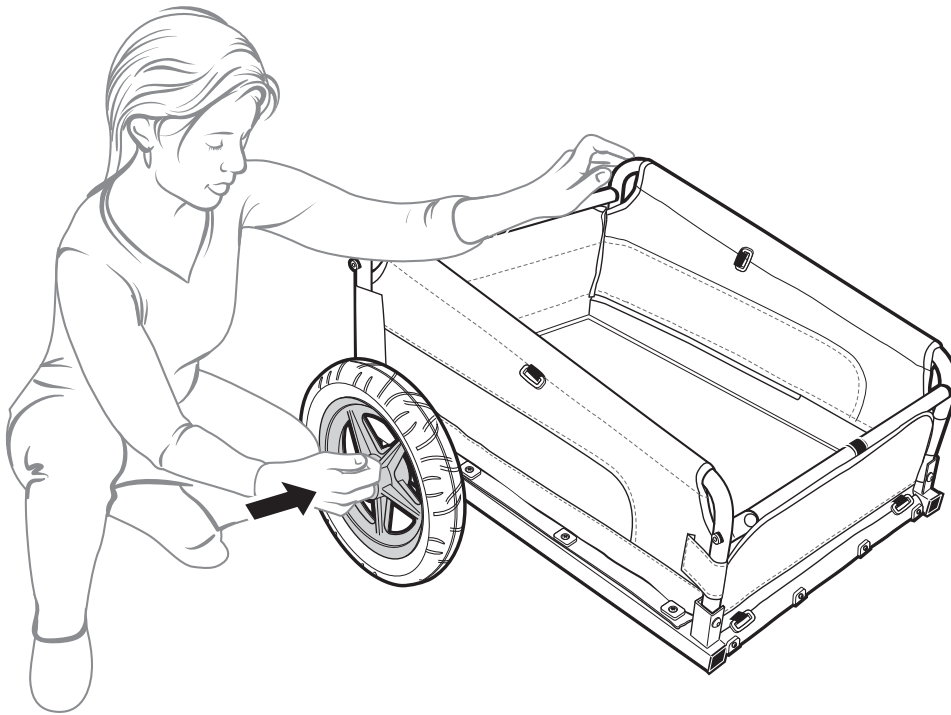
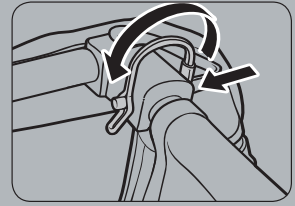

Attaching the Wheels

1. Insert the wheel axle into the axle receiver on the trailer body as shown.
2. Locate the through-hole on the wheel axle and secure the wheel by using the tethered spring clip pin.
2. Pull firmly on the wheel to confirm the axle is fully secure.

WARNING! You must make certain the frame and wheels are locked before using the trailer. Failure to do so could result in serious injury. Make sure the cabin assembly is securely locked together in place before use.

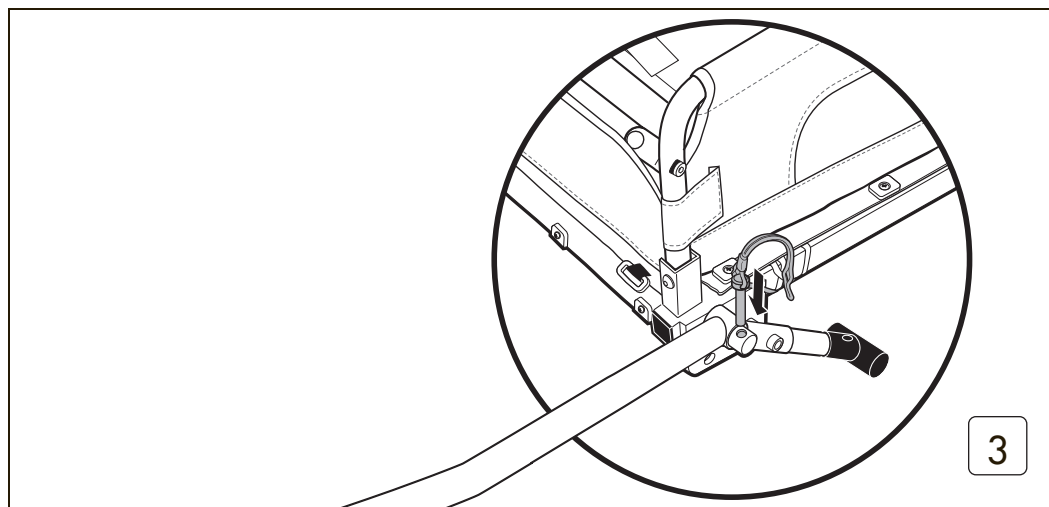
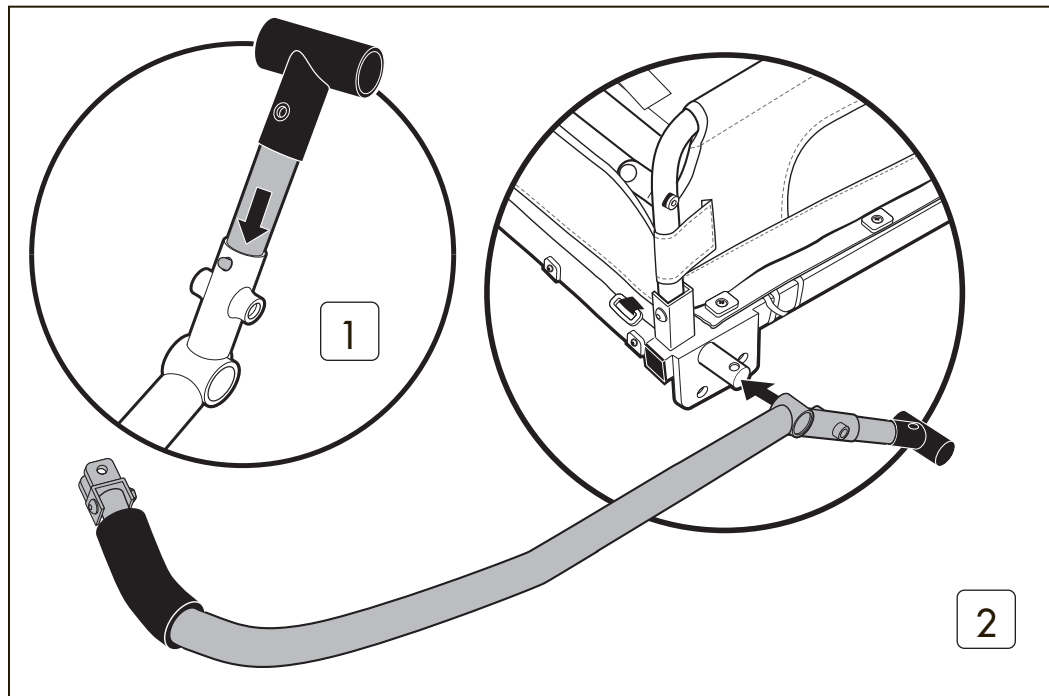

Securing the Tow/Pull Arm

1. Attach the kick-stand by inserting the stand into the end of the tow arm until the spring-pin engages. (fig 1)
2. Attach the tow arm onto the trailer frame as shown and secure with the lock-pin (fig 2 and fig 3)

WARNING! Check this pin periodically during and before each use to be sure it has not become loose. Failure to do so could result in serious injury.

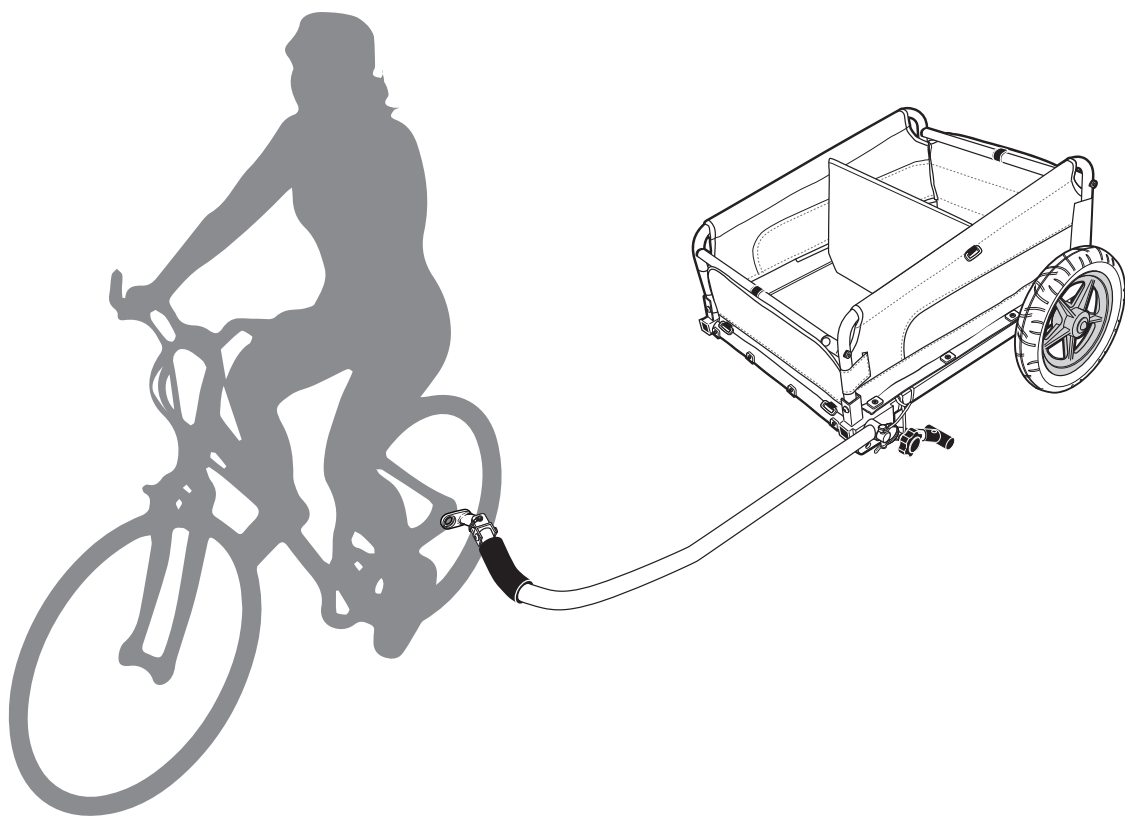

Attaching the Trailer to a Bike

Your trailer is designed to attach easily to just about any full-size bicycle. Once installed the hitch connector can be left on the bicycle and the trailer released using the spring clip.

The hitch fitting must be attached to the left rear axle of the bike. Do not attach to any cycle where it cannot attach to the axle. It is recommended that the bicycle(s) to which the trailer will be attached undergo a safety check by a qualified bicycle mechanic before attaching the trailer to it. This trailer is not designed to be used with electric bikes or motorcycles.

Note: Additional hitch connectors for use on multiple bikes can be purchased at www.cyclicsports.com.

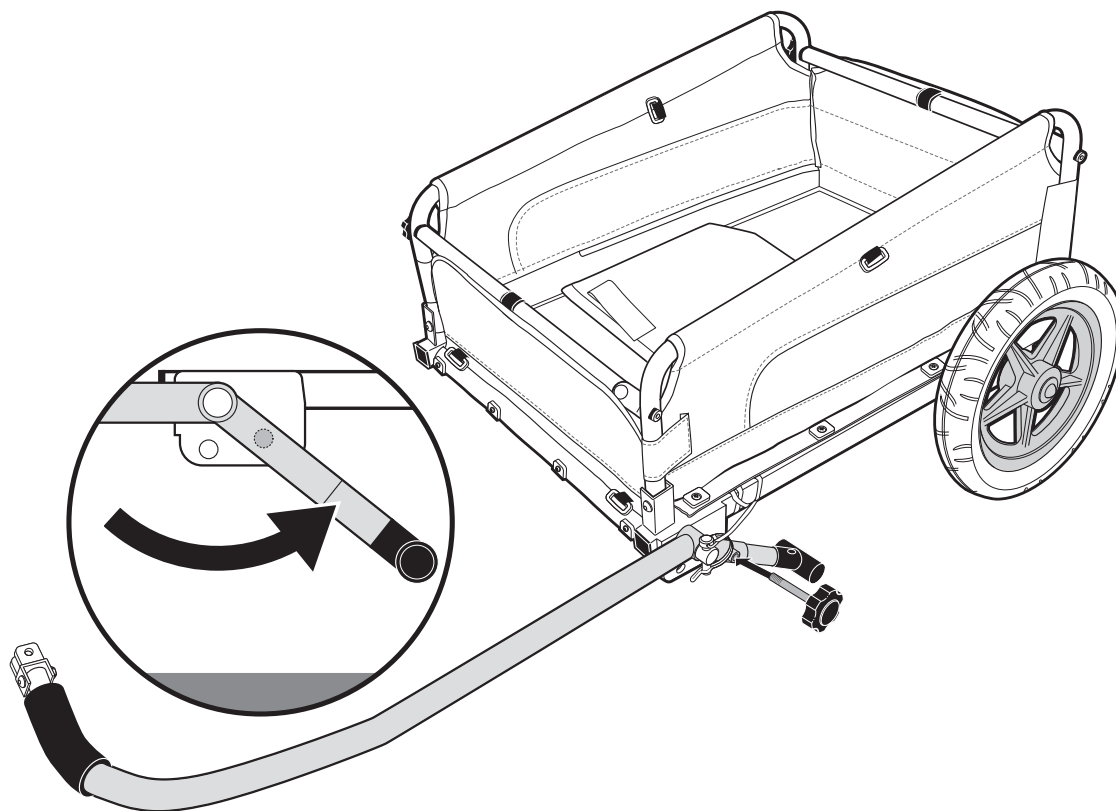

Attaching the Trailer to a Bike

Position the tow arm into a horizontal position as shown and secure with the large screw-knob as shown.

WARNING! Check this pin periodically during and before each use to be sure it has not become loose. Failure to do so could result in serious injury.

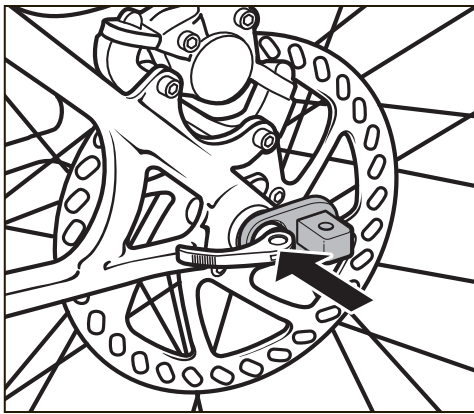

1

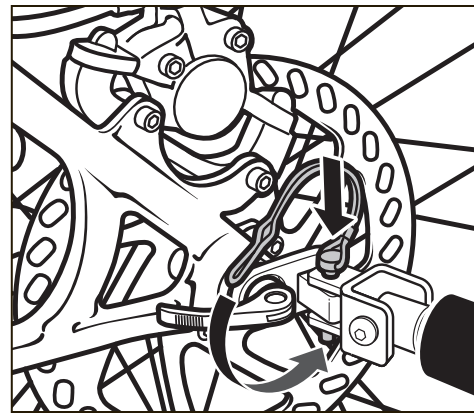

3

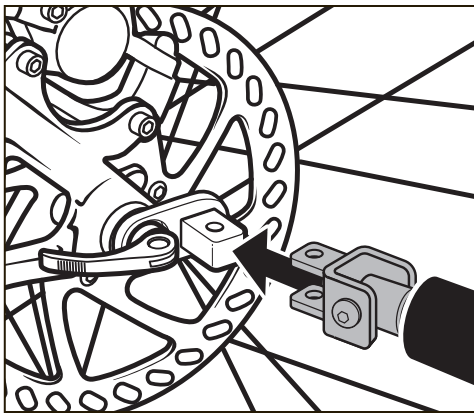

2

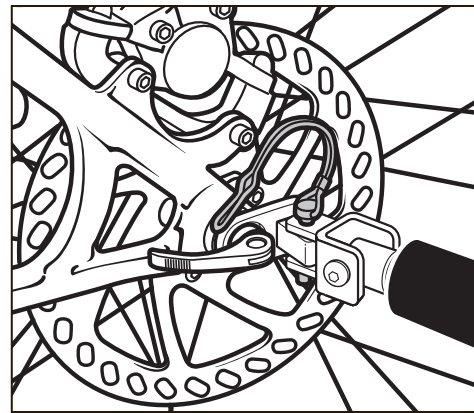

4

Attaching the Trailer to a Bike

1. Remove the quick release or nut from the left side of the bikes rear axle. Install the hitch connector between the quick release or nut and the bike frame. Tighten the quick release or nut according to the manufacturers recommendation.
2. Insert the flex connector onto the hitch connector. Insert the lock pin and close the spring clip. Wrap the safety strap around the frame of the bike and latch to the D-ring on the tow bar.

WARNING! Safety strap must attach to the bike frame when using this product in trailer mode.

Quick -release lock pin must be in place and locked before riding.

The height of the hitch clamp shall not exceed 15.7in (400mm) above the road surface and the standard drawbar load shall be between 30 and 80N.

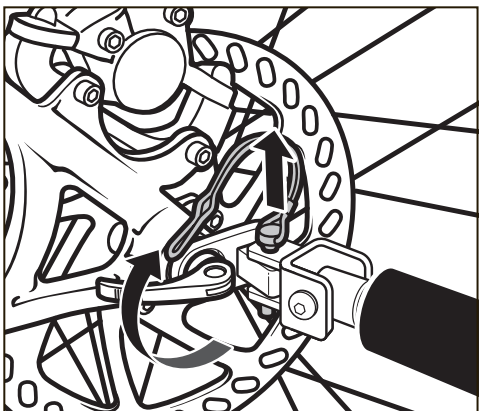

1

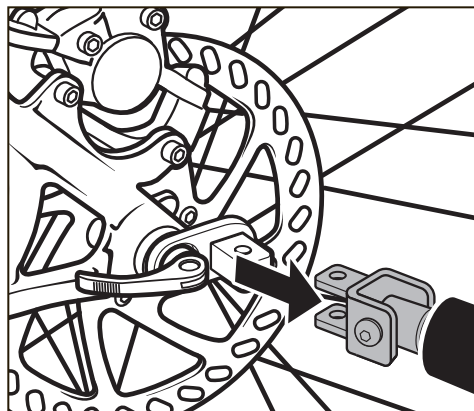

2

Removing the Trailer from the Bike

1. Remove the safety strap by releasing the clip on the D-ring. Remove the quick-release lock pin to release the flex connector and trailer. The hitch connector can remain on the bike when the trailer is removed.

Note: Additional hitch connectors for use on multiple bikes can be purchased at www.cyclicsports.com.

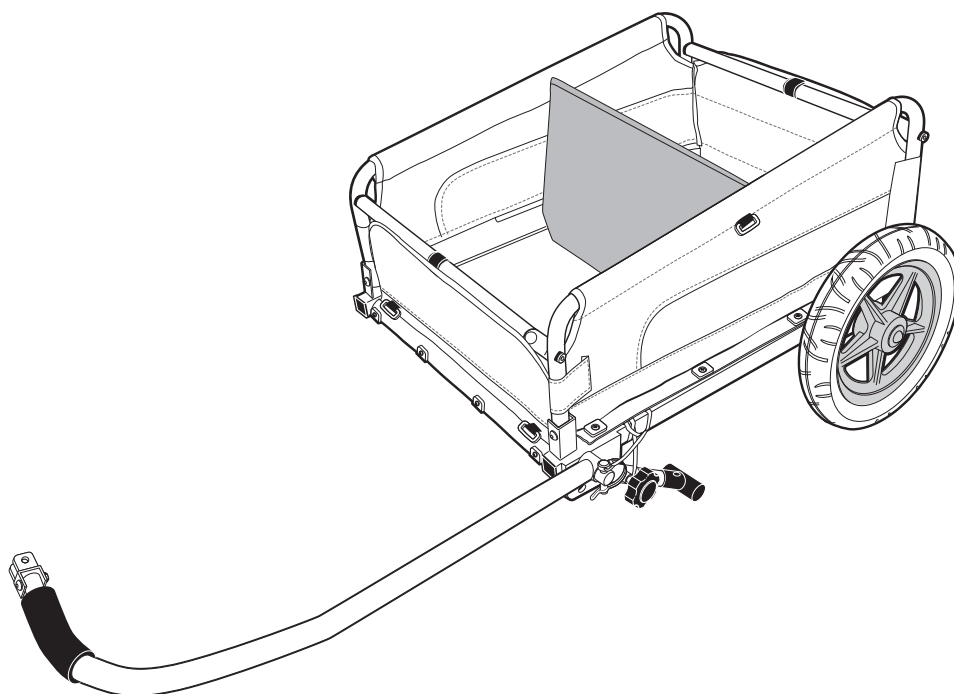

Cargo Storage and Configuration

The trailer includes a divider panel which can be configured to divide and hold cargo securely. To use, attach the velcro tabs onto the side anchors. The panel can also be completely removed by unzipping along the zipper at the panel base.

WARNING! NOT FOR USE WITH CHILDREN OR PETS. DO NOT transport flammable or toxic materials. Distribute cargo carefully and evenly. Unevenly loaded items may cause the trailer to become unstable. Failure to comply with this warning could result in serious injury.

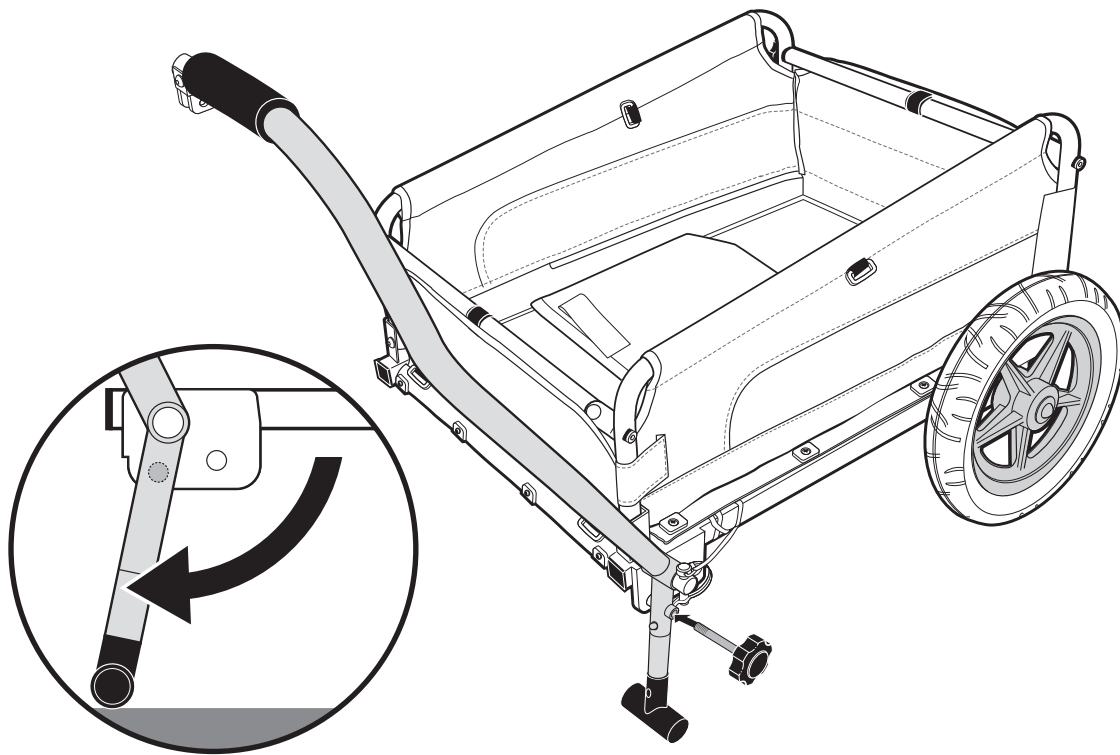

Configuring as a Wagon

1. If the vehicle is in trailer mode, unscrew the large screw knob at the tow arm anchor.
2. Rotate the tow arm 45 degrees upwards and align the screw knob through-hole.
3. Seure the arm in place by fastening into place using the large screw-knob.

Check this pin periodically during and before each use to be sure it has not become loose. Failure to do so could result in serious injury.

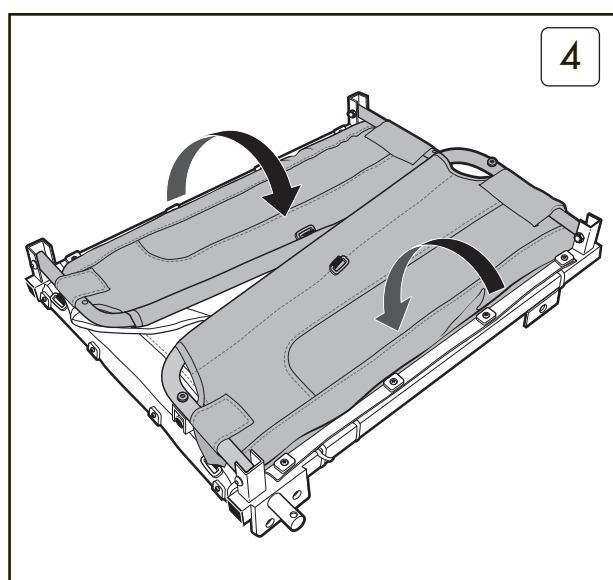
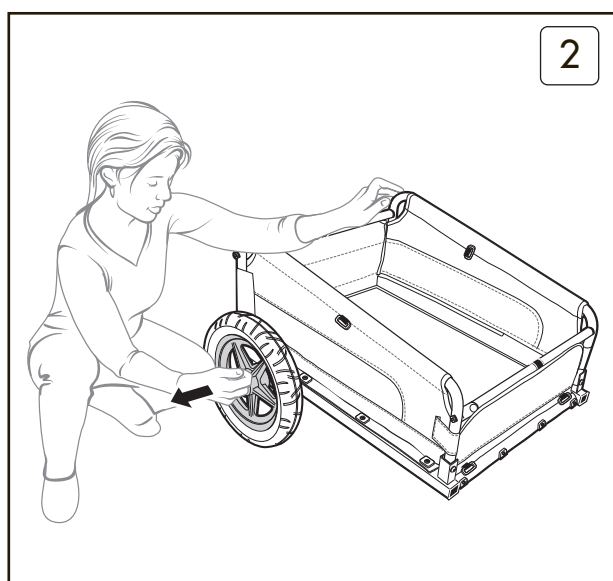
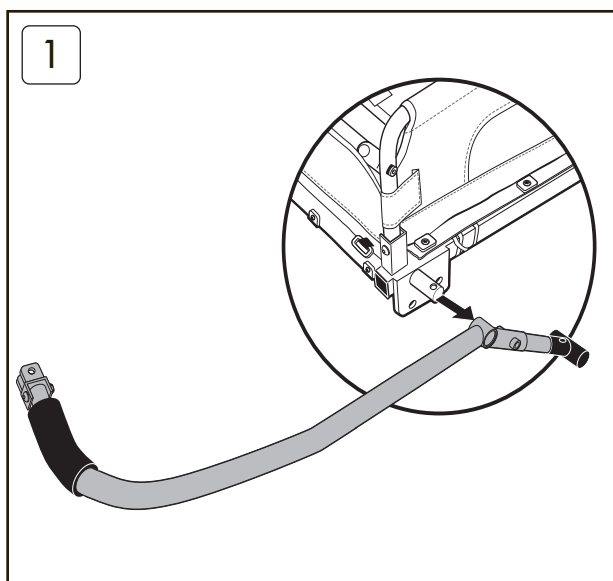

Folding Your Trailer

1. Remove the tow-bar by unscrewing the large screw-knob and then releasing the spring-clip.
2. Remove the wheels by releasing the spring-clips on either side.
3. Fold the trailer body by unscrewing the two screw-knobs and folding the cross-bars against the side wall.
4. Fold the two side walls down.

General Maintenance

From time to time, check your trailer for loose hardware, worn parts, torn material or stitching. Repair or replace parts as needed. Over or under inflation of tires may cause handling issues for the trailer. Replace tires only with street tread tires.

We suggest you periodically clean all parts, wipe dry and then let air dry, especially if exposed to salt water, salt spray, beach sand etc.

WARNING! Do not make any modifications to the trailer. Be sure that the trailer and bike are in good working conditions. A bike dealer can help you with inspection and maintenance. Do not use cleaning solvents. Clean only with mild soap and water.

Seasonal Storage of Your Trailer

Inspect the trailer and its parts before and after each use and storage. Check the working conditions of both trailer and bike before each use.

Store trailer in a dry area and always make sure trailer is dry before storing.

WARNING! To prevent color fading and eventual weakening of the fabrics or components, store the trailer out of direct sunlight.

Service and Repair of Your Trailer

Service and repair can be performed by any bike shop.

For any assembly questions or for replacement parts, please do not return to the store.

Call customer service at



888-995-7437

Email customer service at



service@cyclicsports.com

WARNINGS!

Please read the warnings carefully. Failure to follow these warnings and assembly instructions could result in serious injury or death.

- This trailer is designed for transportation of cargo only. DO NOT transport children or pets in the trailer under any condition.
- DO NOT transport flammable or toxic materials.
- Maximum weight capacity for the trailer is 70 lbs (31 kgs). Exceeding capacity may cause the trailer to change balance and become unstable.
- Always secure cargo
- Always distribute load evenly inside the trailers.
- Ride slower than you would if you were riding without the trailer.
- You will require extra stopping distance. Use your brakes early. Take corners very gradually.
- Do not exceed a speed over 13 kmph (8 mph) and reduce speed to 3mph (5kmph) when turning.
- Use on smooth roads only. Do not ride over curbs, potholes or off-road.
- Do not install a car seat or any other seating device to this trailer.
- Do not make any modifications to the trailer.
- Install a rearview mirror on your bike to inspect the trailer while riding.
- Never leave children unattended in or around the trailer.
- Never allow children to assemble, fold, or disassemble this unit.
- Periodically re-check all fasteners to make sure they are tight.

Pre-Ride Safety Check

Before every ride the following safety check should be performed.

- Check to ensure hitch connector is tight.
- Check to ensure hitch safety strap is secure.
- Check that the load is evenly distributed and secure.
- Check TIRE AIR PRESSURE. Always maintain 20in wheels between 40 PSI and 65 PSI (2.7 BAR and 4.4 BAR) and 12in wheel between 30 PSI and 50 PSI (2.1 BAR and 3.5 BAR) or as indicated on tire sidewall.

General Safety Guidelines

SAFETY FIRST! Check the working conditions of both bike and trailer before each use. If you discover broken components, misalignments or missing parts, correct the problem prior to use. Please refer to all warning and guidelines for the proper use of this trailer. Be aware of what is necessary to safely control the bike-trailer combination.

Follow these safety guidelines for safe and effective performance.

- Inspect the trailer and its parts before and after each use. Proper care and maintenance of the trailer are essential to safety.
- When assembling the trailer, make sure that the wheels are correctly and securely installed as described in the assembly instructions. Inflate the tires to the desired pressure and check the pressure before each use. Over-inflation may cause the trailer to bounce or turn over. Use only tires with street tread and not with BMX or knobby tread.
- Attach the hitch connector securely to the bicycle frame. The connector should be tightened and the safety strap wrapped around the stay or frame and the hook snapped into the D-ring.
- The person riding the towing bicycle should be at least 18 years of age and in good physical condition.
-
- Be sure that the bicycle used with the trailer is in good working condition and has good brakes. A bicycle shop can help you with inspection and maintenance. Please have your bicycle inspected by a qualified bicycle mechanic for compatibility.
- Riding at dusk or dawn with this trailer is not recommended. A reflector that complies with CPSC regulations must be mounted and visible on the rear and sides of the trailer.
- Do not overload the trailer. The load limit for cargo and/or passengers is 70 lbs (31 kgs). Position the load as low as possible and center it within the trailer (front to rear and left to right). Any extra gear should be placed towards the rear. All loads should be secured so that it does not shift.
- Use extra caution when turning on uneven pavement, and going downhill.
- Do not ride over curbs. Avoid bumps and holes. Always signal your turns.
- Do not travel on the highways, busy streets or in areas unsafe for bicycling.
- Do not use trailer in snow or icy conditions.
- Do not travel or descend at high speeds.

IMPORTANT: Do not allow children or pets to ride in the trailer. Do not attempt to install seating systems in the trailer. It is not designed for car seats, stroller seats, infant beds, or any other type of seating. Any modification of the trailer will void the warranty, and may result in damage to the trailer or injury of the passengers.

Pulling this trailer affects the operation of the bicycle. Stopping, starting and turning are affected, depending on the weight of the cargo. To familiarize yourself with the changes, load the trailer to capacity and practice in a safe area. Do not use your trailer until you have become accustomed to how it affects your bicycle handling.

SUFFOCATION WARNING: Plastic bags can be dangerous. To avoid danger of suffocation, keep plastic bags away from babies and children.

For more on the world of CYCLIC, please visit us at

www.cyclicsports.com

