



INSTRUCTION MANUAL

Tree Stump Fogger



FG-01

If you are not satisfied with this product, return it with your valid proof of purchase for a refund. Conditions apply. See store or [PetSmart.com](https://www.PetSmart.com) for details.

For more information about Thrive products, please call 1-888-839-9638.

Dist. by/par: Pacific Coast Distributing, Inc.
19601 N. 27th Ave.,
Phoenix, AZ USA 85027
Made in China

Product SKU # : 5300273

Last revision 02/18/20
(Continued)

IMPORTANT SAFETY INSTRUCTIONS

WARNING:

To guard against injury, basic safety precautions should be observed, including the following:

READ AND FOLLOW ALL SAFETY INSTRUCTIONS

**VERY IMPORTANT INSTRUCTIONS, PLEASE READ CAREFULLY!
NOT FOLLOWING THE PROVIDED INSTRUCTIONS VOIDS
ANY AND ALL GUARANTEES AND/OR WARRANTIES.**

CAUTION:

Please read the following before installing the fogger.

1. Only use the power adapter supplied with the product.
2. The power adapter must be kept dry at all times.
3. Always unplug the fogger from an outlet when not in use, before putting on or taking off parts, and before cleaning. Never yank the cord to pull the plug from outlet. Grasp the plug and pull to disconnect.
4. Do not operate the device if it has a damaged cord or plug, or if it is malfunctioning or has been dropped or damaged in any manner.
5. Unplug the power adapter from the power source, if you want to switch off the fogger for an extended period of time.
6. Use only original replacement parts.

SAVE THESE INSTRUCTIONS

Specification

1. DC 5V, 2W
2. Container Capacity: 500 ml
3. Operating Time (Auto shut-off): 6 hours
4. Water runs out: 10-15 hours

Operating Instruction

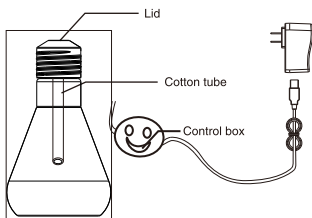

(Continued)

1. Remove water container from tree stump décor piece. Twist off the lid and fill to the top with water. Secure lid and return water container to its original location.
2. Position fogger in the corner of your habitat and place cord through cord slots in the terrarium lid.
3. Plug fogger into an outlet near terrarium and press the control box to activate. Fogger is spraying when LED light flashes in the control box. Make sure to turn off fogger when desired humidity level has been reached.

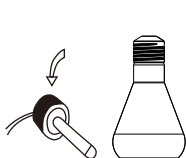

Twist off the lid.

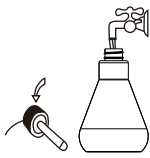

Add water into the container.



Place water container back inside décor piece.

Attention

1. Don't activate fogger spray without water.
2. Unplug when not in use. Drain remaining water and let dry.
3. Keep item away from children.
4. Keep button free and clear of anything that may cover it.
5. Always place fogger on a firm, flat, level surface. A waterproof mat or pad is recommended for use under the fogger.
6. DO NOT place in or drop into water or other liquid.
7. Never add any additive to the water.
8. Stop use if there is an unusual noise or smell.
9. If there is dripping water or dirt on the nozzle, it will take time to spray, otherwise you need to wipe out the water and dirt.

Warning

1. Working conditions: temperature between 41-104 °F (5-40°C).
2. DO NOT use distilled water, and water temperature can not be over 104 °F (40°C).
3. Clean the bar inside the water container often.

(Continued)

FCC INSTRUCTIONS

CAUTION:

Please note that changes or modifications of this product are not expressly approved by the party responsible for compliance could void the user's authority to operate the equipment.

NOTE:

This equipment has been tested and found to comply with the limits for a Class B digital device, pursuant to Part 15 of the FCC Rules. These limits are designed to provide reasonable protection against harmful interference in a residential installation. This equipment generates, uses and can radiate radio frequency energy and, if not installed and used in accordance with the instructions, may cause harmful interference to radio communications. However, there is no guarantee that interference will not occur in a particular installation.

If this equipment does cause harmful interference to radio or television reception, which can be determined by turning the equipment off and on, the user is encouraged to try to correct the interference by one or more of following measures:

- Reorient or relocate the receiving antenna.
- Increase the separation between the equipment and receiver.
- Connect the equipment into an outlet on a circuit different from that to which the receiver is connected.
- Consult the dealer or an experienced radio/TV technician for help.

This device complies with Part 15 of the FCC Rules.

Operation is subject to the following two conditions: (1) this device may not cause harmful interference, and (2) this device must accept any interference received, including interference that may cause undesired operation.