

# Installing the Infant Restraint Using the Vehicle Seat belt

## Infant restraint with seat belt

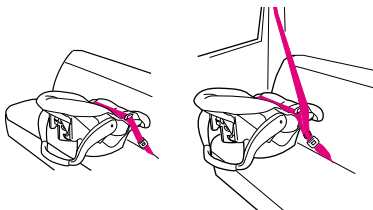

1. Buckle the seat belt. Make sure the buckle tongue goes into the correct buckle **1**. The seat belt should not be twisted or turned.

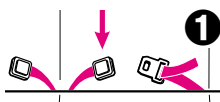

2. Tighten the vehicle seat belt. Refer to your vehicle owners manual and the instructions in "5.2.2 SAFE Vehicle Belt Systems", p. 24-25, on tightening your vehicle belt.

To create a very tight installation, push down hard with your knee or free hand in the middle of the infant restraint or base **2** and pull and tighten the vehicle belt.

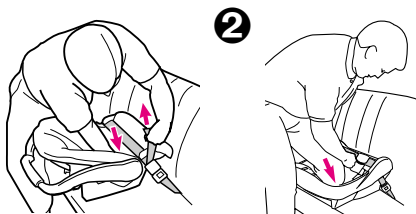

3. Push the infant restraint down into the base and make sure that you hear a "click" **3**. Pull up on the infant restraint to be sure it is latched securely into the base.

If the infant restraint does not securely latch into the base, the infant restraint provides NO protection for your child.

**DO NOT** use the infant restraint/base if the infant restraint does not securely latch into the base.

