

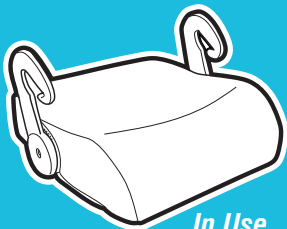

# Turbo GO™

## FOLDING BACKLESS BOOSTER

Read This Instruction Manual



*In Use*

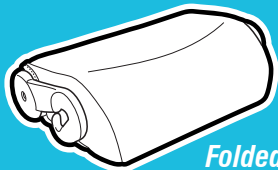

*Folded*

Do not install or use this child restraint until you read and understand the instructions in this manual.

**FAILURE TO PROPERLY USE THIS CHILD RESTRAINT INCREASES THE RISK OF SERIOUS INJURY OR DEATH IN A SUDDEN STOP OR CRASH.**

# **1 Important**

*Pages 5-17*

**1-A Quick Guide to Your Manual**

**1-B Welcome to the Graco Family**

**1-C Before You Begin**

Register This Car Seat

If You Need Help

Certification

Car Seat's Useful Life

Vehicle Seat Protection

Warm Weather Use

**1-D Safety Warnings**

# **2 Features**

*Pages 18-19*

**2-A Car Seat Features**

## **3 Booster**

*Pages 20-22*

**3-A Booster Use**

**3-B Install Booster**

## **4 Securing Child**

*Pages 23-28*

## **5 Vehicle Information**

*Pages 29-32*

**5-A Choosing Vehicle Seat Location**

**5-B Unsafe Vehicle Seat Location**

**5-C Vehicle Seat Belts**

## **6 Care and Cleaning**

*Pages 33-34*

## **7 Fold and Carry Feature**

*Pages 35-36*

## 1-A Quick Guide to Your Manual

***This car seat is for children: Booster: 40-100 lb (18.1-45 kg) 43-57 in. (110.1-145 cm)***

### ***Unfolding and Folding***

#### ***Unfold the Base***

From the bottom of the booster seat, rotate the inner part of the seat base out of the outer part of the seat base. The booster seat is now ready to use.

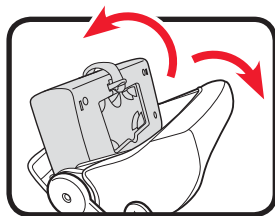
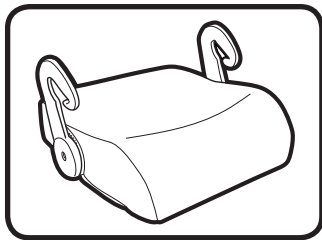



**1 Important**

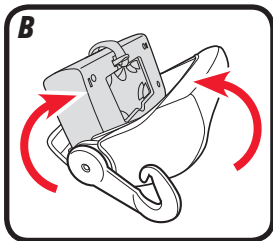
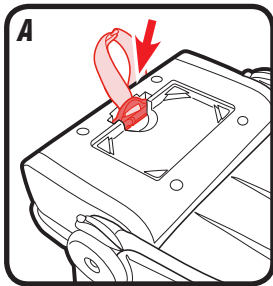

### ***Fold the Base***

Store the belt positioning clip by sliding it into the slot next to the instruction manual storage **(A)**. Rotate the inner part of the seat base into the outer part of the seat base **(B)**. The booster seat is now securely folded.

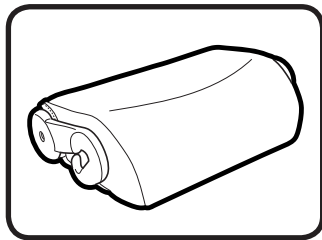



1 Important

## ***Get to Know Your Car Seat***

Review section 2-A to see all of the features of this booster seat.

## ***What Seating Location Should I Use?***

***The best seating location for this booster seat is one that:***

- Is recommended by your vehicle owner's manual, and
- Results in a secure installation of this booster seat.

Some vehicles have specific requirements for where the booster seat can be installed, so be sure to check your vehicle owner's manual for available seating positions, if any. For example, sometimes the center rear seat has a lap belt only vehicle seat belt, which cannot be used with this booster seat.

Review section 5-B, 5-C of this manual AND your vehicle owner's manual.

**According to accident statistics, the safest place for your child in any vehicle is the back seat. The center of the back seat can be the safest during a possible side impact.**





1 Important

## *Using The Car Seat Correctly*

To make sure your child is secured properly, review section 3 and 4 to fit your child.

### *When Installing As a Booster*

#### **Vehicle Seat Belt**

There is one type of vehicle seat belt that can be used: Lap/Shoulder Seat Belt.

Review section 3 of this manual AND your vehicle owner's manual.

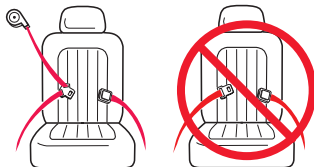

## **Booster Installation**

### **Use Lap/Shoulder Belt Only**

Review section 3

### **Position Lap Belt**

Lap belt must go through the seat belt guides and lie low across your child's hips and thighs.

Review section 3

### **Position Shoulder Belt**

Shoulder belt lies across shoulder between neck and edge of shoulder in the red zone as shown.

Review section 3

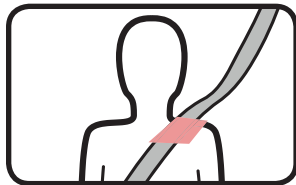
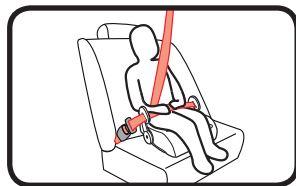
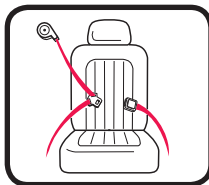

**i** 1 Important



**1 Important**

## **1-B Welcome to the Graco Family!**

Your child's safety depends on you. No car seat can guarantee protection from injury in every situation, but proper use helps reduce the risk of serious injury or death.

Even if this car seat seems easy to figure out on your own, you must follow the detailed instructions in this instruction manual to ensure the steps below are performed correctly.



**1 Important**

## **1-C Before You Begin**

### ***Register This Child Restraint***

Please fill out the prepaid registration postcard attached to the seat pad and mail it in today **or register online at [www.gracobaby.com/carseatregistration](http://www.gracobaby.com/carseatregistration).**

Child restraints could be recalled for safety reasons. You must register this restraint to be reached in a recall. Send your name, address, and the restraint's model number and manufacturing date to:

Graco Children's Products, Inc.

Attn: Customer Service

P.O. Box 169, Elverson, PA 19520-9901

or call 1-800-345-4109

**or register online at [www.gracobaby.com/carseatregistration](http://www.gracobaby.com/carseatregistration)**

For recall information, call the U.S. Government's Vehicle Safety Hotline at 1-888-327-4236 (TTY: 1-800-424-9153), or go to <http://www.NHTSA.gov>.



**1 Important**

For future reference or if you change addresses, record the model name, model number, date of manufacture and purchase date of this car seat on the below. You can find this information either on the registration card if you still have it or on the date label located on the underside of the car seat.

<b>Model Name</b> _____	<b>Date of Manufacture</b> _____
<b>Model Number</b> _____	<b>Date of Purchase</b> _____

### ***If You Need Help***

In the U.S.A, please contact our Customer Service Department with any questions you may have concerning parts, use, or maintenance. When you contact us, please have your product's model number and date of manufacture ready so that we may help you efficiently. These numbers can be found on a sticker on the underside of your car seat.

For additional resources or to get your car seat checked by a child passenger safety technician, please visit the following web sites:

**[www.nhtsa.gov](http://www.nhtsa.gov) • [www.seatcheck.org](http://www.seatcheck.org) • [www.safekids.org](http://www.safekids.org)**



**1 Important**

## ***Certification***

This child restraint meets or exceeds all applicable requirements of Federal motor vehicle safety standard 213 for use in motor vehicles.



This child restraint is NOT certified for use in aircraft because aircrafts do not have shoulder belts.

## ***Car Seat's Useful Life***

STOP using this car seat and throw it away 10 years after the date of manufacture. Look for date of manufacture label on the underside of the car seat.

Graco Children's Products Inc. advises against loaning or passing along a car seat unless you know the complete history of the product. We also advise against purchasing a car seat second hand.



1 Important

### *Vehicle Seat Protection*

Protect vehicle seat. Use a car seat mat, towel, or thin blanket under and behind car seat.

### *Warm Weather Use*

Car seat parts can get very hot in the sun or warm weather. **To avoid burns, always check before putting child in car seat.**

## 1-D Safety Warnings

No car seat can guarantee protection from injury in every situation, but proper use helps reduce the risk of serious injury or death. **READ THIS MANUAL CAREFULLY.**

### **!WARNING!**

Failure to follow these instructions and child restraint's labels can result in child striking the vehicle's interior during a sudden stop or crash.



1 Important



**1 Important**

- ! Review your vehicle owner's manual for more information about air bags and car seat use.**
- ! If your vehicle does not have a back seat, review your vehicle owner's manual.**
- ! Select a suitable location for the car seat in your vehicle.**
- ! Always secure car seat with the vehicle seat belt, even when unoccupied. In a crash, an unsecured car seat can injure occupants.**
- ! If car seat is in a crash, it must be replaced. DO NOT use it again! A crash can cause unseen damage and using it again could result in serious injury or death.**
- ! DO NOT use car seat if it is damaged or missing parts.**
- ! DO NOT use accessories or parts other than those provided by Graco. Their use could alter the performance of the car seat.**



**1 Important**

- ! Never leave child unattended, even when sleeping.**
- ! The American Academy of Pediatricians (AAP) recommends that children should use a built-in harness system car seat for as long as possible until they reach the maximum forward-facing weight or height for their car seat. After reaching the maximum forward-facing weight or height, they also recommend that children 4 feet 9 inches (145cm) tall or under should ride in a belt-positioning booster seat.**
- ! For use in motor vehicles ONLY**

## 2-A Car Seat Features

**A** *Seat Belt Guides*

**B** *Seat Base*

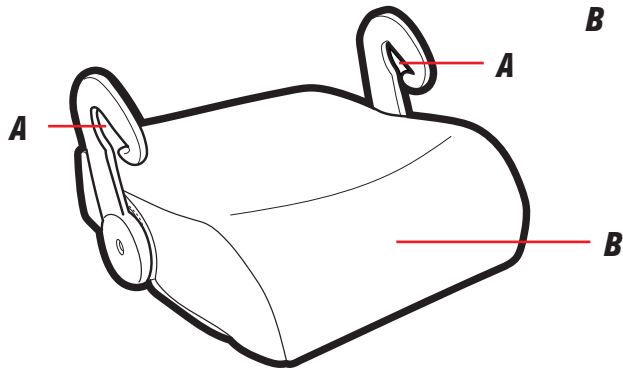

2 Features

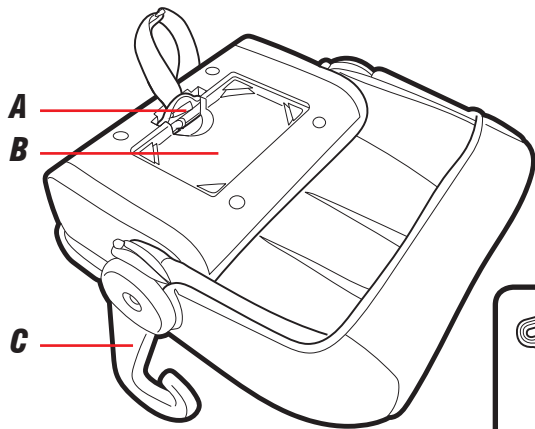

- A** *Belt Positioning Clip*
- B** *Instruction manual storage*
- C** *Seat Belt Guide*

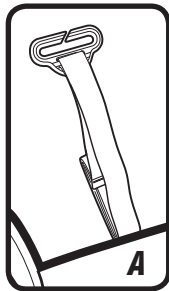



## 3-A Booster Use



***Vehicle Seat Lap/  
Shoulder Belt***

***Booster: 40-100 lb (18.1-45 kg) 43-57 in. (110.1-145 cm) at least 4 years old\****

- Place car seat forward-facing in the vehicle back seat.
- Make sure vehicle seat's lap belt is adjusted snugly and lays low on the child's hip and is routed through the seat belt guides.
- Vehicle belts **MUST** lie flat against child and **MUST NOT** be twisted.
- Vehicle seat's shoulder belt is adjusted snugly and should lie between child's neck and edge of shoulder.

\*Check your state laws and the AAP/NHTSA recommendations.

- **Never** use a vehicle lap-only belt across front of child.
- **DO NOT** position vehicle shoulder belt under the child's arm or back.
- **DO NOT** allow child to slouch or slide down in the booster seat.
- **DO NOT** position the vehicle belt around the seat belt guides.
- The front of booster seat **MUST NOT** hang over front of vehicle seat.
- If child will not keep vehicle belt properly positioned, **DO NOT** use this booster seat. Use a different car seat.
- **DO NOT** carry the booster seat from the belt positioning clip.
- The AAP recommends that children should use a built-in harness system car seat for as long as possible until they reach the maximum forward-facing weight or height for their car seat. After reaching the maximum forward-facing weight or height, they also recommend that children 4 feet 9 inches (145cm) tall or under should ride in a belt-positioning booster seat.



***Never Use a Vehicle  
Lap-Only Belt Across  
Front of Child***

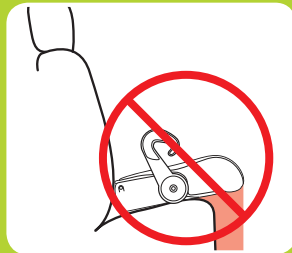



## 3-B Install Booster

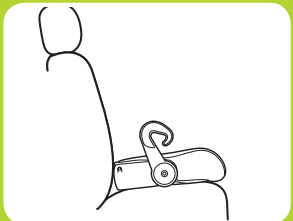
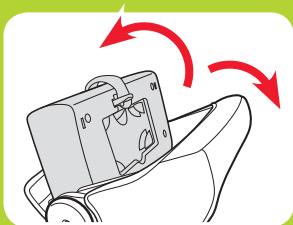

### 1. *Unfold the Seat*

See section 7-A to unfold the seat.

### 2. *Place Car Seat Forward-Facing in Back Seat of the Vehicle*

Place forward-facing in vehicle seat. The bottom of the seat should sit as flat as possible on the vehicle seat.

**Note:** Always secure car seat with the vehicle seat belt, even when unoccupied or stowed away.

See section 4-A to secure your child.

## 4-A Securing Child

### **!WARNING!**

**Use only the vehicle lap and shoulder belt system when restraining the child in the booster seat.**

#### **1. Place Child In Seat**

Have your child sit in the booster seat, with his/her back flat against the back of the vehicle seat.

#### **2. Ears Must Be Below the Top of the Vehicle Seat Back or Headrest.**

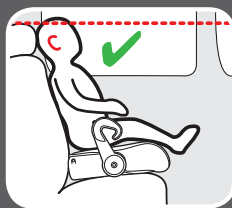

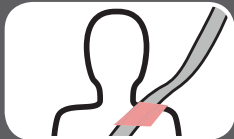
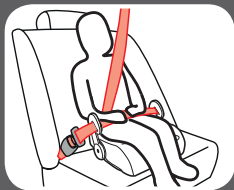

### **3. Buckle the Vehicle Lap/Shoulder Seat Belt**

Be sure the lap portion of the vehicle seat belt goes through both seat belt guides and the shoulder belt goes through the seat belt guide on the buckle side.

Be sure the lap portion of the vehicle seat belt lies low across your child's hips.

Be sure the shoulder belt lies across your child's shoulders, in the red zone between the neck and edge of shoulder.

***You may need to use the belt positioning clip to help get a good fit. See "Using Belt Positioning Clip"***

## ***Is Everything Correct?***

***Never Use Lap Belt Only***

***Lap Belt through the seat belt guides and Lies Low Across Hips and Thighs***

***Shoulder Belt Lies On the Shoulder, in the Red Zone Between the Neck and Edge of Shoulders***

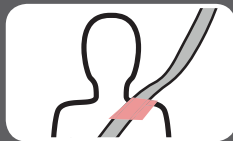



## Using Belt Positioning Clip

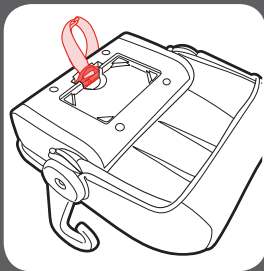
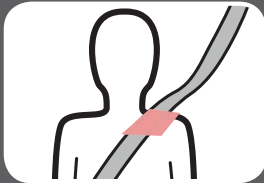

### **1. Make Sure Vehicle's Seat Shoulder Belt Lays in the Red Zone As Shown**

If the vehicle's seat shoulder belt lays outside this zone, you **MUST** use the belt positioning clip.

### **2. Belt Positioning Clip Storage**

From the bottom of the seat, remove the belt positioning clip from the slot next to the instruction manual storage.

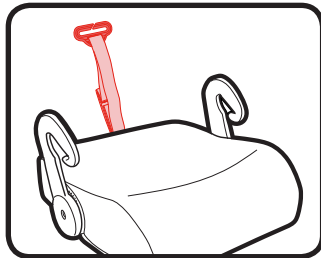

### **3. Place Child in Seat, Buckle Child In Seat and Attach Belt Positioning Clip**

With child's back flat against the back of the vehicle seat, buckle child in. Then slide the clip onto the vehicle's seat shoulder belt as shown.

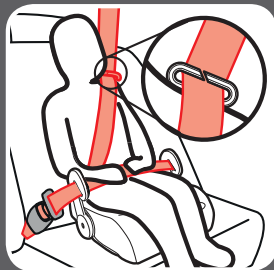
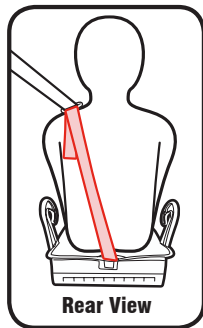

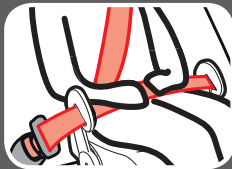
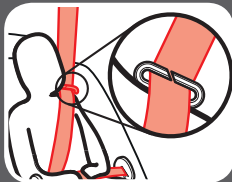
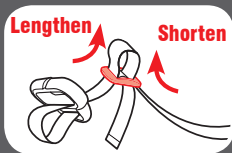

#### **4. Adjust the Belt Positioning Clip to Fit Your Child**

Lengthen or shorten the belt length as shown.

Clip should fit right at the top of shoulder as shown.

Be sure the lap portion of the vehicle seat belt lies low across your child's hips.

## 5-A Choosing Vehicle Seat Location

### *Review Your Vehicle's Owner Manual for Seating Locations*

#### ***The best seating location for this car seat is one that:***

- Is recommended by your vehicle owner's manual, and
- Results in a secure installation of this car seat

In the event there is no available back seat and / or you have no other option, the National Highway Traffic Safety Administration (NHTSA) recommends that you take the following steps:

- Ensure the child is properly restrained according to their age and size
- Move the seat as far back as possible
- Make sure the child is not leaning out of position, such as leaning forward into the deployment path of the air bag
- Set the air bag ON-OFF switch, if available, to the OFF position





## 5-B Unsafe Vehicle Seat Location

Never install this car seat in any of the following vehicle seating locations:



rear-facing or side-facing  
vehicle seats



booster mode with vehicle  
lap belt only seat belt

## 5-C Vehicle Seat Belts

*Review Your Vehicle's Owner Manual for Vehicle Seat Belt Use*

### *Vehicle Seat Belt Terms*

**Retractor**

A device that winds up the unused vehicle seat belt. It is often hidden inside the panels on the walls of the vehicle or in the vehicle seatback.

**Latch Plate**

The male end of the seat belt with the silver tongue.

**Seat Bight**

The crease where the vehicle seat back and seat bottom meet.

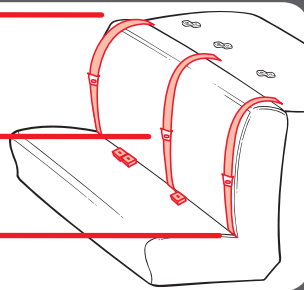



## Identify Your Seat Belt Type

There is one type of vehicle seat belt that can be used with this car seat:

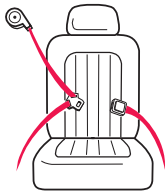

**Lap/Shoulder Belt 3**  
connections points. Can be  
used in all car seats modes of  
use.

The following types of vehicle seat belts  
**CANNOT** be used safely with this car seat:



Lap Belt Only 2  
connection points.



Lap Belt with Motorized  
Shoulder Belt



Lap Belt or Shoulder Belt  
Mounted on Door

Belts Forward of the  
Seat Bight



Some vehicles you may not get a  
secure fit. Read both your vehicle  
and car seat manuals.

## 6 Care and Cleaning

Refer to seat pad care tag for washing instructions.

### ***Cleaning Seat Pad***

To remove the seat pad, first thread the belt positioning clip out of the seat pad.

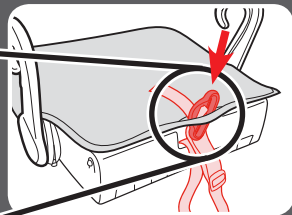
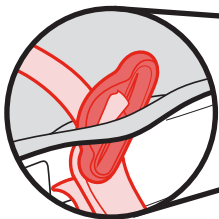

From the bottom of the seat, undo the two elastic loops on each side of the seat.

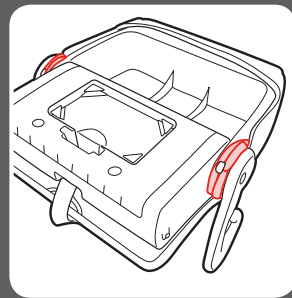

## 6 Care & Cleaning

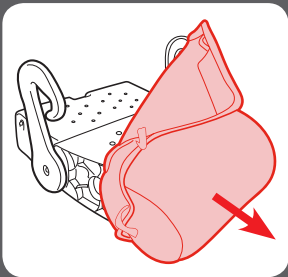

Pull the seat pad off the booster seat.

Machine wash pad in cold water on delicate cycle and drip-dry. **DO NOT USE BLEACH.**

Reverse the steps to reattach the seat pad on the booster seat.

## 7-A Folding and Unfolding

### *Folding the Base*

Store the belt positioning clip by sliding it into the slot next to the instruction manual storage **(A)**. Rotate the inner part of the seat base into the outer part of the seat base **(B)**. The booster seat is now securely folded.

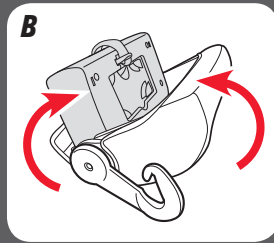
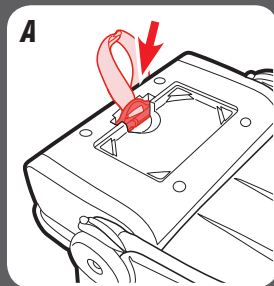
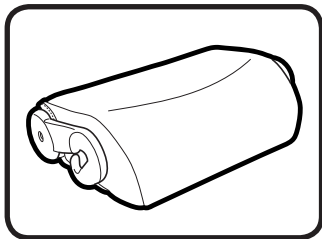

  
**7 Fold and  
Carry Feature**

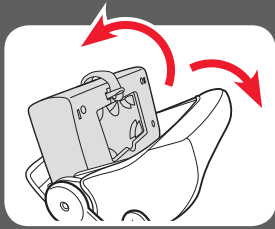

***Unfolding the Base***

From the bottom of the booster seat, rotate the inner part of the seat base out of the outer part of the seat base. The booster seat is now ready to use.

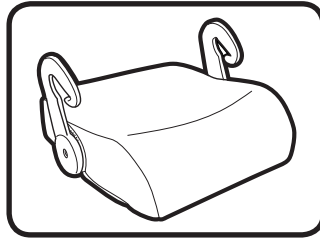

**Notes:**

**Notes:**

**Notes:**

## Replacement Parts

To purchase parts or accessories in the United States,  
please contact us at the following:

**[www.gracobaby.com](http://www.gracobaby.com)**

**or**

**1-800-345-4109**

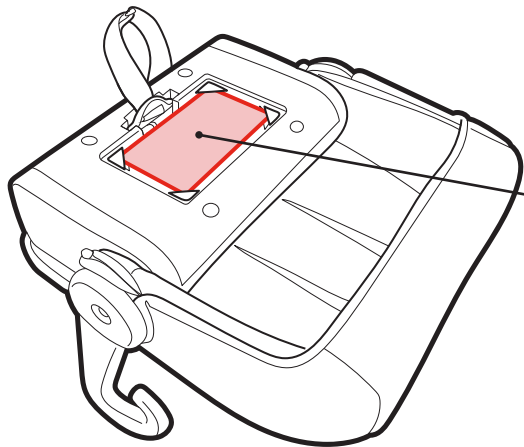

Store instruction manual in the  
space underneath the seat.