

**AFFIX™
Booster Seat**

Owner's Manual

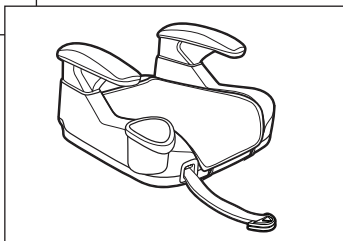

READ THIS MANUAL.

Do not install or use this car seat until you read and understand the instructions in this manual.

**FAILURE TO PROPERLY USE THIS CAR SEAT
INCREASES THE RISK OF SERIOUS INJURY
OR DEATH IN A SUDDEN STOP OR CRASH.**

Table of Contents

Registration Information	3
For Recall Information.....	3
If You Need Help/Booster Seat Useful Life.	4
Parts List	5
Warnings to Parents and Other Users.....	6-9
Weight and Height Limits.....	10-11
Vehicle Seat Location Requirements.....	12
Vehicle Seat Belt Requirements	13-14
SAFE Vehicle Belt Systems	13
UNSAFE Vehicle Belt Systems	14
Assembling the Booster Seat	15-16
Assembling the Back Support	17-22
Using your Graco Booster Seat	23-25
Booster Seat Positions	26
Attaching Booster to Vehicle Seat	27-29
Securing your Child in Vehicle	30-33
Adjusting the Head Support.....	34
Removing the Back Support (on certain models) to Use as Backless Booster.....	35
Securing Child in Vehicle with Shoulder Belt Positioning Clip	36-39
Airplane Use	40
Cupholder and Storage Compartment.....	40
Instruction Sheet Storage	41
Care and Maintenance	41-42
Replacement Parts.....	44

Registration Information

Model Number:

Date of Manufacture:

Purchase Date:

Register Your Booster Seat

Please fill in the above information. The **model number and date of manufacture** can be found on a label underneath your booster seat. Fill out the prepaid registration postcard attached to the seat cover and mail it today.

Child restraints could be recalled for safety reasons. You must register this restraint to be reached in a recall. Send your name, address, and the restraint's model number and manufacturing date to:

Graco Children's Products Inc.

Attn: Customer Service

P.O. Box 169

Elverson, PA 19520-9901

or call 1-800-345-4109

or register online at

<http://www.gracobaby.com/carseatregistration>

For Recall Information

- Call the U.S. Government's Vehicle Safety Hotline at 1-888-327-4236 (TTY: 1-800-424-9153), or go to <http://www.NHTSA.gov>
- Graco: 1-800-345-4109 or www.gracobaby.com

If You Need Help

Please contact our Customer Service Department with any questions you may have concerning parts, use, or maintenance. When you contact us, please have your product's **model number** ready so that we may help you quickly. This number can be found on a sticker on the underside of your booster seat.

1-800-345-4109 or www.gracobaby.com

www.NHTSA.gov

www.seatcheck.org

www.safekids.org

Booster Seat Useful Life

STOP using this booster seat and throw it away 10 years after the date of manufacture.

Look for this sticker on the bottom of the booster seat:

MODEL:	NAME:
Date of Manufacture	year month day
GRACO CHILDREN'S PRODUCTS, INC.	
ATLANTA, GA 30328 1-800-345-4109	
Made in China	PD206938E

Parts List

Adult assembly required.

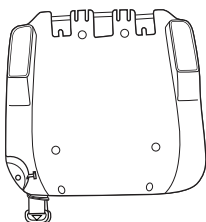

Base

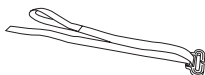

Shoulder belt
positioning clip



Armrests



Cupholder
(in bottom of base)

On certain models

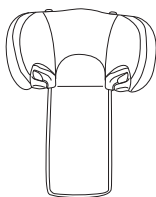

Head support

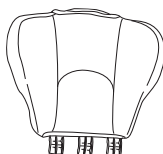

Lower back support



Seat pad

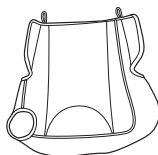

Seat pad

Warnings to Parents and Other Users

WARNING

**NEVER PLACE THIS BOOSTER SEAT IN
A VEHICLE SEATING
LOCATION THAT HAS AN**

AIR BAG. If an air bag inflates, it can hit the child and booster seat with great force and cause serious injury or death to your child. Refer to your vehicle owner's manual for information about air bags and booster seat installation.



WARNING

- **NO BOOSTER SEAT CAN GUARANTEE PROTECTION FROM INJURY. HOWEVER, PROPER USE OF THIS BOOSTER SEAT REDUCES THE RISK OF SERIOUS INJURY OR DEATH TO YOUR CHILD.**
- **DO NOT INSTALL OR USE THIS BOOSTER SEAT UNTIL YOU READ AND UNDERSTAND THE INSTRUCTIONS IN THIS MANUAL AND IN YOUR VEHICLE OWNER'S MANUAL. DO NOT** let others install or use the booster seat unless they understand how to use it.
- **FAILURE TO PROPERLY USE THIS BOOSTER SEAT INCREASES THE RISK OF SERIOUS INJURY OR DEATH IN A SHARP TURN, SUDDEN STOP OR CRASH.** Your child can be injured in a vehicle even if you are not in a crash. Sudden braking and sharp turns can injure your child if the booster seat is not properly installed or if your child is not properly secured in the booster seat.

- According to crash statistics, **CHILDREN ARE SAFER WHEN PROPERLY RESTRAINED IN REAR VEHICLE SEATING POSITIONS, RATHER THAN FRONT SEATING POSITIONS.** For a vehicle with a front passenger air bag, refer to your vehicle owner's manual as well as these instructions for booster seat installation.
- **NEVER LEAVE YOUR CHILD UNATTENDED.**
- **NEVER LEAVE A BOOSTER SEAT UNSECURED IN YOUR VEHICLE.** An unsecured booster seat can be thrown around and may injure occupants in a sharp turn, sudden stop or crash. Remove it or make sure that it is securely belted in the vehicle.
- **IF AFFIX™ BOOSTER IS NOT CONNECTED TO VEHICLE ANCHORS,** secure the booster seat with the lap/shoulder belt into the vehicle seat.
- **REPLACE THE BOOSTER SEAT AFTER A CRASH OF ANY KIND.** A crash can cause damage to the booster seat that you cannot see.

- **DO NOT MODIFY YOUR BOOSTER SEAT** or use any accessories or parts supplied by other manufacturers.
- **NEVER USE BOOSTER SEAT IF IT HAS DAMAGED OR MISSING PARTS.** DO NOT use a cut, frayed or damaged vehicle seat belt.
- **THE BOOSTER SEAT CAN BECOME VERY HOT IF LEFT IN THE SUN.** Contact with these parts can burn your child's skin. Always touch the surface of any metal or plastic parts before putting your child in the booster seat.
- **THIS CHILD RESTRAINT CONFORMS** to all applicable Federal motor vehicle safety standards and is certified for use in motor vehicles. This restraint is NOT certified for use in aircraft because there is no shoulder belt available.
- **NEVER GIVE THIS BOOSTER SEAT** to someone else without also giving them this manual.
- **NEVER USE A SECOND-HAND BOOSTER SEAT** or a booster seat whose history you do not know.
- **NEVER USE THIS BOOSTER SEAT** without the armrests attached to the base.

Weight and Height Limits

⚠ WARNING

FAILURE TO USE booster seat in a manner appropriate for your child's size may increase the risk of serious injury or death.

To use this Graco booster seat, your child **MUST** meet **ALL** of the following requirements:

With back support

(approximately 4 to 10 years old) :

- weigh between 40 and 100 lb.
(mass between 18.1 and 45 kg), and
- are between 43 and 57 inches (110.1 and 145 cm) in height, and
- the shoulder belt **MUST** lie across child's shoulders in red zone as shown in **1** and the lap portion is positioned low on the child's hips, and
- the child's ears are below top of booster seat. If tops of ears are above top of seat, your child is too large for the booster seat

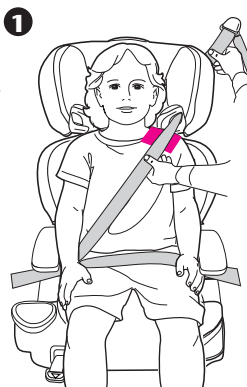

Without back support (approximately 4 to 10 years old) :

- weigh between 40 and 100 lbs.
(mass between 18.1 and 45 kg), and
- are between 43 and 57 inches
(110.1 and 145 cm) in height, and
- the shoulder belt **MUST** lie across child's shoulders in red zone as shown in **2** and the lap portion is positioned low on the child's hips, and
- when sitting on the booster seat, your child's ears are below the top of the vehicle seat cushion / head rest.

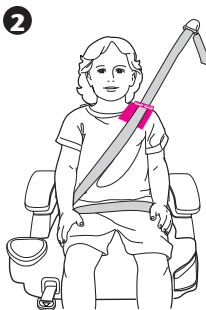

Your Graco booster seat can be used with or without the back support (on certain models) as long as the above requirements are met.

When forward-facing, children should use the built-in harness system for as long as possible until they reach the maximum forward-facing weight or height for their car seat. At that point, children should ride in a belt-positioning booster seat. A booster is no longer needed once the vehicle seat belt fits properly, typically when they reach 4 feet 9 inches (145 cm) tall and are between ages 8-12. Be sure to check your local and state laws, as well as AAP and NHTSA recommendations, for car seat usage.*

*Graco Supports the American Academy of Pediatrics and National Highway Traffic Safety Administration's Car Seat Guidelines. Visit www.gracobaby.com/en-US/safety-information for information on car seat usage recommendations.

Vehicle Seat Location Requirements

⚠ WARNING

IMPROPER PLACEMENT OF THE BOOSTER SEAT INCREASES THE RISK OF SERIOUS INJURY OR DEATH. Some seating positions in your vehicle may **NOT** be safe for this booster seat. Some vehicles do not have any seating positions that can be used safely with the booster seat. If you are not sure where to place the booster seat in your vehicle, consult your vehicle owner's manual or call Graco Children's Products Inc., at 1-800-345-4109.

- **Children are safer when properly restrained in rear vehicle seating positions.** Whenever possible secure the Graco booster seat in the center position of the seat directly behind the front seats. However, this position is often equipped with a lap belt only and cannot be used.



- The vehicle seat **MUST** face forward.

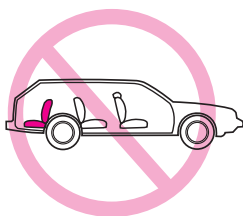

Vehicle Seat Belt Requirements

⚠ WARNING

A FEW SEAT BELT SYSTEMS ARE NOT SAFE TO USE WITH THE BOOSTER SEAT.

Pay careful attention to these systems; some of the seat belts that are **NOT** safe to use look very much like seat belts that are safe to use. If you are unsure, consult your vehicle owner's manual or call Graco Children's Products Inc., at 1-800-345-4109.

SAFE Vehicle Seat Belt System

ONLY A LAP/SHOULDER BELT SYSTEM CAN BE USED WITH THIS BOOSTER SEAT, IF

the seat location meets all other requirements of these instructions and those in your vehicle owner's manual.

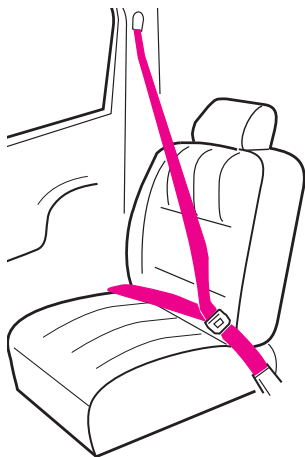

UNSAFE Vehicle Seat Belt Systems

DO NOT USE ANY OF THE FOLLOWING VEHICLE BELT SYSTEMS.

- **NEVER** use a lap-only belt.
 - **NEVER** use a Passive Restraint - Lap or Shoulder Belt Mounted on Door
 - **NEVER** use a Passive Restraint - Lap Belt with Motorized Shoulder Belt
- NEVER** use vehicle belts that are attached to the door in any way or that move along a track to automatically surround the passenger when the door is closed.

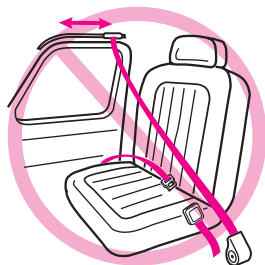
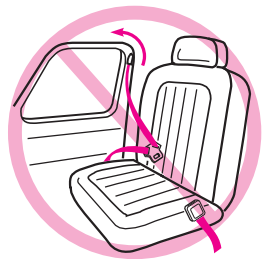
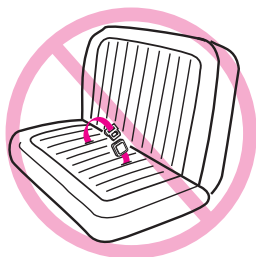

Assembling the Booster Seat

Step 1.

To attach armrests to base, press armrests into opening in base **1**.

CHECK to make sure armrests are securely attached by pulling up on them **2**.

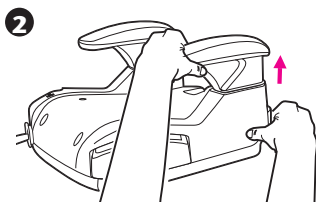
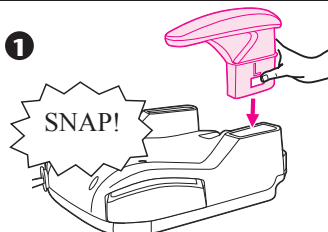

Step 2.

Remove cupholder from compartment in bottom of base **3**. Align tabs on side and bottom of cupholder with their slots in base and press cupholder into place **4**.

DO NOT REMOVE CUPHOLDER ONCE IT IS ATTACHED.

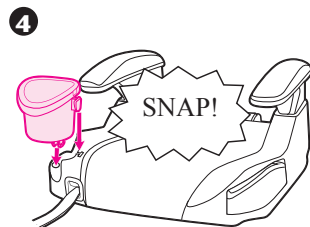
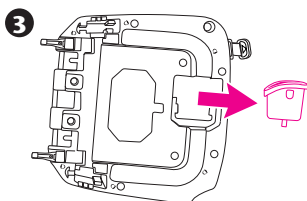

Step 3.

Wrap seat pad around front of base **5** and attach with elastic straps **6** as shown.

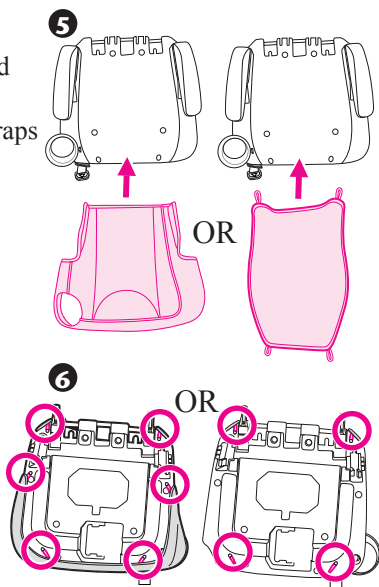

Step 4.

Your Graco booster seat is now ready to use. See page 27, “Attaching Booster to Vehicle Seat”.

FOR MODELS with a back support continue on to **Step 5**.

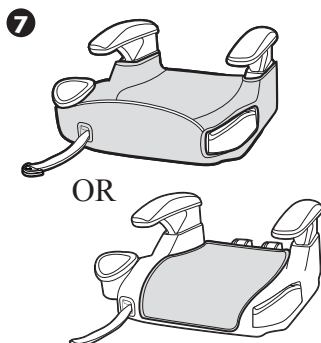

Assembling the Back Support (on certain models)

Step 5.

On certain models, your lower back support pad may not be attached to the back support. Place lower back support pad around edges of support as shown. Then fasten lower elastic strap to the metal hook on the other side of the seat pad. If your lower back support pad is already attached go to **Step 5a**.

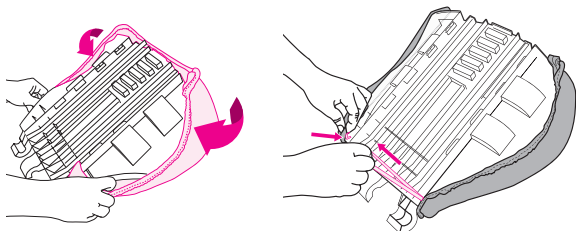

Step 5a.

Flip head support and lower back support over as shown **1**.

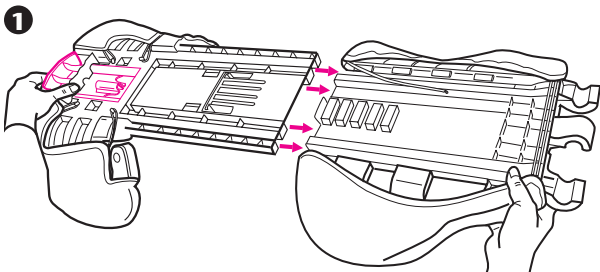

Step 6.

Squeeze adjustment button and slide two pieces together until they snap into place **2**.

CHECK to make sure two pieces are securely snapped together by pulling on them.

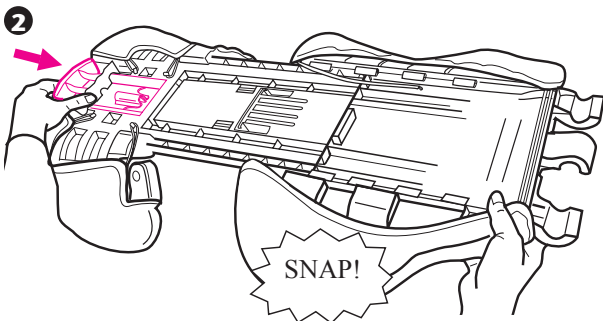

Step 7.

Attach elastic strap to metal hook on other side of seat pad as shown **3**. If your elastic strap is already attached you can skip to Step 8.

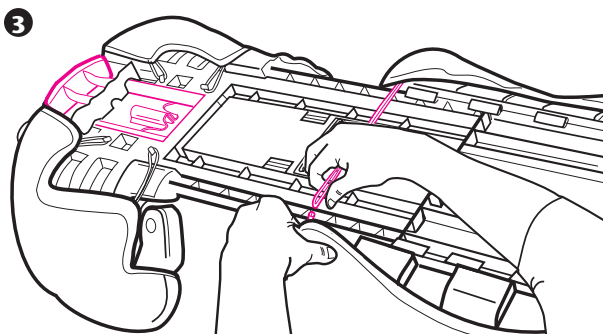

Step 8.

Flip seat over and insert the fabric from the head support underneath the fabric on the lower back support as shown **4**.

To make insertion of fabric easier, slide the upper and lower back pieces apart by squeezing the adjustment button.

4

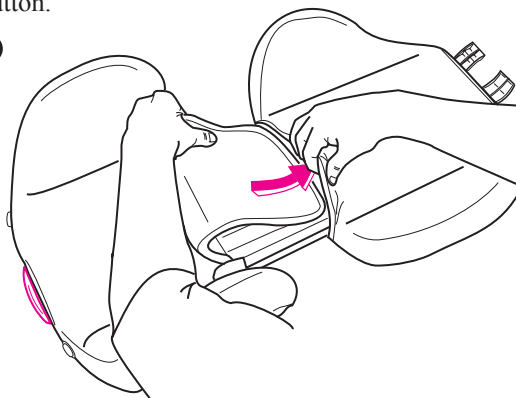

Step 9.

Attach backrest to base. “U”-shaped hooks on bottom of backrest will interlock with bars on base **5**.

Make sure that no part of the seat covering interferes when attaching backrest to the base.

5

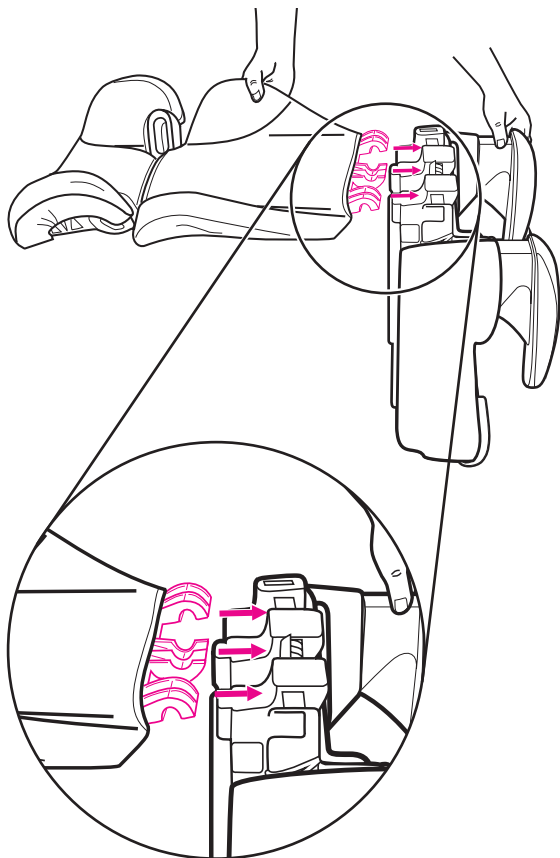

Step 10.

Once backrest is securely attached to the base, push backrest up as shown **6**.

6

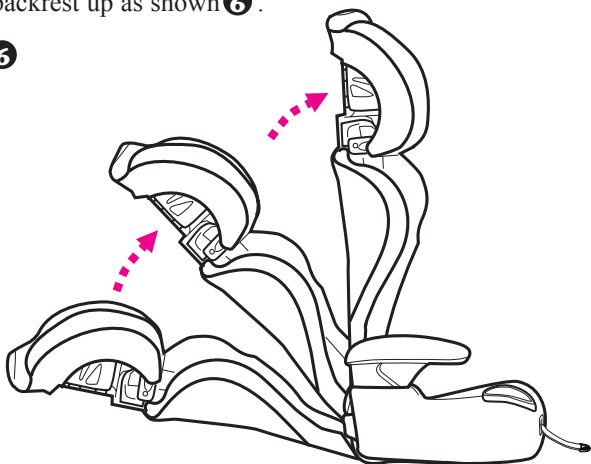

Step 11.

Your Graco booster seat is now ready to use.

See page 23-35.



Using your Graco Booster Seat

⚠ WARNING!

FAILURE TO PROPERLY SECURE YOUR CHILD AND THE BOOSTER SEAT IN YOUR VEHICLE INCREASES THE RISK OF SERIOUS INJURY OR DEATH IN THE EVENT OF A SHARP TURN, SUDDEN STOP OR CRASH.

WARNING: Use only the vehicle's lap and shoulder belt system when restraining the child in this booster seat **1**.



NEVER use a vehicle lap-only belt across front of child **2**.



⚠ WARNING

Vehicle belts **MUST** lie flat against child and **MUST** not be twisted.

DO NOT use shoulder belt loose or positioned under child's arm **3**.

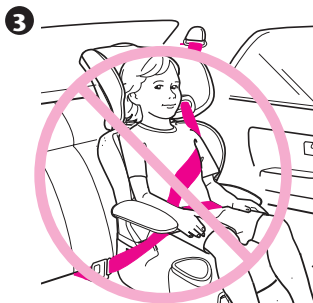

DO NOT position vehicle belt over top of the armrests **4**. It must pass underneath the armrests.

Make sure vehicle belt is NOT twisted.

Lap portion of lap/shoulder belt MUST be low and snug on hips, just touching thighs.

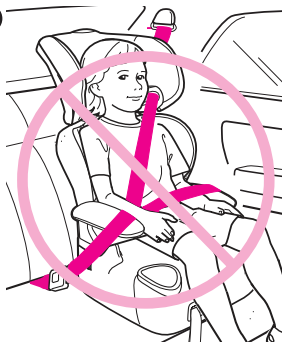

DO NOT allow child to slide down in booster seat **5**.

If child will not keep vehicle restraint properly positioned, **DO NOT** use this booster seat. Use a different child restraint system.

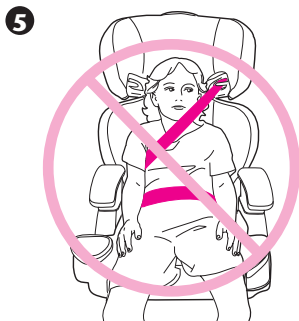

⚠ WARNING

Vehicle seat headrest must not interfere with booster seat head support. The front of booster seat **MUST NOT** hang over front of vehicle seat **6**.

6

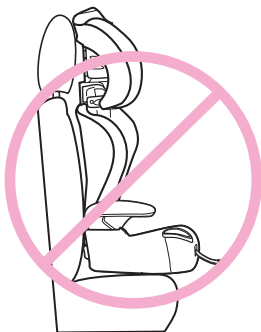

The back of the booster seat **MUST** fit tight against the vehicle seat back as shown **7**.

7

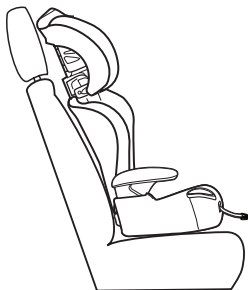

Booster Seat Positions

Your booster seat has two positions as shown.

1 Upright

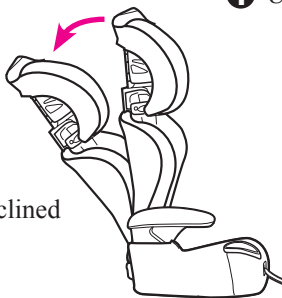

2 Reclined

The back of the booster seat **MUST** fit tight against the vehicle seat back as shown in **3** in either the first or second position.

3

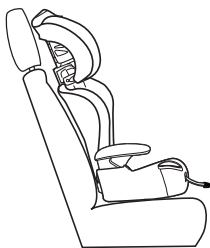

DO NOT USE
booster seat beyond
reclined position **2**.

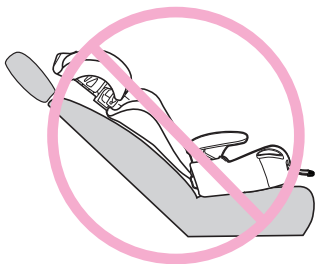

Attaching Booster to Vehicle Seat

WARNING: Use only the vehicle's lap and shoulder belt system when restraining the child in this booster seat.

Lower anchor connectors are **ONLY** to secure the booster seat to the vehicle seat.

When using the Lower anchor connectors, **DO NOT** place booster seat off-center of the vehicle anchors.

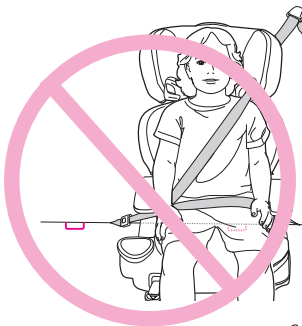

1. Push button on front of seat **1** and pull lower anchor connectors out from back of booster **2**.

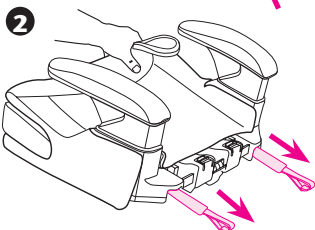
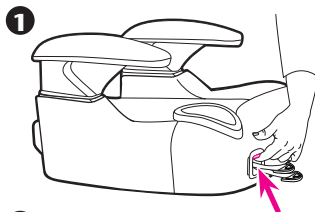

2. Attach lower anchor connectors to vehicle lower anchors **3**.

Pull firmly on lower anchor connectors **4** to be sure they are attached.

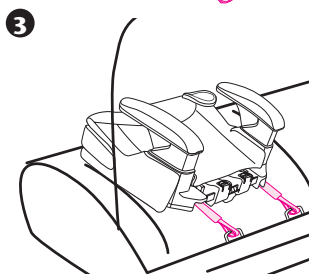

NEVER put two lower anchor connectors on one vehicle anchor **5**.

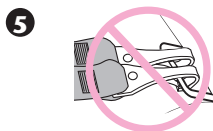
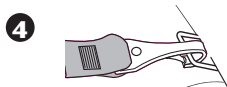

3. Tighten lower anchor connectors, by pushing on booster and pulling straps on front of booster **6**.

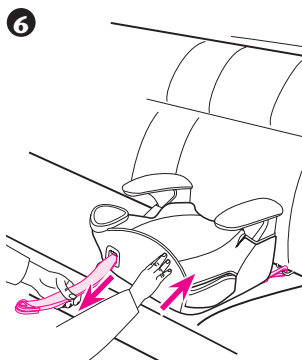

4. To remove booster, push release button up on front of booster **7** and pull slightly away from seat.

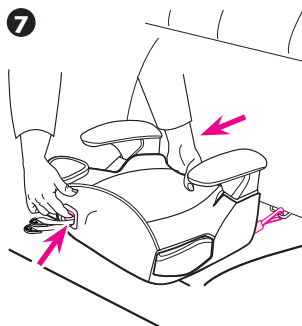

5. Push lower anchor connector in **8**, lift up and pull out (away from anchor point) **9**.

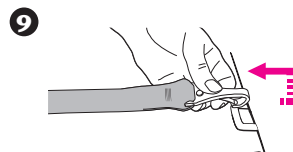
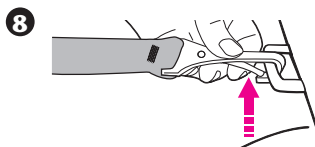

Repeat on other lower anchor connector.

Securing Your Child in Vehicle

1. Place booster seat firmly against the back of a forward-facing vehicle seat equipped with a lap/shoulder belt only **1**.
2. Have your child sit in booster seat with their back flat against back of booster seat.

1

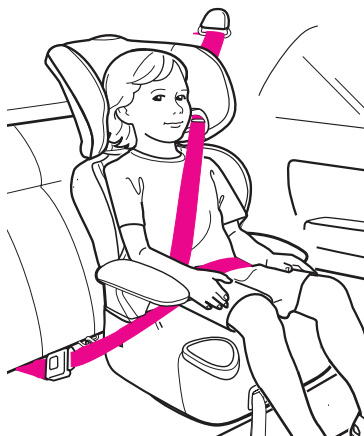

3. Position shoulder belt through the shoulder belt guide shown in **2**, NOT as shown in **3**. Fasten buckle and pull up on the shoulder belt to tighten.

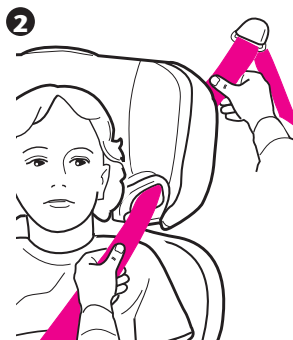

CORRECT



INCORRECT

4. To ensure the correct head support height is obtained, the bottom of the headrest **SHOULD** be even with the top of child's shoulders as shown in ④ and the shoulder belt must be positioned in the red zone as shown in ⑤.



CORRECT

The lap belt portion **MUST** pass under the armrests and be positioned low on the hips.



5. If the belt lies across child's neck, head or face **6**, readjust head support height.

Follow instructions on page 34, "Adjusting the Head Support".



INCORRECT

6

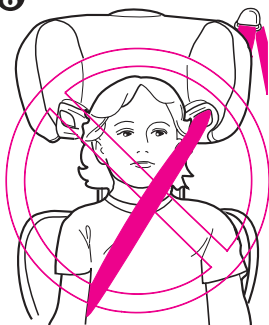

INCORRECT

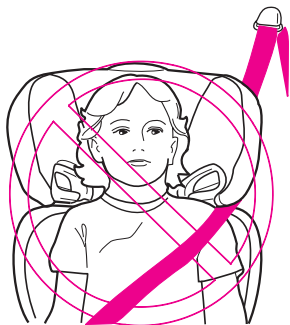

INCORRECT

Adjusting the Head Support

BEFORE adjusting the head support height, have your child lean forward slightly.

Squeeze the adjustment button on top of seat and pull back support up until it snaps into one of the 6 height positions.

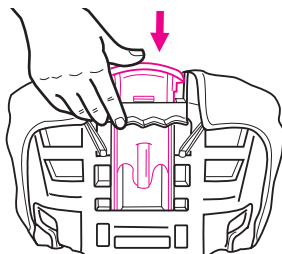

Back of seat

To lower, squeeze adjustment button and push down.

CHECK to make sure it is securely snapped into one of the 6 height positions by pulling up on head support.

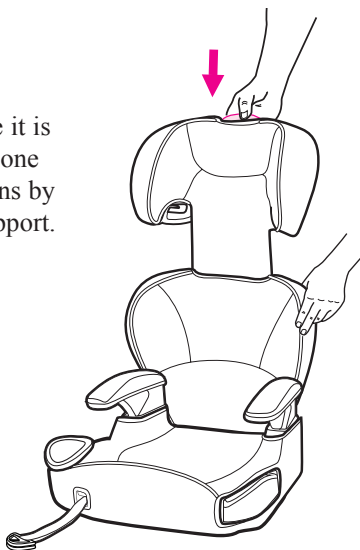

Removing the Back Support (on certain models) to Use as Backless Booster

To use booster seat without back support:

Remove back support
as shown.

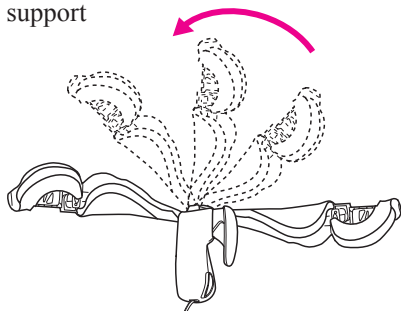

“U”-shaped
hooks on bottom
of back support
are interlocked
with bars on
base. Lift back
support off base.

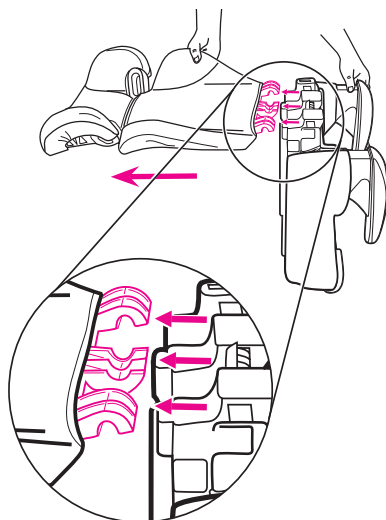

Securing Child in Vehicle with Shoulder Belt Positioning Clip

The shoulder belt **MUST** lie across child's shoulders in red zone as shown.

If shoulder belt lies outside this zone, the shoulder belt positioning clip **MUST** be used. **DO NOT** use the belt positioning clip if the shoulder belt is in the red zone.

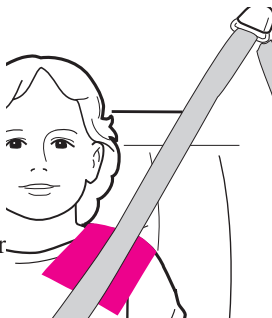

To attach clip to booster seat:

1. The shoulder belt positioning clip **MUST** be attached onto the horizontal bar in the center of the base. Insert the loop end of strap around horizontal bar on rear of seat as shown in **1**.

1

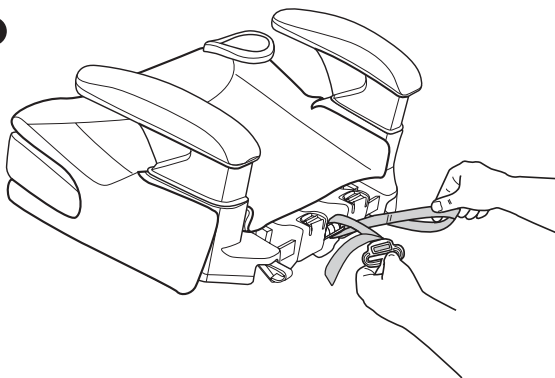

2. Pass the clip and strap through the loop end as shown in **2** and pull strap up **3** .

NOTE: Free end of strap should face front of seat.

2

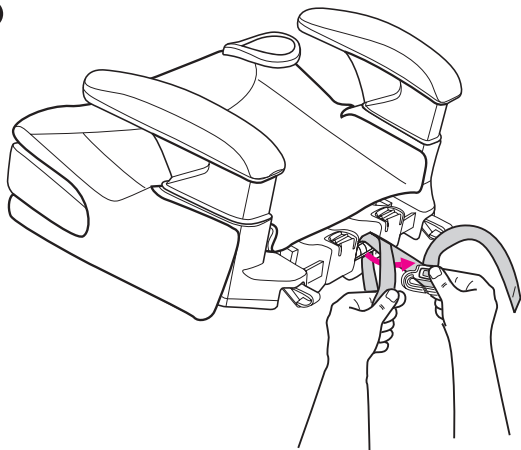

3

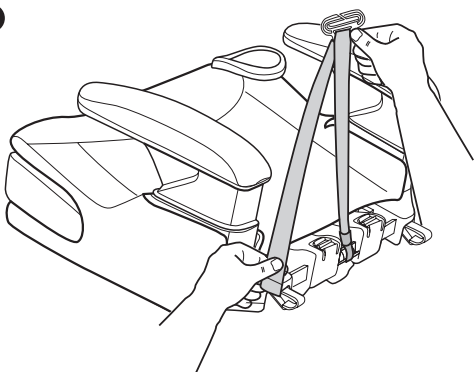

3. Slide the vehicle shoulder belt onto the clip as shown in ④ and pull strap down to tighten clip against child's shoulder.

The lap belt portion **MUST** pass under the armrests and be positioned low on the hips.

The belt MUST NOT be twisted.

④

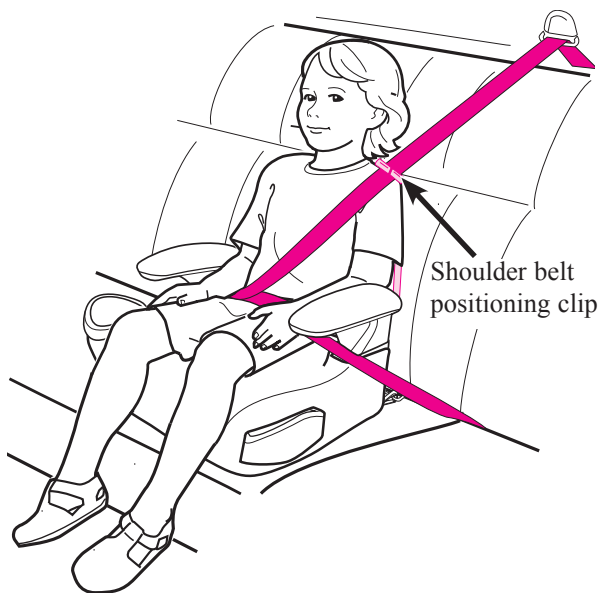

Rear view of child sitting in seat

5

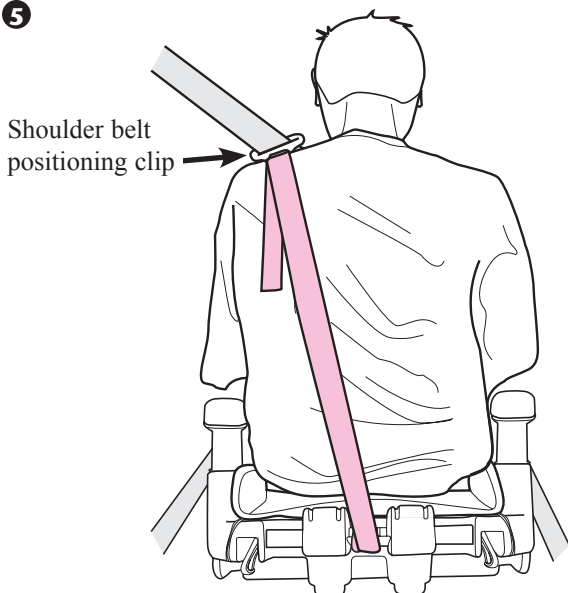

4. For warnings on vehicle belt positions, see page 23-25, "Using your Graco Booster Seat".

Additional Information

Airplane Use

This restraint is **NOT** certified for aircraft use because there are no shoulder belts available in an aircraft.

Cupholder and Storage Compartment

Cupholder and storage compartment are included on sides of the seat.

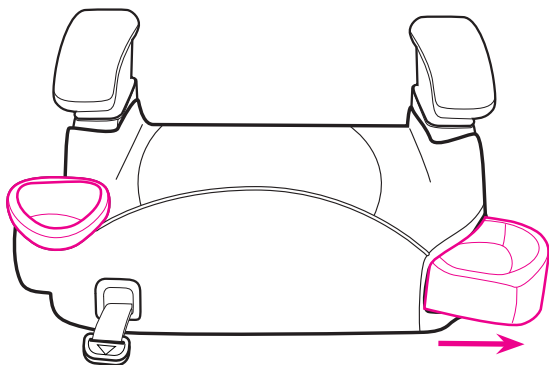

Instruction Sheet Storage

Your instruction sheet can be stored on the bottom of the seat as shown.

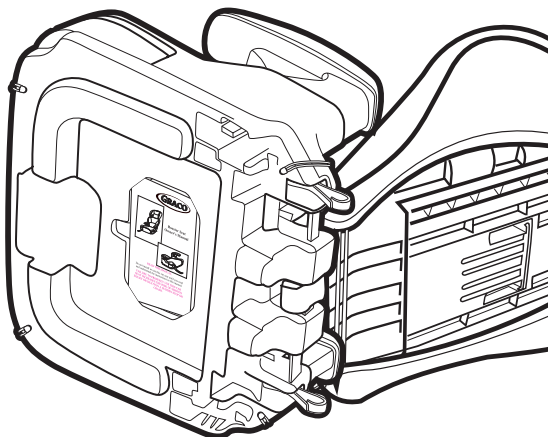

Care and Maintenance

- **CONTINUOUS USE OF BOOSTER SEAT MAY CAUSE DAMAGE TO VEHICLE SEAT.** Use a booster seat mat, towel or thin blanket to protect upholstery.
- **METAL AND PLASTIC PARTS:** clean with mild soap and cool water. No bleach or detergents.

To Remove Seat Cover

1. Remove elastic loops and hooks from seat as shown **1**.

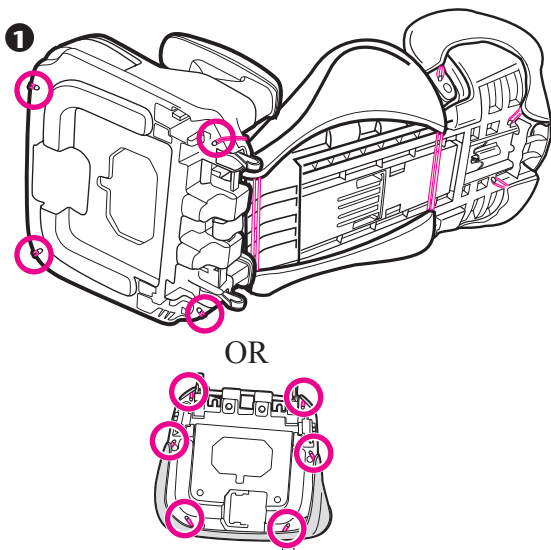

Refer to your care tag on your seat pad for washing instructions. NO BLEACH.

3. To put the seat cover back on, re-attach pad, loops and hooks.

Notes

Replacement Parts

To purchase parts or accessories or for warranty information in the United States, please contact us at the following:

www.gracobaby.com

or

1-800-345-4109

