

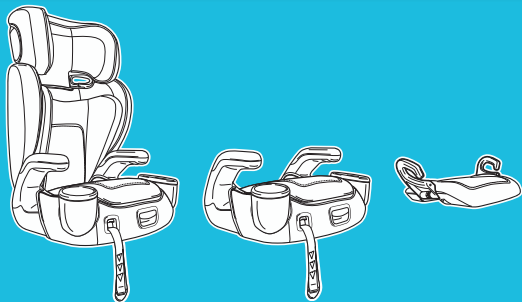

TURBOBOOSTER® GROW™

featuring RightGuide™ Seat Belt Trainer

Read This Instruction Manual



Do not install or use this child restraint until you read and understand the instructions in this manual.

FAILURE TO PROPERLY USE THIS CHILD RESTRAINT INCREASES THE RISK OF SERIOUS INJURY OR DEATH IN A SUDDEN STOP OR CRASH.

1 Important

Pages 5-17

1-A Quick Guide to Your Manual

1-B Welcome to the Graco Family

1-C Before You Begin

Register This Car Seat

If You Need Help

Certification

Car Seat's Useful Life

Vehicle Seat Protection

Warm Weather Use

1-D Safety Warnings

2 Features

Pages 18-23

2-A Car Seat Features

3 Booster

Pages 24-34

- 3-A Booster Use**
- 3-B Install Highback Booster**
- 3-C Install Backless Booster**
- 3-D Install RightGuide™ Seat Belt Trainer**

4 Securing Child

Pages 35-50

- 4-A Securing Child in Highback Booster**
- 4-B Securing Child in Backless Booster**
- 4-C Securing Child in RightGuide™ Seat Belt Trainer**

5 Reinstall RightGuide™ Seat Belt Trainer to Booster

Pages 51-52

6 Accessories

Page 53

7 Vehicle Information

Pages 54-58

- 7-A How to Remove Lower Anchor Connectors**
- 7-B Choosing Vehicle Seat Location**
- 7-C Unsafe Vehicle Seat Location**
- 7-D Vehicle Seat Belts**

8 Care & Cleaning

Pages 59-67

- 8-A Cleaning Seat Pad**
- 8-B Cleaning Lower Anchor Straps**

1-A Quick Guide to Your Manual

This car seat is for children:

Highback Booster:

40-100 lb (18.1-45 kg) 43-57 in. (110.1-145 cm) at least 4 years old

Backless Booster:

40-110 lb (18.1-50 kg) 43-57 in. (110.1-145 cm) at least 4 years old

RightGuide™ Seat Belt Trainer:

50-120 lb (22.5-54 kg) 43-60 in. (110.1-152 cm) at least 5 years old

Car Seat Assembly (On Select Models)

Adult Assembly Required

1. Attach Headrest to Seat Back

Squeeze the adjustment button and slide the headrest into the seat back.

CHECK to make sure the two pieces are securely snapped together by pulling on them.

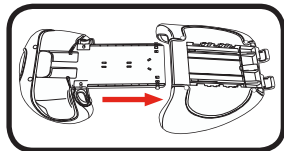
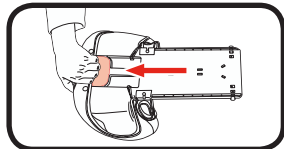

1 Important

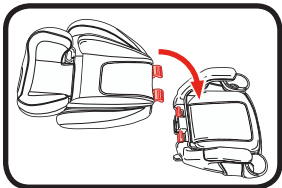
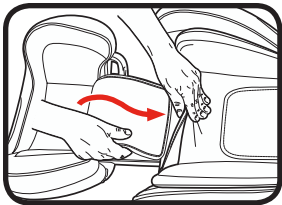

2. **Headrest Seat Pad**

With the headrest all the way up, insert the pad from the headrest underneath the seat back pad.

3. **Attach Seat Back to Base**

The "U"-shaped hooks on bottom of the seat back will interlock with bars on the base. Make sure that no part of the seat pad interferes when attaching the backrest to the base.

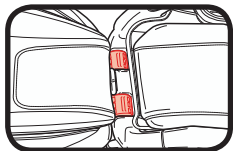

4. **Raise Seat Back**

Once the seat back is securely attached to the base, push backrest up.

5. **Attach Cup Holder and Storage Compartment**

Align locking tabs with the holes in the base. Push down to lock them in.

Circular cup holder goes on the left and the oval storage compartment goes on the right as shown.

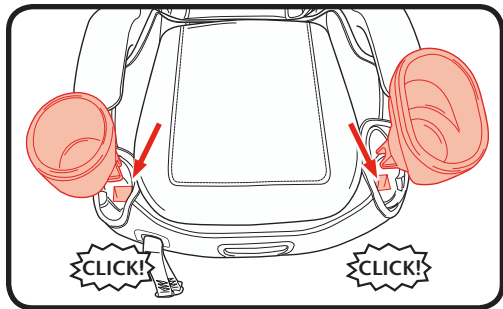

Assembly Complete

Your Graco booster seat is now ready to use.



i
1 Important



1 Important

Get to Know Your Car Seat

Review section 2-A to see all of the features of this booster seat.

What Seating Location Should I Use?

The best seating location for this booster seat is one that:

- Is recommended by your vehicle owner's manual, and
- Results in a secure installation of this booster seat.

Some vehicles have specific requirements for where the booster seat can be installed, so be sure to check your vehicle owner's manual for available seating positions, if any. For example, sometimes the center rear seat has a lap belt only vehicle seat belt, which cannot be used with this booster seat.

Review section 7-B, 7-C, 7-D of this manual AND your vehicle owner's manual.

According to accident statistics, the safest place for your child in any vehicle is the back seat. The center of the back seat can be the safest during a possible side impact.



Using The Car Seat Correctly

To make sure your child is secured properly, review section 3 and 4 to fit your child.

When Installing As a Booster

Lower Anchor System

The lower anchor system consists of lower anchor bars, which are built-in to your vehicle, and connectors that are built-in your car seat.

Review section 3 of this manual AND your vehicle owner's manual.

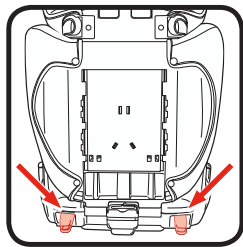
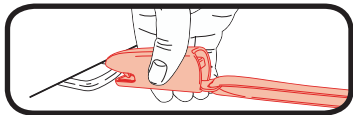

Vehicle Seat Belt

There is one type of vehicle seat belt that can be used: Lap/Shoulder Seat Belt.

Review section 3 of this manual AND your vehicle owner's manual.

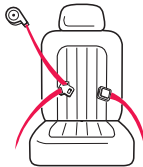

Booster Installation

Use Lap/Shoulder Belt Only

Review section 3

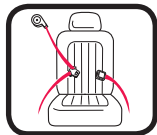

Position Lap Belt

Be sure the lap portion of the vehicle seat belt goes in front of both armrests and the shoulder belt goes under the armrest on the buckle side.

Review section 3



Highback



Backless

Position Lap Belt on RightGuide™ Seat Belt Trainer

Be sure the lap portion of the vehicle seat belt goes through both seat belt guides and the shoulder belt goes through the seat belt guide on the buckle side.

Review section 3



**RightGuide™
Seat Belt Trainer**

Booster Installation

Position Shoulder Belt

Shoulder belt lies across shoulder between neck and edge of shoulder.

Review section 3



1-B Welcome to the Graco Family!

Your child's safety depends on you. No car seat can guarantee protection from injury in every situation, but proper use helps reduce the risk of serious injury or death.

Even if this car seat seems easy to figure out on your own, you must follow the detailed instructions in this instruction manual to ensure the steps below are performed correctly.



1 Important

1-C Before You Begin

Register This Child Restraint

Please fill out the prepaid registration postcard attached to the seat and mail it in today **or register online at www.gracobaby.com/carseatregistration.**

Child restraints could be recalled for safety reasons. You must register this restraint to be reached in a recall. Send your name, address, and the restraint's model number and manufacturing date to:

Graco Children's Products, Inc.

Attn: Customer Service

P.O. Box 169, Elverson, PA 19520-9901

or call 1-800-345-4109

or register online at www.gracobaby.com/carseatregistration

For recall information, call the U.S. Government's Vehicle Safety Hotline at 1-888-327-4236 (TTY: 1-800-424-9153), or go to <http://www.NHTSA.gov>.

For future reference or if you change addresses, record the model name, model number, date of manufacture and purchase date of this car seat on the below. These numbers can be found on a sticker on the bottom of your car seat.

Model Name _____

Model Number _____

Date of Manufacture _____

Date of Purchase _____

If You Need Help

In the U.S.A, please contact our Customer Service Department with any questions you may have concerning parts, use, or maintenance. When you contact us, please have your product's model number and date of manufacture ready so that we may help you efficiently. These numbers can be found on a sticker on the bottom of your car seat.

For additional resources or to get your car seat checked by a child passenger safety technician, please visit the following web sites:

www.nhtsa.gov • www.seatcheck.org • www.safekids.org



1 Important



Certification

This child restraint meets or exceeds all applicable requirements of Federal Motor Vehicle Safety Standard 213 for use in motor vehicles.



This child restraint is NOT certified for aircraft use because aircrafts do not have shoulder belts.

Car Seat's Useful Life

STOP using this car seat and throw it away 10 years after the date of manufacture. Look for date of manufacture label on the bottom of the car seat.

Graco Children's Products Inc. advises against loaning or passing along a car seat unless you know the complete history of the product. We also advise against purchasing a car seat second hand.

Vehicle Seat Protection

Protect vehicle seat. Use a car seat mat, towel, or thin blanket under and behind car seat.

Warm Weather Use

Car seat parts can get very hot in the sun or warm weather. **To avoid burns, always check before putting child in car seat.**

1-D Safety Warnings

No car seat can guarantee protection from injury in every situation, but proper use helps reduce the risk of serious injury or death. **READ THIS MANUAL CAREFULLY.**

WARNING!

Failure to follow these instructions and child restraint's labels can result in child striking the vehicle's interior during a sudden stop or crash.



1 Important

- ! Review your vehicle owner's manual for more information about air bags and car seat use.**
- ! If your vehicle does not have a back seat, review your vehicle owner's manual.**
- ! Select a suitable location for the car seat in your vehicle.**
- ! Always secure car seat with the lower anchor connectors or a vehicle seat belt, even when unoccupied. In a crash, an unsecured car seat can injure passengers.**
- ! If car seat is in a crash, it must be replaced. DO NOT use it again! A crash can cause unseen damage and using it again could result in serious injury or death.**
- ! The American Academy of Pediatrics (AAP) recommends that children should use a built-in harness system car seat for as long as possible until they reach the maximum forward-facing weight or height for their car seat. After reaching the maximum forward-facing weight or height, they also recommend that children 4 feet 9 inches (145cm) tall or under should ride in a belt-positioning booster seat.**

- ! DO NOT use car seat if it is damaged or missing parts.**
- ! DO NOT use accessories or parts other than those provided by Graco. Their use could alter the performance of the car seat.**
- ! Never leave child unattended, even when sleeping. Child may become tangled in vehicle belt straps and suffocate or strangle.**



- ! Never attach two lower anchor connectors to one vehicle lower anchor bar unless specifically allowed by the vehicle manufacturer.**

2-A Car Seat Features

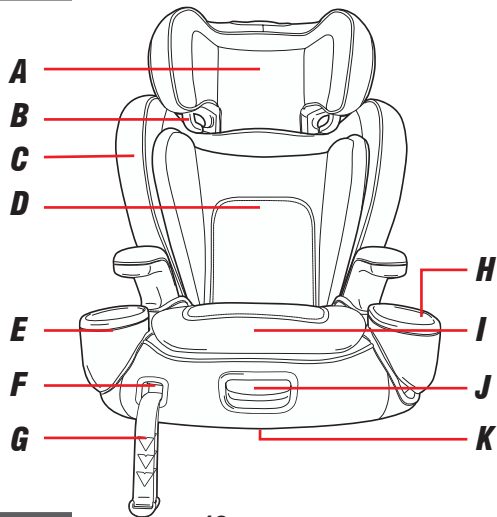

- A Headrest***
- B Shoulder Belt Guide***
- C Backrest***
- D Body Support***
- E Cup Holder***
- F Lower Anchor Adjuster Button***
- G Lower Anchor Adjustment Straps***
- H Storage Compartment***
- I RightGuide™ Seat Belt Trainer***
- J RightGuide™ Seat Belt Trainer Release Lever***
- K Instruction Manual Storage***



2 Features

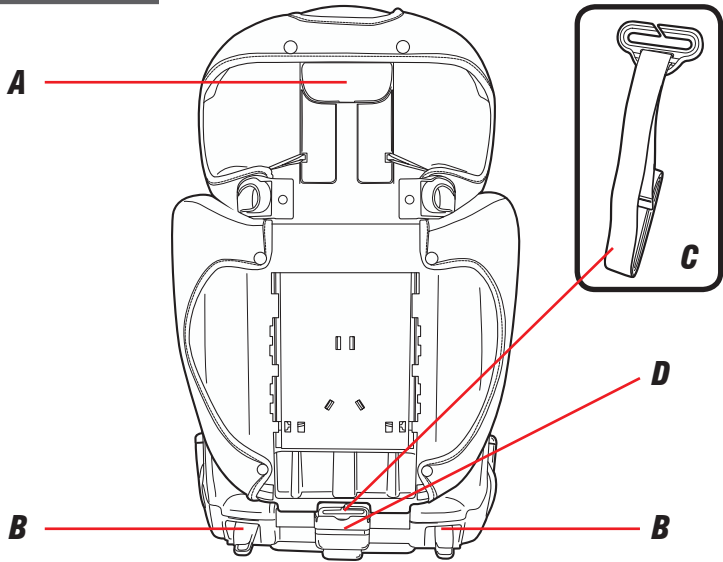

A Headrest Adjustment Lever

B Lower Anchor Connectors

C Belt Positioning Clip (Inset)

D Belt Positioning Clip Storage



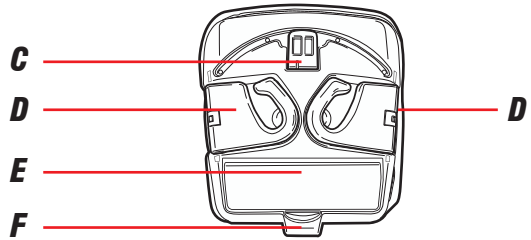
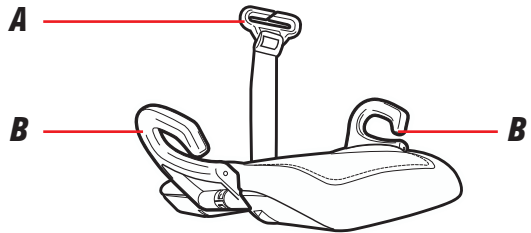

- A Belt Positioning Clip***
- B Belt Guides***
- C RightGuide™ Seat Belt Trainer Lock***
- D Belt Guides***
- E Belt Positioning Clip and
Instruction Manual Storage***
- F Rear Locking Tab***





3-A Booster Use

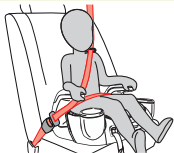
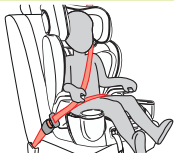

Vehicle Lap/Shoulder Belt

Booster Use With Back:
40-100 lb (18.1-45 kg)
43-57 in. (110.1-145 cm) at least 4 years old*

Booster Use Without Back:
40-110 lb (18.1-50 kg)
43-57 in. (110.1-145 cm) at least 4 years old*

RightGuide™ Seat Belt Trainer:
50-120 lb (22.5-54 kg)
43-60 in. (110.1-152 cm) at least 5 years old*

- Place car seat forward-facing in the vehicle back seat.
- Make sure vehicle seat's lap belt is adjusted snugly and lays low on the child's hip and is routed in front of the armrest in the booster's belt path.
- Vehicle belts **MUST** lie flat against child and **MUST NOT** be twisted.
- Vehicle seat's shoulder belt is adjusted snugly and should lie between child's neck and edge of shoulder.

- **Never** use a vehicle lap-only belt across front of child.
- **DO NOT** position vehicle shoulder belt under the child's arm or back.
- **DO NOT** allow child to slouch or slide down in the booster seat.
- **DO NOT** position vehicle belt over top of armrests or the belt guides.
- Vehicle's seat headrest **SHOULD NOT** create a gap between vehicle seat and booster seat in the highback mode.
- The front of booster seat **MUST NOT** hang over front of vehicle seat.
- If child will not keep vehicle belt properly positioned, **DO NOT** use this booster seat. Use a different car seat.
- The AAP recommends that children should use the built-in harness system for as long as possible until they reach the maximum forward-facing weight or height for their car seat, and after reaching the maximum forward-facing weight or height, that children 4 feet 9 inches (145 cm) tall or under should ride in a belt-positioning booster seat.

*Check your state laws and the AAP/NHTSA recommendations.

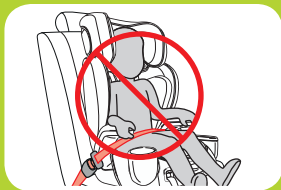

Never Use a Vehicle Lap-Only Belt Across Front of Child in All Booster Modes



3 Booster



3-B Install Highback Booster

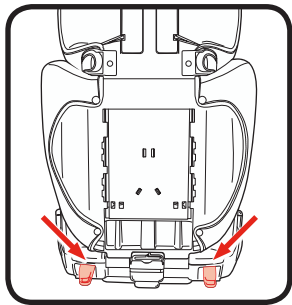

you **MUST** store the lower anchor straps. Always secure car seat with the lower anchors or a vehicle seat belt, even when unoccupied. In a crash, an unsecured car seat can injure passengers.

Graco allows the securing of the car seat with the lower anchor system in the booster mode, only if the vehicle manufacture allows it. The child still **MUST BE SECURED** with the vehicle lap/shoulder seat belt. The lower anchors can be used in the booster mode regardless of the weight of the child up to 110 lb (50 kg).

Verify the following before using the lower anchors in the booster mode:

- The lower anchor attachment **DOES NOT** interfere with any vehicle seat belts or buckles.

If the lower anchor attachment interferes with the vehicle seat belts or if the chosen seating position does not have lower anchor bars,

Note: You can use the Highback Booster WITH or WITHOUT the RightGuide™ Seat Belt Trainer.

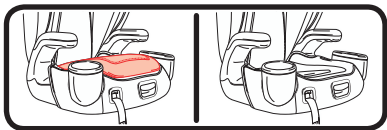

1. Place Car Seat Forward-Facing in Back Seat of the Vehicle

Place forward-facing in vehicle seat. The bottom of the seat should sit as flat as possible on the vehicle seat.



Skip to Step 5 if Not Using the Lower Anchors



3 Booster

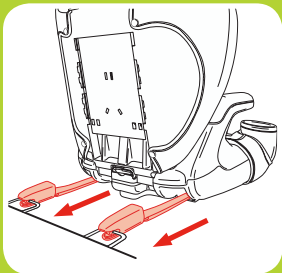
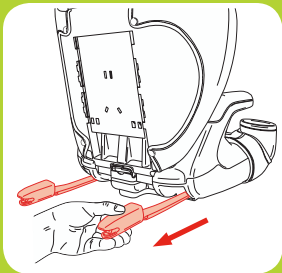

2. **Extend the Lower Anchor Straps**

For easier installation, extend the lower anchor straps to their maximum length by pressing the red button on the front of the base and pulling out on the straps.

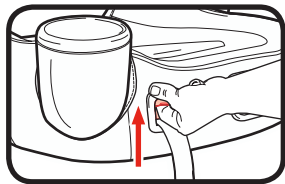

3. **Attach Lower Anchor Connectors to Vehicle's Lower Anchor Bars**

Lower Anchor straps should not be twisted.

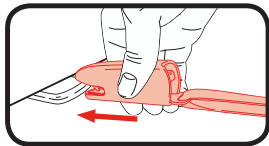

4. Tighten the Lower Anchor Straps

Remove all the slack from the lower anchor straps by pushing on the booster and pulling straps on front of the booster.

Depending on your vehicle, you may need to align the lower connectors with the slots in the base to get a good install.

The bottom of the seat should sit as flat as possible on the vehicle seat.

5. Thread the Vehicle Seat Shoulder Belt Through Seat Belt Guide on the Headrest

See section 4-A to secure your child

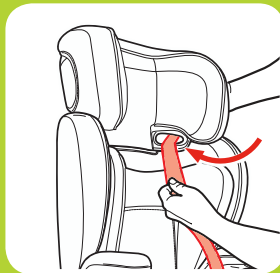

3 Booster



3-C Install Backless Booster

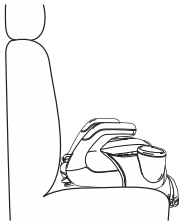
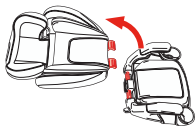

Note: You can use the Backless Booster WITH or WITHOUT the RightGuide™ Seat Belt Trainer.

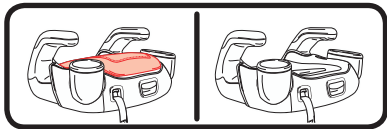

1. **Remove the Backrest**

Recline backrest then remove from base.

2. **Place the Booster Seat Forward-Facing in the Back Seat of Vehicle**

Place forward-facing on a vehicle seat that has a lap/shoulder seat belt. The base should sit as flat as possible on the vehicle seat.

See section 4-B to secure your child

If Using the Lower Anchors

3. Extend the Lower Anchor Straps.

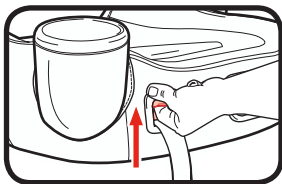

For easier installation, extend the lower anchor straps to their maximum length by pressing the red button on the front of the base and pulling out on the straps.

4. Attach Lower Anchor Connectors to Vehicle's Lower Anchor Bars.

Lower Anchor straps should not be twisted.

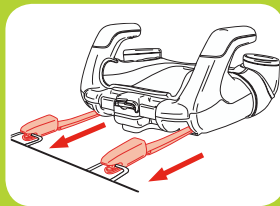
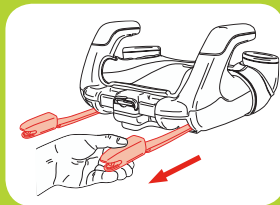
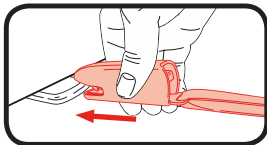

3 Booster



3 Booster



5. Tighten the Lower Anchor Straps

Remove all the slack from the lower anchor straps by pushing on the booster and pulling straps on front of the booster.

Depending on your vehicle, you may need to align the lower connectors with the slots in the base to get a good install.

The bottom of the seat should sit as flat as possible on the vehicle seat.

See section 4-B to secure your child

3-D Install RightGuide™ Seat Belt Trainer

1. *Remove RightGuide™ Seat Belt Trainer*
2. *Lay RightGuide™ Seat Belt Trainer Upside Down*
3. *Push The Lock Down*

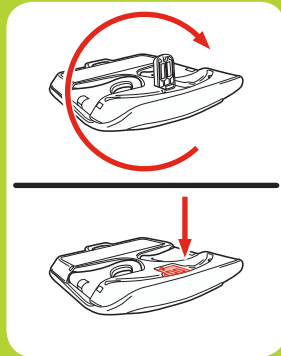
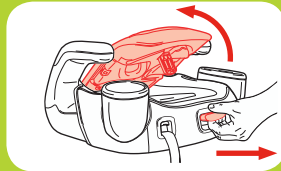

3 Booster



3 Booster

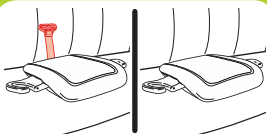
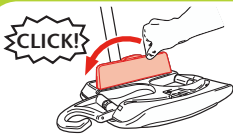
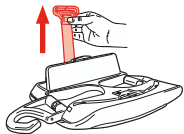
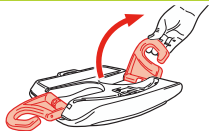

4. Rotate the Seat Belt Guides Out as Shown

Skip to step 7 if Shoulder Belt Positioning Clip is not needed to get a good fit

5. Open Storage Door and Pull Out the Shoulder Belt Positioning Clip

6. Close The Storage Door so it Clicks Closed

7. Place RightGuide™ Seat Belt Trainer Seat Right Side Up, Forward-Facing in Back Seat of Vehicle

See section 4-C to secure your child

4-A Securing Child Highback Booster

!WARNING!

Use only the vehicle's lap and shoulder belt system when restraining the child in this booster seat.

Note: You can use the Highback Booster WITH or WITHOUT the RightGuide™ Seat Belt Trainer.

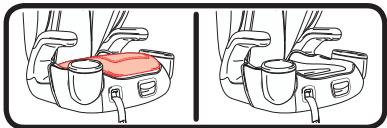

1. Place Child In Seat

Have your child sit in the booster seat, with his/her back flat against the back of the booster seat.

2. Thread Vehicle's Shoulder Belt Into Seat Belt Guide in the Headrest

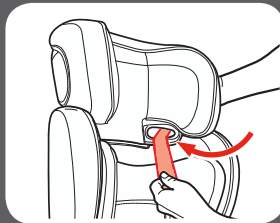



Forward-Facing

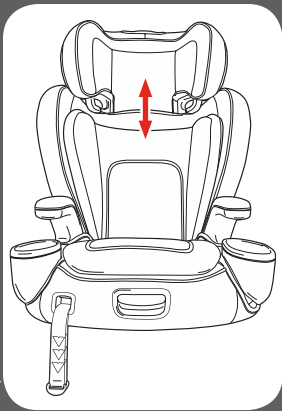

3. To Raise or Lower Headrest

Lift adjustment lever and lift or lower headrest for the proper shoulder belt height.

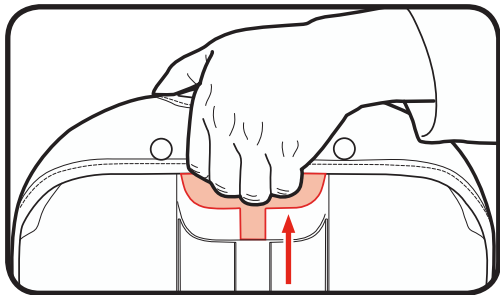

4. **Buckle the Vehicle Lap/Shoulder Seat Belt**

Be sure the lap portion of the vehicle seat belt goes in front of both armrests and the shoulder belt goes under the armrest on the buckle side.

Be sure the lap portion of the vehicle seat belt lies low across your child's hips.

Be sure the shoulder belt lies across your child's shoulders, between the neck and edge of shoulder by raising or lowering the headrest. The belt guides should be even with or just above the shoulders.

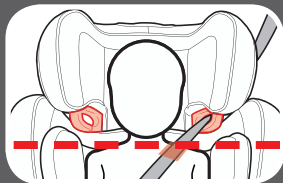
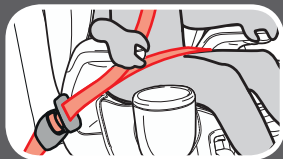

4 Securing
Child

Is Everything Correct?



Never Use Lap Belt Only

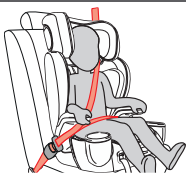

Lap Belt in Front of Armrest and Lies Low Across Hips and Thighs

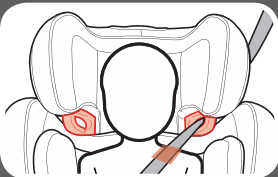

Shoulder Belt Lies On the Shoulder, Between the Neck and Edge of Shoulder

**4 Securing
Child**



4-B Securing Child Backless Booster

!WARNING!

Use only the vehicle's lap and shoulder belt system when restraining the child in this booster seat.

Note: You can use the Backless Booster WITH or WITHOUT the RightGuide™ Seat Belt Trainer.

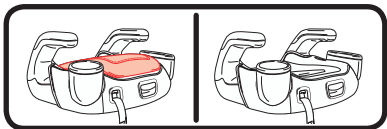

1. Place Child In Seat

Have your child sit in the booster seat, with his/her back flat against the back of the vehicle seat.

2. Ears Must Be Below the Top of the Vehicle Seat Back or Headrest.

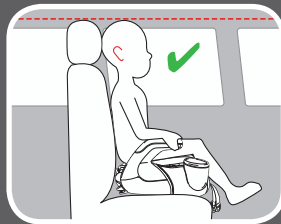

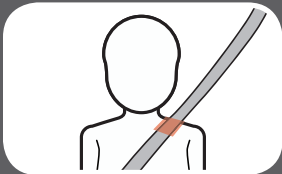
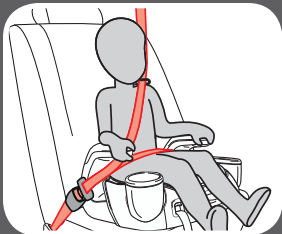

3. **Buckle the Vehicle Lap/Shoulder Seat Belt**

Be sure the lap portion of the vehicle seat belt goes in front of both armrests and the shoulder belt goes under the armrest on the buckle side.

Be sure the lap portion of the vehicle seat belt lies low across your child's hips.

Be sure the shoulder belt lies across your child's shoulders, between the neck and edge of shoulder.

You may need to use the belt positioning clip to help get a good fit. See "Using Belt Positioning Clip" (page 42).

Is Everything Correct?

Never Use Lap Belt Only

Lap Belt in Front of Armrest and Lies Low Across Hips and Thighs

Shoulder Belt Lies On the Shoulder, Between the Neck and Edge of Shoulder

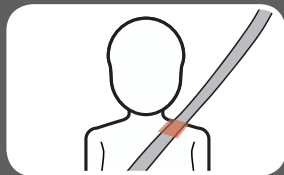

**4 Securing
Child**

Using Belt Positioning Clip in Backless Booster Mode



1. **Make Sure Vehicle's Seat Shoulder Belt Lays in the Red Zone As Shown**

If the vehicle's seat shoulder belt lays outside this zone, you **MUST** use the belt positioning clip.

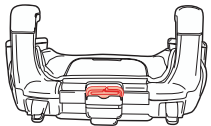

2. **Pull Belt Positioning Clip Out of Storage**

From the back of the seat, completely pull out the belt positioning clip.

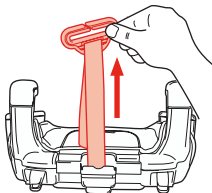

3. *Free End of Strap Should Face Front of Seat*

4. *Place Child in Seat, Buckle Child In Seat and Attach Belt Positioning Clip*

With child's back flat against the back of the vehicle seat, buckle child in. Then slide the clip onto the vehicle's seat shoulder belt as shown.

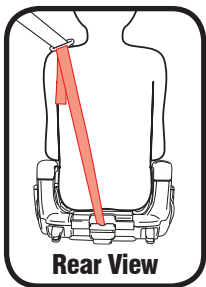

43

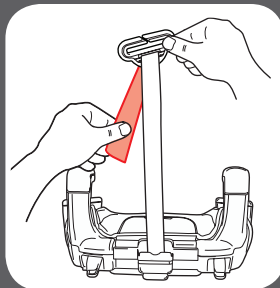

4 Securing
Child

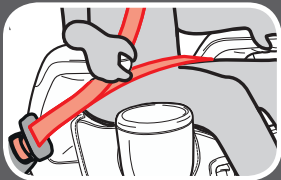
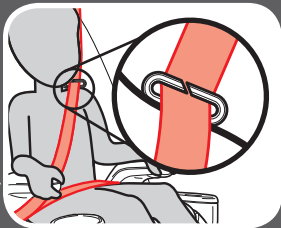
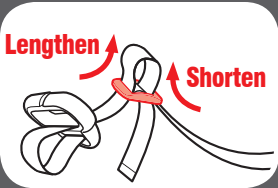

5. *Adjust the Belt Positioning Clip to Fit Your Child*

Lengthen or shorten the belt length as shown.

Clip should fit right at the top of shoulder as shown.

Be sure the lap portion of the vehicle seat belt lies low across your child's hips.

4-C Securing Child in RightGuide™ Seat Belt Trainer

! WARNING!

Use only the vehicle's lap and shoulder belt system when restraining the child in this booster seat.

1. Place Child In RightGuide™ Seat Belt Trainer

Have your child sit in the RightGuide™ Seat Belt Trainer, with his/her back flat against the back of the vehicle seat.

2. Ears Must Be Below the Top of the Vehicle Seat Back or Headrest.

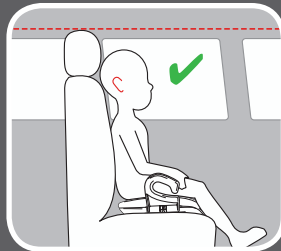

**4 Securing
Child**

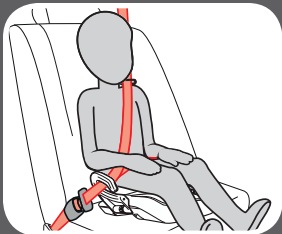

3. ***Buckle the Vehicle Lap/Shoulder Seat Belt***

Be sure the lap portion of the vehicle seat belt goes through both seat belt guides and the shoulder belt goes through the seat belt guide on the buckle side.

Be sure the lap portion of the vehicle seat belt lies low across your child's hips.

Be sure the shoulder belt lies across your child's shoulder, between the neck and edge of shoulder.

You may need to use the belt positioning clip to help get a good fit. See “Using Belt Positioning Clip” (page 48).

Is Everything Correct?

Never Use Lap Belt Only

Lap belt in front of belt guides and shoulder belt in front of the belt guide on the buckle side. Lap belt lies low across hips and thighs.

Shoulder Belt Lies On the Shoulder, Between the Neck and Edge of Shoulder



**4 Securing
Child**

Using Belt Positioning Clip in Seat Belt Trainer Mode

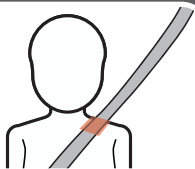

1. **Make Sure Vehicle's Seat Shoulder Belt Lays in the Red Zone As Shown**

If the vehicle's seat shoulder belt lays outside this zone, you **MUST** use the belt positioning clip.



2. **Open Storage Door and Pull Belt Positioning Clip Out of Storage**

From the back of the seat, completely pull out the belt positioning clip.

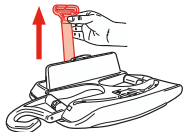

3. *Free End of Strap Should Face Front of Seat*

4. *Place Child in Seat, Buckle Child In Seat and Attach Belt Positioning Clip*

With child's back flat against the back of the vehicle seat, buckle child in. Then slide the clip onto the vehicle's seat shoulder belt as shown.

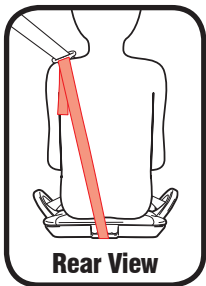

49



4 Securing
Child

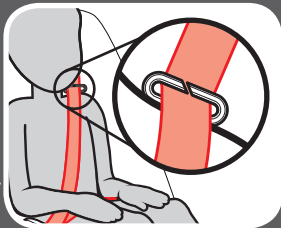
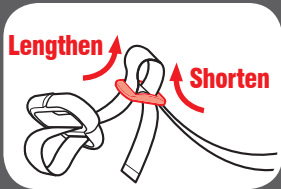

5. *Adjust the Belt Positioning Clip to Fit Your Child*

Lengthen or shorten the belt length as shown.

Clip should fit right at the top of shoulder as shown.

Be sure the lap portion of the vehicle seat belt lies low across your child's hips.

5 Reinstall RightGuide™ Seat Belt Trainer to Booster

1. *Open Storage Door and Store the Shoulder Belt Positioning Clip if it was Used*
2. *Fold in Seat Belt Guides*
3. *Pull Up RightGuide™ Seat Belt Trainer Lock*

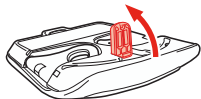
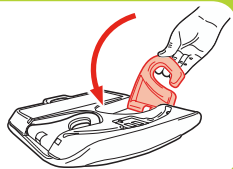
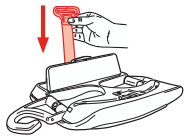

5 Seat Belt
Trainer

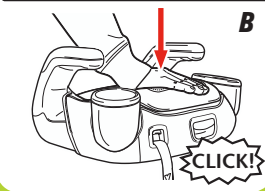
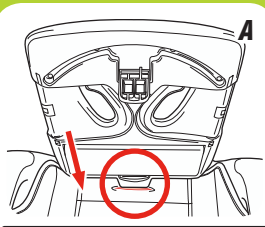

4. **Attach RightGuide™ Seat Belt Trainer to Seat Base**

Slide back Rear Locking Tab into the opening on the back of the Seat Base (A). Push the front of the RightGuide™ Seat Belt Trainer down on the Seat Base. You will hear a click when it is into place (B).

Make sure belt guides are tucked under the RightGuide™ Seat Belt Trainer



CHECK that the RightGuide™ Seat Belt Trainer is securely attached by pulling up on it.

6 Accessories (on select models)

Body Support (Optional)

Never allow body support to bunch or fold behind child.

To remove, pull the attachment strap out of the backrest pad.

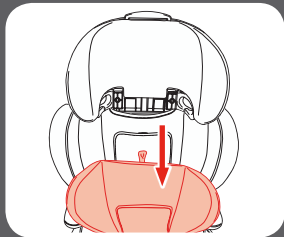
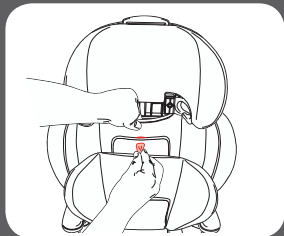



7-A How to Remove Lower Anchor Connectors

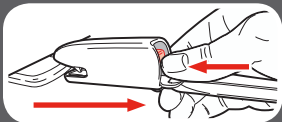
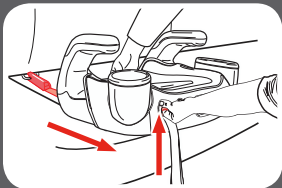

Lower Anchor Connector

Push release button up on front of booster and pull slightly away from seat.

Push in on the red button and pull off.

7-B Choosing Vehicle Seat Location

Review your vehicle's owner manual for Seating Locations

The best seating location for this car seat is one that:

- Is recommended by your vehicle owner's manual, and
- Results in a secure installation of this car seat

In the event there is no available back seat and / or you have no other option, the National Highway Traffic Safety Administration (NHTSA) recommends that you take the following steps:

- Ensure the child is properly restrained according to their age and size
- Move the seat as far back as possible
- Make sure the child is not leaning out of position, such as leaning forward into the deployment path of the air bag
- Set the air bag ON-OFF switch, if available, to the OFF position





7-C Unsafe Vehicle Seat Location

Never install this car seat in any of the following vehicle seating locations:



rear-facing or side-facing
vehicle seats



booster mode with vehicle lap
belt only seat belt

7-D Vehicle Seat Belts

Review your vehicle's owner manual for vehicle seat belt use

Vehicle Seat Belt Terms

Retractor

A device that winds up the unused vehicle seat belt. It is often hidden inside the panels on the walls of the vehicle or in the vehicle seatback.

Latch Plate

The male end of the seat belt with the silver tongue.

Seat Bight

The crease where the vehicle seat back and seat bottom meet.

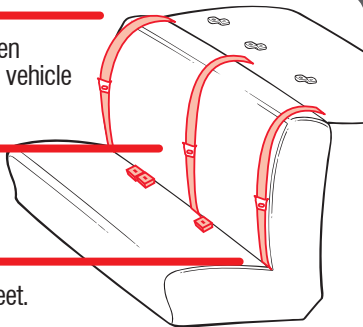



Identify Your Seat Belt Type

There is one type of vehicle seat belt that can be used with this car seat:

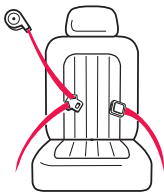

Lap/Shoulder Belt 3
connections points. Can be used
in all car seats modes of use.

The following types of vehicle seat belts **CANNOT** be used safely with this car seat:



Lap Belt Only 2
connection points.



Lap Belt with Motorized
Shoulder Belt

Belts Forward of the
Seat Bight



Lap Belt or Shoulder Belt
Mounted on Door



Some vehicles you may not
get a secure fit. Read both your
vehicle and car seat manuals.

8-A Cleaning Seat Pad

Refer to seat pad care tag for washing instructions.

Headrest Pad

Clean with a damp sponge using mild soap and cool water. If needed, headrest pad may be removed for cleaning.

To remove, raise the headrest and undo the 2 elastic straps and the 2 snaps.

Pull off headrest pad as shown

Machine wash cover in cold water on delicate cycle and drip-dry. **DO NOT USE BLEACH.**

Reverse the steps to reattach the headrest pad.

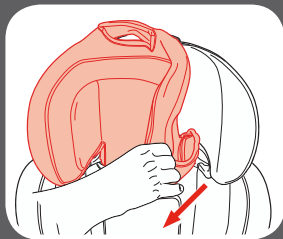
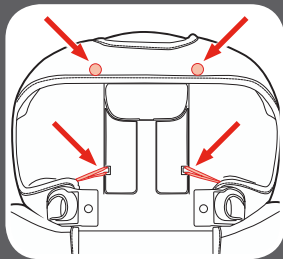

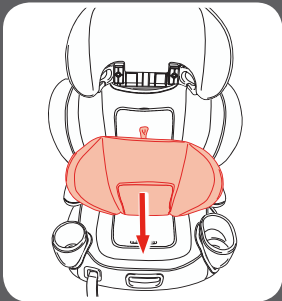
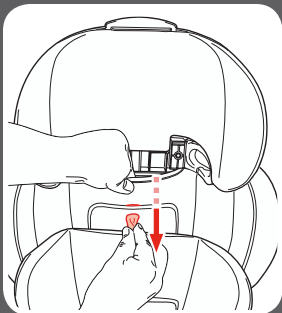

Body Support

Clean with a damp sponge using mild soap and cool water. If needed, body support may be removed for cleaning.

To remove, pull the attachment strap out of the backrest pad. Pull off body support as shown.

Machine wash cover in cold water on delicate cycle and drip-dry. **DO NOT USE BLEACH.**

Reverse the steps to reattach the body support.

Backrest Pad

Clean with a damp sponge using mild soap and cool water. If needed, backrest pad may be removed for cleaning.

To remove, undo the 4 snaps on the seat back.

Pull backrest pad off the backrest as shown.

Machine wash cover in cold water on delicate cycle and drip-dry. **DO NOT USE BLEACH.**

Reverse the steps to reattach the backrest pad.

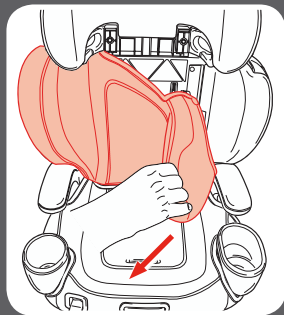
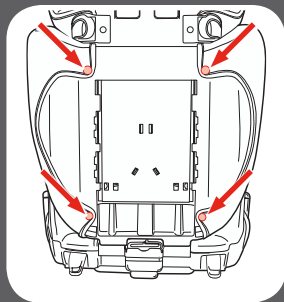

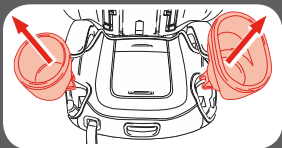
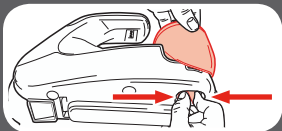
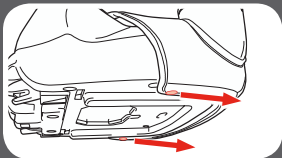
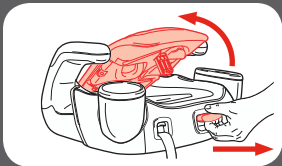

Base Pad

Clean with a damp sponge using mild soap and cool water. If needed, base pad may be removed for cleaning.

Remove RightGuide™ Seat Belt Trainer.

Undo the 2 snaps on each side at the bottom of the seat.

From the bottom of the seat, unhook cup holder and storage compartment by squeezing the locking tabs.

Remove cup holder and storage compartment as shown. Cup holder and storage compartment are dishwasher safe (top rack only).

Unhook plastic tabs on the back.

Remove base pad as shown.

Machine wash cover in cold water on delicate cycle and drip-dry. **DO NOT USE BLEACH.**

Reverse the steps to reattach the base pad, cup holder, storage compartment and RightGuide™ Seat Belt Trainer. Be sure to tuck the pad around the lower anchor adjuster button and RightGuide™ Seat Belt Trainer release lever housing.

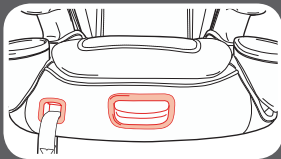
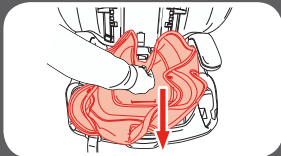
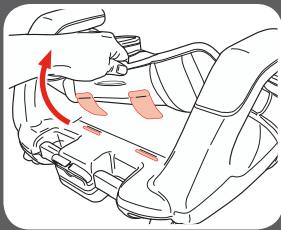



RightGuide™ Seat Belt Trainer

Clean with a damp sponge using mild soap and cool water. If needed, the seat belt trainer pad may be removed for cleaning.

Removing Seat Belt Trainer Pad

To remove the seat pad, start from the sides of the seat belt trainer and pull the pad out from around the plastic shell. Then pull the plastic tab out from the back of the shell.

Machine wash pad in cold water on delicate cycle and drip-dry. **DO NOT USE BLEACH.**

Attaching Seat Belt Trainer Pad

To put the set pad back on, reverse the steps. Start by inserting the plastic tab into the back of the seat.

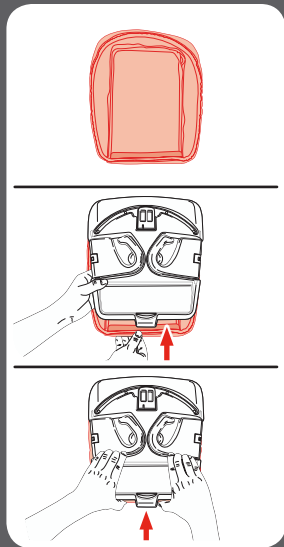

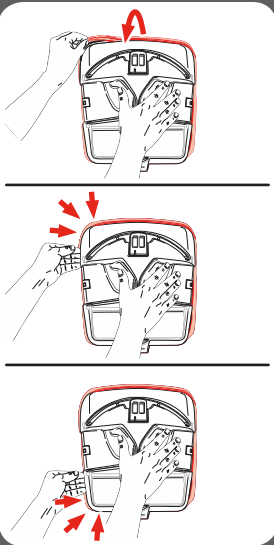

Pull the pad over the front of the seat and start tucking in the edge of the pad into the groove that is around the front and sides of the plastic shell.

8-B Cleaning Lower Anchor Straps

Surface wash only with mild soap and damp cloth. **DO NOT IMMERSE THE LOWER ANCHOR STRAPS IN WATER** Doing so may weaken the straps.

If lower anchor straps are frayed or heavily soiled, contact Customer Service at www.gracobaby.com or 1-800-345-4109.



Replacement Parts

To purchase parts or accessories in the United States,
please contact us at the following:

1-800-345-4109

or

www.gracobaby.com

