

Kwikset
SIGNATURE SERIES



↑
2-POINT LOCKING
for increased security
↓



PERALTA HANDLESET

Upgrade your entryway with a bold, modern edge. Peralta™ is perfect for those who appreciate clean lines, a minimalist aesthetic and peace of mind from a dual-lock design. It's the Kwikset® front door lock set that delivers on security without compromising on style.

- 2-Point Locking Exterior For Reliable Front Door Security
- 2-Point Locking Interior For Peace of Mind
- Bump- and Pick-Resistant SmartKey Security®
- Deadbolt has ANSI/BHMA Grade AAA Certified Security
- Easy Install with Just a Screwdriver
- Lifetime Mechanical and Finish Warranty



#1 SELLING U.S. LOCK BRAND*

Source: YipitData Unit Share Report, 2026

Specifications

Door Prep	Cross Bore 2 1/8". Edge Bore 1" Latch Face 1" x 2 1/4".
Backset	Adjustable 2 3/8" or 2 3/4".
Door Thickness	1 3/4" Standard.
Faceplates	1" x 2 1/4" includes round corner and drive-in.
Strikes	Deadbolt: 1 1/8" x 2 3/4" round corner, 1 1/4" x 3 5/8" round corner and 2 1/4" Full lip round corner. Handle: 2 1/4" Full lip round corner.
Bolt	Deadbolt: 1" throw Handle: 1/2" throw
Cylinder	SmartKey Security®
Door Handing	Reversible for right or left-handed doors.
ANSI/BHMA	Deadbolt is A156.40 Grade AAA Certified.
UL	N/A
ADA	N/A
Warranty	Lifetime mechanical and lifetime finish.

Adjustable Throughbolt

Vertical and horizontal slide designed for a guaranteed fit

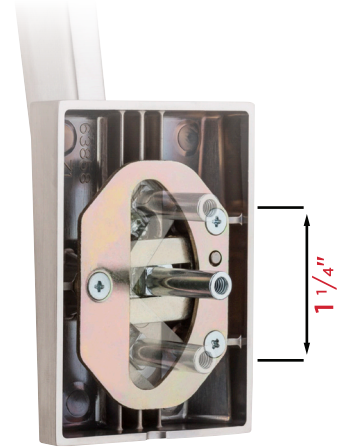

Functions



Handleset (Single Cylinder, 2-Point Locking):

Latch bolt operated by thumb piece outside.
Deadbolt operated by key outside.

- 553 PRH [Available with Halifax (HFL) lever] SMT

Dimensions

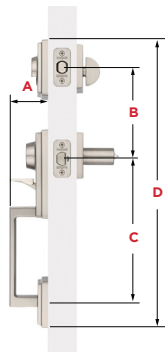

Dimensions	A	B	C	D
Peralta	2 9/16"	5 1/2"	8 13/32" to 9 11/16"	18 3/32"

Finishes



Satin
Brass 4

Satin
Nickel 15

Matte
Black 514



One Key For All Your Locks®

Protects against advanced break-in techniques and allows you to re-key your lock yourself in seconds.

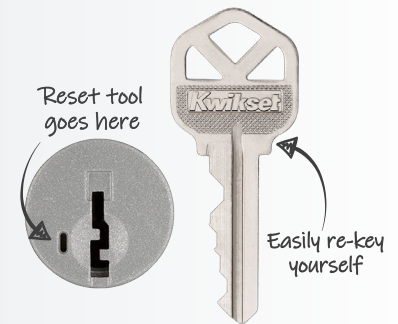

LIFETIME
WARRANTY