

Kwikset[®]

Introducing ALISO[™]



Features SmartKey[®] Re-Key Technology
with BumpGuard[™] Protection

ANSI/BHMA Grade 3 Certified Quality & Security

Lifetime Mechanical Warranty

Adjustable to Fit All Standard Door Preparations



#1 SELLING U.S. LOCK BRAND

ALISO™

Specifications:

Door Prep	Cross Bore 2 1/8". Edge Bore 1". Latch face 1" x 2 1/4"
Backset	Adjustable to 2 3/8" or 2 3/4"
Door Thickness	1 3/8" - 1 3/4" doors standard
Cylinder	SmartKey™
Faceplates	1" x 2 1/4". Specify 6-way, round corner, square corner, or drive in.
Strikes	2 1/4" full lip standard. Specify round corner, square corner.
Bolt	1/2" throw for all functions.
ANSI/BHMA	A156.2 Grade 3

Functions:

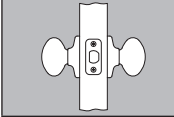
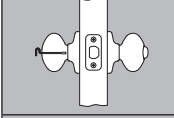
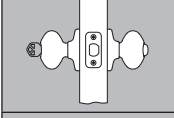
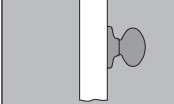
	Passage/Hall/Closet: Both knobs always free.
	Privacy/Bed/Bath: Both knobs locked or unlocked by turnbutton inside. Outside knob unlocked by emergency key.
	Keyed Entry: Both sides locked or unlocked by key outside or turnbutton inside.
	Half Dummy Trim, Surface Mounted: For doors where only a pull is required. No operation.

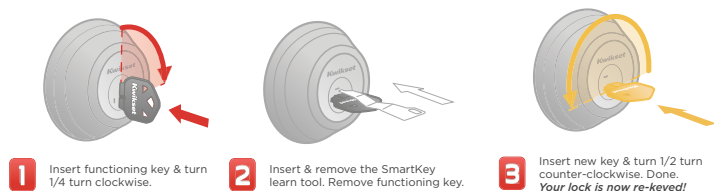

Dimensions:

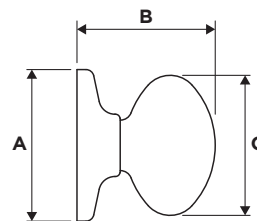

Design	A	B	C
Aliso™	2 5/8"	2 3/4"	2 2/5"

Finishes:

