

# Kwikset

## THE SMART SOLUTION FOR ANY SINGLE- OR MULTI-FAMILY PROJECT



### 780 Deadbolt

- Add to a keyed knob or lever for additional security
- ANSI/BHMA Grade 2 Security
- Fits all standard door preparations
- Lifetime mechanical and finish warranty
- Featuring SmartKey® Re-key Technology
- Patented side locking bar technology

THE BEST SECURITY IS SMART SECURITY.

## 780 Deadbolt

### Specifications:

|                       |  |
|-----------------------|--|
| <b>Door Prep</b>      | 780, 785: Crossbore 2-1/8" or 1-1/2". Edge Bore 1". Latch Face 1" x 2-1/4"<br>782, 784: Crossbore 2-1/8". Edge Bore 1". Latch Face 1" x 2-1/4" |
| <b>Backset</b>        | Adjustable to 2-3/8" or 2-3/4" standard.   |
| <b>Door Thickness</b> | 1-3/8" - 1-3/4" standard. 1-7/8" - 2-1/4" optional.  |
| <b>Cylinder</b>       | 6-pin removable core or SmartKey.  |
| <b>Faceplates</b>     | 1" x 2-1/4". Specify round corner or square corner, or drive-in.   |
| <b>Strikes</b>        | 1-1/4" x 3-5/8". Specify round corner or square corner. Other options available.   |
| <b>Bolt</b>           | 1" throw.  |
| <b>Door Handing</b>   | Reversible for right or left-hand doors.   |
| <b>ANSI/BHMA</b>      | Grade 2 Certified.   |
| <b>ADA</b>            | Interior turn piece meets 4.13.9 ADA requirements.   |
| <b>UL</b>             | Meets UL 3 hour fire rating for 782 and 784. Optional UL 1/3 hour fire rating for all functions.*  |

### Dimensions:

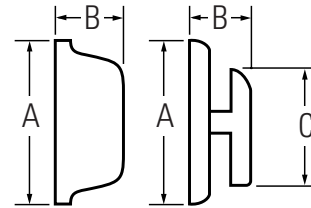

| Design            | A      | B      | C (Keyed) |
|-------------------|--------|--------|-----------|
| 780, 782 Interior | 2 1/2" | 15/16" | 1 25/32"  |
| 780, 782 Exterior | 2 5/8" | 1 1/8" |           |
| 784, 785 Interior | 2 5/8" | 1 1/8" |           |
| 784, 785 Exterior | 2 5/8" | 1 1/8" |           |

### Available Finishes:



## HOW SMARTKEY WORKS

Re-key as Easy as 1-2-3

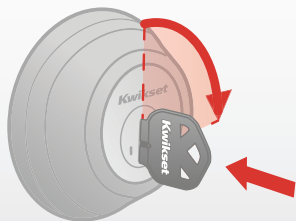

**1** Insert functioning key & turn 1/4 turn clockwise.

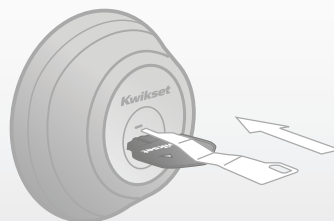

**2** Insert & remove the SmartKey learn tool. Remove functioning key.

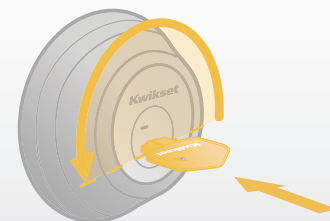

**3** Insert new key & turn 1/2 turn counter-clockwise. Done. *Your lock is now re-keyed!*



**!** You must have your functioning key & the learn tool for the system to work.