

**Kwikset**  
— Security Series



# 660 DEADBOLT

Kwikset's 660 Deadbolt offers effective security at an affordable price.

- Featuring SmartKey Security™
- ANSI/BHMA Grade 3 Certification
- Easy to Install



660 Deadbolt  
in Venetian Bronze

**#1 SELLING U.S. LOCK BRAND\***

Numerator TruView, Unit Share Report, 2024

## Specifications

<b>Door Prep</b>	Cross Bore 2 1/8". Edge Bore 1". Latch face 1" x 2 1/4".
<b>Backset</b>	Adjustable 2 3/8" or 2 3/4"
<b>Door Thickness</b>	1 3/8" - 1 3/4" doors standard. Thick Door Kit Available for 660 & 665 functions for up to 2 1/4"
<b>Cylinder</b>	SmartKey™ or 5-pin Pin & Tumbler
<b>Faceplates</b>	1" x 2 1/4" round corner, square corner & round face options available.
<b>Strikes</b>	1" x 2 1/4" Includes round corner & 2 1/4" full lip round corner. Other options available.
<b>Bolt</b>	1" Throw
<b>Door Handing</b>	Reversible for right or left-hand doors
<b>ANSI/BHMA</b>	A156.2 Grade 3
<b>UL</b>	20-minute UL certification available on 660 SMT in 26, 26D, 15 & 514 finishes. 3-hour UL certification available on 663 in 26, 26D, 15 & 514 finishes.
<b>ADA</b>	N/A
<b>Warranty</b>	Lifetime Mechanical and Lifetime Finish

## Dimensions

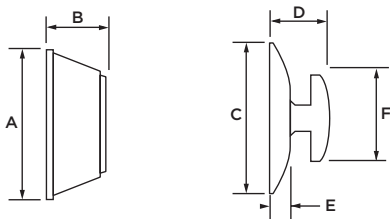

Design	A	B	C	D	E	F
660	2 7/16"	1 1/16"	2 1/2"	27/32"	5/16"	1 3/4"
663			2 1/2"	27/32"	5/16"	1 3/4"
665	2 7/16"	1 1/16"	2 1/2"	1 1/16"		

## Finishes



Matte Black **514**



Polished Brass **LO3/3**

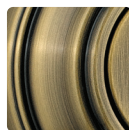

Antique Brass **5**



Satin Nickel **15**



Venetian Bronze **11P**



Polished Chrome **26**

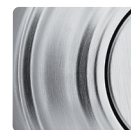

Satin Chrome **26D**

## Functions



### 660 Single Cylinder:

Deadbolt operated by key outside and thumb turn inside.



### 663 Thumb Turn Only:

Deadbolt operated by thumb turn. No trim on exterior.



### 665 Double Cylinder:

Deadbolt operated by key both sides.



### One Key For All Your Locks

Protects against advanced break-in techniques and allows you to re-key your lock yourself in seconds.

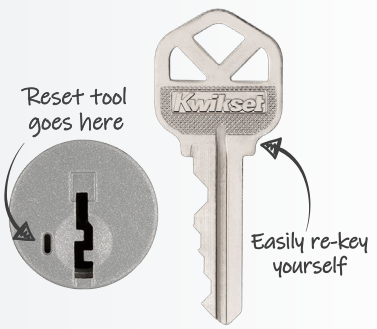

Reset tool goes here

Easily re-key yourself

LIFETIME WARRANTY