

# IMC COMPONENTS

## Intermetallic Composites

### TECHNICAL DATA

#### GENERAL PROPERTIES

Intermetallic composites (IMC) are unique materials that combine electrically insulating and electrically conductive materials to form a ceramic that can be heated to extreme temperatures using electrical resistance. IMC components are used when materials are required that can be superheated by electrical resistance, yet still resist molten metal and corrosive environments. Kennametal is a leading manufacturer of IMC components. We manufacture eight resistivity levels of IMC to meet any resistance requirement.

#### APPLICATIONS

- Metallization
- Semi-conductors
- Crucibles
- Electron beam evaporation
- Optical coating

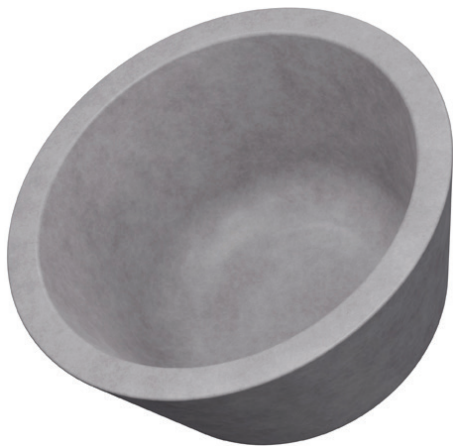

#### PHYSICAL PROPERTIES

Property	Unit	IMC
Maximum Use Temperature	°C	1020 (oxidizing) 1900 (inert)
Young's Modulus at RT	GPa	34,1 para 75,2 perp
Thermal Conductivity at 25 °C	W/m*K	120
Thermal Conductivity at 1200 °C	W/m*K	35
CTE, RT to 1500 °C	10 <sup>-6</sup> K <sup>-1</sup>	8 para 6 perp
Flexural Strength	MPa at 25 °C	150
Flexural Strength	MPa at 1200 °C	30
Density	g/cm <sub>3</sub>	3.01
Ca	ppm	<100
Cr	ppm	<20
Mg	ppm	<20
Ni	ppm	<10
Fe	ppm	<50
Si	ppm	<15
P	ppm	<10
S	ppm	<10

*Note: This data shows typical values and does not represent a specification.*

Kennametal manufactures sophisticated materials in the form of castings, powders, coatings, consumables, and machined parts that resist wear, corrosion, and abrasion. Information provided in this document is intended only for general guidance about Kennametal. Selection and purchase of Kennametal products is the sole responsibility of the product user. Individual applications must be fully evaluated by the user, including compliance with applicable laws, regulations, and non-infringement. Kennametal cannot know or anticipate the many variables that affect individual product use and individual performance results may vary. For these reasons, Kennametal does not warrant or guarantee information in this document and assumes no liability regarding the same. Kennametal makes no warranties regarding this information and disclaims all express or implied warranties with respect to this information, including, without limitation, all implied warranties of merchantability and fitness for a particular purpose and warranties of patent non-infringement. Kennametal will not be responsible for special, incidental, exemplary, or consequential damages that may be incurred pursuant to the use of the information provided in this document. To learn more, please contact your local Kennametal sales office.

#### Sales Offices

**Americas**  
Tel: 800 458 3608  
americas.sintec@kennametal.com

**United Kingdom (UK)**  
Tel: +44 (0)1633 63 65 00  
emea.sintec@kennametal.com

**Europe/Middle East/Africa**  
Tel: +49 (0)8861 2308 0  
emea.sintec@kennametal.com

**Asia Pacific**  
Tel: 852 2572 8991  
ap.sintec@kennametal.com

**China**  
Tel: +86 21 3718 0518  
ap.sintec@kennametal.com



**kennametal.com**