

**9469100**

1/2" Thermostatic Trim  
With Diverter And  
Volume Control

needs rough VALVE 691

**FINISHES**

9469100PC Polished Chrome  
9469100BN Brushed Nickel

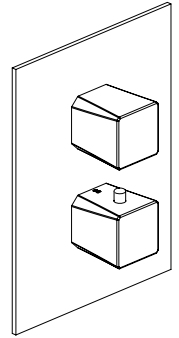

**STANDARDS** 

- Compliant with ASME A112.18.1 - CSA B125.1 when sold with rough valve
- Certified by IAPMO R&T Lab when sold with rough valve

**FEATURES**

- Solid Brass Construction
- Complete Trim Kit
- Mechanical diverter Controlling water flow
- Thermo Control Cartridge
- Independent Temperature Control
- Stop limit temperature device included
- Step-By-Step Installation Instructions

**DIMENSIONS**

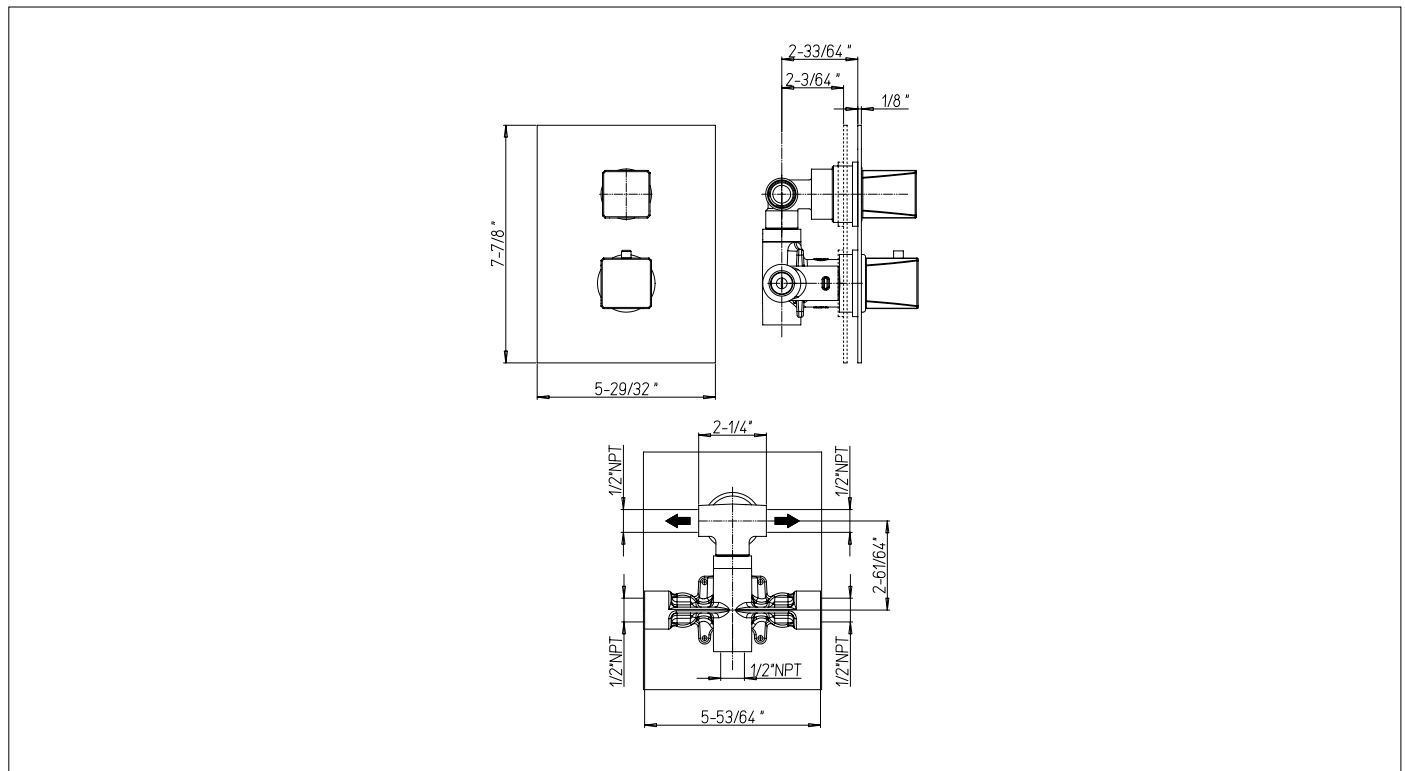

Project \_\_\_\_\_  
Contractor \_\_\_\_\_