



CAT® PRECISION SEALS

EXTREME PERFORMANCE FOR EXTREME CONDITIONS.

For over 60 years, Caterpillar has been engineering, testing, and deploying seals designed to withstand the lifespan of equipment with low maintenance resulting in increased uptime and productivity.

APPLICATION

Axles
Final Drives
Idlers
Rollers
Undercarriages
Mobile Track Systems
Pumps

PROVEN IN:

Light, Medium & Heavy Armored Tanks
Military Trucks & Transport Vehicles
Armored Personnel Carriers
Marine Power Solutions
Material Handling
Weapon & Firearm Vehicles

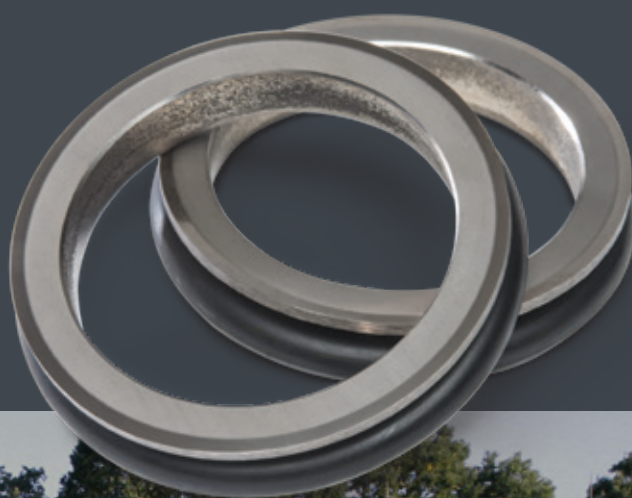

The appearance of U.S. Department of Defense (DoD) visual information does not imply or constitute DoD endorsement.



Cat® Duo-Cone™ Seal

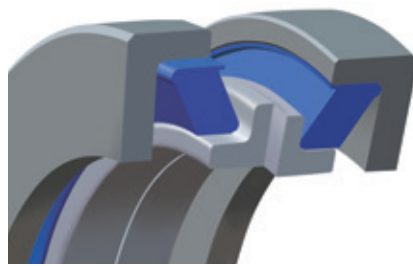

Cat® Heavy Duty Dual Face Seal

**45% SUPERIOR WEAR LIFE
COMPARED TO COMPETITORS**

Seal Ring Material Options

	C6	Stellite	NiHard	Formed
Material	Nickel-Alloy	Iron-Alloy	Iron-Alloy	SEA 1074
Process	Cast	Cast	Cast	Stamped
Wear Life	High	High	Satisfactory	Low
Corrosion Resistance	High	Satisfactory	Satisfactory	Satisfactory
Scoring Resistance	High	Low	Satisfactory	Low

Additional seal ring materials available.

Load Ring Material Families

	Nitrile	LT Nitrile	Silicone	HNBR	FKM
Min Temp (°C/°F)	-17/1	-35/-31	-55/-67	-23/-9	-7/20
Max Temp (°C/°F)	100/212	100/212	150/302	135/275	160/320
Material Hardness	60 - 65	60 - 70	65 - 70	60 - 70	60
Tear Resistance	Medium	Medium	Low	High	Medium
Abrasion Resistance	Medium	Medium	Low	High	Medium
Oil Resistance	Medium	Medium	Low	High	Superior

Additional load ring materials available.



Why choose Cat® seals?

- Designed for critical applications and superior performance.
- Industry's best corrosion protection.
- Custom designed sealing solutions for application requirements.
- Quality and reliability of seals ensured by ISO 9001:2008 accreditation.
- Global supply network.

Let's start a conversation.

Email us by scanning this QRcode.

