



CAT[®] ROTARY CUTTERS PARTS REFERENCE GUIDE

MODELS: RC10, RC15, RC20, RC30, RC50

LET'S DO THE WORK.™



PROTECT YOUR INVESTMENT WITH GENUINE CAT® PARTS

Thank you for selecting a Cat® Rotary Cutter.

This guide is designed to provide you with a quick reference for the parts and part numbers you need to keep your Cat Rotary Cutter operating at peak efficiency. Always read and understand the machine's Operation and Maintenance Manual (OMM) prior to performing any type of maintenance.

MAINTENANCE

Proactive preventative maintenance extends the life of your Rotary Cutter and protects your investment. Caterpillar knows Rotary Cutter requirements and recommended inspection / replacement intervals, to properly maintain your asset.

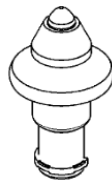
SCHEDULED REPAIR PARTS	
	PICKS and FILTERS
	RESEAL and COMPONENTS

REPLACEMENT PARTS

Proper maintenance minimizes the need for untimely repairs and the potential for costly major component replacement. In the event, that replacement parts are required for this product; Caterpillar recommends using original Caterpillar replacement components. Competitive aftermarket parts may not meet certain original equipment specifications.

WEAR COMPONENTS
PICKS and RETAINERS
TOOL HOLDERS and WEAR BARS
HYDRAULICS
CONNECTING LINES
FILTERS

TECHNICAL SPECIFICATIONS

Part Number	Sales Model	Weight		Interface	Carrier Weight	Drum Speed Operating Pressure	
		kg	lb		Metric tons	bar	psi
625-2979	RC10	675	1488	Pin On, CPG, CW,S	9-16	170-350	2466-5076
625-2980	RC15	1110	2447	Pin On, CPG, CW,S	14-22	170-400	2466-5802
625-2981	RC20	1340	2954	Pin On, CPG, CW,S	20-34	170-400	2466-5802
625-2982	RC30	2340	5159	Pin On, CPG, CW,S	28-50	190-400	2756-5802
625-2983	RC50	3000	6613	Pin On, CPG, CW,S	50-70	190-400	2756-5802

Part Number	Sales Model	Drum Speed	Drum Diameter		Fixed Picks	Height		Oil Flow	
		rpm	mm	in		mm	in	lpm	gpm
625-2979	RC10	72-110	500	20	56	1005	40	90-150	24-40
625-2980	RC15	83-100	595	23	44	1270	49.6	140-190	37-50
625-2981	RC20	60-90	660	26	44	1335	53	170-270	45-71
625-2982	RC30	80-90	750	30	48	1570	62	240-340	63-90
625-2983	RC50	70-80	750	30	56	1825	72	350-500	92-132



ANATOMY OF A CAT® ROTARY CUTTER

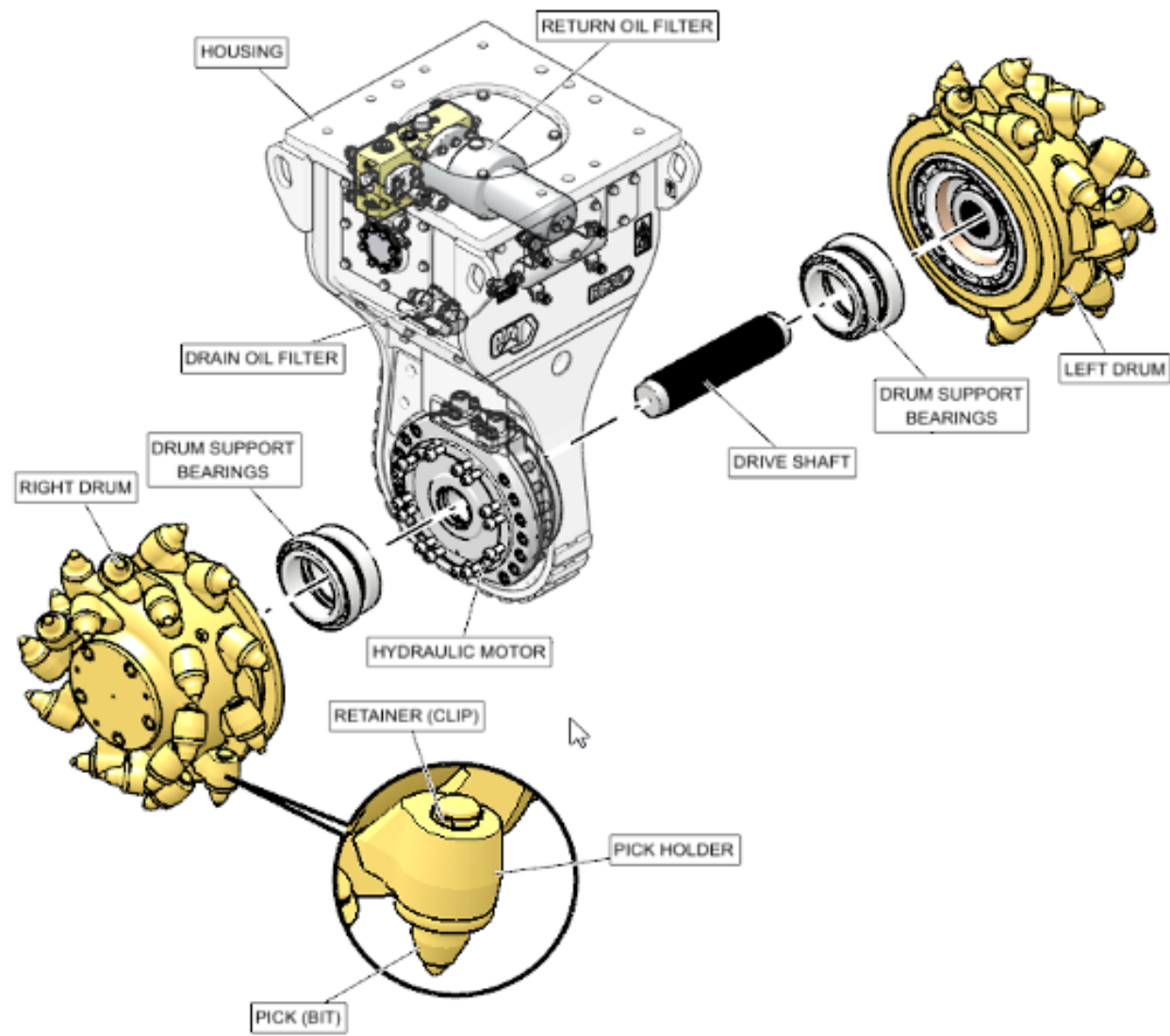

COMPONENT	FUNCTION
Left Drum	From excavator view left drum rotates in concert with right drum powered by hydraulic motor and direct drive shaft delivery high performance
Right Drum	From excavator view right drum rotates in concert with left drum powered by hydraulic motor and direct drive shaft delivery high performance
Housing	Narrow lower portion of Frame shape allows for reduction of the space between the drums thus increasing the working width. The lower portion of frame incorporates replaceable anti-wear plates
Drive Shaft	Delivers power to the drums without mechanical transmission components, guaranteeing high torque and high performance. Transmits motion only and bears no load
Hydraulic Motor	Direct drive, high torque motor delivers power direct to drums for highest performance
Drum Support Bearings	Two bearings support the left and right drum, while taking loads away from drive shaft
Return Oil Filter	Integrated and protects the hydraulic system from external impurities which can damage or reduce performance of both the excavator and rotary cutter
Drain Oil Filter	Integrated and protects the hydraulic system from external impurities which can damage or reduce performance of both the excavator and rotary cutter
Pick (Bit)	Inserted through the pick holder and secured by the retainer clip. The pick has carbide tip that cuts through material in demolition and excavation or rock, concrete and other materials
Retainer (Clip)	Secures and holds the pick in the holder for demolition of rock, concrete and other materials
Pick (Bit) Holder	Mounted on the left and right drum, the pick is inserted through the holder and secured with retaining clip for demolition of rock, concrete and other materials

MAINTENANCE INTERVAL SCHEDULE

ALL Rotary Cutter Models and Serial Number Prefixes		
Interval	Component	Inspect / Rotate / Replace
Every 100 Service Hours	Picks	Inspect and Replace if required
Every 200 Service Hours	Wear Plates	Inspect and Replace if required
Every 400 Service Hours	Filters	Replace Pressure and Drain filters
Every 2000 Service Hours	Seals, Bearings & Spring Kit	Replace all seals, bearings & Spring Kits

ESTIMATED WEAR LIFE

The chart below details the estimated life of your Rotary Cutter components under normal operating conditions. It is not meant to replace daily maintenance requirements and inspections outlined in your OMM. The hours noted are only an estimation and may need to be replaced prior to the listed hours.

Description	Estimated Life of Components (Hrs)	Recommended Actions
Picks	100	Replace
Filters	400	Replace
Seal Kits	2000	Replace
Bearing AS	2000	Replace
Spring Kit	2000	Replace

ROTARY CUTTER PARTS

Rotary Cutter	Serial Number Prefix	PICKS	RETAINER*	TOOL (Pick Removal)	FILTER (Inlet)	FILTER (Drain)	SEAL KIT	SEAL KIT	BEARING AS	BEARING AS	SPRING KT
RC10	DV4	638-9618	638-9619	646-5772	641-4060	631-8000	638-9620	638-9641	638-9766	638-9767	630-4903
RC15	DV5	630-8161	630-8163	636-8943	631-7999	631-8000	639-6909	639-9290	638-9766	639-7103	630-4903
RC20	DV6	630-8161	630-8163	636-8943	631-7999	631-8000	630-6020	630-0951	630-0055	630-0059	630-4903
RC30	DV7	632-6671	630-8163	636-8943	634-5351	631-8000	632-5114	632-6669	630-0055	632-4473	632-5122
RC50	DV8	644-0535	644-0536	636-8943	644-8838	644-8797	632-5114	632-6669	643-9364	632-4473	632-5122

*Heavy Duty Retainer 650-6124 available for use in place of 630-8163

DRUM AS & WEAR PARTS

Rotary Cutter	Serial Number Prefix	DRUM AS (RH)	PICK HOLDER	PICK HOLDER	DRUM AS (LH)	PICK HOLDER	PICK HOLDER	DRUM AS (RH)	WEAR PLATE	DRUM AS (LH)	WEAR PLATE
RC10	DV4	638-9610	638-9617	NA	638-9614	638-9617	NA	638-9610	639-6907	638-9614	639-6907
RC15	DV5	639-6902	638-9779	NA	639-6903	638-9779	NA	639-6902	639-6905	639-6903	639-6904
RC20	DV6	630-6008	638-9779	NA	630-6009	638-9779	NA	630-6008	639-5610	630-6009	639-5613
RC30	DV7	632-6665	638-9786	638-9787	632-6666	638-9786	638-9787	632-6665	640-1945	632-6666	640-1944
RC50	DV8	644-0509	644-0510	644-0511	644-0512	644-0510	644-0511	644-0509	640-1945	644-0512	640-1944



MATCHING GUIDE

Rotary Cutter Model	313	315	317	320	323	325	326	330	335	336	340	349	350	352	355
RC10															
RC15															
RC20															
RC30															
RC50															

Rotary Cutter Model	M314	M315	M316	M318	M320	M322	340 UHD	352 UHD
RC10								
RC15								
RC20								
RC30								
RC50								





LET'S DO THE WORK.™

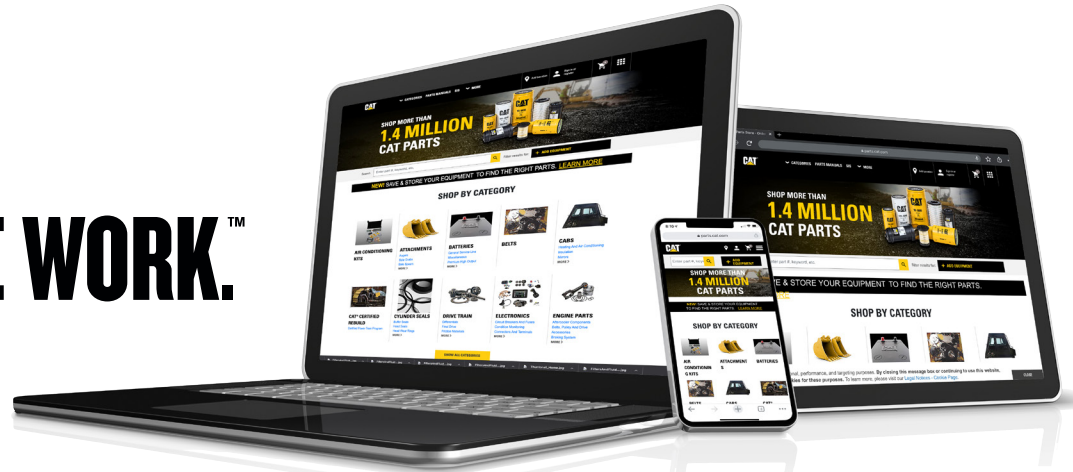

To buy Cat parts online, visit Parts.cat.com.

PEBJ0232
(Global)

© 2024 Caterpillar. All Rights Reserved. CAT, CATERPILLAR, LET'S DO THE WORK, their respective logos, "Caterpillar Corporate Corporate Yellow", the "Power Edge" and Cat "Modern Hex" trade dress as well as corporate and product identity used herein, are trademarks of Caterpillar and may not be used without permission.

