



F2 SERIES BACKHOE LOADER CENTER PIVOT MODELS PARTS REFERENCE GUIDE

LET'S DO THE WORK.™



» PROTECT YOUR INVESTMENT WITH GENUINE CAT® PARTS

Thank you for selecting the Cat® F2 Series Backhoe Loader.

This guide is designed to provide you with a quick reference for the parts and part numbers you need to keep your Cat backhoe loader operating at peak efficiency.

MAINTENANCE

Proactive preventative maintenance extends the life of your machine and protects your investment. Only Caterpillar knows Cat equipment's filtration and lubrication requirements and offers parts kits to match your machine's maintenance cycles.

SCHEDULED MAINTENANCE PARTS	
	GREASES
	PLANNED MAINTENANCE KITS

REPLACEMENT PARTS

Proper maintenance minimizes the need for repair and replacement. In the event that replacement parts are required, the use of genuine Cat parts helps maximize machine performance and maintains high resale value.

WEAR PARTS	SALES MODEL	SERIAL NUMBER PREFIX
GROUND ENGAGING TOOLS	416F2	LYA LBF
WEARPADS AND SHIMS		
REPAIR PARTS	420F2 / IT	LYB LBS LYC
BATTERY		
ENGINE PARTS		
MIRRORS, LIGHTS AND FUSES		
CAB GLASS	430F2 / IT	LYD LYE
ENHANCEMENT PARTS		
QUICK DISCONNECTS		
LINKAGE PIN AND BEARING PARTS		

GREASES F2 Series

Previous Cat® Product Name	STANDARD MAINTENANCE GREASES			GREASES FOR UNIQUE APPLICATIONS AND ENVIRONMENTS
	Cat Ultra5 Moly #1	Cat Ultra5 Moly #2	Cat Advanced 3 Moly	
Current Cat Product Name	Cat Extreme Application Grease 1	Cat Extreme Application Grease 2	Cat Prime Application Grease	Hammer Paste
Grade (NLGI)	1	2	2	2
Melting Point C° (F°)	>260 (>500)	>260 (>500)	260 (500)	230 (446)
Ambient Temperature C° (F°)	-35 to +40 (-31 to +104)	-30 to +50 (-22 to +122)	-20 to +40 (-4 to +104)	-20 to +1100 (-4 to +2012)
Base Oil Type	Mineral	Mineral	Mineral	Mineral
Color	Dark Gray	Dark Gray	Dark Gray	Bronze
Cartridge (390 g / 14 oz)	452-5996	452-6001	452-6006	130-6951 (standard) 317-8491 (autolube)
Plastic Pail (5 kg / 11 lb)	—	—	—	133-8807
Plastic Pail (16 kg / 35 lb)	452-5999	452-6004	452-6009	—
Keg (55 kg / 120 lb)	452-5998	452-6003	452-6008	—
Drum (180 kg / 400 lb)	452-5997	452-6002	452-6007	—



PLANNED MAINTENANCE KITS

Backhoe Loader		A										
		Engine Oil/Filter Change		Engine Air Filter		Fuel Filter Change			Cabin Air		Transmission Filter Change	
Sales Model	Serial Number Prefix	Filter Element	Oil Qty L (US Gal) DEO	Primary Element	Secondary Element	Primary Element (applicable serial number effectivity)		Secondary Element (applicable serial number effectivity)		Fresh Air Element	Recirculating Element	Filter Element
416F2	LYA LBF	7W-2326	8.8 (2.3)	346-6687	346-6688	502-3341 (LBF1-06950 and LYA1-00464) 1R-1804 (LBF06951-UP and LYA00465-UP)		Not Applicable (LYA1-00464) 441-5111 (LYA00465-UP) 156-1200 (LBF1-06950) 460-0310 (LBF06951-UP)		417-8134	211-2660	471-7003
420F2 / IT	LYB LBS LYC					502-3341 (LBS1-01648) 1R-1804 (LBS01649-UP)		Not Applicable (LYB1-00611 and LYC1-00723) 441-5111 (LYB00612-UP and LYC00724-UP) 156-1200 (LBS1-01648) 460-0310 (LBS01649-UP)				
430F2 / IT	LYD LYE					1R-1804		441-5111				

Backhoe Loader		B									C		D		E				
		Front Differential Oil Change		Front Final Drive Oil Change (each side)		Rear Differential Oil Change		Hydraulic Filter Change			Transmission Oil/Filter Change		Transmission	Belt (Serpentine)		Hydraulic Oil Change	Hydraulic Tank	Cooling System Coolant (ELC) Change	
Sales Model	Serial Number Prefix	Oil Qty L (US Gal) MTO	O-Ring	Oil Qty L (US Gal) MTO	O-Ring	Oil Qty L (US Gal) MTO	O-Ring	Filter Element	Seal (Housing)	Seal (Plug)	Oil Qty L (US Gal) TDTO	Seal	Breather	No A/C	With A/C	Oil Qty Hydo Advance L (US Gal)	Breather	No A/C Qty L (US Gal)	With A/C Qty L (US Gal)
416F2	LYA LBF	11 (2.9)	9R-3176 (QTY 2)	0.75 (0.2)	9R-3176	17.3 (4.5)	2M-9780 (QTY 2)	362-1163	526-0891	2M-9780	15 (3.9) manual	238-5080 manual	9G-5127 manual	390-0532	390-0536	40 (10.6)	9R-9925	20 (5.3)	22 (5.8)
420F2 / IT	LYB LBS LYC										15 (3.9) manual 19 (5) powershift	238-5080 manual 5P-6718 p owershift	9G-5127 manual 7T-3251 powershift						
430F2 / IT	LYD LYE																		

Machine Hours	Parts Maintenance Kits				
	Kit	Kit	Kit	Kit	Kit
500	A				
1000	A	B			
1500	A		C		
2000	A	B			
2500	A				
3000	A	B	C	D	
3500	A				
4000	A	B			
4500	A		C		
5000	A	B			
5500	A				
6000	A	B	C	D	

Machine Hours	Parts Maintenance Kits				
	Kit	Kit	Kit	Kit	Kit
6500	A				
7000	A	B			
7500	A		C		
8000	A	B			
8500	A				
9000	A	B	C	D	
9500	A				
10000	A	B			
10500	A		C		
11000	A	B			
11500	A				
12000	A	B	C	D	E

COMMON GROUND ENGAGING TOOLS F2 Series

Loader		
Description (Width)	Qty	Part Number
Edge Group - Bolt-On (2262mm)		9R-5321
Cutting Edge	2	9W-8215
Hex Head Nut	8	4K-0367
Washer Hard	8	8T-4122
Plow Bolt	8	3F-5108
Edge Group - Bolt-On (2406mm)		9R-5320
Cutting Edge	2	118-7110
Hex Head Nut	8	4K-0367
Washer Hard	8	8T-4122
Plow Bolt	8	3F-5108
Edge Group - Bolt-On (2434mm)		220-4758
Cutting Edge	2	220-4691
Hex Head Nut	8	4K-0367
Washer Hard	8	8T-4122
Plow Bolt	8	3F-5108
Edge Group - Bolt-On (2434mm)		9R-7948
Cutting Edge	2	9U-9665
Hex Head Nut	12	4K-0367
Plow Bolt	12	3F-5108
Cutting Edge MP (2262mm)	1	233-3757
Cutting Edge MP (2406mm)	1	233-0859
Cutting Edge MP (2434mm)	1	515-9970
Cutting Edge MP (2434mm)	1	517-1305
Tooth Gp-Uni		9R-5866
Unitooth Tip	8	135-8203
Hex Head Nut	16	4K-0367
Plow Bolt	16	4F-3657

Hoe	
Description	Part Number
Diagonal Retention System (DRS230)	
Retainer	201-1239
Pin - GET	500-0269
Diagonal Pin Adapter	
Adapter (25mm for Rock Buckets)	201-1234
Adapter (20mm)	201-1235
Adapter (25mm for Soil Buckets)	253-0234
Tip	
Penetration	208-5235
Chisel	208-5232
Soil Digging	208-5234
Long	208-5236
Twin Sharp	208-5237
Sharp	208-5239
Wide	208-5240
Cutting Edge	
Cutting Edge (1200mm)	311-6221
Cutting Edge (1500mm)	311-9239
Cutting Edge (1800mm)	556-3598



WEARPADS AND SHIMS F2 Series

Location	Part Number
Stabilizer (Rock Guard Option)	
Pad	188-3953
Extendable Stick	
Pad (Side)	233-5169
Shim (0.25mm)	293-9884
Shim (0.5mm)	233-5166
Shim (1mm)	293-9882
Shim (2mm)	233-5167
Pad (Head - Wedge)	289-9426
Pad (Nose - Wedge)	217-1577
Shim (1mm)	287-5667
Pad (Top)	226-9764

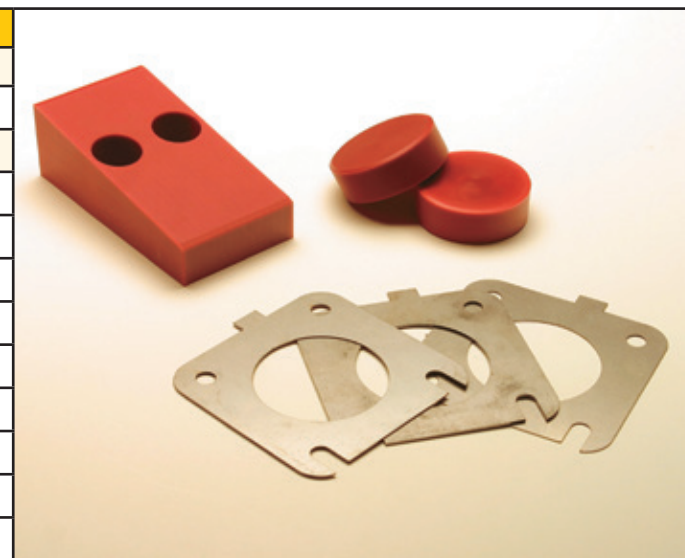

BATTERY F2 Series

Backhoe Loader		Battery	Part Number
Sales Model	Serial # Prefix	Standard	230-6368
416F2	LYA / LBF		
420F2 / IT	LYB/ LBS / LYC		
430F2 / IT	LYD / LYE		



ENGINE PARTS F2 Series

Backhoe Loader				Part Number / Reman											
Sales Model	Serial # Prefix	Engine Gross Power Rating*	Emissions	Engine	Long Block	Alter-nator	Fuel Injector		Fuel Injection Pump		Water Pump	Starting Motor		Turbocharger	
416F2	LBF	68.5 kW (92 hp)	U.S. EPA Tier 2/EU Stage II	556-7913	20R-4053	383-2557	236-1674	20R-0471	249-9226	10R-9721	354-1672	143-0539	OR-4316	354-1672	143-0539
	521-6420														
	LBF	70 kW (94 hp)	U.S. EPA Tier 3/ EU Stage IIIA	556-7899	-		315-3381		326-8993	20R-4832	355-2252	303-5795		355-2252	303-5795
	521-6422														
420F2	LBS	74.5 kW (100 hp)	Tier 2/ Stage II	556-7885	20R-4053	383-2557	236-1674	20R-0471	236-8228		354-1672	143-0539	OR-4316	354-1672	143-0539
	521-6421														
	LBS		Tier 3/ Stage IIIA	556-7905	-		315-3381		326-9147	20R-6819	355-2252	303-5795		355-2252	303-5795
	521-6423														
430F2/IT	LYD/LYE		Tier 2/ Stage II	521-6421	20R-4053		236-1674	20R-0471	236-8228		354-1672	143-0539	354-1672	143-0539	

*ISO 14396

MIRRORS, LIGHTS AND FUSES F2 Series

Mirrors			Part Number	Lights		Lamp Type	Part Number
Rearview	External		180-0448	Flood Lamp (Front and Rear) Long Range		Halogen Light	214-2969
Bracket	Right Hand		382-2497	Flood Lamp (Front and Rear) Wide Range		Halogen Bulb	9W-0607
Bracket	Left Hand		382-2498	Flood Lamp LED (Front and Rear) Wide Range		Halogen Light	214-2968
Rearview	Internal		472-9218			Halogen Bulb	9W-0607
Rear View	External Rear		220-4050				479-8445

Fuses		Part Number
3 Amp Mini		395-9584
10 Amp		9W-1442
10 Amp Mini		113-8490
15 Amp		9W-1441
15 Amp Mini		113-8491
20 Amp		9W-1446
25 Amp		1Q-1905
30 Amp		192-7727
40 Amp		232-6313
50 Amp		418-0363

Lamp Signal (Stop, Tail and Turn) (Rear)		Part Number
Lamp Assembly		336-9096
Halogen Bulb (Stop)		7S-1800
Halogen Bulb (Signal)		9W-3326
Lens		352-4645
Lamp Signal (Stop, Tail and Turn) LED (Rear)		387-6627
Lamp Signal (Turn) (Front)	Lamp Assembly	449-3759
Dome Lamp	Lamp Assembly	426-0976
Lamp 12V (Dome)	Lamp	210-8754
Beacon (Warning) Strobe Light	Roof Mounted	140-3668
Beacon (Rotating Warning)	Roof Mounted	309-1325
	Halogen Bulb	9X-8118

CAB GLASS F2 Series

Position	Sales Model	Serial Number Prefix	Part Number
Windscreen (Top)	All	All	382-2342
Windscreen (Bottom Right)			382-2344
Windscreen (Bottom Left)			382-2343
Left Door (Top)			382-2261
Left Door (Bottom)			382-2263
Right Door (Top)			382-2274
Right Door (Bottom)			382-2269
Left Rear (Top)			382-2249
Left Rear (Bottom)			382-2310
Right Rear (Top)			382-2250
Right Rear (Bottom)			382-2311
Rear Glass (Top Section)			416F2
	420F2	LYB1-00636 LYC1-00762 LBS1-01543	
	430F2	LYD1-00246 LYE1-00245	
Rear Glass (Top Section)	416F2	LYA00478-UP LBF06581-UP	564-7654
	420F2	LYB00637-UP LYC00763-UP LBS01544-UP	
	430F2	LYD00247-UP LYE00246-UP	
Rear Glass (Bottom Section)	ALL	ALL	441-4184

QUICK DISCONNECTS

Get the most out of your Cat F2 Series Backhoe Loader with a wide range of hydraulic work tool attachments that can be easily interchanged with Quick Disconnects. Contact your Cat dealer for a complete list of all available attachments.

Function	Twist to connect - Connect under pressure			
	Male	Cap	Female	Cap
Loader	439-1589	471-1018	439-1588	471-1017
Hoe	439-1591		439-1590	



LINKAGE PIN AND BEARING PART NUMBERS F2 Series

See part numbers on following pages

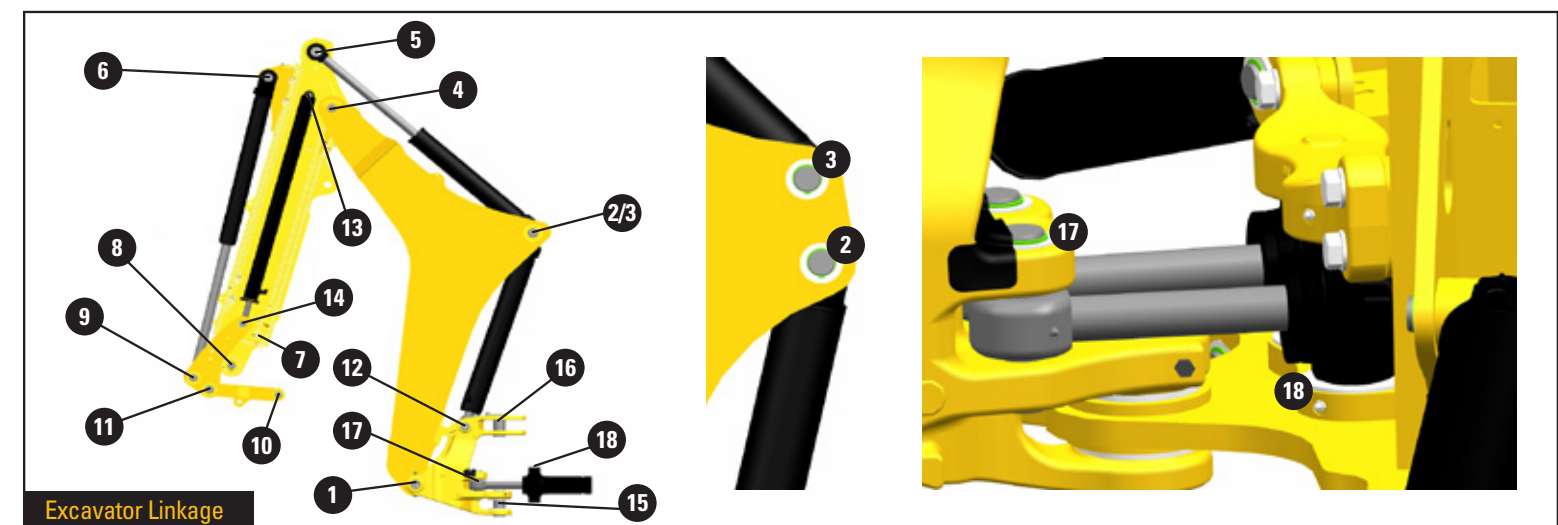
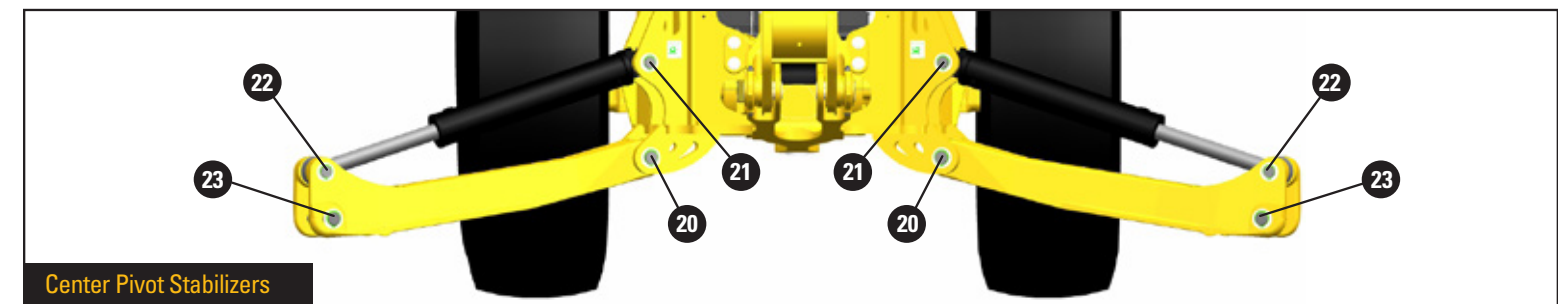
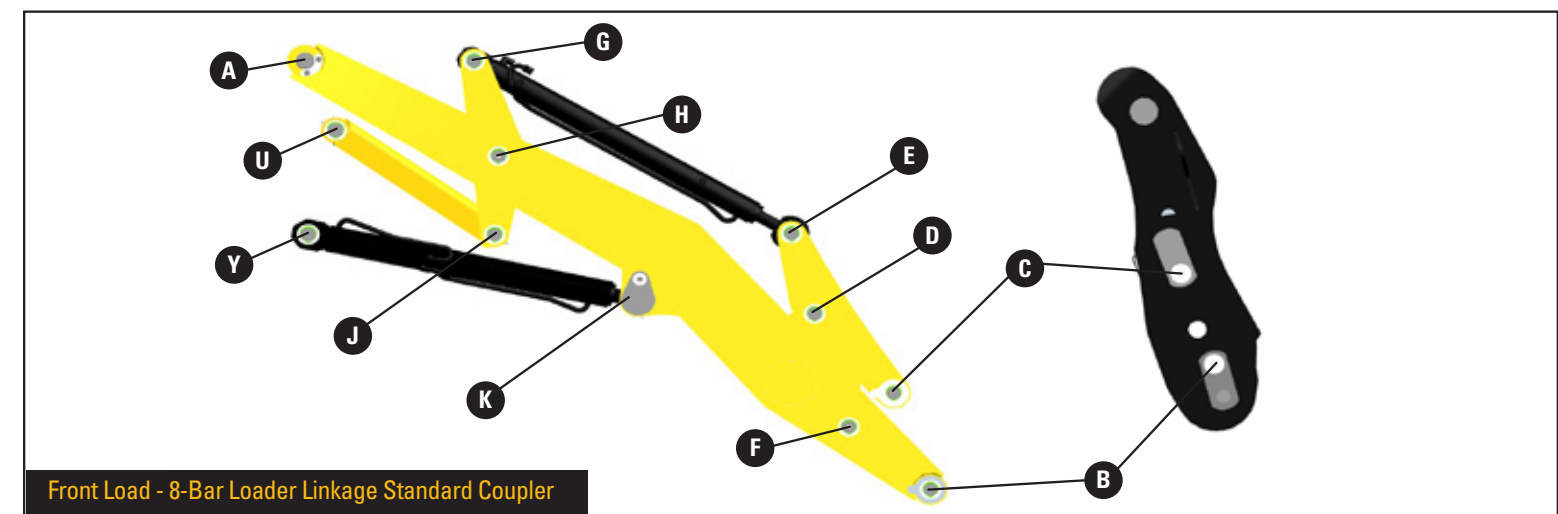
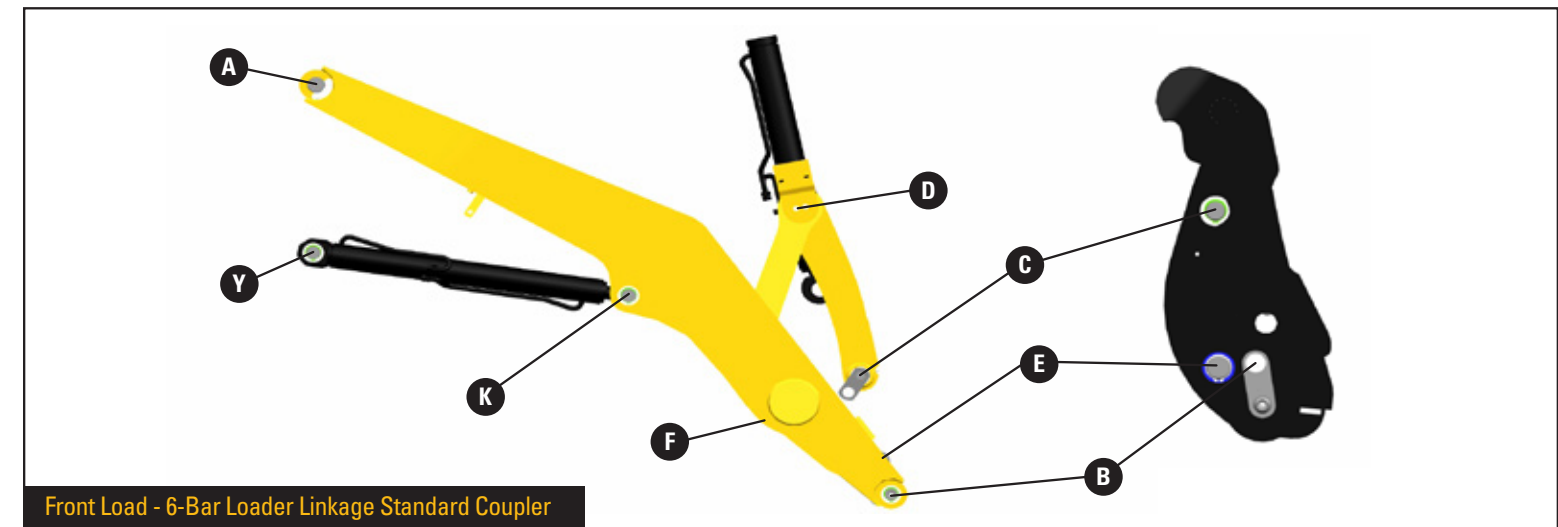

FRONT LOAD – 6-BAR LOADER LINKAGE STANDARD COUPLER F2 Series

Linkage Pins									
Sales Model	Serial Number Prefix	A	B Arm	C Arm	D	E Arm	F	K	Y
416F2	LBF, LYA	341-6152 Pin	360-2821 Pin (QTY 2)	360-2823 Pin Assembly	361-0415 Trunnion	364-3011 Pin Assembly	360-2822 Pin	362-3269 Pin (Right) 362-3270 Pin (Left)	360-2816 Pin (QTY 2)
420F2	LBS, LYB								
430F2	LYD								
Bearings									
Sales Model	Serial Number Prefix	A	B Arm	C Arm	D	E Arm	K	Y	
416F2	LBF, LYA	278-7066 Bearing (QTY 4)	9R-0411 Bushing (QTY 4)	9R-5828 Bushing (QTY 2)	531-3531 Bearing (QTY 2) 361-4673 Bearing (QTY 2) 362-5025 Bushing (QTY 2)	362-5027 Bushing (QTY 2)	362-5024 Bushing (QTY 2)	362-5024 Bushing (QTY 2)	
420F2	LBS, LYB								
430F2	LYD								
Seals and Grease Fittings									
Sales Model	Serial Number Prefix	B Arm							
416F2	LBF	3B-8489 Grease Fitting (QTY 2)							
420F2	LBS								
Retention Hardware									
Sales Model	Serial Number Prefix	A	B Arm	C Arm	D	E Arm	F	K	Y
416F2	LBF, LYA	372-5024 Plate (QTY 2) 8T-4139 Bolt (QTY 4) 8T-4223 Washer (QTY 4) 128-7903 Spacer (QTY 2) 128-7905 Spacer (QTY 2)	111-4337 Washer (QTY 6) 6V-3213 Retaining Ring (QTY 4) 9R-0158 Washer (QTY 4) 363-2856 Shim (QTY 2) 363-2855 Shim (QTY 3)	111-4337 Washer (QTY 2) 7X-0618 Washer 9R-0158 Washer (QTY 4) 361-7826 Tube 8T-4956 Bolt	358-1472 Spacer (QTY 2) 101-0117 Plate 362-1201 Plate 8T-4121 Washer (QTY 4) 8T-4137 Bolt (QTY 4)	7X-0618 Washer 9R-1502 Washer 8T-4956 Bolt	111-4337 Washer (QTY 5) 6V-3213 Retaining Ring (QTY 2) 9R-0158 Washer (QTY 2)	373-8390 Shim (QTY 6) 7X-0542 Washer (QTY 7) 6V-4364 Retaining Ring (QTY 4)	6V-7744 Lock Nut (QTY 2) 105-3479 Bolt (QTY 2) 373-8390 Shim (QTY 4) 6V-4364 Retaining Ring (QTY 2) 7X-0542 Washer (QTY 6)
420F2	LBS, LYB								
430F2	LYD								

FRONT LOAD – 8-BAR LOADER LINKAGE STANDARD COUPLER F2 Series

Linkage Pins															
Sales Model	Serial Number Prefix	A	B Arm	B Coupling	C Arm	C Coupling	D	E	F	G	H	J	K	U	Y
420F2	LYC	341-6152 Pin	438-0593 Pin (QTY 2)	360-2812 Pin (QTY 2)	438-0593 Pin (QTY 2)	360-2812 Pin (QTY 2)	360-2813 Pin (QTY 2)	360-2815 Pin (QTY 2)	360-2814 Pin (QTY 2)	360-2813 Pin (QTY 2)	360-2814 Pin (QTY 2)	360-2813 Pin (QTY 2)	372-5085 Pin Assembly (QTY 2)	360-2816 Pin (QTY 2)	360-2816 Pin (QTY 2)
430F2	LYE														
Bearings															
Sales Model	Serial Number Prefix	A	B Arm	C Arm	D	E	F	G	H	J	K	U	Y		
420F2	LYC	278-7066 Bearing (QTY 4)	9R-0411 Bushing (QTY 4)	9R-0153 Bushing (QTY 4)	9R-0153 Bushing (QTY 4)	9R-0153 Bushing (QTY 4)	9R-0411 Bushing (QTY 4)	9R-0153 Bushing (QTY 4)	9R-0411 Bushing (QTY 4)	9R-0153 Bushing (QTY 4)	362-5024 Bushing (QTY 4)	9R-3700 Bushing (QTY 4)	362-5024 Bushing (QTY 4)		
430F2	LYE														
Seals and Grease Fittings															
Sales Model	Serial Number Prefix	F	H												
420F2	LYC	3B-8489 Grease Fitting (QTY 2)	3B-8489 Grease Fitting (QTY 2)												
430F2	LYE														
Retention Hardware															
Sales Model	Serial Number Prefix	A	B Arm	B Coupling	C Arm	C Coupling	D	E	F	G	H	J	K	U	Y
420F2	LYC	128-7903 Spacer (QTY 2)	363-2855 Shim (QTY 4)	363-2855 Shim (QTY 3)	363-2855 Shim (QTY 4)	363-2855 Shim (QTY 4)	111-4337 Washer (QTY 6)	111-4337 Washer (QTY 6)	111-4337 Washer (QTY 6)	111-4337 Washer (QTY 10)	111-4337 Washer (QTY 6)	111-4337 Washer (QTY 6)	7X-0590 Washer (QTY 2)	373-8390 Shim (QTY 4)	373-8390 Shim (QTY 4)
		128-7905 Spacer (QTY 3)	363-2856 Shim (QTY 2)	363-2856 Shim (QTY 4)	363-2856 Shim (QTY 4)	363-2856 Shim (QTY 4)									
430F2	LYE	372-5024 Plate (QTY 2)	111-4335 Spacer (QTY 2)	7X-0550 Washer (QTY 4)	111-4335 Spacer (QTY 2)	7X-0550 Washer (QTY 4)	6V-3213 Retaining Ring (QTY 4)	6V-3213 Retaining Ring (QTY 4)	6V-3213 Retaining Ring (QTY 4)	9R-0158 Washer (QTY 4)	9R-0158 Washer (QTY 4)	9R-0158 Washer (QTY 4)	8T-4139 Bolt (QTY 2)	6V-7744 Lock Nut (QTY 2)	6V-7744 Lock Nut (QTY 2)
		8T-4139 Bolt (QTY 4)	111-4337 Washer (QTY 4)	7X-0590 Washer (QTY 2)	111-4337 Washer (QTY 4)	7X-0590 Washer (QTY 2)	9R-0158 Washer (QTY 4)	9R-0158 Washer (QTY 5)	9R-0158 Washer (QTY 4)	360-2820 Spacer (QTY 4)	9R-0158 Washer (QTY 4)	9R-0158 Washer (QTY 4)	8T-4139 Bolt (QTY 2)	7X-0542 Washer (QTY 4)	7X-0542 Washer (QTY 6)
		8T-4223 Washer (QTY 4)	9R-0158 Washer (QTY 8)	8T-4956 Bolt (QTY 2)	9R-0158 Washer (QTY 8)	8T-4956 Bolt (QTY 2)								105-3479 Bolt (QTY 2)	105-3479 Bolt (QTY 2)

CENTER PIVOT STABILIZERS F2 Series

Linkage Pins					
Sales Model	Serial Number Prefix	20	21	22	23
416F2	LBF, LYA	374-7900 Pin (QTY 2)	376-7520 Pin (QTY 2)	380-9478 Pin (QTY 2)	238-9546 Shaft (QTY 2)
420F2	LBS, LYC, LYB				
430F2	LYD				

Bearings					
Sales Model	Serial Number Prefix	20	21	22	23
416F2	LBF, LYA	9R-0411 Bushing (QTY 4)	9R-0321 Bushing (QTY 4)	9R-0321 Bushing (QTY 4)	
420F2	LBS, LYC, LYB				
430F2	LYD				

Retention Hardware					
Sales Model	Serial Number Prefix	20	21	22	23
416F2	LBF, LYA	111-4337 Washer (QTY 2) 6V-3213 Retaining Ring (QTY 4) 9R-0158 Washer (QTY 12)	119-4594 Washer (QTY 2) 6V-8144 Retaining Ring (QTY 4) 9R-0109 Washer (QTY 8)	6V-8144 Retaining Ring (QTY 4) 9R-0109 Washer (QTY 8)	6V-3213 Retaining Ring (QTY 4) 9R-0158 Washer (QTY 14)
420F2	LBS, LYC, LYB				
430F2	LYD				

EXCAVATOR LINKAGE F2 Series

Linkage Pins																												
Sales Model	Serial Number Prefix	Stick Type Standard Stick: Areas 4,5,6,7 Extendable Stick: Areas 4,5,6,7,13 and 14	Linkage Type (Areas 7,8,9,10 and 11)	1	2	4	5	6	7	8	9	10	11	12	13	14	15	16	17	18								
416F2	LBF, LYA	Standard	Fabricated	237-5330 Pin (QTY 2)	445-5660 Pin	473-0239 Pin Assembly	213-6714 Pin	213-6696 Pin	213-6697 Pin	154-5280 Pin	154-5278 Pin	154-5279 Pin	213-6698 Pin	209-6850 Pin Assembly	-	-	341-9483 Pin	341-9484 Pin Assembly	341-9488 Pin (QTY 2)	381-8085 Cylinder Assembly 381-8086 Cylinder Assembly								
		Extendable						220-1019 Pin	220-1018 Pin						214-6143 Pin	220-1018 Pin												
420F2	LBS, LYC, LYB	Standard						213-6696 Pin	213-6697 Pin						213-6695 Pin	213-6696 Pin					213-6697 Pin	220-1019 Pin	220-1018 Pin	-	-	214-6143 Pin	220-1018 Pin	
		Extendable						214-6143 Pin	220-1018 Pin																			
430F2	LYD, LYE	Standard						130-2533 Pin (QTY 2)	213-6717 Pin						213-6728 Pin Assembly	213-6718 Pin					213-6696 Pin	213-6697 Pin	220-1019 Pin	220-1018 Pin	-	-	214-6143 Pin	220-1018 Pin
		Extendable 16 feet																			214-6143 Pin	220-1018 Pin						

Bearings																														
Sales Model	Serial Number Prefix	Stick Type Standard Stick: Areas 4,5,6,7 Extendable Stick: Areas 4,5,6,7,13 and 14	Linkage Type (Areas 7,8,9,10 and 11)	1	2	3	4	5	6	7	8	9	10	11	12	15	16	17	18											
416F2	LBF, LYA	Standard	Fabricated	209-6181 Bushing (QTY 2) 237-0944 Bushing (QTY 2) 278-5454 Bushing (QTY 2)	214-3855 Bearing (QTY 2)	214-2255 Bushing (QTY 2)	9R-0170 Bushing (QTY 2)	9R-3092 Bushing (QTY 2)	9R-0139 Bushing (QTY 2)	9R-0162 Bushing (QTY 2) 213-6687 Bushing (QTY 2)	9R-0162 Bushing (QTY 2)	9R-0162 Bushing (QTY 4)	213-6703 Bearing (QTY 2)	9R-0170 Bushing (QTY 4)	326-3362 Bushing	220-1013 Bushing	220-1013 Bushing	213-6702 Bushing (QTY 4) 274-4274 Bushing (QTY 2)	9T-2883 Bushing (QTY 4) 363-0528 Bearing (QTY 4)											
		Extendable								286-7166 Bushing (QTY 2) 213-6687 Bushing (QTY 2)																				
420F2	LBS, LYC, LYB	Standard								212-8960 Bearing (QTY 2)										215-1906 Bushing (QTY 2)	213-6683 Bushing (QTY 2)	213-6682 Bushing (QTY 2)	9R-0162 Bushing (QTY 2) 213-6687 Bushing (QTY 2)	(QTY 2) 286-7166 Bushing (QTY 2) 213-6687 Bushing	9R-0162 Bushing (QTY 2)	9R-0162 Bushing (QTY 4)	213-6703 Bearing (QTY 2)	9R-0170 Bushing (QTY 4)	250-1561 Bushing (QTY 2)	
		Extendable								213-6687 Bushing (QTY 2) 286-7166 Bushing (QTY 2)																				
430F2	LYD, LYE	Standard								217-1460 Bushing (QTY 2) 236-8158 Bushing (QTY 2) 278-5455 Bushing (QTY 2)										220-1013 Bearing (QTY 2) 250-1563 Bearing (QTY 2)	217-6046 Bushing (QTY 2)	213-6715 Bushing (QTY 2)	213-6719 Bushing (QTY 2)	9R-0162 Bushing (QTY 2) 213-6687 Bushing (QTY 2)	213-6687 Bushing (QTY 2) 286-7166 Bushing (QTY 2)	9R-0162 Bushing (QTY 2)	9R-0162 Bushing (QTY 4)	213-6703 Bearing (QTY 2)	9R-0170 Bushing (QTY 4)	250-1561 Bushing (QTY 2)
		Extendable 16 feet																												

EXCAVATOR LINKAGE F2 Series

Seals and Grease Fittings							
Sales Model	Serial Number Prefix	1	2	3	7	15	16
416F2	LBF, LYA	3B-8489 Grease Fitting (QTY 2)	6V-9746 Seal-O-Ring	6V-8398 Seal-O-Ring	(QTY 2) 3B-8489 Grease Fitting	3B-8489 Grease Fitting	3B-8489 Grease Fitting
420F2	LBS, LYC, LYB						
430F2	LYD						

Retention Hardware

Sales Model	Serial Number Prefix	Stick Type Standard Stick: Areas 4,5,6,7 Extendable Stick: Areas 4,5,6,7,13 and 14	Linkage Type (Areas 7,8,9, 10 and 11)	1	2	4	5	6	7	8	9	10	11	12	13	15	16	17	18									
416F2	LBF, LYA	Standard	Fabricated	6V-7687 Lock Nut (QTY 2) 8T-7930 Bolt (QTY 2)	176-0626 Washer (QTY 4) 375-1442 Retaining Ring (QTY 2)	286-3086 Spacer (QTY 3) 473-0240 Plate (QTY 2) 8T-4192 Bolt 8T-4895 Washer	6V-4364 Retaining Ring (QTY 2) 9R-1510 Washer (QTY 4)	6V-8344 Retaining Ring (QTY 2) 9R-1502 Washer (QTY 6)	6V-4364 Retaining Ring (QTY 2) 9R-1510 Washer (QTY 4) 220-7108 Washer (QTY 2)	9R-1510 Washer (QTY 5) 3B-5319 Cotter Pin (QTY 2) 220-7108 Washer (QTY 2)	6V-4364 Retaining Ring (QTY 2) 9R-1510 Washer (QTY 6)	9R-0158 Washer (QTY 7) 3B-5319 Cotter Pin (QTY 2) 111-4337 Washer (QTY 4)	6V-8344 Retaining Ring (QTY 2) 9R-1502 Washer (QTY 6) 210-1707 Shim (QTY 2)	8T-4139 Bolt 8T-4821 Washer 9R-7882 Spacer	-	6V-7687 Lock Nut 8T-7930 Bolt 280-7732 Washer (QTY 2)	136-1122 Spacer 8T-4139 Bolt 8T-4821 Washer	9R-0481 Washer (QTY 2)	-									
		Extendable						6V-8344 Retaining Ring (QTY 2) 9R-5238 Spacer (QTY 6)	6V-4364 Retaining Ring (QTY 2) 9R-1510 Washer (QTY 3) 220-7108 Washer (QTY 2)						1L-3768 Retaining Ring (QTY 2) 111-9251 Washer (QTY 2) 233-5169 Pad (QTY 4) 233-5166 Shim (QTY 16) 233-5167 Shim (QTY 4) 293-9882 Shim (QTY 8) 293-9884 Shim (QTY 8)				6V-4364 Retaining Ring (QTY 4) 7X-0542 Washer (QTY 2) 465-3495 Guard									
420F2	LBS, LYB, LYC	Standard			9R-0481 Washer (QTY 4) 095-7950 Retaining Ring (QTY 2)	9R-8292 Spacer (QTY 3) 473-0240 Plate (QTY 2) 8T-4192 Bolt 8T-4895 Washer	375-1442 Retaining Ring (QTY 2) 215-9690 Washer (QTY 4)	6V-8344 Retaining Ring (QTY 2) 9R-1502 Washer (QTY 4)	6V-4364 Retaining Ring (QTY 2) 9R-1510 Washer (QTY 4) 220-7108 Washer (QTY 2)						6V-8344 Retaining Ring (QTY 2) 9R-1502 Washer (QTY 4)				6V-4364 Retaining Ring (QTY 2) 9R-1510 Washer (QTY 4) 220-7108 Washer (QTY 2)	6V-8344 Retaining Ring (QTY 2) 9R-1510 Washer (QTY 6)	9R-1510 Washer (QTY 6)	6V-8344 Retaining Ring (QTY 2) 9R-1502 Washer (QTY 6) 210-1707 Shim (QTY 2)	8T-4139 Bolt 8T-4821 Washer 9R-7882 Spacer	-	6V-7687 Lock Nut 8T-7930 Bolt 280-7732 Washer (QTY 2)	136-1122 Spacer 8T-4139 Bolt 8T-4821 Washer	9R-0481 Washer (QTY 2)	-
		Extendable					375-1442 Retaining Ring (QTY 2) 215-9690 Washer (QTY 5)	6V-8344 Retaining Ring (QTY 2) 9R-5238 Spacer (QTY 6)	6V-4364 Retaining Ring (QTY 2) 9R-1510 Washer (QTY 3) 220-7108 Washer (QTY 2)															1L-3768 Retaining Ring (QTY 2) 111-9251 Washer (QTY 2) 233-5169 Pad (QTY 4) 233-5166 Shim (QTY 16) 233-5167 Shim (QTY 4) 293-9882 Shim (QTY 8) 293-9884 Shim (QTY 8)				6V-4364 Retaining Ring (QTY 4) 7X-0542 Washer (QTY 2) 465-3496 Guard
430F2	LYD, LYE	Standard			254-7211 Plate (QTY 4) 8C-3114 Retaining Ring (QTY 2)	286-3088 Spacer (QTY 3)	095-7950 Retaining Ring (QTY 2) 9R-0481 Washer (QTY 4)	6V-8344 Retaining Ring (QTY 2) 9R-1502 Washer (QTY 4)	6V-4364 Retaining Ring (QTY 2) 9R-1510 Washer (QTY 4) 220-7108 Washer (QTY 2)						6V-8344 Retaining Ring (QTY 2) 9R-1502 Washer (QTY 4)				6V-4364 Retaining Ring (QTY 2) 9R-1510 Washer (QTY 4) 220-7108 Washer (QTY 2)	6V-8344 Retaining Ring (QTY 2) 9R-1510 Washer (QTY 6)	9R-1510 Washer (QTY 6)	6V-8344 Retaining Ring (QTY 2) 9R-1502 Washer (QTY 6) 210-1707 Shim (QTY 2)	8T-4139 Bolt 8T-4821 Washer 9R-7882 Spacer	-	6V-7687 Lock Nut 8T-7930 Bolt 280-7732 Washer (QTY 2)	136-1122 Spacer 8T-4139 Bolt 8T-4821 Washer	9R-0481 Washer (QTY 2)	-
		Extendable						6V-8344 Retaining Ring (QTY 2) 9R-5238 Spacer (QTY 6)	6V-4364 Retaining Ring (QTY 2) 9R-1510 Washer (QTY 3) 220-7108 Washer (QTY 2)															1L-3768 Retaining Ring (QTY 2) 111-9251 Washer (QTY 2) 233-5169 Pad (QTY 4) 233-5166 Shim (QTY 16) 233-5167 Shim (QTY 4) 293-9882 Shim (QTY 8) 293-9884 Shim (QTY 8)				6V-4364 Retaining Ring (QTY 4) 7X-0542 Washer (QTY 2) 465-3496 Guard

LET'S DO THE WORK.™

AEXQ1581-02
May 2021
(Am South, AME, APD)

© 2021 Caterpillar. All Rights Reserved. CAT, CATERPILLAR, LET'S DO THE WORK, their respective logos, "Caterpillar Corporate Yellow," the "Power Edge" and Cat "Modern Hex" trade dress, as well as corporate and product identity used herein, are trademarks of Caterpillar and may not be used without permission.

