

Introduction

This document provides instructions for installing an accessory on a Cat® Utility Vehicle (CUV). Do not perform any procedure in this document until you have read and understood the information contained in this document and the Operation and Maintenance Manual.

Safety Section

<p>⚠ WARNING</p> <p>Do not operate or work on this product unless you have read and understood the instruction and warnings in the relevant Operation and Maintenance Manuals and relevant service literature. Failure to follow the instructions or heed the warnings could result in injury or death. Proper care is your responsibility.</p>	<p>⚠ WARNING</p> <p>Personal injury can result from improper handling of chemicals. Make sure you use all the necessary protective equipment required to do the job. Make sure that you read and understand all directions and hazards described on the labels and material safety data sheet of any chemical that is used. Observe all safety precautions recommended by the chemical manufacturer for handling, storage, and disposal of chemicals.</p>
<p>⚠ WARNING</p> <p>Failure to follow all safety guidelines prescribed in this document and by governing authorities and regulatory agencies may result in severe injury or death of personnel or machine damage.</p>	<p>⚠ WARNING</p> <p>Before servicing/performing maintenance on the machine, electrical power must be physically disconnected; battery cables must be disconnected from the battery. All applicable lock out and tag out procedures must be followed.</p>
<p>⚠ WARNING</p> <p>When removing a major component or attachment, ensure that it is properly blocked or secured before removing mounting hardware. An assembly that is disconnected without proper blocking may shift or fall, resulting in serious injury or death of personnel or machine damage.</p>	<p>⚠ WARNING</p> <p>Observe the safe working load limits of all lifting and blocking devices and keep a safe distance from suspended/blocked loads. Personnel may be seriously injured or killed by falling loads.</p>
<p>⚠ WARNING</p> <p>Personal injury or death can result from improper maintenance procedures. To avoid injury or death, follow the procedures exactly as stated below.</p>	<p>⚠ WARNING</p> <p>Do not operate the machine if any guards or covers are missing or inadequately secured. Personnel could be seriously injured or machine damage may occur.</p>

Caterpillar®

Installation Instructions - Accessory Kit

Center Passenger Seat Kit

(p/n 590-3234)



■ **NOTE:** Read these Installation Instructions thoroughly before beginning the installation process. Retain these Installation Instructions for future reference.

Kit includes:

QTY	DESCRIPTION
2	Nylon Flange Nut (M12)
2	Seat Grommet
1	Cap Screw (M12 x 30 mm)
5	Machine Screw (M6 x 16 mm)
2	Machine Screw (M8 x 20 mm)
1	Seat Belt Bracket
1	Seat Belt Assembly
1	Seat Base Assembly
1	Backrest Assembly

CUV82 and CUV102D Installation

1. Remove the screws securing the center console between the two seat bottoms. Remove the console. See Fig. 1.

Fig. 1

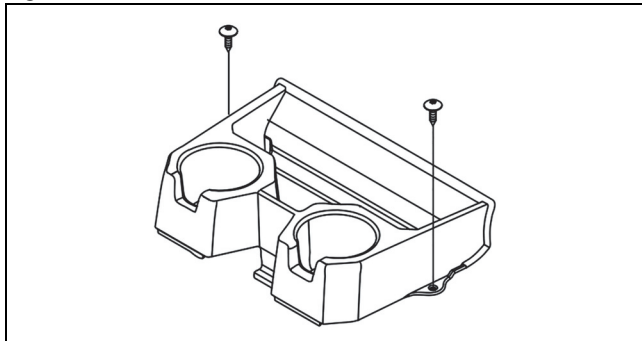

VOR-714

2. Unlatch the passenger seat backrest; then fold down.
3. Remove the cap screws and nuts securing the upper center console to the seat backrest frame; then remove the upper center console. See Fig. 2.

Fig. 2

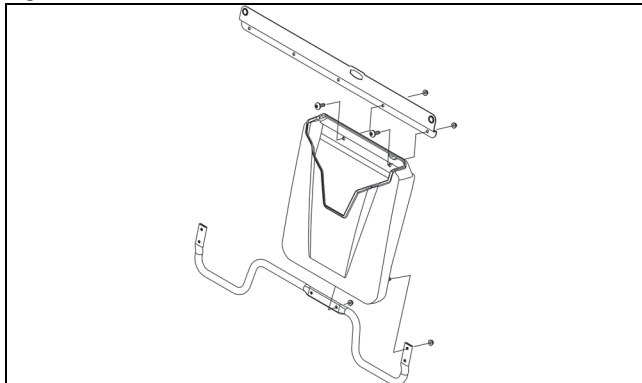

VOR-710

4. Secure Seat Belt Bracket to the frame using two Machine Screws (M8 x 20 mm). Tighten to 16 ft-lb. See Fig. 3.
5. Secure the seat belt retractor portion of Seat Belt Assembly to the bracket using the supplied nut. Tighten to 60 ft-lb. See Fig. 3.

Fig. 3

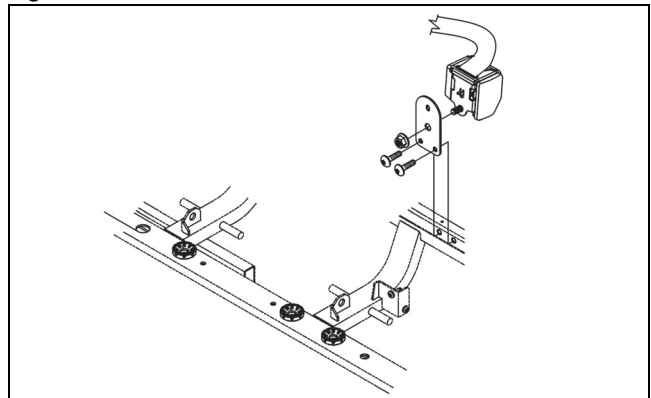

VOR-715

6. Secure the upper portion of Seat Belt Assembly to the rear ROPS assembly using the supplied cap screw and nut. Tighten to 60 ft-lb. See Fig. 4.

Fig. 4

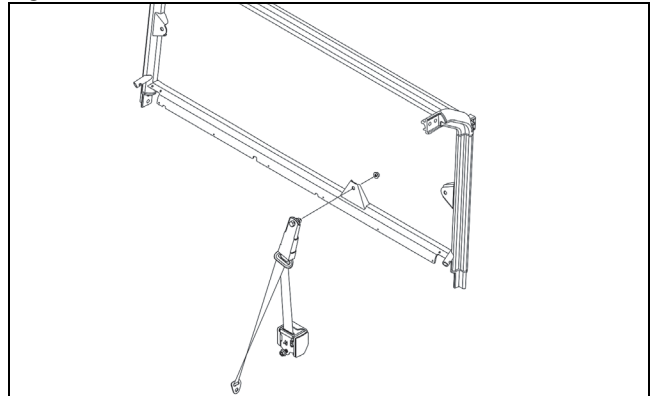

VOR-712

7. Remove the cap screws and nuts securing the seat belt buckles to the frame; then secure the new buckle and the existing passenger side buckle to the frame using new Cap Screw (M12 x 30 mm) and new M12 Nylon Flange Nut. Tighten to 60 ft-lb. See Fig. 5.
8. Secure the anchor portion of the center seat belt and the operator side buckle to the frame using the existing cap screw and new M12 Nylon Flange Nut. Tighten to 60 ft-lb. See Fig. 5.
9. Install Seat Grommets into the frame. See Fig. 5.

Fig. 5

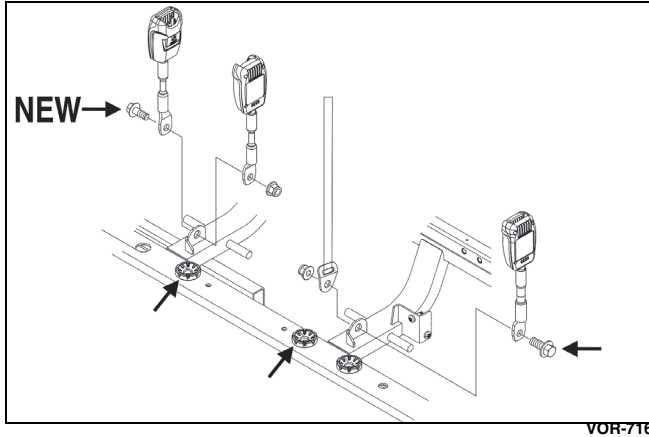

VOR-716

10. Secure Seat Backrest to the seat backrest frame using five Machine Screws (M6 x 16 mm). Tighten securely. Install the passenger seats as an assembly and secure and latch the frame. See Fig. 6.

Fig. 6

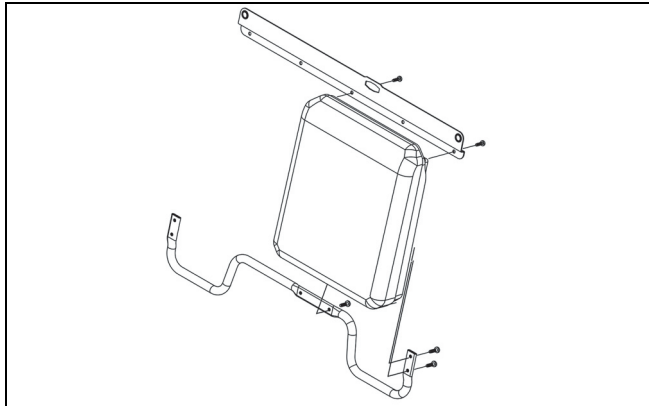

VOR-711

11. Install the seat bottom by hooking both of the "C" channels of the seat bottom into the mounting pegs and pressing down into the grommets.

■ **NOTE:** On CUV85 and CUV105 models, install the front rear seat close off and side panels.

CUV85 and CUV105D Installation

1. Remove the screws securing the center console between the two seat bottoms. Remove the console. See Fig. 7.

Fig. 7

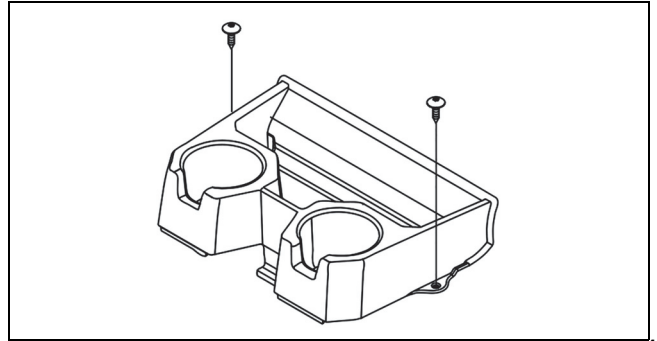

VOR-714

2. Unlatch the front passenger seat backrest; then fold down.
3. Remove both front side panels.
4. Remove the six cap screws that secure the rear panel to the center ROPS. See Fig. 8.

Fig. 8

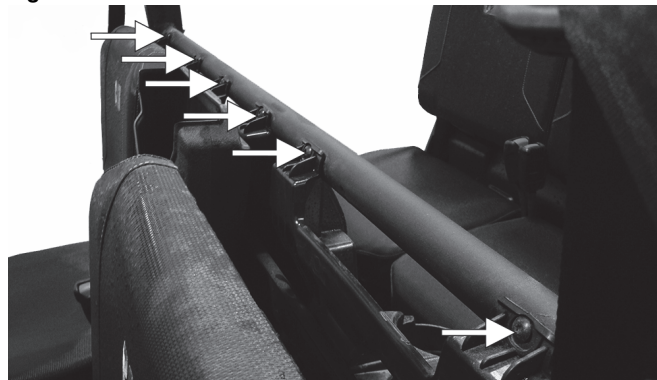

MOD635A

5. Remove the five cap screws at the bottom of the behind seat close-off panel. See Fig. 9.

Fig. 9

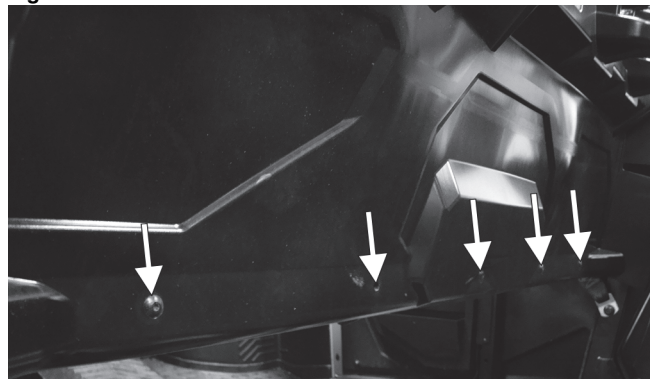

MOD669

6. Remove the five cap screws near the cup holders; then remove the behind seat close-off panel. See Fig. 10.

Fig. 10

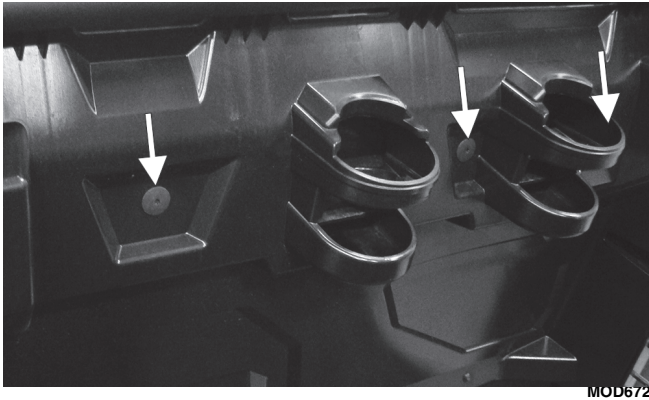

7. Secure the seat belt retractor portion of Seat Belt Assembly to the frame bracket using the supplied nut. Tighten to 60 ft-lb. See Fig. 11.

Fig. 11

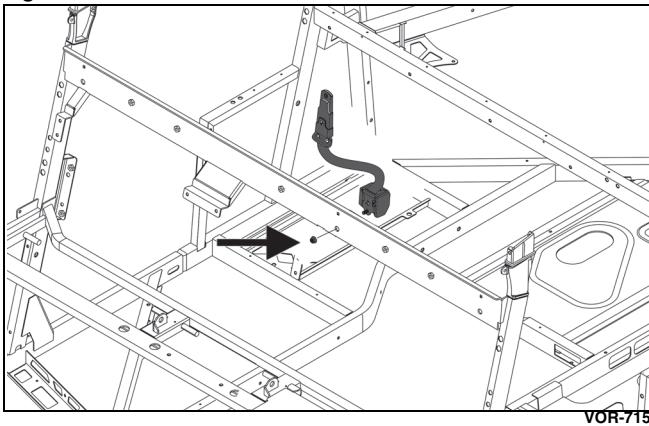

8. Secure the upper portion of Seat Belt Assembly to the middle ROPS assembly using the supplied cap screw and nut. Tighten to 60 ft-lb. See Fig. 12.

Fig. 12

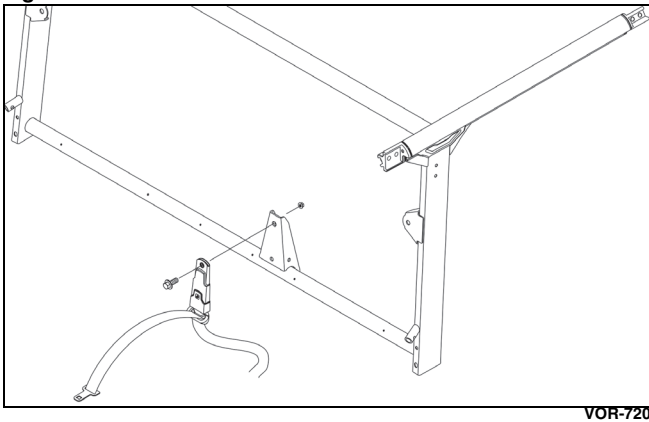

9. Install the seat belt close off using the existing push pins.

10. Remove the cap screws and nuts securing the seat belt buckles to the frame; then secure the new buckle and the existing passenger side buckle to the frame new Cap Screw (M12 x 30 mm) and new M12 Nylon Flange Nut. Tighten to 60 ft-lb. See Fig. 13.

11. Secure the anchor portion of the center seat belt and the operator side buckle to the frame using the existing cap screw and new M12 Nylon Flange Nut. Tighten to 60 ft-lb. See Fig. 13.

12. Install Seat Grommets into the frame. See Fig. 13.

Fig. 13

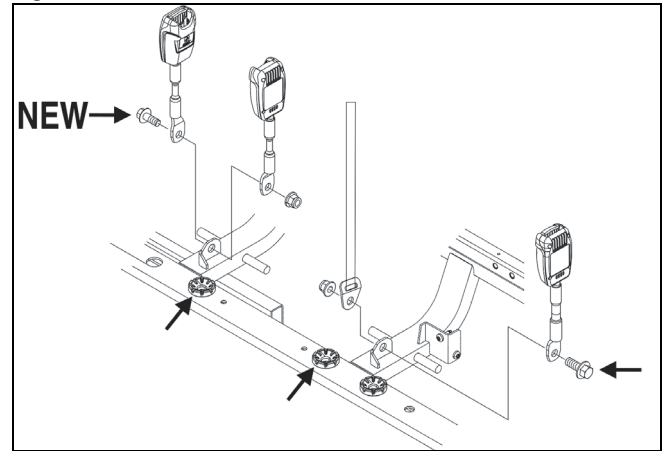

13. Secure Seat Backrest to the seat backrest frame using five Machine Screws (M6 x 16 mm). Tighten securely. Install the passenger seats as an assembly and secure and latch the frame. See Fig. 14.

Fig. 14

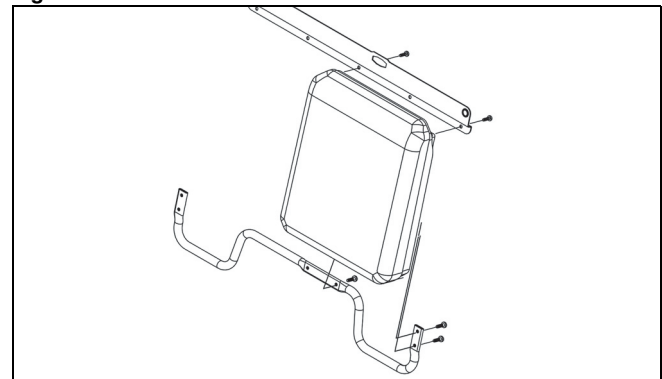

14. Install the seat bottom by hooking both of the "C" channels of the seat bottom into the mounting pegs and pressing down into the grommets.

15. Position the behind seat close-off panel into place; then reinstall the five cap screws near the cup holders.

16. Reinstall the five cap screws at the bottom of the behind seat close-off panel.

17. Reinstall the two push pins from inside the center document holder; then reinstall the two cap screws behind the passenger seat.

18. Reinstall the six cap screws that secure the rear panel to the center ROPS.

19. Reinstall both front side panels.