

## Introduction

This document provides instructions for installing an accessory on a Cat® Utility Vehicle (CUV). Do not perform any procedure in this document until you have read and understood the information contained in this document and the Operation and Maintenance Manual.

## Safety Section

### WARNING

Do not operate or work on this product unless you have read and understood the instruction and warnings in the relevant Operation and Maintenance Manuals and relevant service literature. Failure to follow the instructions or heed the warnings could result in injury or death. Proper care is your responsibility.

### WARNING

Failure to follow all safety guidelines prescribed in this document and by governing authorities and regulatory agencies may result in severe injury or death of personnel or machine damage.

### WARNING

When removing a major component or attachment, ensure that it is properly blocked or secured before removing mounting hardware. An assembly that is disconnected without proper blocking may shift or fall, resulting in serious injury or death of personnel or machine damage.

### WARNING

Personal injury or death can result from improper maintenance procedures. To avoid injury or death, follow the procedures exactly as stated below.

### WARNING

Personal injury can result from improper handling of chemicals. Make sure you use all the necessary protective equipment required to do the job. Make sure that you read and understand all directions and hazards described on the labels and material safety data sheet of any chemical that is used. Observe all safety precautions recommended by the chemical manufacturer for handling, storage, and disposal of chemicals.

### WARNING

Before servicing/performing maintenance on the machine, electrical power must be physically disconnected; battery cables must be disconnected from the battery. All applicable lock out and tag out procedures must be followed.

### WARNING

Observe the safe working load limits of all lifting and blocking devices and keep a safe distance from suspended/blocked loads. Personnel may be seriously injured or killed by falling loads.

### WARNING

Do not operate the machine if any guards or covers are missing or inadequately secured. Personnel could be seriously injured or machine damage may occur.

# Caterpillar®

## Installation Instructions - Accessory Kit

### Curved Glass Windshield Kit

(p/n 545-8307)



■ **NOTE:** Read these Installation Instructions thoroughly before beginning the installation process. Retain these Installation Instructions for future reference.

#### Kit includes:

QTY	DESCRIPTION
1	Side Trim (6.17 ft)
1	Full Windshield
4	Snap Clamp
4	Buckle Bracket
1	Hardware Kit
2	Lower Windshield Bracket

#### Tools Required:

- T30 Torx Bit
- Ruler or Measuring Tape
- Chalk or White Pencil
- 10 mm Socket/Wrench

#### CAUTION

**Do not trailer the vehicle backwards with this windshield installed if full doors, roof, and a rear panel are not installed.**

■ **NOTE:** Two persons are needed to install this kit.

1. Measure and mark 20 mm (0.787 in.) up from the flat face of the lower front ROPS tube joint on both sides of the vehicle. See Fig. 1 and 2.

■ **NOTE:** Failure to place the snap clamps in the correct location will result in improper sealing of the windshield.

2. While lining up the bottom of Snap Clamp with the mark made in step 1, install Snap Clamp to each ROPS tube by hooking the non-buckle side lip to the flat outside face and snapping the clamp into place. See Fig. 1 and 2.

Fig. 1

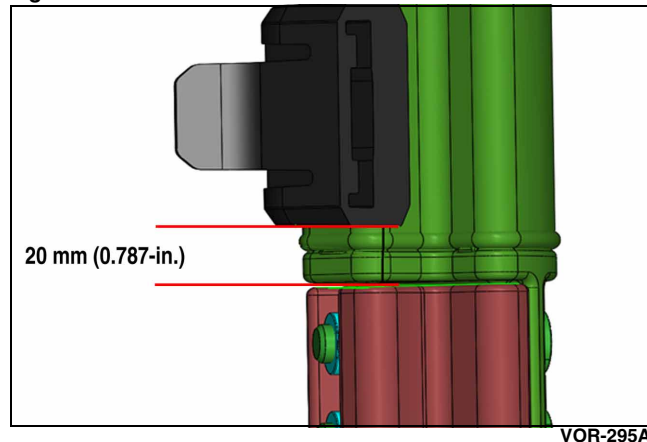

VOR-295A

Fig. 2

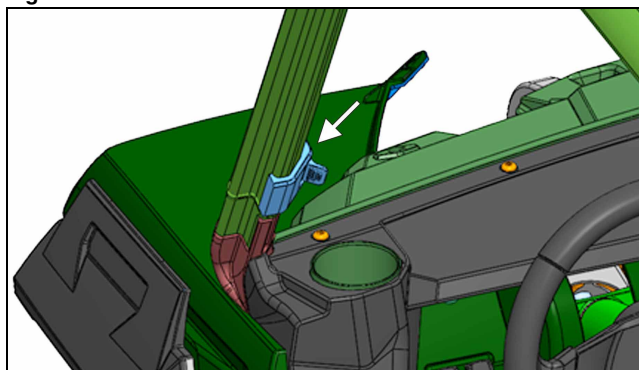

VOR-296

3. Measure and mark 104 mm (4.1 in.) down from the bottom of the front cross ROPS plate on both sides of the vehicle. See Fig. 3 and 4.
4. While lining up the top of Snap Clamp with the mark made in step 3, install Snap Clamp to each ROPS tube by hooking the non-buckle side lip to the flat outside face and snapping the clamp into place. See Fig. 3 and 4.

Fig. 3

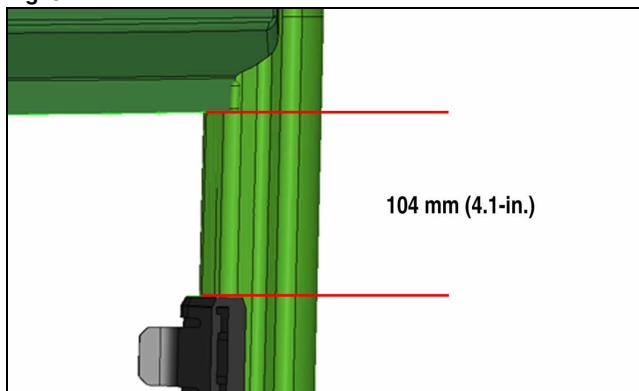

VOR-301B

Fig. 4

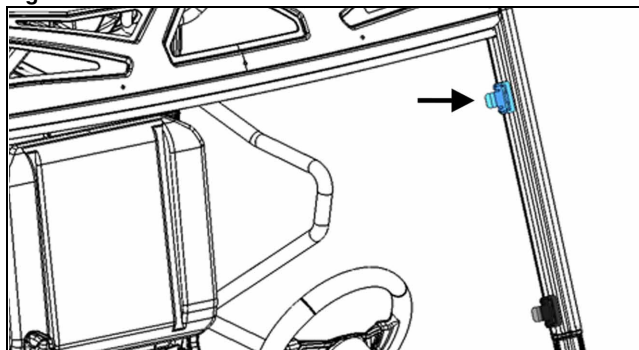

VOR-302

5. Remove the two center screws securing the dash; then position Lower Windshield Brackets with the holes and secure using the existing screws. Do not over-tighten. See Fig. 5 and 6.

Fig. 5

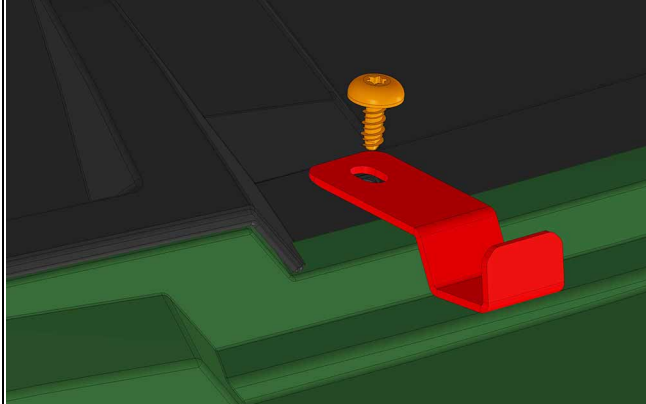

VOR-446

Fig. 6



VOR-447

6. Loosely secure four Buckle Brackets to Windshield assembly using eight M6 Nyloc Nuts making sure the tab with the square hole is installed on the outside. See Fig. 7 and 8.

Fig. 7

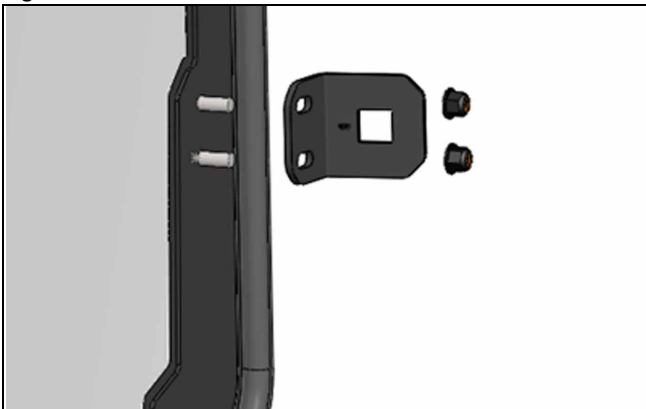

VOR-305

Fig. 8



VOR-306

- **NOTE:** The metal buckle brackets are labeled T for Top and B for Bottom. See Fig. 9 and 10.

Fig. 9

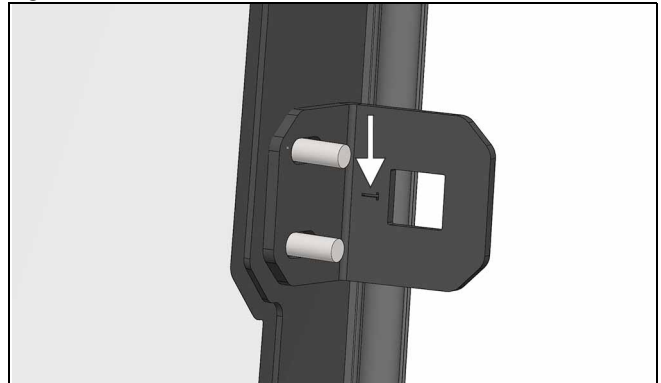

VOR-449

Fig. 10

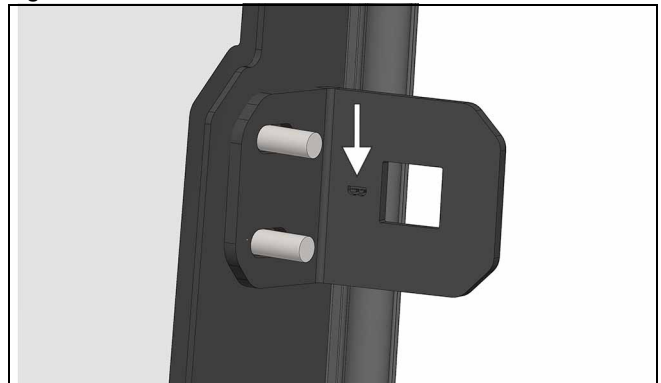

VOR-448

7. With two persons each holding one side of the windshield, push the windshield against the frame and snap the Buckle Brackets into the Snap Clamps making sure the bottom of the windshield is installed into the bottom windshield brackets.

### CAUTION

**DO NOT over-tighten the eight M6 Nylon Nuts or the windshield may crack and break.**

8. While applying even pressure all the way around the windshield and keeping the trim compressed, tighten down the eight M6 nylon nuts using a criss-cross pattern. See Fig. 11 and 12.

Fig. 11

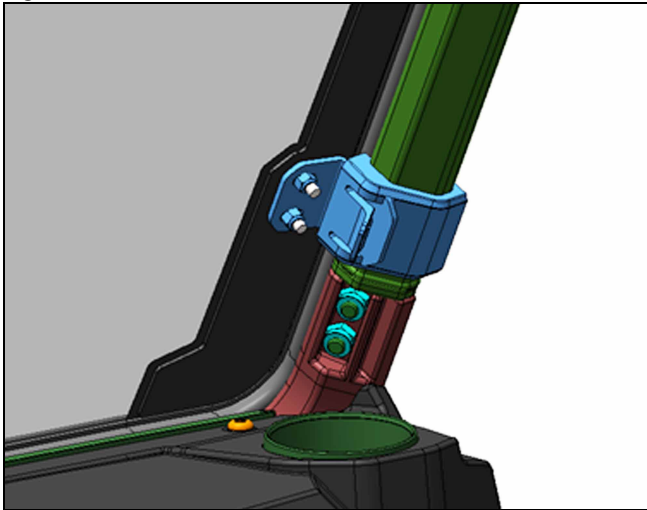

VOR-307

Fig. 12

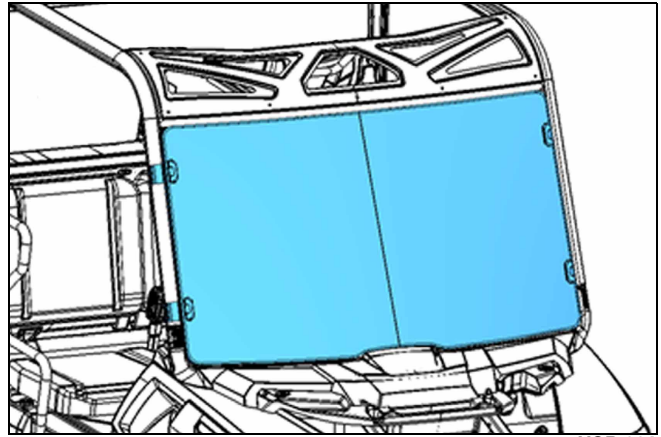

VOR-304

9. Ensure the trim has a proper seal by making sure the trim bulb is compressed against the vehicle.