

## Introduction

This document provides instructions for installing an accessory on a Cat® Utility Vehicle (CUV). Do not perform any procedure in this document until you have read and understood the information contained in this document and the Operation and Maintenance Manual.

## Safety Section

<p><b>⚠ WARNING</b></p> <p>Do not operate or work on this product unless you have read and understood the instruction and warnings in the relevant Operation and Maintenance Manuals and relevant service literature. Failure to follow the instructions or heed the warnings could result in injury or death. Proper care is your responsibility.</p>	<p><b>⚠ WARNING</b></p> <p>Personal injury can result from improper handling of chemicals. Make sure you use all the necessary protective equipment required to do the job. Make sure that you read and understand all directions and hazards described on the labels and material safety data sheet of any chemical that is used. Observe all safety precautions recommended by the chemical manufacturer for handling, storage, and disposal of chemicals.</p>
<p><b>⚠ WARNING</b></p> <p>Failure to follow all safety guidelines prescribed in this document and by governing authorities and regulatory agencies may result in severe injury or death of personnel or machine damage.</p>	<p><b>⚠ WARNING</b></p> <p>Before servicing/performing maintenance on the machine, electrical power must be physically disconnected; battery cables must be disconnected from the battery. All applicable lock out and tag out procedures must be followed.</p>
<p><b>⚠ WARNING</b></p> <p>When removing a major component or attachment, ensure that it is properly blocked or secured before removing mounting hardware. An assembly that is disconnected without proper blocking may shift or fall, resulting in serious injury or death of personnel or machine damage.</p>	<p><b>⚠ WARNING</b></p> <p>Observe the safe working load limits of all lifting and blocking devices and keep a safe distance from suspended/blocked loads. Personnel may be seriously injured or killed by falling loads.</p>
<p><b>⚠ WARNING</b></p> <p>Personal injury or death can result from improper maintenance procedures. To avoid injury or death, follow the procedures exactly as stated below.</p>	<p><b>⚠ WARNING</b></p> <p>Do not operate the machine if any guards or covers are missing or inadequately secured. Personnel could be seriously injured or machine damage may occur.</p>

# Caterpillar®

## Installation Instructions - Accessory Kit

### Polycarbonate Half Windshield Kit

(p/n 545-8313)



■ **NOTE:** Read these Installation Instructions thoroughly before beginning the installation process. Retain these Installation Instructions for future reference.

**Kit includes:**

QTY	DESCRIPTION
1	Side Trim (6.17 ft)
1	Half Windshield
2	Snap Clamp
2	Buckle Clamp Seal
2	Buckle Clamp Clip

**Tools Required:**

- Ruler or Measuring Tape
- Chalk or White Pencil

1. Measure and mark 20 mm (0.787 in.) up from the flat face of the lower front ROPS tube joint on both sides of the vehicle. See Fig. 1 and 2.
2. While lining up the bottom of Snap Clamp with the mark made in step 1, install the Snap Clamp to the ROPS tube by hooking the non-buckle side lip to the flat outside face and snapping the clamp into place. See Fig. 1 and 2.

Fig. 1

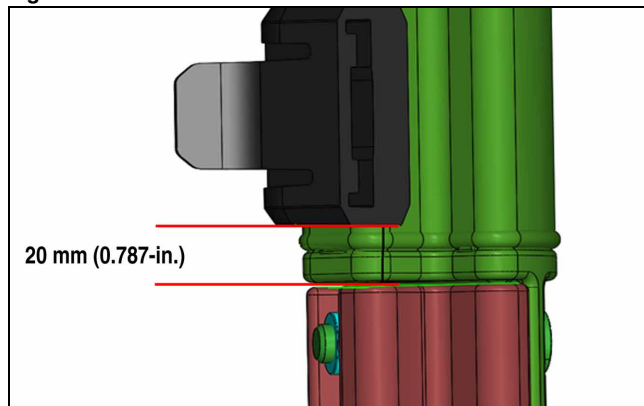

VOR-295A

Fig. 2

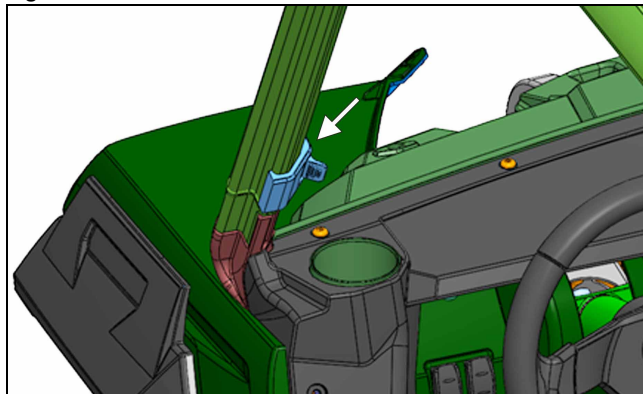

VOR-296

3. Install Buckle Clamp Seal onto Buckle Clamp Clip making sure the edges align. See Fig. 3.

Fig. 3

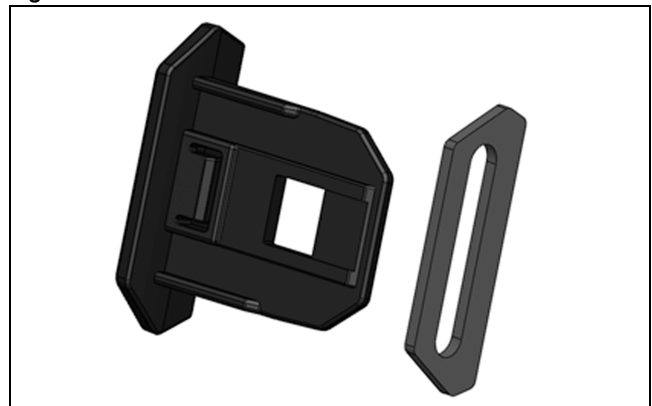

VOR-297

4. Insert a Buckle Clamp Clip through the routed slot in the half windshield so that the bulb of the rubber trim and the clip end of the Buckle Clamp Clip are both on the opposite side of the bend in the top of the windshield, and the longest edge of the Buckle Clamp Clip is closest to the trim of the windshield. See Fig. 4.

Fig. 4

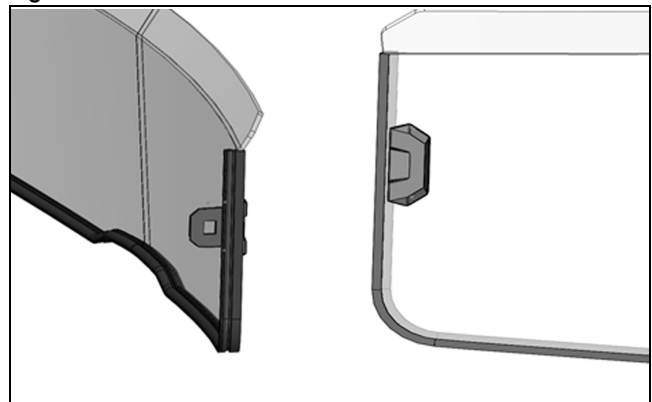

VOR-298

5. From the front of the vehicle with the Buckle Clamp Clip and trim bulb toward the inside of the vehicle, push the half windshield up to the left-side ROPS tube and insert the Buckle Clamp Clip into the Snap Clamp until the buckle snaps into place. See Fig. 5.

Fig. 5

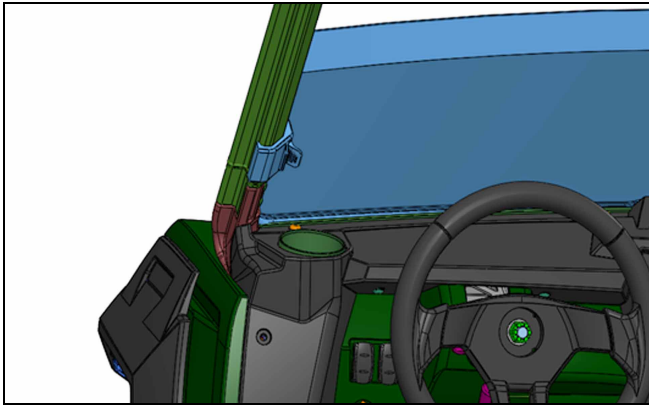

VOR-299

6. With the half windshield still secured to the left-side ROPS tube (from step 5), gently bend the middle of the half windshield with the bottom trim touching the vehicle hood and snap the other Buckle Clamp Clip into the Snap Clamp. See Fig. 6.

Fig. 6

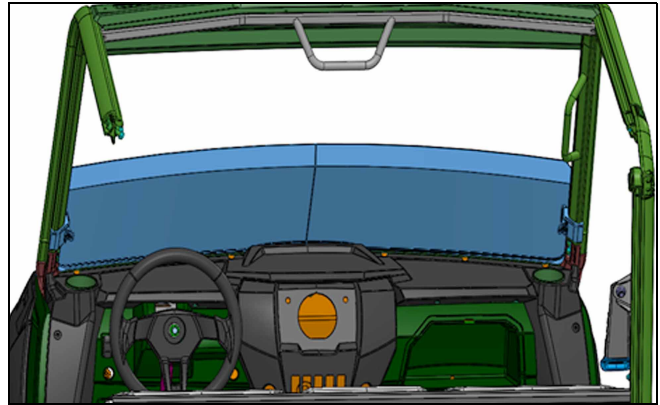

VOR-300

7. Ensure the trim has a proper seal by making sure the trim bulb is compressed against the vehicle.