



# REPAIR OPTIONS

---

## **DRIVE TRAIN**

# THE CAT® DRIVE TRAIN DIFFERENCE

## REUSABILITY BUILT IN

Cat® drive train components are built to be rebuilt. All parts and components are built as a system with varying levels of wear. You will gain maximum life by taking advantage of the reusability that is built in. There are three levels of Cat parts. Getting full value out of these parts will help lower costs. This is done by maximizing parts reuse. The longer the component is run after the appearance of problem indicators, the less parts reuse you will typically experience.

**LEVEL 1** parts are designed to wear and protect mating parts. 100% replacement is recommended during rebuilds. Included are anti-friction bearings, seals, gaskets and thrust washers (highlighted in blue).

HIGHER AVAILABILITY. LOWER COST.

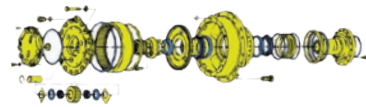

**LEVEL 2** parts are slower-wearing parts designed with reusability in mind. Included are plates, discs, gears and planet shafts.

TYPICALLY READILY AVAILABLE. HIGHER COST.

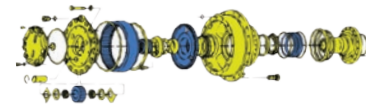

**LEVEL 3** parts are designed to last the life of the machine and only need to be replaced after a catastrophic failure. Included are cases, housings, carriers, hubs and main shafts.

NOT READILY AVAILABLE. SIGNIFICANTLY HIGHER COST.

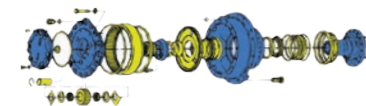

## CONSEQUENCES OF WORN DRIVE TRAIN

A worn drive train system can lead to accelerated wear and lower productivity.



## THE CAT FRICTION MATERIAL DIFFERENCE

The use of Cat Extended Life friction discs can reduce ownership costs because the brake overhaul can be extended to 2-4 times the hours versus competitive friction discs, depending on application.

————— **TIME** —————>

1 BRAKE OVERHAUL	2 BRAKE OVERHAUL	3 BRAKE OVERHAUL	FEWER FRICTION DISCS CONSUMED	LABOR HOUR SAVINGS
● ●	●	● ●	<b>33%</b>	<b>12</b>

● STANDARD COMPETITIVE DISC

● CAT EXTENDED LIFE DISK

EXAMPLE ABOVE  
CAT 980H WHEEL LOADER

# INDICATORS & SOLUTIONS

Regular maintenance intervals and proper inspections are critical to predicting the right time for a repair. Planned indicators help identify a window for before-failure repairs. Problem indicators help you fine tune the timing and type of repair. There are both visual and non-visual problem indicators that may be causing a loss in productivity and resulting in a higher cost. Below is a list of planned indicators and potential problem indicators and a range of possible solutions that can be customized to your situation.

PLANNED INDICATORS		PROBLEM INDICATORS	
<input type="radio"/> S•O•S <sup>SM</sup>	<input type="radio"/> Fuel consumption	<input type="radio"/> Hesitation	<input type="radio"/> Clutch or transmission slippage
<input type="radio"/> Machine SMUs	<input type="radio"/> VIMS™/ET	<input type="radio"/> Unusual noises	<input type="radio"/> Debris in filter
<input type="radio"/> Service history	<input type="radio"/> Inspections	<input type="radio"/> Vibration	<input type="radio"/> Brake chatter
<input type="radio"/> Experience		<input type="radio"/> Overheating	
		<input type="radio"/> Leaks	



## CHOOSE THE BEST OPTION FOR YOUR REPAIR

Every repair starts with four key questions:



### OWNERSHIP

How long do you plan to own the machine?



### UTILIZATION

How much/often do you use the machine?



### AFFORDABILITY

What is your expectation with regard to price?



### TURNAROUND

How quickly does your machine need to get back to work?

	REBEARING/RESEAL	REBEARING/RESEAL PLUS	COMPONENT REBUILD/RESEAL EXCHANGE	REMAN	NEW
<b>OWNERSHIP</b>	< 2 years			> 2 years	
<b>UTILIZATION</b>	< 1000 hours			> 1000 hours	
<b>AFFORDABILITY</b>	< 50% of new			> 50% of new	
<b>TURNAROUND</b>	Flexible			Urgent	

COMPONENT LIFE	Extend	Extend	Extend/Restore	Restore	Restore
INDICATORS	Planned	Planned	Planned/Problem	Problem	Problem
UPGRADE OPTIONS			●	●	●
<b>CAT ADVANTAGE</b>	Extend component life Reseal fluid leaks Seal components from contaminants Refill with new fluids Replace all seals, gaskets, anti-friction bearings and thrust washers/bearings	Extend component life Replace all seals, gaskets, anti-friction bearings and thrust washers/bearings Inspect and re-use to gain full life of reusable parts Replace worn parts as requested Restores performance	Restores 100% component life and performance Option to rebuild your core component or off-the shelf exchange with store credit Latest engineering updates Inspect and re-use to gain full life of reusable parts Flexible rebuild options including Cat Certified	Restores 100% of component life and like-new performance Off-the shelf exchange Value for your core Latest engineering updates Quick turnaround Minimizes waste	Cat original new component Built to be rebuilt Latest engineering updates Quick turnaround

<b>CAT BRAND PROMISE</b>	← <b>Cat genuine parts carry a 12-month warranty that covers resultant damage</b> <b>Cat factory-trained technicians</b> <b>Cat specified testing, tuning and tooling</b> →
--------------------------	---

\* Options determined based on condition

## GUARANTEED TO LAST

Genuine Cat new and Reman parts are backed by our **12-MONTH WARRANTY**, so you can feel confident selecting a repair option through your Cat dealer.

Additionally, if one of the genuine Cat new or Reman parts used in your repair is proven to be defective and the cause of any resultant damage, not only would the Cat new or Reman part be replaced, but any resultant damage to other Cat parts would also be covered. Competitors typically only warranty the part they replace regardless of whether or not the part has caused resultant damage.

---

**CONTACT YOUR CAT DEALER  
TO DISCUSS A RANGE OF SOLUTIONS  
THAT CAN BE TAILORED TO MEET  
YOUR NEEDS.**

