

BEARING WET SUMP

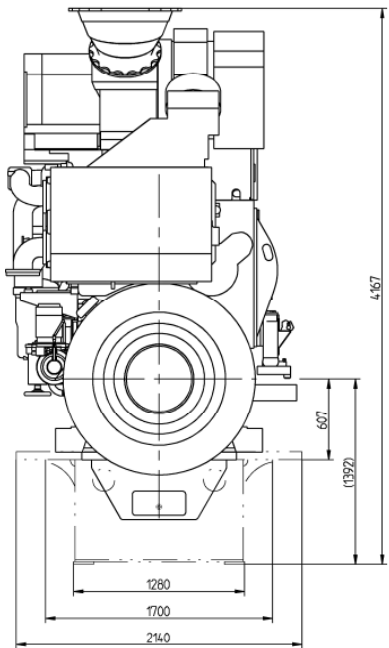

WET SUMP

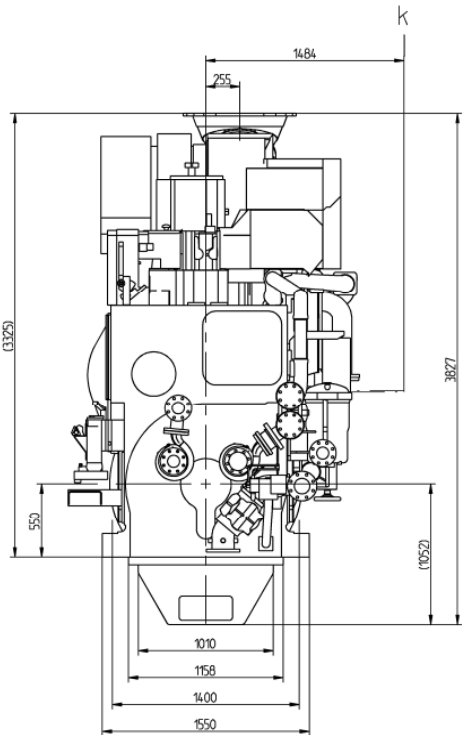
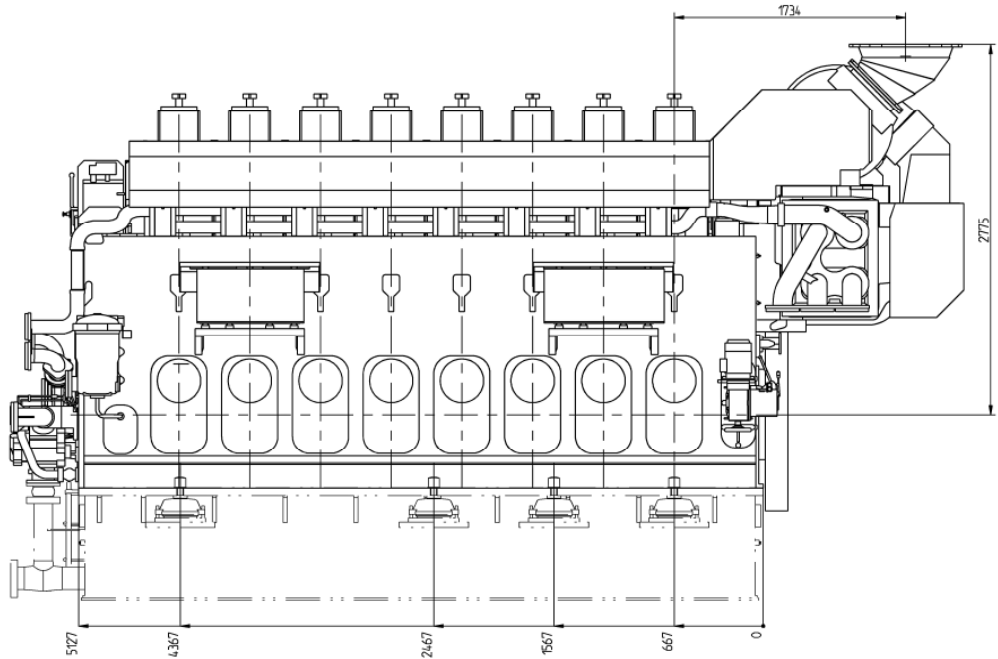

DRY SUMP

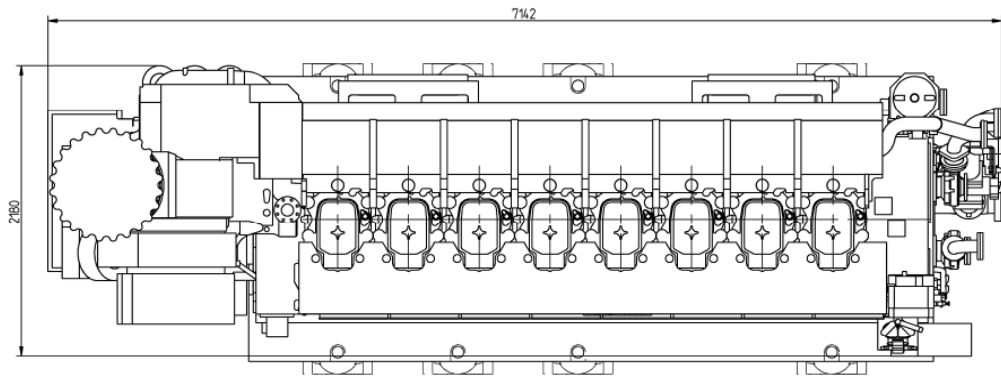
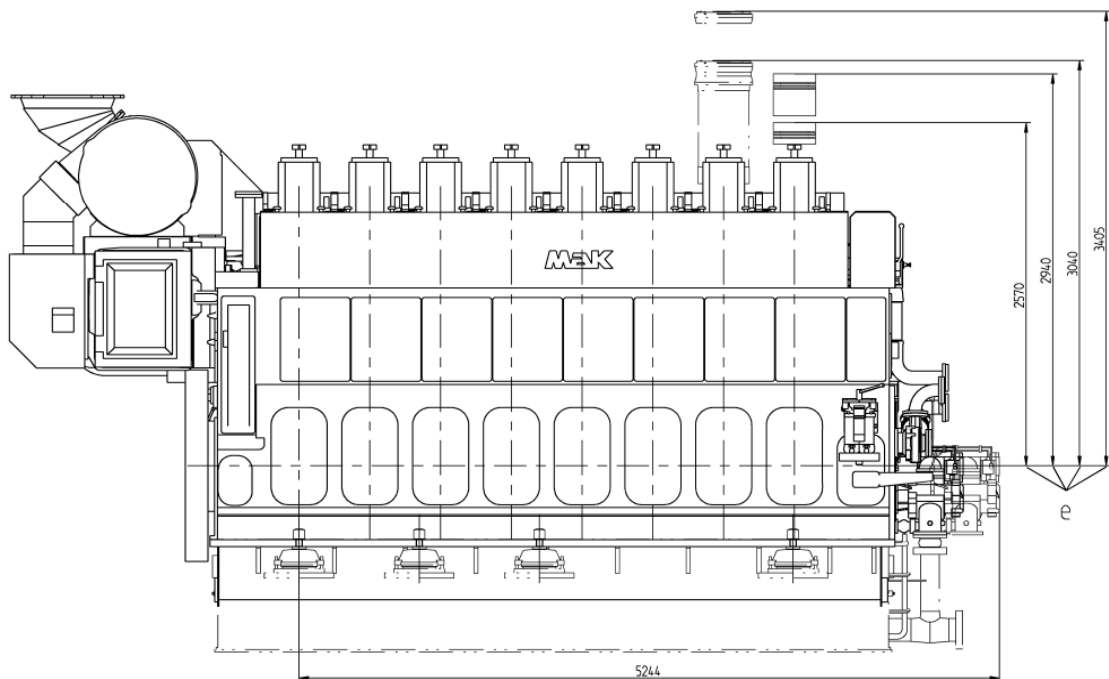

Anmerkung / REMARKS	
b	SPACE REQUIRED FOR MEASURING TORSIONAL VIBRATIONS, AND/OR FOR REMOVAL OF THE VIBRATION DAMPER AND/OR LUBOIL PUMP
e	SPACE REQUIRED FOR REMOVAL OF PISTON AND CYLINDER LINER REDUCED REMOVAL HEIGHT FOR CYLINDER LINER 2940mm
k	SPACE REQUIRED FOR TERMINAL SET
o	SPACE REQUIRED FOR TURBOCHARGER SHAFT
p	SPACE TIQUIRED FOR CHARGE AIR COOLER REMOVING

Gewicht trocken mit flacher Ölwanne  
WEIGHT DRY WITH DRY SUMP

CATERPILLAR MOTOREN GmbH & Co. KG RESERVES THE RIGHT TO  
MODIFY AND AMEND DATA AT ANY TIME. ANY LIABILITY FOR  
ACCURACY OF INFORMATION PROVIDED IS EXCLUDED.  
WE WILL SUPPLY FURTHER BINDING DATA IN CONNECTION WITH A CORRESPONDING ORDER.  
ALL RIGHTS RESERVED. NO PART OF THIS PUBLICATION  
MAY BE REPRODUCED OR COPIED IN ANY FORM,  
WITHOUT PRIOR WRITTEN PERMISSION OF CATERPILLAR MOTOREN GmbH & Co. KG.

<b>CATERPILLAR</b>		Model 8M32E_FWS 1.0	8M32E_FWS 1.0		
Überflächen Surfaces ISO 1802	Allgemeinskizzen General. Illustrations ISO 2768 - mK	Druck Drawing W 882	Verstärkt Reinforced Scale	1:20	Gewicht (toll Weight (kg) ~49000
Motor - Einbauzeichnung ENGINE - INSTALLATION DRAWING					
Änd.-Stand Change Level -	Freigabe-Nr. Release No.	UKZ Doc Code	Zeichnungs-Nr. Drawing No.	Blatt Sheet 1	1
8M32E FWS					