



## PR43C Technical Details

### PR43C Benefits

- Unique Dual Caterpillar Engine Configuration  
4300 bhp total
- Environmentally Friendly –  
Rebuilt from Older Locomotive Core
- Maximized Fuel Savings
- Extended Engine Overhaul Life
- EPA Tier 2, Tier 3 Compliant –  
with Provision for Exhaust Aftertreatment

### Dimensions and Performance

- AAR Clearance - Modified Plate C
- Nominal Length - 71' 2"
- Nominal Weight - 432,000 lbs
- Stall Tractive Effort - 140,000 lbs
- Continuous Tractive Effort - 95,000 lbs
- Dynamic Brake max. - 79,000 lbs

### Options:

- Crash Worthy Wide Body Cab
- High Adhesion Single Axle Control  
Traction System
- Zeit Locomotive Microprocessor  
Control System

Engine Model	C-175 (Primary)	C-18 (Secondary)
Engine Type	16 Cylinder V	6 Cylinder Inline
Engine Horsepower	3600 hp @ 1800 rpm	700 hp @ 1800 rpm
Wheel Arrangement	C - C	
Traction Alternators	Marathon	
Traction Motors	D88 type	
Air Compressor	GAR37	
Air Brake (basic)	CCB26	
Fuel Tank (nominal)	4000 gallons	
Basic EPA Compliance	Tier 2, Tier 3	
(subject to final certifications)		

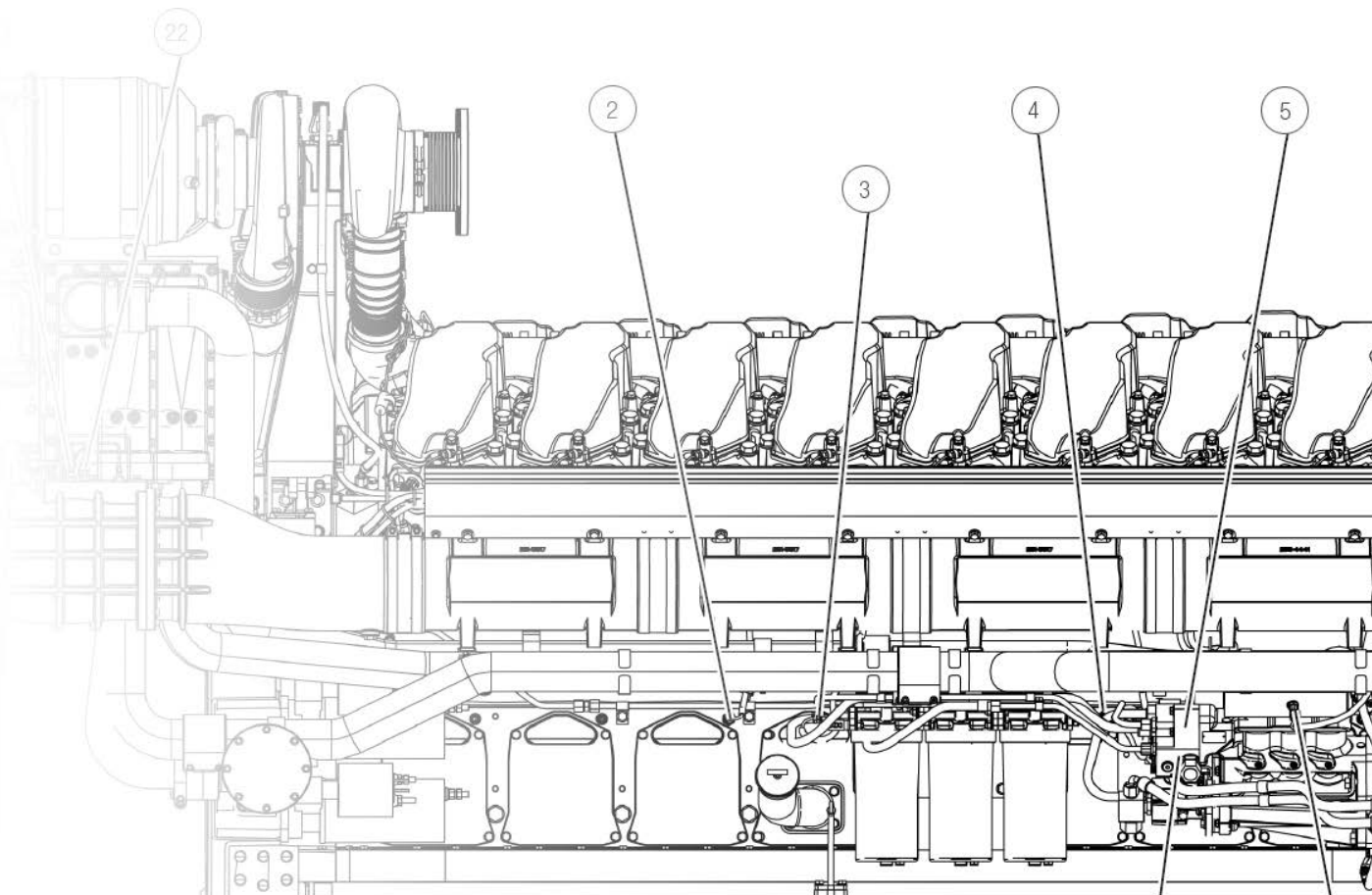

Engine Shown May Not Reflect Actual Engine Used.