

38ELQ183A-C

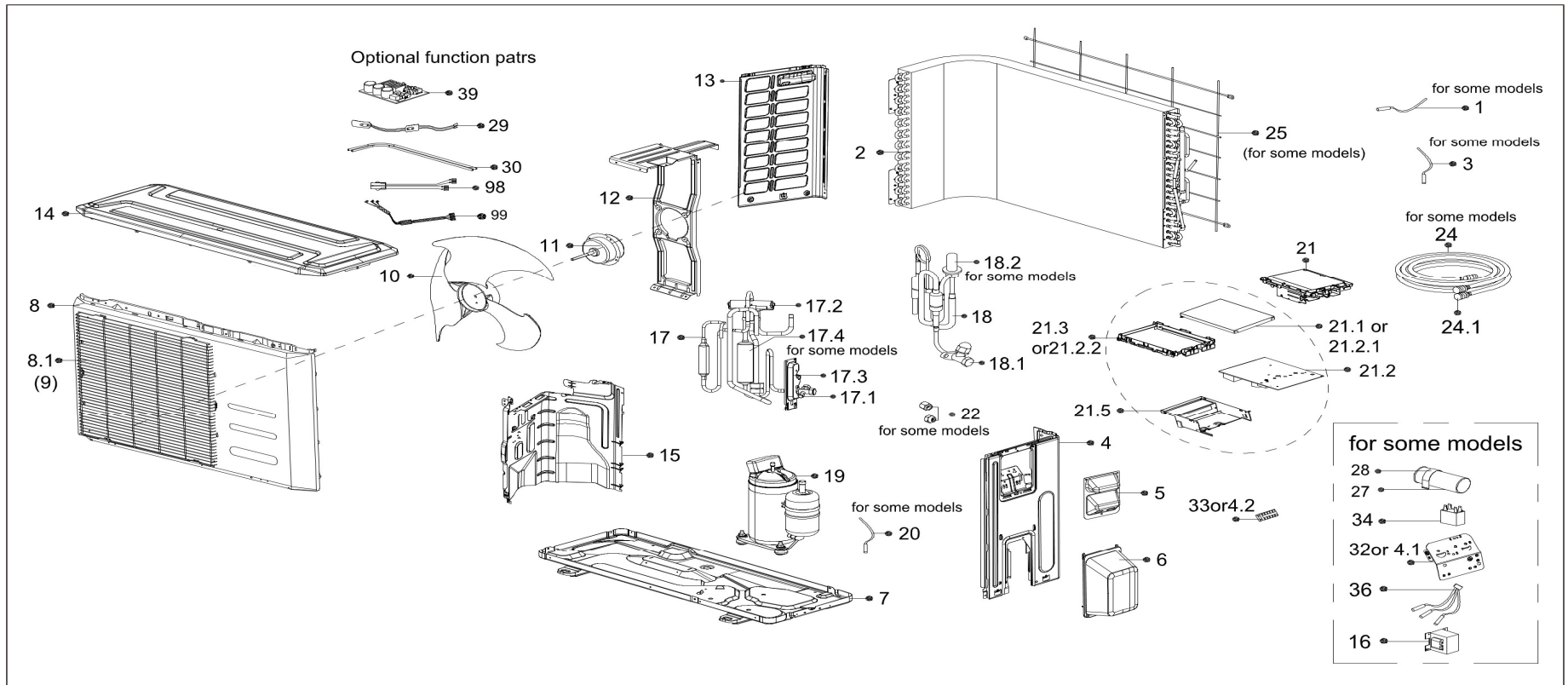

EX_ID	Spare Parts Code	Part Name(EN)	Qty.
2	15822000008261	Condenser assembly	1
4	12222000004186	Right side plate	1
5	12100701000015	Big handle assembly	1
6	12122000007150	Water collector	1
7	12222000003983	Chassis Assembly	1
8	12222000005442	Front panel assembly	1
9	12122000012538	Air outlet grille	1
10	12100105000051	Axial flow fan	1
11	11002015000039	Brushless DC Motor	1
12	12222200002154	Supporter subassembly of fan motor	1
13	12222000008484	Left side plate assembly of cabinet	1
14	12222000002451	Top cover assembly	1
15	12222000002226	Partition board	1
17	15422000013773	4-way valve assembly	1
17.1	15500204000058	Gas valve	1
17.2	15500216000026	4-way Valve	1

EX_ID	Spare Parts Code	Part Name(EN)	Qty.
17.3	12222000002571	Valve plate	1
17.4	15500508000046	Muffler subassembly	1
18	15422000004813	Liquid valve assembly	1
18.1	15500208000028	Liquid valve	1
19	11103020003919	DC Inverter Rotary Compressor	1
21	17222000035624	Electronic control box subassembly	1
21.2	17122000053435	Outdoor main control board subassembly	1
21.2.1	12222000001455	Cover of electronic control box	1
21.2.2	12122000006913	Support of electronic control box	1
21.5	12222000008644	Electronic installing box subassembly	1
24	15111600A00014	Connecting pipe assembly	1
32	12222000002259	Terminal board	1
33	17400401000068	Terminal	1
36	11201011000067	Combination Sensor	1
99	17401203012697	Compressor wire subassembly	1

40ELQ183A-E

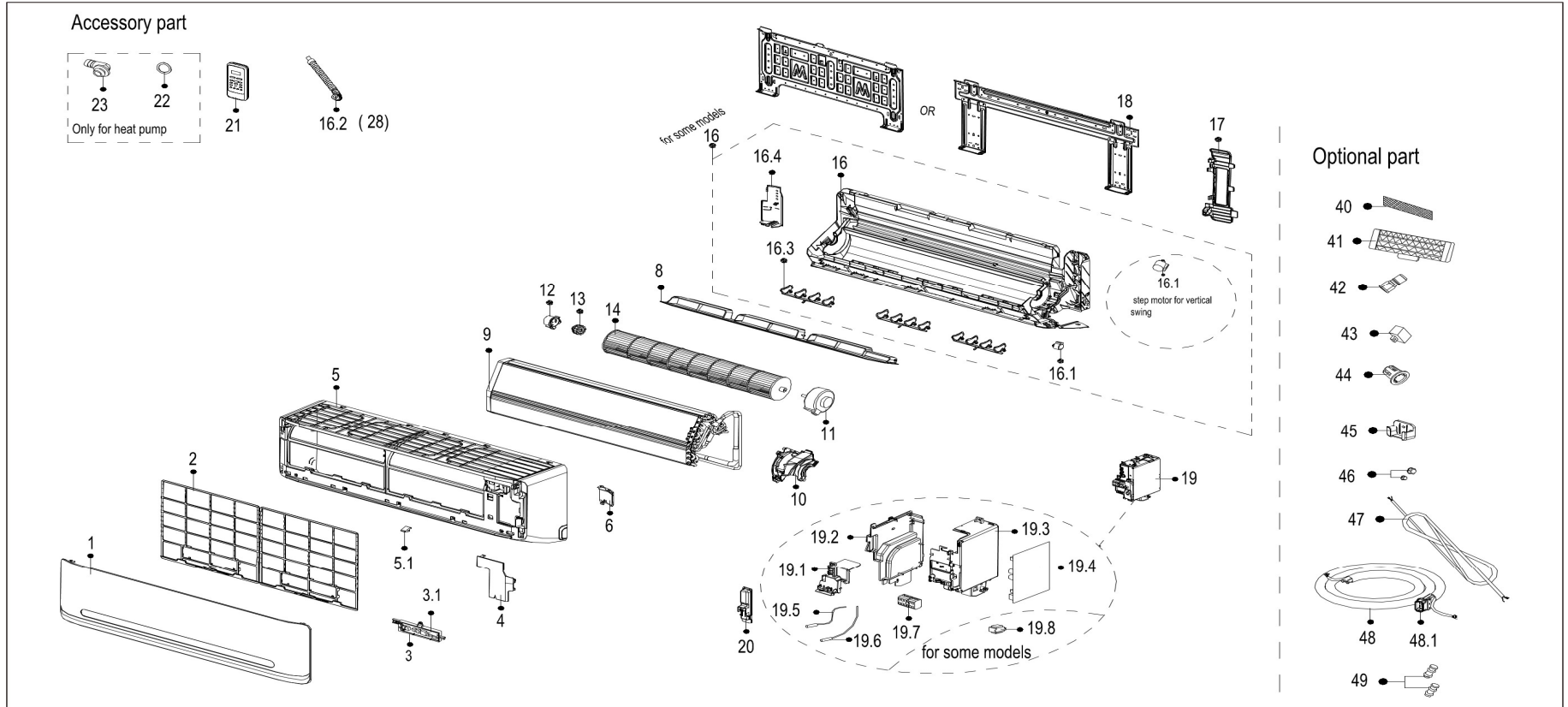

EX_ID	Spare Parts Code	Part Name(EN)	Qty.
1	12122000A71998	Panel assembly	1
2	12100204000397	Air filter	2
4	12122000006755	Cover of electrical equipment	1
5	12122000002008	Panel frame assembly	1
5.1	12122000008242	Screw Cap	1
6	12122000004592	Front cover of chassis(right)	1
8	12122000006359	Horizontal louver	1
9	15822000008214	Evaporator assembly	1
10	12122000005538	Fan motor cover	1
11	11002015011867	Brushless DC Motor	1
12	12122000000350	Bearing holder	1
13	12622000000131	Bearing components	1
14	12100102000131	Cross flow fan	1
16	12122000004279	Chassis assembly	1
16.1	11002010000077	Stepper motor	1
16.2	12100501000032	Drain hose	1
16.3	12122000008961	Horizontal louver	3
16.4	12122000004612	Front cover of chassis(left)	1
17	12122000012941	pipe clamp board	1
18	12222000003595	Installation Plate	1
19	17222000A55549	Electronic control box subassembly (Mid-and low-end)	1
19.1	12122000004577	Electronic control box	1

EX_ID	Spare Parts Code	Part Name(EN)	Qty.
19.2	12122000004639	Left cover of electronic control box	1
19.3	12122000004632	Right cover of electronic control box	1
19.4	17122000A35431	Main control board subassembly	1
19.5	11201007003424	Room Temperature Sensor	1
19.6	11201007003447	Pipe Temperature Sensor	1
19.7	17400401000006	Terminal	1
20	12122000005020	Cover of electronic control box	1
21	17317000005414	Remote controller	1
22	12600701000039	seal ring	1
23	12100509000061	Drain hose	1
40	12100204000685	Air freshening filter	1
42	15500209000001	Check valve	1
45	12122000027144	Bracket of remote Controller	1
46	15500406000012	Copper nut	1
46	15500406000016	Copper nut	1
47	17401203000043	Indoor and Outdoor Junction Cable	1
53	17222000A46068	Display box subassembly	1
53.1	17122000A07845	Display board subassembly	1
53.1	17122000046739	Adapter plate subassembly	1
53.2	12122000A03192	Display box	1
98	17310900A03543	WIFI module subassembly	1