

SAMSUNG

Optimized printing to
transform your business.



Samsung Laser Multifunction **ProXpress**
M4070 | 3870 | 3370 Series

Businesses increasingly require high productivity and lower operating costs from their printers.

Fast, professional-quality printers with lower operating costs.

Most businesses are increasingly demanding high productivity and lower operating costs from their printers. Ease of use and printing versatility for a wide range of documents and presentations are also needed.

The ProXpress M4070 | 3870 | 3370 series multifunction printers are ideal for every business environment, with a full range of features designed to increase productivity and efficiency:

High-Speed Performance With Professional Results

ProXpress M4070 | 3870 | 3370 series MFPs have high print speeds of up to 42 ppm¹ (pages per minute) with 256 MB memory for letter size documents. Samsung's Rendering Engine for Clean Page (ReCP) technology produces sharp text and clear images on a range of media sizes and weights.

Cost Efficiency

Eco features such as the One Touch Eco Button and Easy Eco Driver plus job accounting help reduce paper, toner, and energy consumption. A wide range of toner cartridges² supporting different printing volumes aids in lowering the total cost of ownership (TCO).

Versatility

4-in-1 multifunctional features and built-in duplex, and convenient mobile printing capabilities come standard. The printers feature enterprise-level security, which offers greater control of user, document, and network access. The M3870FW also features wireless connectivity and Wi-Fi Direct for ultimate ease of sharing.

Ease of Use

Easy Printer Manager ensures smooth printer operation, Easy Document Creator helps users create, compile and share documents, and the built-in numeric keypad enables easy and secure printing.

Samsung high-performing MFPs deliver improved print quality and speed.

Print with exceptional speed and superior quality.

The Samsung ProXpress M4070 | 3870 | 3370 series help businesses print complex documents on heavier media types without sacrificing processing and printing speed and professional-quality results.

High-Speed Printing and Image Processing

The robust ProXpress M4070 | 3870 | 3370 series MFPs feature print speeds of up to 42 ppm¹, powered by a Cortex™-A5 core processor and up to 256 MB of memory. High speed and performance enable businesses to accelerate document and image processing for increased efficiency.

Higher-Quality Print Output

ReCP technology improves the readability of printed documents by enhancing thin lines and sharpening the edges of negative text. Small text that typically may not scan completely is sharpened through edge resolution enhancement. The ProXpress M4070 | 3870 | 3370 series MFPs deliver sharp, solid prints and scans with effective output print resolutions of up to 1200 x 1200 dpi.

 42 pages per minute

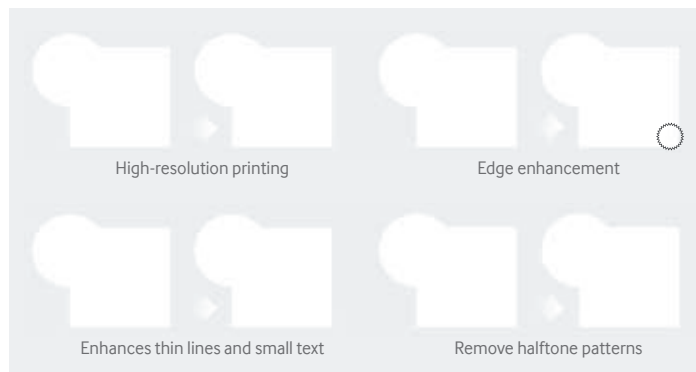

Additional Printing Choices for Professional Documents

The printers' multipurpose tray supports media of up to 58 lb. stock in weight, which offers more printing choices for professional documents. Numerous labels, cards and envelopes can be printed with ease using the multipurpose tray.³

Control costs by reducing toner and paper expenses.

Reduce operating expenses with economical features and solutions.



One Touch Eco Button

Businesses can lower toner and paper usage with the one-touch Eco Button. Eco Mode automatically adjusts the print job and enables 2-up printing (two pages on the same side) and duplex printing (printing on both sides). Skipping blank pages and toner save mode are also enabled. These settings are easily adjusted from within the driver, and an administrator can modify and even choose to enforce Eco Mode for all users, saving their organization on costs.



Easy Eco Driver

The Easy Eco Driver, granted the 2012 Outstanding Achievement in Innovation award from Buyers Laboratory (BLI), can reduce toner use by up to 20%. Users have the option of removing images, converting them from bitmap to sketch, and removing bold text in order to save on toner costs.



Samsung Eco-Driver earned the 2012 "Outstanding Achievement in Innovation" Award from Buyers Lab



Central Print Usage Control to Save More Resources

Central print usage control, activated through the SyncThru™ Admin job accounting feature, enables managers to assign users to specific printers. Users can also be assigned quotas for the number of pages or copies they can make per printer.



More Toner Options, More Choices for Cost Reduction

ProXpress M4070 | 3870 | 3370 series offers diverse laser toner cartridge options² from standard-yield laser toner cartridges that typically yield 3,000 standard pages to ultra-high yield laser toner cartridges that can yield 15,000 standard pages, which lowers the cost per page and reduces your expenses.

An integrated toner system contains the imaging unit and toner cartridge in one convenient package. This integrated toner system is the preferred choice for businesses with heavier printing volumes.

Take advantage of flexible printing options that help optimize output.

Improve productivity with versatile features from multifunction to security.



4-in-1 Multifunction and Built-in Duplex Printing

4-in-1 multifunctional (print, copy, scan, fax) capabilities and built-in duplex printing provide the versatility and convenience that businesses need to stay competitive. Furthermore, the M4070FR and M3870FW have a DADF (duplex automatic document feeder) standard, allowing users to copy, scan and fax two-sided documents, which further improves office efficiency.



Convenient Mobile Printing Optimized for Various Business Environments

The free Samsung Mobile Print app allows users to print, scan and fax directly from their mobile devices. By simply downloading the Mobile Print app from the Google® Play store for Android™ or the App Store for iOS®, users can access their devices without the need for additional drivers or complicated setup.

The app will detect any compatible Samsung printer or MFP located on the same Wi-Fi network, giving users access to the full range of the machine's functions. The ProXpress M4070 | 3870 | 3370 series can handle almost any type of file, including Microsoft Office documents, images and web pages.

Google® Cloud Print Ready

With the ProXpress M4070 | 3870 | 3370 series and Google Cloud Print, you can print from virtually anywhere, right out of the box. Google Cloud Print connects your printers to the Web, allowing you to print from mobile devices including smartphones, tablets, laptops and Chromebooks, from anywhere you have an Internet connection. You can even share your work or home printer with anyone you choose for added convenience.



Enterprise-Level Document Security

Businesses produce numerous official documents containing confidential information, which requires highly secure printing. ProXpress M4070 | 3870 | 3370 series MFPs offer greater control of users, document and network access with Samsung SyncThru™ Admin at the enterprise security level.

With Samsung SyncThru™ Admin, businesses can administer, operate and manage print jobs securely.

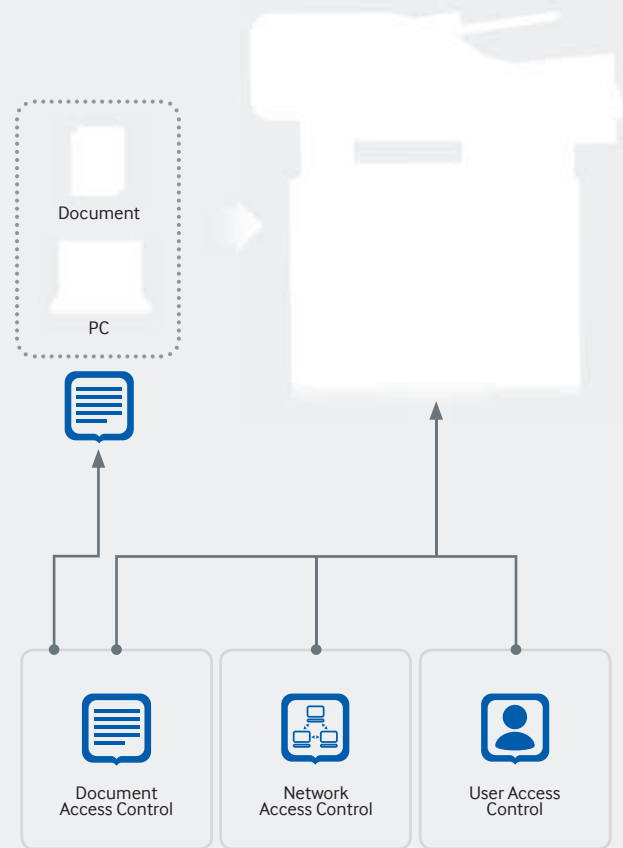

Network Access Control

- SSL
- 802.1x
- IP/MAC Filtering
- All Network Port Control, IPSEC

User Access Control

- LDAP/Local Authentication
- Authorization (Role) Manager
- Job and Access Log

Document Access Control

- Data Encryption, Function Lock

Simplify print jobs with easy security management.

Streamline printing with easy-to-use design.

Easy Printer Manager

The Easy Printer Manager helps companies remotely control settings, such as the One Touch Eco Button, and copy, scan and fax settings. Multiple devices can be monitored and managed using the Easy Printer Manager. Businesses can also monitor printer status such as error messages, including paper empty, toner empty and paper jam alerts.

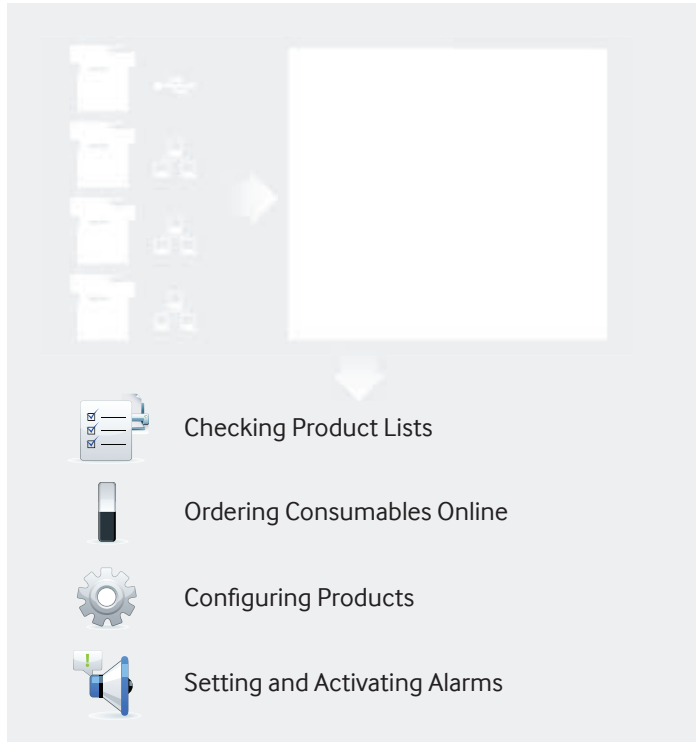

Easy Document Creator

With the Easy Document Creator, employees can create digital documents in multiple formats and share them through email or social networks. A document converter for smartphones, e-book readers, and social media provide users convenience with less effort.



Easy Secure Printing

The ProXpress M4070 | 3870 | 3370 series MFPs feature easy secure printing capability right out of the box. A user can elect to send a confidential or personal print job right from the driver, which can only be accessed by entering the PIN on the built-in keypad. Not only does this protect sensitive information, but it reduces the number of wasted prints if a user decides they no longer needed the print job, thereby lowering costs.



Optimize the print environment with high performance and efficiency.

The Intelligent Choice

Samsung ProXpress M4070 | 3870 | 3370 series MFPs provide high performance with print speeds of up to 42 ppm¹. The printers produce professional-quality printouts with more reliable paper handling, and support a range of media types, up to 58 lbs.

Along with the enhanced print and copy management, companies can achieve greater cost efficiency through robust Eco features for lower toner and paper costs based on higher cartridge yields.

ProXpress M4070 | 3870 | 3370 series MFPs provide versatility with 4-in-1 multifunctional capabilities, duplex printing, mobile and wireless⁴ printing, and added security at the enterprise-security level.

With convenient features such as the Easy Printer Manager, Easy Document Creator, and secure printing, ProXpress M4070 | 3870 | 3370 series MFPs help improve printing and document processing efficiency for all types of businesses.

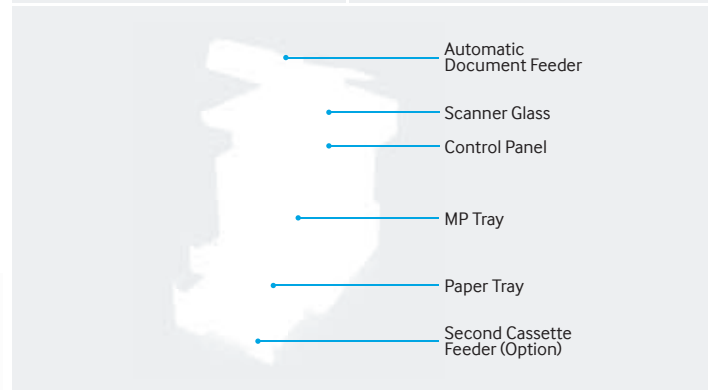
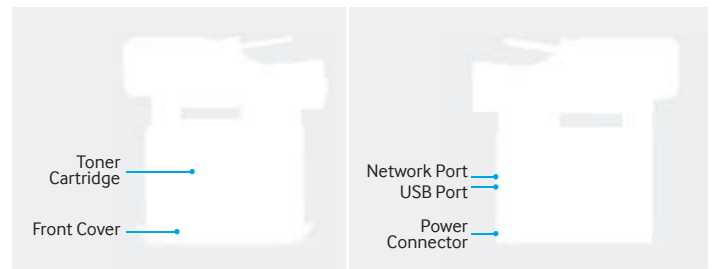

| Features | Benefits |
|------------------------------------|--|
| 600MHz processor and 256 MB memory | Boost print and scan productivity with high quality results. |
| ReCP Technology | Produce sharp and clean print and scan outputs. |
| Various Media Handling | Produce and handle more types of documents with support for heavy media. |
| One Touch Eco Button | Support cost and energy saving functions of 2-up/duplex printing, skipping blank pages, and toner saving mode. |
| Easy Eco Driver | Deliver cost savings by printing only what you need. |
| 4-in-1 | Enable users to print, copy, scan, fax and PC-fax with unparalleled convenience, ease, and speed. |
| Easy Printer Manager | Facilitate various printer management and monitoring. |
| Easy Document Creator | Compile and print complex documents with ease. |
| SyncThru™ Admin | Secure printing jobs at the enterprise-security level. |
| Samsung Mobile Print | Print, scan, and fax from mobile devices. |

- 42 PPM on M4070FR, 40 PPM on M3870FW, 35 PPM on M3370FD
- 10,000 page yield toner cartridge is available on M4070 and M3870 series only. 15,000 page yield toner cartridge is available on M4070ND model only.
- 50-sheet multipurpose tray is available on M4070 and M3870 series only. 1-sheet bypass available on M3370 series.
- Wireless and Wi-Fi Direct available on M3870FW only

| Specifications | M3370FD | M3870FW | M4070FR |
|----------------------------|---|---|---|
| Print | | | |
| Engine Speed | Up to 35 ppm in Letter | Up to 40 ppm in Letter | Up to 42 ppm in Letter |
| Resolution | Up to 1,200 x 1,200 dpi | Up to 1,200 x 1,200 dpi | Up to 1,200 x 1,200 dpi |
| FPOt (From Ready) | < 6.5 seconds | < 6.5 seconds | < 6.5 seconds |
| Duplex | Automatic | Automatic | Automatic |
| Emulation | SPL, PCL5e/6, PS3, IBM ProPrinter, EPSON (ESC/P), PDF v1.7 | SPL, PCL5e/6, PS3, IBM ProPrinter, EPSON (ESC/P), PDF v1.7 | SPL, PCL5e/6, PS3, IBM ProPrinter, EPSON (ESC/P), PDF v1.7 |
| Copy | | | |
| Copy Speed | Up to 35 cpm in letter | Up to 40 cpm in letter | Up to 42 cpm in letter |
| Resolution | Up to 600 x 600 dpi | Up to 600 x 600 dpi | Up to 600 x 600 dpi |
| First Copy Out Time | Less than 10 Seconds Flatbed, Less than 13 Seconds ADF | Less than 10 Seconds Flatbed, Less than 13 Seconds ADF | Less than 10 Seconds Flatbed, Less than 13 Seconds ADF |
| Multi Copy | 1-99 | 1-99 | 1-99 |
| Duplex Copy | No | Yes | Yes |
| Copy Features | ID Copy, N-Up, Book Copy, Erase Edge, Watermark Copy, Page Numbering, Time & Date Stamping, ID Stamp, Erase Background | ID Copy, N-Up, Book Copy, Erase Edge, Watermark Copy, Page Numbering, Time & Date Stamping, ID Stamp, Erase Background | ID Copy, N-Up, Book Copy, Erase Edge, Watermark Copy, Page Numbering, Time & Date Stamping, ID Stamp, Erase Background |
| Fax | | | |
| Compatibility | ITU-T G3, ECM | ITU-T G3, ECM | ITU-T G3, ECM |
| Communication System | PSTN / PABX | PSTN / PABX | PSTN / PABX |
| Modem Speed | 33.6 Kbps | 33.6 Kbps | 33.6 Kbps |
| Color Fax | Yes | Yes | Yes |
| Resolution | Standard: 203 x 98 dpi, Fine: 203 x 196 dpi, Superfine: 300 x 300 dpi, Color: Up to 200 x 200 dpi | Standard: 203 x 98 dpi, Fine: 203 x 196 dpi, Superfine: 300 x 300 dpi, Color: Up to 200 x 200 dpi | Standard: 203 x 98 dpi, Fine: 203 x 196 dpi, Superfine: 300 x 300 dpi, Color: Up to 200 x 200 dpi |
| Fax Memory | 6 MB (500 pages) | 6 MB (500 pages) | 6 MB (500 pages) |
| Fax Features | Fax to PC/Email/SMB/FTP, Speed Dial, Auto Redial, On Hook Dial, Last Number Redial, Delayed Fax, Fax Forward to Fax/PC, Junk Fax Barrier, Auto Reduction, Secure Receive, Confirmation Report | Fax to PC/Email/SMB/FTP, Speed Dial, Auto Redial, On Hook Dial, Last Number Redial, Delayed Fax, Fax Forward to Fax/PC, Junk Fax Barrier, Auto Reduction, Secure Receive, Confirmation Report | Fax to PC/Email/SMB/FTP, Speed Dial, Auto Redial, On Hook Dial, Last Number Redial, Delayed Fax, Fax Forward to Fax/PC, Junk Fax Barrier, Auto Reduction, Secure Receive, Confirmation Report |
| Scan | | | |
| Scan Compatibility | TWAIN, WIA, ICDM, SANE (Linux) | TWAIN, WIA, ICDM, SANE (Linux) | TWAIN, WIA, ICDM, SANE (Linux) |
| Scan Method | Color CIS | Color CIS | Color CIS |
| Scan Speed | Up to 20 ipm | Up to 24 ipm | Up to 24 ipm |
| Resolution | Optical | Up to 1200 x 1200 dpi | Up to 1200 x 1200 dpi |
| | Enhanced | Up to 4800 x 4800 dpi | Up to 4800 x 4800 dpi |
| Duplex Scan | No | Yes | Yes |
| Scan Depth | Mono: 8 bit, Color: 48 bit | Mono: 8 bit, Color: 48 bit | Mono: 8 bit, Color: 48 bit |
| Scan To | Email, SMB, FTP, PC, WSD | USB, Email, SMB, FTP, PC, WSD | USB, Email, SMB, FTP, PC, WSD |
| Paper Handling | | | |
| Input Capacity | 250-sheet Cassette, 1-sheet Manual Bypass (771 sheets max) | 250-sheet Cassette, 50-sheet Multipurpose Bypass Tray (820 sheets max) | 250-sheet Cassette, 50-sheet Multipurpose Bypass Tray (820 sheets max) |
| Output Capacity | 150 sheets face down | 150 sheets face down | 150 sheets face down |
| Media Size | 3" x 5" ~ 8.5" x 14" | 3" x 5" ~ 8.5" x 14" | 3" x 5" ~ 8.5" x 14" |
| Media Types | Plain, Thick, Thin, Bond, Pre-printed, Recycled, Envelope, Transparency, Label, Cardstock, Cotton, Colored, Archive | Plain, Thick, Thin, Bond, Pre-printed, Recycled, Envelope, Transparency, Label, Cardstock, Cotton, Colored, Archive | Plain, Thick, Thin, Bond, Pre-printed, Recycled, Envelope, Transparency, Label, Cardstock, Cotton, Colored, Archive |
| Media Weight | 16-58 lb. | 16-58 lb. | 16-58 lb. |
| ADF Capacity | 50 Sheets | 50 Sheets | 50 Sheets |
| ADF Type | ADF | DADF | DADF |
| ADF Document Size | 5.6" x 5.8" ~ 8.5" x 14" | 5.6" x 5.8" ~ 8.5" x 14" | 5.6" x 5.8" ~ 8.5" x 14" |
| ADF Document Weights | 16-28 lb. | 16-28 lb. | 16-28 lb. |
| General | | | |
| Processor | 600 MHz | 600 MHz | 600 MHz |
| Memory | 256 MB (Max 512 MB) | 256 MB (Max 512 MB) | 256 MB (Max 512 MB) |
| Hard Drive | NA | N/A | 4 GB Flash Disk Drive |
| OS Compatibility | Windows (32/64 bit) XP/2003/Vista/2008/7/2008 R2, Mac OS X 10.5-10.8, Various Linux, Various Unix, Citrix Presentation Server, Windows Terminal Services | Windows (32/64 bit) XP/2003/Vista/2008/7/2008 R2, Mac OS X 10.5-10.8, Various Linux, Various Unix, Citrix Presentation Server, Windows Terminal Services | Windows (32/64 bit) XP/2003/Vista/2008/7/2008 R2, Mac OS X 10.5-10.8, Various Linux, Various Unix, Citrix Presentation Server, Windows Terminal Services |
| Interface | Hi-Speed USB 2.0, Ethernet 10/100 Base TX | Hi-Speed USB 2.0, Ethernet 10/100 Base TX, Wireless 802.11b/g/n, Wi-Fi Direct, Direct USB | Hi-Speed USB 2.0, Ethernet 10/100 Base TX, Direct USB |
| User Interface | 4-line LCD, 11 Status LEDs, Numeric Keypad, Function Keys, Soft Power | 4-line LCD, 11 Status LEDs, Numeric Keypad, Function Keys, Soft Power | 4-line LCD, 11 Status LEDs, Numeric Keypad, Function Keys, Soft Power |
| Monthly Duty Cycle | 50,000 pages per month | 80,000 pages per month | 100,000 pages per month |
| Noise Level | <57 dBA while Printing | <57 dBA while Printing | <57 dBA while Printing |
| Power Consumption | 700W Printing, 10W Ready, 1.1W Power Save, 1.7 kWh TEC | 700W Printing, 10W Ready, 1.6W Power Save, 2.1 kWh TEC | 700W Printing, 10W Ready, 1.1W Power Save, 2.0 kWh TEC |
| Unit Dimension (W x D x H) | 16.3" x 16.6" x 17.7" | 18.5" x 17.5" x 19.0" | 18.5" x 17.5" x 19.0" |
| Box Dimensions (W x D x H) | 21.2" x 21.0" x 24.6" | 23.3" x 21.5" x 26.0" | 23.3" x 21.5" x 26.0" |
| Unit Weight | 33.4 lbs. | 37.6 lbs. | 37.6 lbs. |
| Box Weight | 40.4 lbs. | 45.2 lbs. | 45.2 lbs. |
| Consumables | | | |
| Toner System | All-in-One Integrated Cartridge System | All-in-One Integrated Cartridge System | All-in-One Integrated Cartridge System |
| Toner | Starter Toner | Full Standard Toner 3,000 Page Yield | Full Standard Toner 3,000 Page Yield |
| | Toner Models and Yields | Standard 3,000 Page Yield (MLT-D203S) High Yield 5,000 Page Yield (MLT-D203L) | Standard 3,000 Page Yield (MLT-D203S) High Yield 5,000 Page Yield (MLT-D203L) Extra High Yield 10,000 Page Yield (MLT-D203E) |
| | Toner Metrics | Declared Cartridge Yield in Accordance with ISO/IEC 19752 | Declared Cartridge Yield in Accordance with ISO/IEC 19752 |
| Accessories | | | |
| Included | Power Cord, Fax Line Cable, Full Standard Yield Toner, Driver/Software CD with Digital User Manual, Warranty Card, Quick Installation Guide | Power Cord, Fax Line Cable, Full Standard Yield Toner, Driver/Software CD with Digital User Manual, Warranty Card, Quick Installation Guide, Hi-Speed USB 2.0 Cable | Power Cord, Fax Line Cable, Full Standard Yield Toner, Driver/Software CD with Digital User Manual, Warranty Card, Quick Installation Guide |

Follow us:  @SamsungBizUSA |  youtube.com/samsungbizusa

Product Support: 1-800-SAMSUNG | 1-866-SAM4BIZ | samsung.com/printer

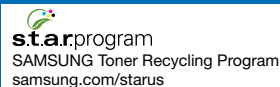

©2013 Samsung Electronics America, Inc. Samsung is a registered mark of Samsung Electronics Corp., Ltd. Specifications and designs are subject to change without notice. Non-metric weights and measurements are approximate. All other brand, product, service names and logos are trademarks and/or registered trademarks of their respective manufacturers and companies. Simulated screen images. See samsung.com for detailed information. Printed in USA on 50% recycled (30% post-consumer waste) paper using soy inks. PNT-M407038703370-JUN13T

