

Samsung Smart multiXpress X3280
Color laser print, copy, scan, fax MFP

SAMSUNG

Performance and savings you need,
reliability you can trust





Printing innovations for the way you do business

To stay ahead, it's critical that businesses avail themselves of every advantage at their disposal. Samsung is dedicated to providing those advantages, year after year.

With a focus on boosting productivity and efficiency through innovative technology, Samsung offers differentiated products and solutions. The multiXpress X3280 MFP is the latest in a long line of innovations designed to help SMBs maximize time and budget.

Combining touchscreen usability, printing flexibility and enterprise-level security, the multiXpress X3280 delivers it all with an eye toward cost-efficiencies. It's products like this that have led to our A4 laser printers earning the No. 2 position in global market share, while our A3 MFPs continue their strong growth.

As ways of doing business continue to evolve, Samsung will remain at the forefront of optimized solutions and services that advance business. As will our reseller partners and customers.

The multiXpress X3280 A3 color MFP offers reliability, combining usability and security with cost efficiencies



Samsung's X3280 A3 color multifunction printer (MFP) delivers exceptional business performance, reliability and savings for SMBs. Its fast 1GHz dual core processor, high scan speed and superior graphic quality keep you business-ready. Its 7" capacitive touchscreen (TSP) and NFC make printing smarter and easier, both in the office and on the go. Robust security and an industry-leading monthly duty cycle give top-notch reliability, and the X3280 delivers the performance of the higher-end X4300, but at a more budget-friendly price point.

For dealers, the X3280 offers an ideal business model. NFC helps effectively support customers' business mobility performance and Bring Your Own Device (BYOD) needs, with anywhere mobile printing. Quickly respond to customers' service requests using the Samsung Smart Printer Diagnostic System (SPDS) application to maintain reliable print operations. Most importantly, the Samsung X3280 shares service parts with the Samsung X4300 to help lower management and maintenance costs.

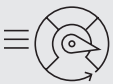

Boost productivity with fast, high-quality prints and scans

Faster printing speeds with a powerful 1GHz CPU

Crisper, clearer results with Samsung ReCP technology

Industry-best monthly duty cycle of up to 80,000 pages



Smart device management with more solutions on a highly sensitive touchscreen

Print from anywhere, share with anyone through the cloud

Tap-to-print NFC technology for secure printing through a mobile device

Easy-to-operate 7" touchscreen user interface



Keep your mind on business with enterprise-grade security and cost-efficiency

Peace of mind through enterprise-grade security and functionality

Cut operational costs through options and parts shared with the higher-end Samsung X4300 MFP

Simplify printer troubleshooting and maintenance with the Samsung SPDS app (Smart Printer Diagnostic System)

Boost productivity with fast, high-quality prints and scans

Fast, easy and flexible. The multiXpress X3280 MFP is powerful and intuitive. It's ready to work.

Faster printing speed with powerful CPU

The 1GHz dual core processor and 2GB memory guarantee faster printing, speedy scanning and enhanced productivity.



1.0 GHz

Up to 28 ppm

1GHz Dual-Core CPU
fast print speed

EXPENDITURES REPORT

Print from anywhere, share with anyone

Print documents on the go and share them with anyone. Save and share to the cloud without a PC or printer driver, with convenient mobile printing solutions such as Google Cloud Print™, AirPrint™, Mopria® and Samsung Cloud Print™.

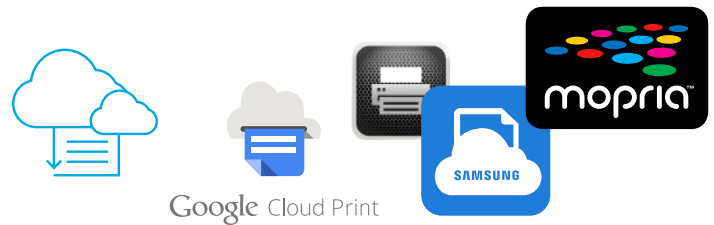

Google Cloud Print

SAMSUNG

mopria™

Crisper, clearer results with Samsung technology

Samsung's unique Rendering Engine for Clean Page (ReCP) technology improves the quality and vibrancy of your color printing by sharpening both graphics and text automatically.



ReCP

25 Mark

Tap-to-print NFC technology

Simply tap to print, scan or fax documents from any supported mobile device, with advanced NFC technology. The wireless option with Active NFC provides user authentication through a mobile device.



NFC Pro

Industry-best monthly duty cycle

With a best-in-class monthly duty cycle of up to 80,000 pages, the Samsung X3280 combines low operating expenses with reliable performance.



80K

Up to 80,000 pages

Easy-to-operate 7" touchscreen user interface

Operating a printer has never been easier with a 7" capacitive touchscreen for intuitive, smartphone-like usability.



Keep your mind on business with enterprise-grade security and cost-efficiency

With enterprise security and a cost-efficient platform, the multiXpress X3280 makes peace of mind a priority.

Peace of mind through enterprise-grade security and functionality

The Samsung X3280 offers industry-best control of user, document and network access at the enterprise security level. It supports authentication, print job protection, network security and protocols, and hard disk protection, while enabling administrators to manage the control panel and printing privileges.



Cut operational costs with shared options and parts

Enjoy cost-efficient printing operations by sharing options and service parts with the higher-end X4300. These options include the Inner Finisher, Punch Kit, Fax, Dual Cassette Feeder, Stand, Wireless/NFC, Developer Unit (Mono), Tray and Roller.



Many parts and options are compatible with the higher-end Samsung X4300

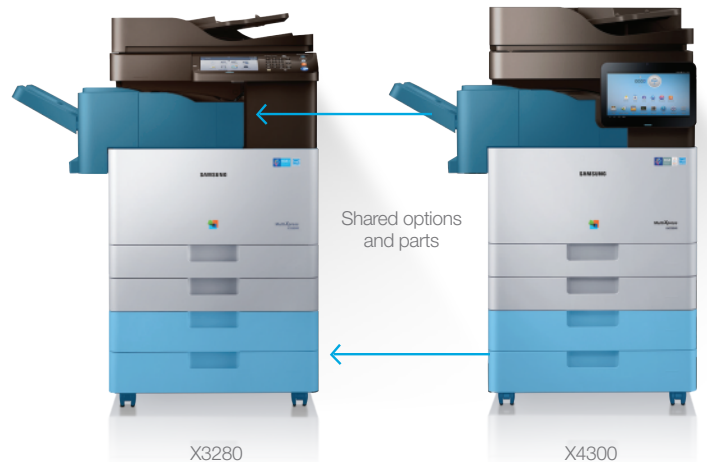

Simplify printer troubleshooting and maintenance with SPDS app

Keep your Samsung X3280 and your business up and running with the Samsung Smart Printer Diagnostic System app. This printer error diagnostic tool provides easy on-site servicing with easy-to-follow image and video manuals.

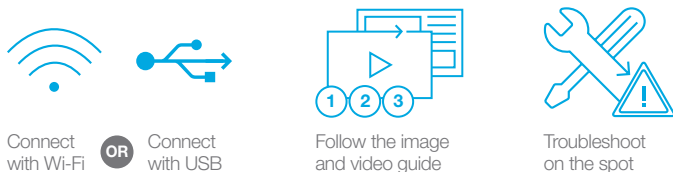

The versatile X3280 works at the speed of business

The multiXpress X3280 MFP can meet the needs of businesses of varying sizes, and in varying industries.

Configurations and options

Paper output options

Job Separator
SL-JSP500S

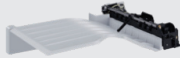

Inner Finisher
SL-FIN501L



Inner Finisher requires:

Punch Kit
(Inner - 2/3)
SL-HPU501T



Staples
(Inner - Booklet)
SCX-STP000

Paper input options

Cabinet
SL-DSK502T

CHOOSE ONE

**DCF Dual
Cassette
Feeder**
SL-PFP502D

OR



Accessories

FDI Kit
CLX-KIT10F



Fax Kit
SL-FAX160



NFC/Wireless
SL-NWE001X

- IEEE 802.11 b/g/n
- NFC (Active Type)







Specifications		X3280NR
General		
Processor	1 GHz / Dual Core	
Operational Panel	7" Color Touch-Panel LCD, 800 x 480 (WVGA)	
Memory	2 GB	
Hard Disk Drive	320 GB or Higher / User Available Space: 300 GB	
Interface Standard	High Speed USB 2.0 Device / Host, Ethernet 10/100/1000 BASE TX	
Interface Optional	IEEE 802.11 b/g/n + NFC Active Type	
Power Consumption	Max 1.75 kW (Ready: 60 Wh, Sleep: 1.5 W)	
Dimension	22.3" x 24.4" x 34.3"	
Max Dimension	22.3" x 24.4" x 44.5"	
Weight	181.44 lb.	
Max. Monthly Duty Cycle	80,000 Pages	
Network Security	SSL/TLS, IPsec, SNMPv3, Protocol & Port Management, IPv6, IP/MAC Filtering, IEEE 802.1x	
Print		
Speed (Mono)	28 ppm in A4 / Letter	
Speed (Color)	28 ppm in A4 / Letter	
Resolution	Default: 2,400 x 600 dpi Effective Output (600 x 600 x 2 bit) Max: 9,600 x 600 dpi Effective Output (600 x 600 x 4 bit), 1,200 x 1,200 dpi (Half Speed)	
Print Languages	PCL5e, PCL6, PostScript3, PDF V1.7	
Client OS Support	Windows®: Windows XP (32/64 bit) / Vista® (32/64 bit) / 2003 Server (32/64 bit) / 2008 Server (32/64 bit) / Win7 (32/64 bit) / 2008 Server R2 (64 bit) / Win8 (32/64 bit) / Win8.1 (32/64 bit) / 2012 Server (64 bit) / Linux®: Red Hat Enterprise Linux® 5, 6, 7 / Fedora 13, 14, 15, 16, 17, 18, 19, 20, 21 / OpenSUSE 11.3, 11.4, 12.1, 12.2, 12.3, 13.1, 13.2 / Ubuntu® 10.04, 10.10, 11.04, 11.10, 12.04, 12.10, 13.04, 13.10, 14.04, 14.10 / SuSE Linux Enterprise Desktop 11, 12 / Debian™ 6, 7 / Mint 13, 14, 15, 16, 17 Unix: Sun Solaris 9, 10, 11 (x86, SPARC) / HP-UX 11.0, 11i v1, 11i v2, 11i v3 (PA-RISC, Itanium) / IBM AIX 5.1, 5.2, 5.3, 5.4, 6.1, 7.1 (PowerPC) Mac OS®: 10.6 - 10.10	
Network Protocols	IP Management (DHCP, BOOTP, AutoIP, SetIP, Static), Discovery Protocol (SLP, UPnP, Bonjour, DNS, WINS), Printing Protocol (TCP/IP, LPR, IPP, WSD), Management Protocol (SNMPv1.2, SNMP3, POP3, SMTP, Telnet), Scan Protocol (SMTP, FTP, SMB, WSD), Security Protocol (SMB, Kerberos, LDAP, IPsec, EAP)	
Copy		
Speed	Up to 28 / 28 ipm in A4 / Letter	
First Copy Out Time	Less than 6.2 / 7.6 sec	
Resolution (Platen / DADF)	Scan: 600 x 600 dpi / Printing: 600 x 600 dpi	
Reduce & Enlarge	25% - 400% (Platen Copy)	
Multi Copy	1 - 9,999 pages	
Duplex Copy	Built-in	
Copy Features	ID Copy, N-up, Booklet, Image Repeat, Auto Fit, Book Copy, Poster Copy, Watermark, Image Overlay, Stamp, Covers, Job Build, Preview, Erase Edge, Image Shift, Image Adjustment, Background Adjustment	
Scan		
Speed Mono	45 ipm (300 dpi / A4 / Letter)	
Speed Color	45 ipm (300 dpi / A4 / Letter)	
Compatibility	Network TWAIN, Network SANE	
Resolution Optical	600 x 600 dpi	
Resolution Enhanced	4,800 x 4,800 dpi	
Scan Destinations	Email, FTP, SMB, HDD, DFS, USB, WSD, PC	
Fax		
Compatibility	ITU-T G3, Super G3	
Modem Speed	33.6 kbps	
Resolution	Mono: 600 x 600 dpi	
Fax Features	Speed Dial, Group Dial, On-hook Dial, Auto Redial, Caller ID, Secure Reception, Fax Forwarding	
Paper Handling		
Input Capacity Cassette	1,040 Sheets	
Input Capacity Maximum	2,180 Sheets (1,140-Sheets Standard + 1,040-Sheets Optional DCF)	
Input Capacity Multipurpose Tray	100 Sheets	
Input Capacity Other Options	520-Sheets Optional Cassette x 2	
Media Type Cassette	Plain Paper, Thin Paper, Bond, Punched, Pre-Printed, Recycled, Label, Cardstock, Letterhead, Thick, Cotton, Colored, Archive, Thin Glossy, Heavy Weight, Extra Heavy Weight	
Media Type Multipurpose Tray	Plain, Thin, Bond, Hole Punched, Pre-Printed, Recycled, Label, Thin Cardstock, Letterhead, Thick, Cotton, Colored, Archive, Thin Glossy, Heavy Weight, Envelope	
Media Type Other Options	Plain Paper, Thin Paper, Bond, Punched, Pre-Printed, Recycled, Label, Cardstock, Letterhead, Thick, Cotton, Colored, Archive, Thin Glossy, Heavy Weight, Extra Heavy Weight	
Media Size Cassette	Cassette 1: 148 x 210 mm - 297 x 354 mm (5.8" x 8.2" - 11.7" x 14") Cassette 2: 148 x 210 mm - 297 x 432 mm (5.8" x 8.2" - 11.7" x 17")	
Media Size Multipurpose Tray	98 x 148 mm - 297 x 432 mm (3.8" x 5.8" - 11.7" x 17")	
Media Size Other Options	148 x 210 mm - 297 x 432 mm (5.8" x 8.2" - 11.7" x 17")	
Media Weights Cassette	Plain Paper: 70 - 90 g/m ² (18.5 - 24 lb/Dupl), Thick Paper: 91 - 105 g/m ² (25 - 28 lb/Dupl), Heavy Weight Paper: 106 - 176g/m ² (Dupl), Extra Heavy Weight 1 Paper: 177 - 220 g/m ² , Thin Paper: 60 - 69 g/m ² (16 - 19 lb/Dupl), Cotton paper: 75 - 90 g/m ² (Dupl), Colored: 75 - 90 g/m ² (Dupl), Pre-Printed: 75 - 90 g/m ² (Dupl), Recycled: 60 - 90 g/m ² (Dupl), Bond Paper: 105 - 120 g/m ² (Dupl), Letterhead: 75 - 90 g/m ² (Dupl), Hole Punched Paper: 75 - 90 g/m ² (Dupl), Thin CardStock: 106 - 163 g/m ² (Dupl), Thin Glossy: 106 - 163 g/m ² (Duplex)	
Media Weights Multipurpose Tray	Simplex, Duplex: 16 - 47 lb (60 to 176 g/m ²), Envelope: 75 - 90 g/m ² , Label: 120 - 150 g/m ² (Simplex)	
Media Weights Other Options	Plain Paper: 70 - 90 g/m ² (18.5 - 24 lb/Dupl), Thick Paper: 91 - 105 g/m ² (25 - 28 lb/Dupl), Heavy Weight Paper: 106 - 176 g/m ² (Dupl), Extra Heavy Weight 1 Paper: 177 - 220 g/m ² , Thin Paper: 60 - 69 g/m ² (16 - 19 lb/Dupl), Cotton Paper: 75 - 90 g/m ² (Dupl), Colored: 75 - 90 g/m ² (Dupl), Pre-Printed: 75 - 90 g/m ² (Dupl), Recycled: 60 - 90 g/m ² (Dupl), Bond Paper: 105 - 120 g/m ² (Dupl), Letterhead: 75 - 90 g/m ² (Dupl), Hole Punched Paper: 75 - 90 g/m ² (Dupl), Thin CardStock: 106 - 163 g/m ² (Dupl), Thin Glossy: 106 - 163 g/m ² (Duplex)	
Options		
	Inner Finisher, Job Separator, Cabinet Stand, Dual Cassette Feeder, Fax Kit, FDI Kit, Wireless / NFC Kit	
Consumables		
Toner Capacity	CLT-C804S, CLT-M804S, CLT-Y804S (CMY) - 15,000 Pages / CLT-K804S (K) - 20,000 Pages (5% Coverage)*	
Imaging Unit / Drum	CLT-R804 (CMY) - 50,000 Pages / CLT-R804 (K) - 50,000 Pages*	
Waste Toner Container	CLT-W808 - Approx. 33,700 Pages (5% Coverage)*	

*Declared cartridge yield in accordance with ISO/IEC 19752

Product support: 1-866-SAM4BIZ 1-800-SAMSUNG

For complete product information and accessories, visit samsung.com/business,
samsung.com/us/printersolutions, insights.samsung.com or samsung.com/b2bprinters

Follow us:  [youtube.com/samsungbizusa](https://www.youtube.com/samsungbizusa)  [@SamsungBizUSA](https://twitter.com/SamsungBizUSA)

SAMSUNG

©2017 Samsung Electronics America, Inc. Samsung is a registered mark of Samsung Electronics Corp., Ltd. Specifications and designs are subject to change without notice. Non-metric weights and measurements are approximate. All brand, product, service names and logos are trademarks and/or registered trademarks of their respective manufacturers and companies. Simulated screen images. See samsung.com for detailed information. Printed in the USA on 50% recycled (10% post-consumer waste) paper using soy inks.

PNT-X3280COLRBRO-MAR17T

