

| | |
|---------------|-------------|
| 28" Class LED | HG28NE473AF |
| 32" Class LED | HG32NE473SF |
| 43" Class LED | HG43NE593SF |



Every patient should be safe, comfortable and well-entertained



NE Series Hospitality TVs

LED TVs designed specifically for today's healthcare industry

Entertainment is the ultimate bedside manner, and the global leader in flat-panel technology delivers. Offering the most advanced TV solutions for the healthcare industry, Samsung's NE Series TVs have been manufactured with hospital-specific features, such as an interchangeable pillow speaker interface and compatibility with many interactive patient education systems. Patients enjoy stunning Samsung picture quality, while you enjoy cost savings from LED technology that uses up to 50% less energy. Pro:Idiom™ decoding gives patients an expanded lineup of HD channels. Facility managers benefit from the side-mounted USB ports for convenient set-up and the on-site warranty program. And Samsung's REACH 4.0 management solution makes content management simple. It's the platform that makes everyone feel better.

Key features



UL-Listed for hospital use

Samsung NE Series televisions are specifically engineered to meet the stringent requirements for use in hospital environments.



Universal pillow speaker interface

An easy-to-use interface for multiple styles of pillow speakers is built right into the TV. This eliminates the hassle of lost remotes and changing batteries.



Samsung LYNK™ REACH 4.0 content management solution

Samsung's LYNK REACH 4.0 fuses the benefits of SINC and REACH hospitality technologies to offer a comprehensive content management solution. As a unified content management solution, LYNK REACH 4.0 accommodates LAN, WiFi and coaxial infrastructures to amplify hotel management, monitoring and guest service functions. Transferred by proprietary management server (PMS) and customized templates, hospitality users can create and deliver personalized service for a more memorable experience. This includes access to a range of IP channels and RF channels, applications and services mirroring what guests expect at home and on their mobile devices. LYNK REACH 4.0 additionally enables two-way communication between hotel management and guests. The solution's efficient remote control capability for in-room display ensures quality service delivery in real time without in-room labor and maintenance.



SMART TV offers interactive patient engagement systems (593 model)

SMART TV offers advanced interactive patient engagement systems, which aid in providing maximum patient satisfaction and superior levels of service. The systems deliver on-demand, condition-specific educational content, hospital information, analytics, surveys, service recovery features and more to the patient's bedside. Customizable user interfaces are offered by healthcare system integrators.

Hospitality TV sales:

1-888-727-2664 | 1-866-SAM4BIZ

samsung.com/business

samsung.com/b2bhospitalitytvs

Follow us

[youtube.com/samsungbizusa](https://www.youtube.com/samsungbizusa)

@SamsungBizUSA

Samsung Healthcare Series Hospitality TVs

Samsung Hospitality TVs are loaded with features that provide premier patient satisfaction, while making your job easier.

Healthcare Features

Channel remapping

The Channel Editor lets you edit the channels stored in the TV's memory. Using Channel Editor, you can change the channel numbers and names, and sort the channels in your desired channel number order. You can also apply the video mute to channels you select. The video mute blanks out the video from a channel and outputs only the sound while displaying a speaker icon on the screen.

Channel Bank Editor

The Channel Bank Editor lets you control the channels the patients (or the guest) have access to. The Channel Bank Editor provides three banks of channels and lets you select which channels will be available from each bank. You can control access to channels by setting the item of Channel Bank Service Level in Hospitality Option Menu.

Clock on timer and alarm key

Allows the guest to program the TV to turn on as a wake-up alarm.

Closed captioning

A text display of all audio content, including spoken dialog and non-speech information such as the identity of the speakers and symbols for sound effects and music.

Hospital channel list

Guest master channel listing of program content. This will display content in analog or HD.

Hospital logo display with time out setting

Display hospital logo bitmap files as a greeting startup display.

Hospital mode plug & play

Interactive stand-alone mode available.

Lockout controls

The hospital manager can enable front panel and menu display lock-outs.

OSD language

Choose English/French/Spanish.

Picture-in-picture

Display one program while another is being displayed on the full TV screen at the same time.

Power on status setting

Settings include power always on, last option or standby.

Multi-code remote

Eliminates interference when two or more TVs are used in close proximity to each other.

Samsung LYNK™ REACH 4.0 content management solution

Samsung's LYNK REACH 4.0 fuses the benefits of its SINC and REACH hospitality technologies to offer a comprehensive content management solution. LYNK REACH 4.0 enhances the guest experience with efficiency-enhancing technology and perks ranging from more information delivery channels to convenient communication options and efficient room management. As a unified content management solution, LYNK REACH 4.0 accommodates LAN, WIFI and coaxial infrastructures to amplify hotel management, monitoring and guest service functions. Transferred by proprietary management server (PMS) and customized templates, hospitality users can create and deliver personalized service for a more memorable experience. This includes access to a range of IP channels and RF channels, applications and services mirroring what guests expect at home and on their mobile devices. LYNK REACH 4.0 additionally enables two-way communication between hotel management and guests. The solution's efficient remote control capability for in-room display ensures quality service delivery in real time without in-room labor and maintenance.

Sleep timer

Allows patient to set TV turn-off time in 30-minute intervals up to 180 minutes.

USB cloning

A quick and easy way to copy the ideal settings off one television to others in the facility. Saves time and helps provide a consistent viewing experience for all televisions.

Connections

Samsung Smart View (593 model only)

View digital content from any of your DLNA-connected Samsung devices. Samsung Smart View lets you wirelessly access and share content between your Samsung devices regardless of where you are. And there's no need for any cables or connected devices. It's also equipped with cloud technology, so you can upload content to a central web storage account and access it wherever you are.

ConnectShare™ (USB 2.0)

Connect a thumb drive or digital camera quickly and easily. User-friendly interface allows access to videos, a music playlist and pictures via the remote.

Hospital TV (RJ-12/IR pass through)

Allows you to connect an interactive STB/SBB (Set Top Box/Set Back Box).

Hospital TV RJ45 (593 model only)

Connection to hospital LAN using custom H-browser or Samsung LYNK™ SINC.

Interactive compatibility system



Remote Jack Panel (RJP) compatibility



WiFi® (593 model only)

With built-in WiFi, no additional equipment is needed to connect with an existing wireless router in your hospital network and start accessing Samsung Apps or other Smart TV features.

Picture Quality and Audio

Auto volume limiter

During initial product setup, minimum and maximum volume levels can be locked to help minimize disturbance to other hospital patients.

Dual core processor (593 model only)

Dual Core makes multitasking fast. Browse the web faster and quickly. Hospital personnel can easily download apps to the TV.

Full HD 1080p, MPEG4

The Samsung 593 model TV features 1920 x 1080 Full HD resolution, while the 473 models feature 1366 x 768 HD resolution. All TVs are compatible with MPEG4.

Music mode (input: HDMI/PC/AV/component)

Allows audio feedback when picture is muted.

Music mode backlight on/off

Shows a background display.

Slim direct-lit LED technology

Direct-lit LED technology provides the brilliance and energy savings advantages of LED technology, along with the uniform brightness typical of CCFL displays. And it does it all with an efficiency that makes it a more affordable technology. In fact, it's possible to upgrade your rooms to LED technology for a cost comparable to CCFL technology. When you add the energy savings of up to 50% that LED offers over CCFL, you end up with the perfect solution for both you and your patients.

Warranty

2-year parts and 2-year labor warranty backed by Samsung Healthcare Hotline 1-866-894-0524. Optional professional installation, accessories and extended warranty are available.

Samsung Healthcare Series TVs



Digital Rights Management (DRM)

Samsung LYNK™ HD Content decryption DRM 

Samsung's software-based DRM technology is integrated into the entire Samsung Hospitality TV line. Samsung LYNK™ offers a robust solution to unlock premium HDTV content from content providers such as cable, satellite and VOD providers, with maximum efficiency and security.

Samsung LYNK™ HD Content Decryption (IP/RF) DRM  (593 model only)

Samsung's software-based DRM technology is integrated into the Samsung Hospitality TV line. Samsung LYNK offers a robust solution to unlock premium HDTV content from content providers such as cable, satellite and VOD providers, with maximum efficiency and security. IPTV-IP LYNK available with REACH 4.0 and H-Browser.

Verimatrix™ HD Content Decryption DRM (IP)  (593 model only)

IPTV-IP Multicast DRM is used in conjunction with Samsung LYNK™ REACH 4.0. In-viewing IPTV channel offers reliable access to unlock premium HDTV content from content providers such as cable and satellite providers. IPTV-IP LINK available with REACH 4.0 and H-Browser 3.0.

Dimensions

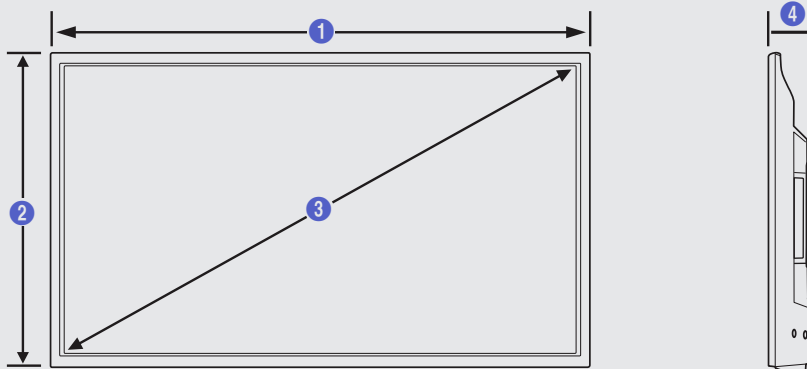

28" | HG28NE473AF - 720p | Mega Dynamic Contrast Ratio

| | | | |
|---|---|---|---|
|  |  |  |  |
| 25.3" | 15.6" | 28" | 2.5" |

32" | HG32NE473SF - 720p | Mega Dynamic Contrast Ratio

| | | | |
|---|---|---|---|
|  |  |  |  |
| 29.3" | 17.4" | 31.5" | 2.7" |

43" | HG43NE593SF - 1080p | Mega Dynamic Contrast Ratio

| | | | |
|---|---|---|---|
|  |  |  |  |
| 38.8" | 22.6" | 43.0" | 2.8" |

Connectivity

HG28NE473AF

1. USB (5C 0.5A) / Cloning
2. HDMI In 1 (DVI)
3. AV In (Video, Audio L/R)
4. Pillow Out
5. HDMI In 2 (Arc)
6. Audio Out
7. Ex-Link
8. Data
9. Ant In (Air / Cable)

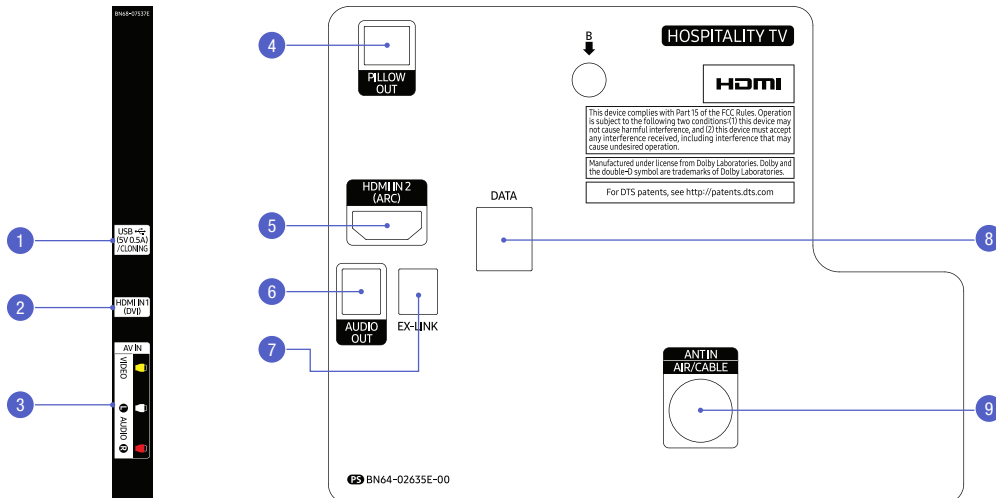

HG32NE473SF

1. AV In
2. USB (5C 0.5A) / Cloning
3. HDMI In 1 (DVI)
4. Antenna In
5. Pillow Out
6. Ex-Link
7. Audio Out
8. HDMI In 2 (ARC)
9. Data

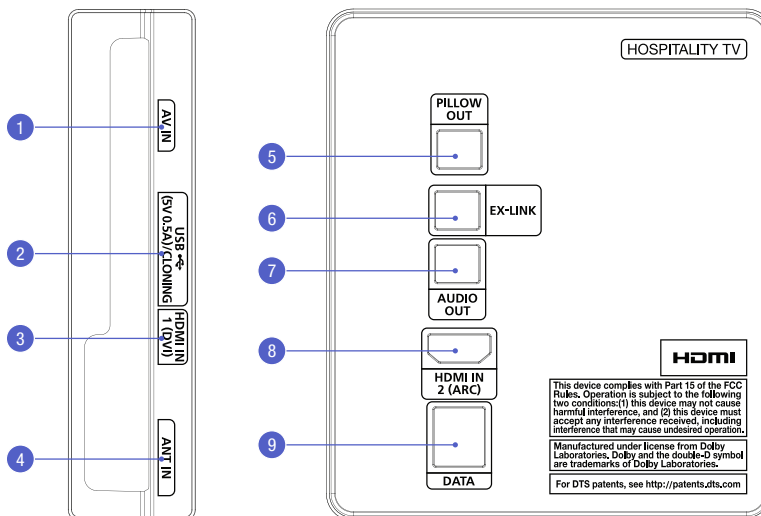

HG43NE593SF

1. USB (5V 0.5A)
2. USB (HDD 1.0A) / Cloning
3. HDMI In 1
4. LAN
5. Antenna In (Air / Cable)
6. HDMI In 3
7. HDMI In 2 (ARC)
8. Digital Audio Out (Optical)
9. Data
10. DVI Audio In
11. Audio Out
12. Ex-Link
13. Component / AV In 1
14. Pillow Out

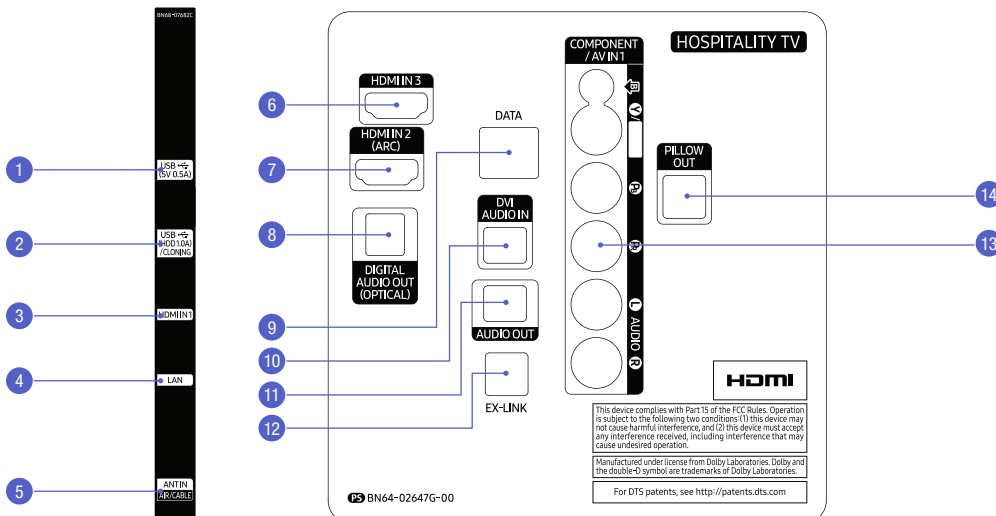

Samsung Healthcare Series Hospitality TVs

Samsung Healthcare Series Hospitality TVs Key Specifications For complete product specifications, visit samsung.com/b2bhospitalitytvs

| | | HG28NE473AF | HG32NE473SF | HG43NE593SF |
|----------------------|--|-------------------------------|-------------------------------|---------------------------------------|
| Display | Backlight | LED | LED | LED |
| | Screen Size (Diagonal) | 28" | 32" (31.5") | 43" (42.5") |
| | HD/FHD/UHD | HD | HD | FHD |
| | Resolution | 1366 x 768 | 1366 x 768 | 1920 x 1080 |
| | Brightness (nits) | 250 | 250 | 300 |
| Video | Picture Engine | HyperReal | HyperReal | HyperReal |
| | Contrast Ratio | Mega Dynamic | Mega Dynamic | Mega Dynamic |
| | Wide Color Enhancer (Plus) | Yes | Yes | Yes |
| | Film Mode | Yes | Yes | Yes |
| Audio | Dolby Digital Plus | Yes | Yes | Yes |
| | DTS Studio Sound | Yes | Yes | Yes |
| | DTS Premium Sound / DTS Premium Sound 5.1 | Yes | Yes | Yes |
| | Auto Volume Leveler | Yes | Yes | Yes |
| | Virtual Surround | N/A | N/A | Yes |
| | Sound Output (RMS) | 10W (L:5W, R:5W) | 10W (L:5W, R:5W) | 20W (L:10W, R:10W) |
| | Speaker Type | 2CH Down Firing w/Bass Reflex | 2CH Down Firing w/Bass Reflex | 2CH Down Firing w/Bass Reflex |
| | Variable Speaker Output | 4W (Mono, 8Ω) | 4W (Mono, 8Ω) | 4W (Mono, 8Ω) |
| | Wall Mount Sound Mode | Yes | Yes | Yes |
| SMART TV | Smart TV Type | Non Smart | Non Smart | Smart |
| | Apps Panel | N/A | N/A | Yes |
| | Web Browser | N/A | N/A | Yes |
| VESA Standard | VESA Wall Mount (mm / in.) | 100 x 100 / 3.9" x 3.9" | 200 x 200 / 7.87" x 7.87" | 200 x 200 / 7.87" x 7.87" |
| | VESA Screw Size | M4 | M8 | M8 |
| Convergence | Mobile to TV - Mirroring, DLNA | N/A | N/A | Yes |
| | Samsung SMART View | N/A | N/A | Yes |
| Features | Accessibility | Voice Guide | Voice Guide | Voice Guide / Enlarge / High Contrast |
| | Smart Hub | No | No | Yes |
| | Processor | N/A | N/A | Quad Core |
| | Samsung Smart View | No | No | Yes |
| | ConnectShare™ (HDD) | N/A | N/A | Yes |
| | ConnectShare™ (USB 2.0) | Yes | Yes | Yes |
| | Wake On LAN | N/A | N/A | Yes |
| | Soft AP | No | No | Yes |
| | USB HID Support | N/A | N/A | Yes |
| | OSD Language | English, Spanish, French | English, Spanish, French | English, Spanish, French |
| | Digital Clean View | Yes | Yes | Yes |
| | HDMI 1.4 A / Return Ch. Support (ARC) | Yes | Yes | Yes |
| | Auto Channel Search | Yes | Yes | Yes |
| | Auto Power Off | Yes | Yes | Yes |
| | EPG | Yes | Yes | Yes |
| | Caption (Subtitle) | Yes | Yes | Yes |
| | Game Mode | Yes | Yes | Yes |
| | Sports Mode | Yes | Yes | Yes |
| | Picture-In-Picture | Yes | Yes | Yes |
| | Sleep Timer | Yes | Yes | Yes |
| System | Digital Broadcasting | ATSC/Clear QAM | ATSC/Clear QAM | ATSC/Clear QAM |
| | Analog Tuner | Yes | Yes | Yes |
| Hospitality Features | Samsung LYNK™ REACH Server Compatibility | Yes | Yes | Yes |
| | H. Browser | N/A | N/A | Yes |
| | Samsung LYNK™ REACH (IP) | N/A | N/A | REACH 4.0 |
| | Samsung LYNK™ REACH (RF) | REACH 4.0 | REACH 4.0 | REACH 4.0 |
| | Samsung LYNK™ REACH RF-Modulator Compatibility | Yes | Yes | Yes |
| | Samsung LYNK™ DRM | Yes | Yes | Yes |
| | Hospitality Home Menu | Home Menu 2015 | Home Menu 2015 | Home Menu 2015 |
| | Hospitality Plug&Play (Easy Setup) | Yes | Yes | Yes |
| | Auto Source Mode | Yes | Yes | Yes |
| | Power On Mode | Yes | Yes | Yes |
| | Hotel Channel List | Yes | Yes | Yes |
| | Channel Menu Display | Yes | Yes | Yes |
| | Mixed Channel List (ATSC, DVB-T/T2/C/S2, Analog) | Yes | Yes | Yes |
| | My Channel | N/A | N/A | Yes |
| | Energy Saving Mode (BLU Control) | Yes | Yes | Yes |
| | Logo Display with Timer Out Setting (BMP/Movie) | Yes | Yes | Yes |
| | Welcome Message | Yes | Yes | Yes |
| | RJ12/IR Pass Through | Yes | Yes | Yes |
| | Clock Back Up Power Supply | Yes | Yes | Yes |
| | Software Clock | Yes | Yes | Yes |
| | Multi Code Remote Control | Yes | Yes | Yes |
| | Screwed Battery Cover | N/A | N/A | Yes |
| | Sound Bar Compatibility | Yes | Yes | Yes |
| | Music Mode (Input: PC/AV/Component/HDMI) | Yes | Yes | Yes |
| | Music Mode Backlight On/Off | Yes | Yes | Yes |
| | USB Cloning | Yes | Yes | Yes |
| | Smovie Compatibility | Yes | Yes | Yes |
| | On/Off Timer (Schedule) | Yes | Yes | Yes |
| | Wake-up Timer (Alarm) | Yes | Yes | Yes |
| | Pro:Idiom | Yes | Yes | Yes |
| | Security Mode | Yes | Yes | Yes |
| | S/W EPG (Solution EPG) | Yes | Yes | Yes |

Samsung Healthcare Series Hospitality TVs

Samsung Healthcare Series Hospitality TVs Key Specifications For complete product specifications, visit samsung.com/b2bhospitalitytvs

| | | HG28NE473AF | HG32NE473SF | HG43NE593SF |
|-----------------------------|--|--|--|---|
| Input & Output | HDMI | 1/1 | 1/1 | 1/2 |
| | USB | 1/0 | 1/0 | 2/0 |
| | Component In (Y/Pb/Pr) | N/A | N/A | 0/1 |
| | Composite In (AV) | 1/0 | 1/0 | 0/1 (Common Use for Component Y) |
| | Ethernet (LAN) | N/A | N/A | 1/0 |
| | Audio Out (Mini Jack / LR) | 0/1 | 0/1 | 0/1 |
| | Digital Audio Out (Optical) | N/A | N/A | 0/1 |
| | RF In (Terrestrial / Cable input / Satellite Input) | 0/1 | 1/0 | 1/0 |
| | Ex-Link (RS232C) | Common (RJP) | Common (RJP) | Common (RJP) |
| | HDMI A / Return Ch. Support | Yes | Yes | Yes |
| | Wireless LAN Built-in | N/A | N/A | Yes |
| | Anynet+ (HDMI-CEC) | Yes | Yes | Yes |
| | Pillow Speaker Jack | 0/1 | 0/1 | 0/1 |
| | RJ12 | 0/1 | 0/1 | 0/1 |
| | RJP Jack (Remote Jackpack) | 0/1 | 0/1 | 0/1 |
| PC/DVI Audio In (Mini Jack) | N/A | N/A | Yes | |
| Design | Front Color | Black | Black | Black |
| Dimensions (W x H x D) | Set Size without Stand - Wall Mount Side (WxHxD) (mm/in) | 643.4 x 396.5 x 49.1 / 25.3" x 15.6" x 1.9" | 745.4 x 442.2 x 57.9 / 29.4" x 17.4" x 2.3" | 985.5 x 575.3 x 58.8 / 38.8" x 22.7" x 2.3" |
| | Set Size without Stand - Speaker Side (WxHxD) (mm/in) | 643.4 x 396.5 x 62.9 / 25.3" x 15.6" x 2.5" | 745.4 x 442.2 x 69.0 / 29.4" x 17.4" x 2.7" | 985.5 x 575.3 x 72.2 / 38.8" x 22.7" x 2.8" |
| | Package Size (WxHxD) (mm/inch) | 815.0 x 463.0 x 108.0 / 32.1" x 18.2" x 4.3" | 808.0 x 507.0 x 127.0 / 31.8" x 20.0" x 5.0" | 1162.0 x 646.0 x 143.0 / 45.7" x 25.4" x 5.6" |
| Weight | Set Weight without Stand (kg / lbs.) | 3.8 kg / 8.4 lbs. | 4.1 kg / 9.0 lbs. | 7.7 kg / 17.0 lbs. |
| | Package Weight (kg / lbs) | 5.1 kg / 11.2 lbs. | 5.7 kg / 12.6 lbs. | 9.9 kg / 21.8 lbs. |
| Power | Power Supply (V) | AC110-120V 60Hz | AC110-120V 60Hz | AC110-120V 60Hz |
| | Power Consumption (Max) (W) | 42 | 50 | 110 |
| | Power Consumption (Stand-by) (W) | 1 | 1 | 1 |
| | Power Consumption (Typical) | 32 | 32 | 60 |
| Accessory | VESA Wall Mount Support | Yes | Yes | Yes |
| | Mini Wall Mount Support | No | Yes | No |
| | Power Cable | Yes | Yes | Yes |
| | Quick Install Guide | Yes | Yes | Yes |



Learn more

samsung.com/business insights.samsung.com samsung.com/b2bhospitalitytvs

Product support

1-866-SAM4BIZ

Follow us

[youtube.com/samsungbizusa](https://www.youtube.com/samsungbizusa) [@SamsungBizUSA](https://twitter.com/SamsungBizUSA)

SAMSUNG