

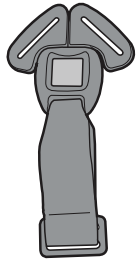

# Argos® Buckle Replacement Guide

©2013 Graco PD253499A 6/13

## To Remove Existing Harness Tongues and Buckle and Attach Replacement Buckle



1

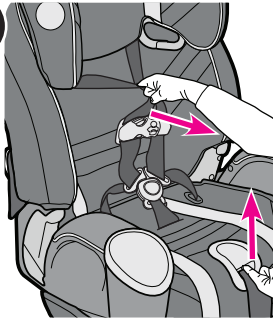

To loosen straps, lift lever and pull harness straps.

2

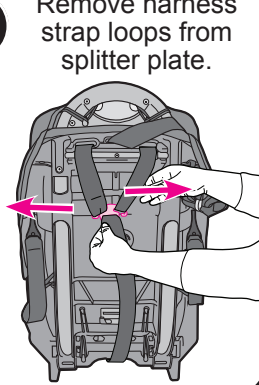

Remove harness strap loops from splitter plate.

3

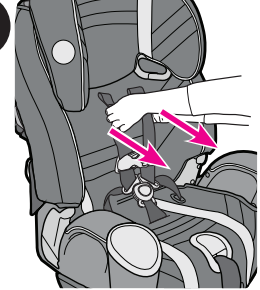

Pull harness straps through seat back and seat pad.

4

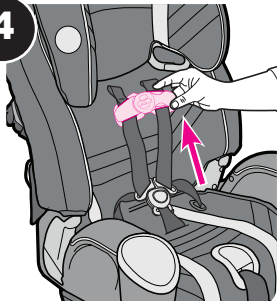

Remove chest clip. **DO NOT DISCARD** the chest clip.

5

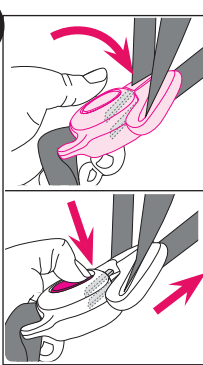

Unbuckle harness by tilting top of buckle down, press top of red button, and pull tongues out of buckle.

6

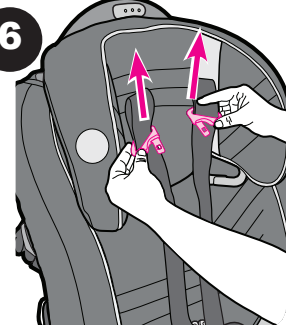

Remove and discard tongues.

7

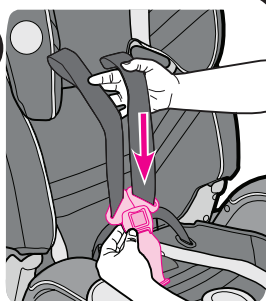

Slide **NEW** buckle onto harness straps. **MAKE** sure not to twist straps.

8



Re-attach chest clip. **MAKE** sure not to twist straps.

9

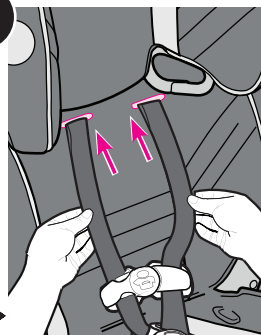

Re-insert straps through slots in seat pad and seat back.

10

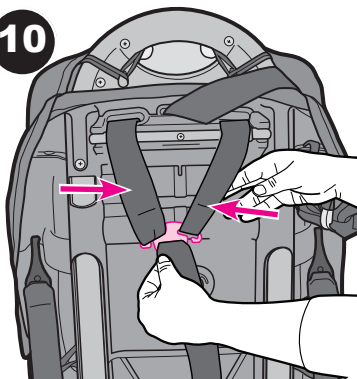

Route harness straps **OVER** metal bar and re-insert straps back onto splitter plate.

Turn page over to finish the rest of the assembly Steps 11 to 20 for the buckle replacement.

**11**

Remove elastic loops from sides of seat as shown.

**12**

Remove elastic loops from back of seat as shown.

**13**

**UNDERSIDE OF SEAT**

Pull seat pad forward and remove buckle from pad. From bottom of seat push metal retainer up and discard buckle.

**14**

Push button and remove tongues from the NEW buckle.

**15**

**UNDERSIDE OF SEAT**

Insert metal retainer from NEW buckle into croch slot in the seat bottom as shown.

**16**

Re-insert buckle through slot in seat pad and pull up on buckle to be sure it is secured in the slot.

**17**

Push seat pad back into seating area until the elastic straps come out the back then re-attach to hooks as shown.

**18**

Re-attach elastic loops on sides of seat as shown.

**19**

**CLICK!**

Insert NEW tongues into buckle.

**20**

**FINAL CHECK :**

- Tug on the buckle to be sure it is properly secured in the bottom of the seat and does not come out.
- **MAKE SURE** the harness straps are not twisted.
- Make sure the chest clip is properly threaded as shown in Step 8.

Any questions please contact us at :

**Graco Children's Products**  
 3 Glenlake Parkway Atlanta, GA 30328  
 1-800-345-4109 [www.gracobaby.com](http://www.gracobaby.com)