

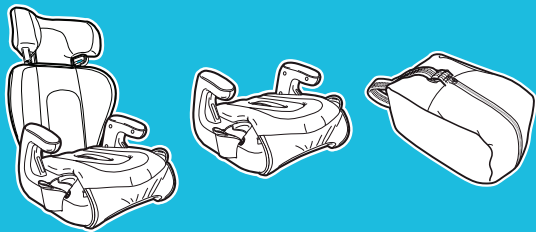

TurboBooster® TakeAlong™

Read This Instruction Manual



Do not install or use this child restraint until you read and understand the instructions in this manual.

FAILURE TO PROPERLY USE THIS CHILD RESTRAINT INCREASES THE RISK OF SERIOUS INJURY OR DEATH IN A SUDDEN STOP OR CRASH.

1 Important

Pages 5-19

1-A Quick Guide to Your Manual

1-B Welcome to the Graco Family

1-C Before You Begin

Register This Car Seat

If You Need Help

Certification

Car Seat's Useful Life

Vehicle Seat Protection

Warm Weather Use

1-D Safety Warnings

2 Features

Pages 20-21

2-A Car Seat Features

3 Booster

Pages 22-25

3-A Booster Use

3-B Install Backed Booster

3-C Install Backless Booster

4 Securing Child

Pages 26-35

4-A Securing Child Backed Booster

4-B Securing Child Backless Booster

5 Accessories

Page 36

6 Vehicle Information

Pages 37-40

6-A Choosing Vehicle Seat Location

6-B Unsafe Vehicle Seat Location

6-C Vehicle Seat Belts

7 Care and Cleaning

Page 41

8 Fold and Carry Feature

Pages 45-46

1-A Quick Guide to Your Manual

This car seat is for children: Booster: 40-100 lb (18.1-45 kg) 43-57 in. (110.1-145 cm)

Car Seat Assembly (On Select Models)

Adult Assembly Required

1. Open the Seat Base

To open the seat base, grab both arm rests and pull apart. You will hear a “click” when it is fully opened and locked. Push down on the center of the base to make sure it is locked.

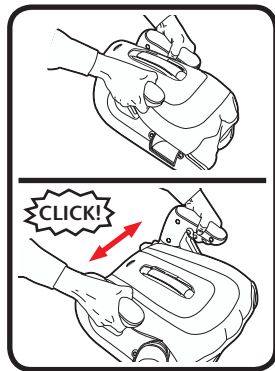

1 Important



1 Important

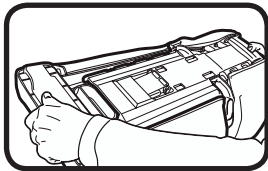
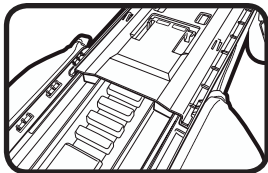
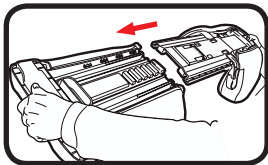

2. Attach Headrest to Backrest

With the back side up, align the bottom of the headrest with the grooves on the backrest. Squeeze the headrest adjustment lever and slide the two pieces together.

Check to make sure they are attached by trying to pull them apart.

3. *Headrest pad*

With the headrest in the upper most position, flip seat over and insert the fabric from the headrest underneath the fabric on the lower backrest as shown.

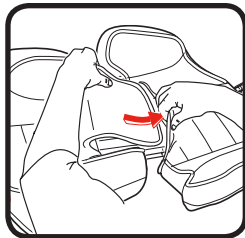

i 1 Important

4. *Attach Backrest to Base*

With the base completely open, attach the backrest by inserting the seat back connectors into the backrest. Push on one side until you hear a click, then the other until you hear it click.

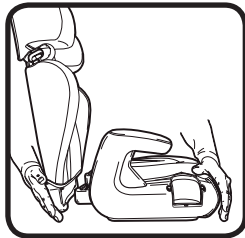
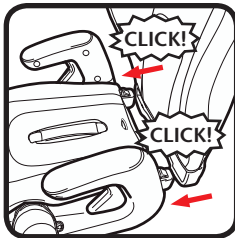



1 Important



Your Graco Booster Seat is Now Ready To Use

Get to Know Your Car Seat

Review section 2-A to see all of the features of this booster seat.

What Seating Location Should I Use?

The best seating location for this booster seat is one that:

- Is recommended by your vehicle owner's manual, and
- Results in a secure installation of this booster seat.

Some vehicles have specific requirements for where the booster seat can be installed, so be sure to check your vehicle owner's manual for available seating positions, if any. For example, sometimes the center rear seat has a lap belt only vehicle seat belt, which cannot be used with this booster seat.

Review section 6-B, 6-C of this manual AND your vehicle owner's manual.

According to accident statistics, the safest place for your child in any vehicle is the back seat. The center of the back seat can be the safest during a possible side impact.





1 Important

Using The Car Seat Correctly

To make sure your child is secured properly, review section 3 and 4 to fit your child.

When Installing As a Booster

Vehicle Seat Belt

There is one type of vehicle seat belt that can be used:
Lap/Shoulder Seat Belt.

Review section 3 of this manual AND your vehicle
owner's manual.

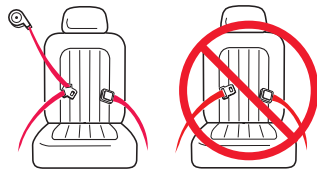

Booster Installation

Use Lap/Shoulder Belt Only

Review section 3

Position Lap Belt

Lap belt must go under armrest and lie low across your child's hips and thighs.

Review section 3

Position Shoulder Belt

Shoulder belt lies across shoulder between neck and edge of shoulder in the red zone as shown.

Review section 3

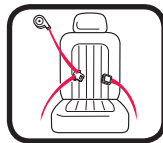

Highback

Backless



i 1 Important



1 Important

1-B Welcome to the Graco Family!

Your child's safety depends on you. No car seat can guarantee protection from injury in every situation, but proper use helps reduce the risk of serious injury or death.

Even if this car seat seems easy to figure out on your own, you must follow the detailed instructions in this instruction manual to ensure the steps below are performed correctly.

1-C Before You Begin

Register This Child Restraint

Please fill out the prepaid registration postcard attached to the seat pad and mail it in today **or register online at www.gracobaby.com/carseatregistration.**

Child restraints could be recalled for safety reasons. You must register this restraint to be reached in a recall. Send your name, address, and the restraint's model number and manufacturing date to:

Graco Children's Products, Inc.
Attn: Customer Service
P.O. Box 169, Elverson, PA 19520-9901
or call 1-800-345-4109

or register online at www.gracobaby.com/carseatregistration

For recall information, call the U.S. Government's Vehicle Safety Hotline at 1-888-327-4236 (TTY: 1-800-424-9153), or go to <http://www.NHTSA.gov>.



1 Important



1 Important

For future reference or if you change addresses, record the model name, model number, date of manufacture and purchase date of this car seat on the below. You can find this information either on the registration card if you still have it or on the date label located on the back of the car seat.

Model Name _____	Date of Manufacture _____
Model Number _____	Date of Purchase _____

If You Need Help

In the U.S.A, please contact our Customer Service Department with any questions you may have concerning parts, use, or maintenance. When you contact us, please have your product's model number and date of manufacture ready so that we may help you efficiently. These numbers can be found on a sticker on the back side of your car seat.

For additional resources or to get your car seat checked by a child passenger safety technician, please visit the following web sites:

www.nhtsa.gov • www.seatcheck.org • www.safekids.org

Certification

This child restraint meets or exceeds all applicable requirements of Federal motor vehicle safety standard 213 for use in motor vehicles.



This child restraint is NOT certified for use in aircraft when used as a booster seat because aircrafts do not have shoulder belts.

Car Seat's Useful Life

STOP using this car seat and throw it away 10 years after the date of manufacture. Look for date of manufacture label on back of the car seat.

Graco Children's Products Inc. advises against loaning or passing along a car seat unless you know the complete history of the product. We also advise against purchasing a car seat second hand.



1 Important



1 Important

Vehicle Seat Protection

Protect vehicle seat. Use a car seat mat, towel, or thin blanket under and behind car seat.

Warm Weather Use

Car seat parts can get very hot in the sun or warm weather. **To avoid burns, always check before putting child in car seat.**

1-D Safety Warnings

No car seat can guarantee protection from injury in every situation, but proper use helps reduce the risk of serious injury or death. **READ THIS MANUAL CAREFULLY.**

WARNING!

Failure to follow these instructions and child restraint's labels can result in child striking the vehicle's interior during a sudden stop or crash.



1 Important



1 Important

- ! Review your vehicle owner's manual for more information about air bags and car seat use.**
- ! If your vehicle does not have a back seat, review your vehicle owner's manual.**
- ! Select a suitable location for the car seat in your vehicle.**
- ! Always secure car seat with the vehicle seat belt, even when unoccupied. In a crash, an unsecured car seat can injure occupants.**
- ! If car seat is in a crash, it must be replaced. DO NOT use it again! A crash can cause unseen damage and using it again could result in serious injury or death.**
- ! DO NOT use car seat if it is damaged or missing parts.**
- ! DO NOT use accessories or parts other than those provided by Graco. Their use could alter the performance of the car seat.**



1 Important

- ! Never leave child unattended, even when sleeping.**
- ! The American Academy of Pediatricians (AAP) and National Highway Safety Administration (NHTSA) recommend that children should use a built-in harness system car seat for as long as possible until they reach the maximum forward-facing weight or height for their car seat. After reaching the maximum forward-facing weight or height, they also recommend that children 4 feet 9 inches (145cm) tall or under should ride in a belt-positioning booster seat.**
- ! For use in motor vehicles ONLY**



2-A Car Seat Features

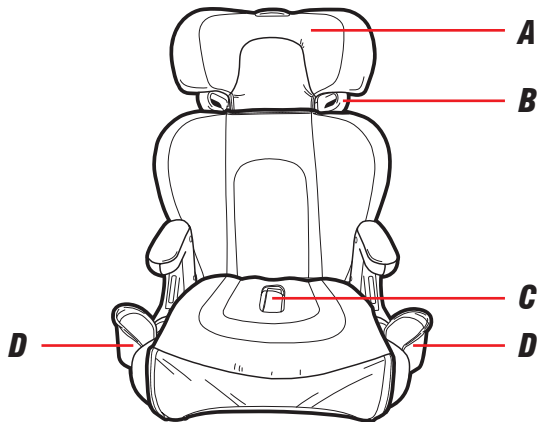

- A** *Headrest*
- B** *Shoulder Belt Guide*
- C** *FastAction™ Fold Strap*
- D** *Cup Holder*

A

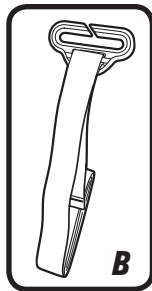
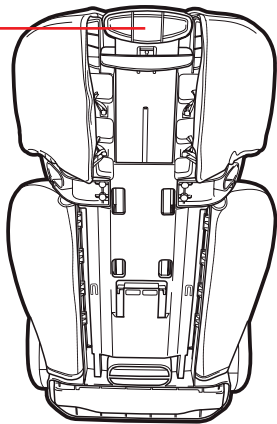

- A** *Headrest Adjustment Lever*
- B** *Belt Positioning Clip (Inset)*



3 Booster

3-A Booster Use



**Vehicle Seat Lap/
Shoulder Belt**



**Vehicle Seat Lap/
Shoulder Belt**

***Booster Use With Back: 40-100 lb (18.1-45 kg)
43-57 in. (110.1-145 cm) at least 4 years old***

***Booster Use Without Back: 40-100 lb (18.1-45 kg)
43-57 in. (110.1-145 cm) at least 4 years old***

- Place car seat forward-facing in the vehicle back seat.
- Make sure vehicle seat's lap belt is adjusted snugly and lays low on the child's hip and is routed under the armrest in the booster's belt path.
- Vehicle belts **MUST** lie flat against child and **MUST NOT** be twisted.
- Vehicle seat's shoulder belt is adjusted snugly and should lie between child's neck and edge of shoulder.

- **Never** use a vehicle lap-only belt across front of child.
- **DO NOT** position vehicle shoulder belt under the child's arm or back.
- **DO NOT** allow child to slouch or slide down in the booster seat.
- **DO NOT** position vehicle belt over top of armrests.
- Vehicle's seat headrest **SHOULD NOT** create a gap between vehicle seat and booster seat.
- The front of booster seat **MUST NOT** hang over front of vehicle seat.
- If child will not keep vehicle belt properly positioned, **DO NOT** use this booster seat. Use a different car seat.
- The AAP and NHTSA recommend that children should use a built-in harness system car seat for as long as possible until they reach the maximum forward-facing weight or height for their car seat. After reaching the maximum forward-facing weight or height, they also recommend that children 4 feet 9 inches (145cm) tall or under should ride in a belt-positioning booster seat.



***Never Use a Vehicle
Lap-Only Belt Across
Front of Child***



**3
Booster**



3 Booster

3-B Install Booster

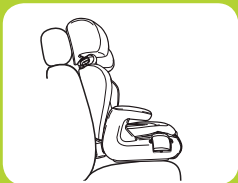

1. Place Car Seat Forward-Facing in Back Seat of the Vehicle

Place forward-facing in vehicle seat. The bottom of the seat should sit as flat as possible on the vehicle seat.

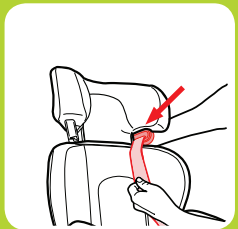

2. Thread the Vehicle Seat Shoulder Belt Through Seat Belt Guide on the Headrest

See section 4-A to secure your child.

Note: Always secure car seat with the vehicle seat belt, even when unoccupied or stowed away.

3-C Install Backless Booster

1. Remove the Backrest (on select models)

Pull up on the FastAction™ fold strap that is in the middle of the seat base and pull the seat back off of the base. Store the seat back in the trunk or in your home.

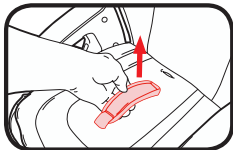

2. Place the Booster Seat Forward-Facing in the Back Seat of Vehicle

Place forward-facing on a vehicle seat that has a lap/shoulder seat belt. The base should sit as flat as possible on the vehicle seat.

See section 4-A to secure your child.

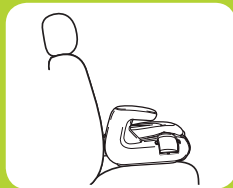

3 Booster



4-A Securing Child Backed Booster

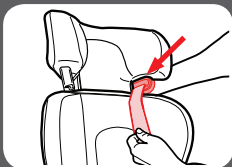

⚠ WARNING!

Use only the vehicle lap and shoulder belt system when restraining the child in the booster seat.

1. Place Child In Seat

Have your child sit in the booster seat, with his/her back flat against the back of the booster seat.

2. Thread Vehicle's Shoulder Belt Into Seat Belt Guide in the Headrest

3. To Raise or Lower Headrest Support

Push down adjustment lever and lift or lower headrest.

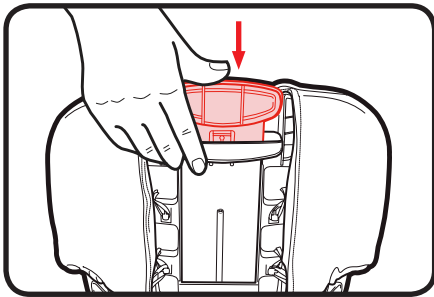

The belt guides should be even with or just above the shoulders.

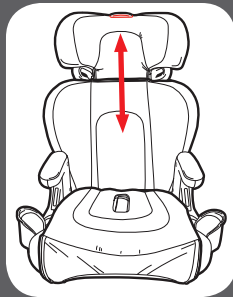

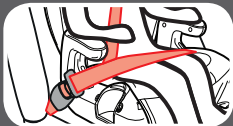

4. Buckle the Vehicle Lap/Shoulder Seat Belt

Be sure the lap portion of the vehicle seat belt goes under both armrests and the shoulder belt goes under the armrest on the buckle side.

Be sure the lap portion of the vehicle seat belt lies low across your child's hips.

Be sure the shoulder belt lies across your child's shoulders, in the red zone between the neck and edge of shoulder by raising or lowering the headrest. The belt guides should be even with or just above the shoulders.

Is Everything Correct?

Never Use Lap Belt Only

Lap Belt under Armrest and Lies Low Across Hips and Thighs

Shoulder Belt Lies On the Shoulder in the Red Zone, Between the Neck and Edge of Shoulders

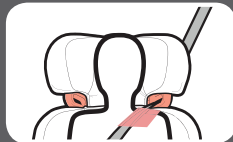
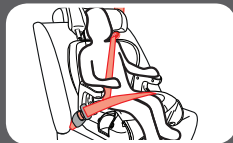



4-B Securing Child Backless Booster

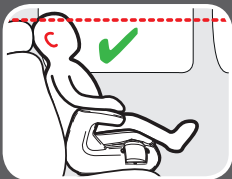

!WARNING!

Use only the vehicle lap and shoulder belt system when restraining the child in the booster seat.

1. Place Child In Seat

Have your child sit in the booster seat, with his/her back flat against the back of the vehicle seat.

2. Ears Must Be Below the Top of the Vehicle Seat Back or Headrest.

3. Buckle the Vehicle Lap/Shoulder Seat Belt

Be sure the lap portion of the vehicle seat belt goes under both armrests and the shoulder belt goes under the armrest on the buckle side.

Be sure the lap portion of the vehicle seat belt lies low across your child's hips.

Be sure the shoulder belt lies across your child's shoulders, in the red zone between the neck and edge of shoulder.

You may need to use the belt positioning clip to help get a good fit. See "Using Belt Positioning Clip"

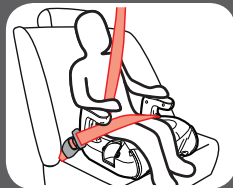



Is Everything Correct?



Never Use Lap Belt Only



Lap Belt under Armrest and Lies Low Across Hips and Thighs

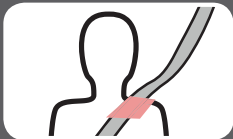

Shoulder Belt Lies On the Shoulder, in the Red Zone Between the Neck and Edge of Shoulders

Using Belt Positioning Clip

1. Make Sure Vehicle's Seat Shoulder Belt Lays in the Red Zone As Shown

If the vehicle's seat shoulder belt lays outside this zone, you **MUST** use the belt positioning clip.

2. Attach Belt Positioning Clip

The shoulder belt positioning clip **MUST** be attached to the slot on the bottom of the base. Insert the loop end of strap through the slot on bottom of seat exactly where shown.

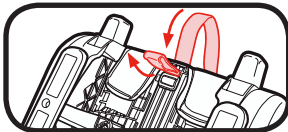

3. Push Clip and Strap Through Loop

Pass the clip and the strap through the loop end as shown and pull strap up.

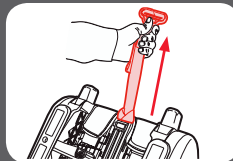
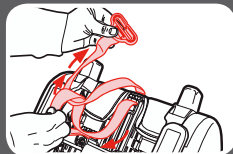

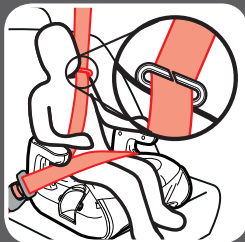
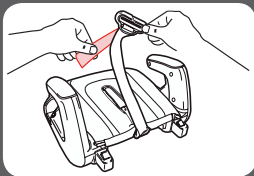

4. Free End of Strap Should Face Front of Seat

5. Place Child in Seat, Buckle Child In Seat and Attach Belt Positioning Clip

With child's back flat against the back of the vehicle seat, buckle child in. Then slide the clip onto the vehicle's seat shoulder belt as shown.

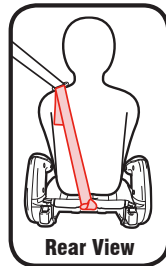

6. Adjust the Belt Positioning Clip to Fit Your Child

Lengthen or shorten the belt length as shown.

Clip should fit right at the top of shoulder as shown.

Be sure the lap portion of the vehicle seat belt lies low across your child's hips.

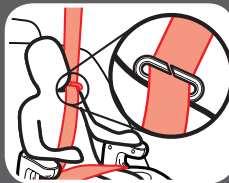
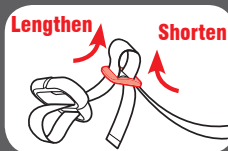

5 Accessories

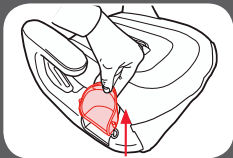

Cup Holders

Lift cup holder up and rotate. Align the cup holder's tabs with the slots and push the cup holder down. You will hear a "Click" when cup holder is in place.

Backless Booster Carry Bag

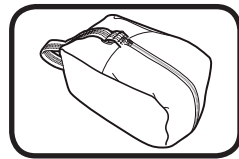
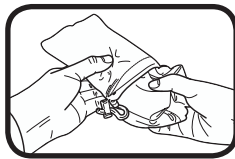

6-A Choosing Vehicle Seat Location

Review Your Vehicle's Owner Manual for Seating Locations

The best seating location for this car seat is one that:

- Is recommended by your vehicle owner's manual, and
- Results in a secure installation of this car seat

In the event there is no available back seat and / or you have no other option, the National Highway Traffic Safety Administration (NHTSA) recommends that you take the following steps:

- Ensure the child is properly restrained according to their age and size
- Move the seat as far back as possible
- Make sure the child is not leaning out of position, such as leaning forward into the deployment path of the air bag
- Set the air bag ON-OFF switch, if available, to the OFF position





6-B Unsafe Vehicle Seat Location

Never install this car seat in any of the following vehicle seating locations:



rear-facing or side-facing
vehicle seats



booster mode with vehicle
lap belt only seat belt



6-C Vehicle Seat Belts

Review Your Vehicle's Owner Manual for Vehicle Seat Belt Use

Vehicle Seat Belt Terms

Retractor

A device that winds up the unused vehicle seat belt. It is often hidden inside the panels on the walls of the vehicle or in the vehicle seatback.

Latch Plate

The male end of the seat belt with the silver tongue.

Seat Bight

The crease where the vehicle seat back and seat bottom meet.

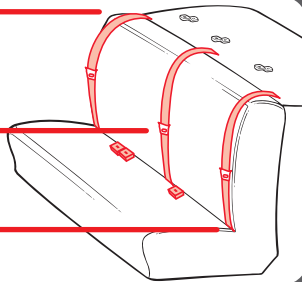



Identify Your Seat Belt Type

There is one type of vehicle seat belt that can be used with this car seat:

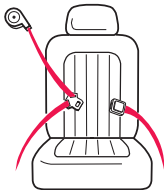

Lap/Shoulder Belt 3
connections points. Can be
used in all car seats modes of
use.

The following types of vehicle seat belts
CANNOT be used safely with this car seat:



Lap Belt Only 2
connection points.



Lap Belt with Motorized
Shoulder Belt



Lap Belt or Shoulder Belt
Mounted on Door



Belts Forward of the
Seat Bight

7 Care and Cleaning

Refer to seat pad care tag for washing instructions.

Refer to carry bag's care tag for washing instructions.

Cleaning Seat Pad

To Remove Seat Cover

Separate the seat back from the seat base. Flip the base over to expose the bottom of the base.

At the front edge, slide the tab towards the back and pull out of the slot. Repeat for the other side

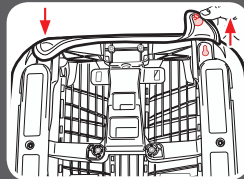
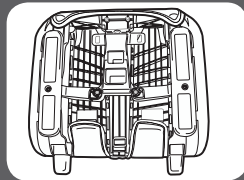

7 Care & Cleaning

7 Care & Cleaning

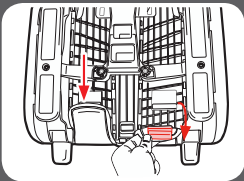

At the back edge, pull the tab towards the front of the base and remove. Repeat for other side.

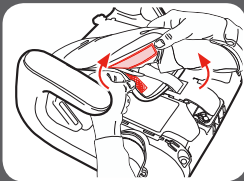

Turn the base over. Undo the fastening strip and remove the seat pad.

Reverse the steps to attach the pad to the base.

To clean the fold strap pad, locate the plastic retainer on the bottom of the base. Rotate the plastic retainer and push it through the slot.

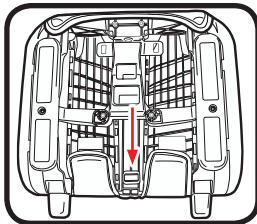

From the front, pull the plastic retainer up through the slot. Slide the fold strap pad off the strap.

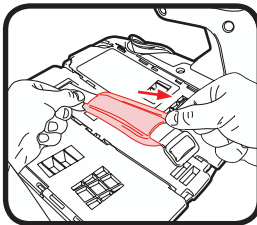

Reverse the steps to put the pad back on.

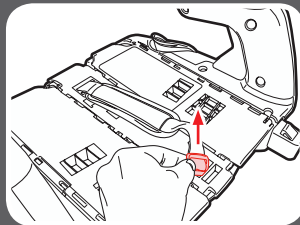
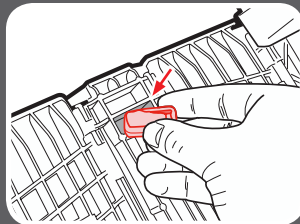

7 Care & Cleaning

7 Care & Cleaning

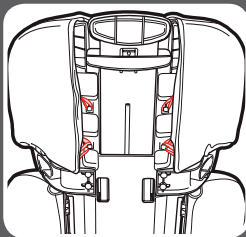
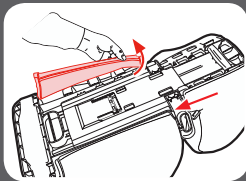

To remove the seat back pad, from the back of the seat back, pull the pad out of the slot. Repeat for the other side and remove the pad.

Reverse the steps to put the seat back pad back on.

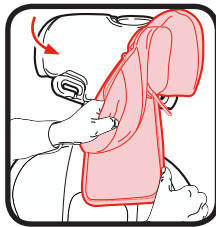

To remove the headrest pad, from the back, undo the elastic straps. From the front, remove the headrest pad.

Reverse the steps to put the headrest pad back on.

8-A Fold and Carry Feature

Backed Booster

1. Remove Backrest

Pull up on the FastAction™ Fold strap that is in the middle of the seat base and pull the backrest off of the base.

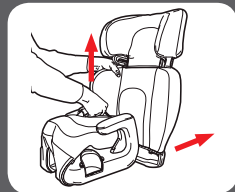

2. Slide Backrest Into Base

Face backrest down so cushions are on the inside.

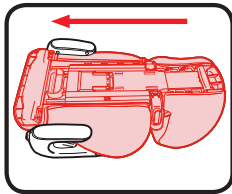

45



8 Fold and Carry Feature

8 Fold and Carry Feature

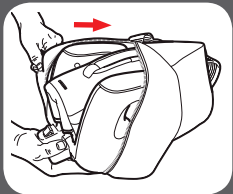

Backless Booster

1. Pull up on the FastAction™ Fold strap and fold the seat. You will hear a click when it is locked.

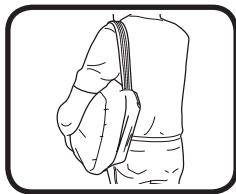

2. Insert seat into the backless booster carry bag and zip closed.

Notes:

Replacement Parts

To purchase parts or accessories in the United States,
please contact us at the following:

www.gracobaby.com

or

1-800-345-4109



Store instruction manual in the
pouch that is under the base seat
pad with the instruction book icon
as shown.