

# SMARTCODE 917

RESIDENTIAL ELECTRONIC LEVER

**Required tools**

Allen  
Wrench



SmartKey™  
Tool

**Kwikset**  
1-800-327-5625  
www.kwikset.com

## How to Re-key the Lock (if needed)

### 1 **IMPORTANT:** Remove lever before re-keying.

- a** Insert the key and turn it 90° clockwise.

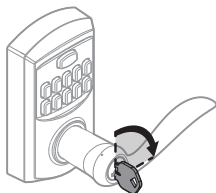

- b** Loosen the pre-installed set screw.

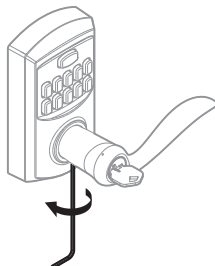

- c** Turn the key 90° counterclockwise to remove it.

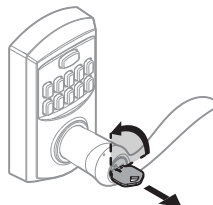

- d** Remove the lever.

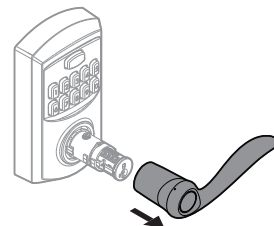

### 2 Re-key the lock.

- a** Insert the key that currently operates your lock, and turn it 90° clockwise.

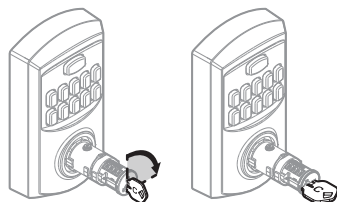

- b** Insert the SmartKey tool fully and firmly into the SmartKey hole, then remove the SmartKey tool and current key.

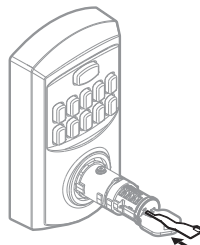

- c** Fully insert your new key into the lock and turn it 180° counterclockwise. Next, turn the key 90° back to the starting position, then remove it.

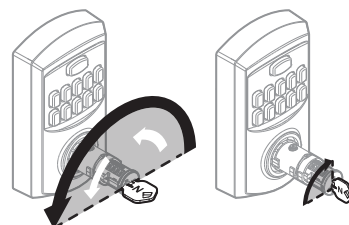

### 3 Re-install the lever.

- a** Install the lever.

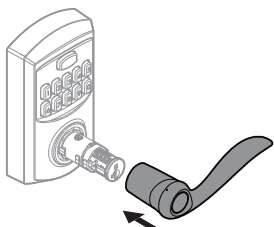

- b** Insert the key and turn it 90° clockwise.

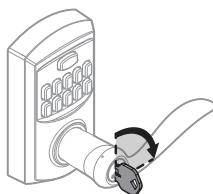

- c** Secure the lever by tightening the pre-installed set screw.

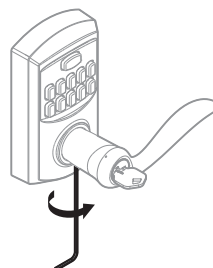

- d** Turn the key 90° counterclockwise to remove it.

