



F2 SERIES BACKHOE LOADER CENTER PIVOT MODELS PARTS REFERENCE GUIDE

LET'S DO THE WORK.™



» PROTECT YOUR INVESTMENT WITH GENUINE CAT® PARTS

Thank you for selecting the Cat® F2 Series Center Pivot Model Backhoe Loader.

This guide is designed to provide you with a quick reference for the parts and part numbers you need to keep your Cat Backhoe Loader operating at peak efficiency.

MAINTENANCE

Proactive preventative maintenance extends the life of your machine and protects your investment. Only Caterpillar knows Cat equipment's filtration and lubrication requirements and offers parts kits to match your machine's maintenance cycles.

SCHEDULED MAINTENANCE PARTS	
	GREASES
	PLANNED MAINTENANCE

REPLACEMENT PARTS

Proper maintenance minimizes the need for repair and replacement. In the event that replacement parts are required, the use of genuine Cat parts helps maximize machine performance and maintains high resale value.

WEAR PARTS	SALES MODEL	SERIAL NUMBER PREFIX
GROUND ENGAGING TOOLS	415F2	HWA
WEARPADS AND SHIMS		
REPAIR PARTS	415F2 IL	PF4
BATTERY		
ENGINE PARTS	416F2	HWB
MIRRORS, LIGHTS AND FUSES		
CAB GLASS	420F2 / IT	HWC, HWD
ENHANCEMENT PARTS		
QUICK DISCONNECTS	430F2 / IT	HWE, HWG
LINKAGE PIN AND BEARING PARTS		

GREASES F2 Series

Previous Cat Product Name	STANDARD MAINTENANCE GREASES			GREASES FOR UNIQUE APPLICATIONS AND ENVIRONMENTS
	Cat Ultra5 Moly #1	Cat Ultra5 Moly #2	Cat Advanced 3 Moly	
Current Cat Product Name	Cat Extreme Application Grease 1	Cat Extreme Application Grease 2	Cat Prime Application Grease	Hammer Paste
Grade (NLGI)	1	2	2	2
Melting Point C° (F°)	>260 (>500)	>260 (>500)	260 (500)	230 (446)
Ambient Temperature C° (F°)	-35 to +40 (-31 to +104)	-30 to +50 (-22 to +122)	-20 to +40 (-4 to +104)	20 to +1100 (-4 to +2012)
Base Oil Type	Mineral	Mineral	Mineral	Mineral
Color	Dark Gray	Dark Gray	Dark Gray	Bronze
Cartridge (390 g / 14 oz)	452-5996	452-6001	452-6006	130-6951 (standard) 317-8491 (autolube)
Plastic Pail (5 kg / 11 lb)	—	—	—	133-8807
Plastic Pail (16 kg / 35 lb)	452-5999	452-6004	452-6009	—
Keg (55 kg / 120 lb)	452-5998	452-6003	452-6008	—
Drum (180 kg / 400 lb)	452-5997	452-6002	452-6007	—



PLANNED MAINTENANCE

Backhoe Loader		EVERY 500 HOURS								
		Engine Oil/Filter Change		Engine Air Filter Change		Fuel Filter Change		Cab Air Filter Change		Transmission Filter Change
Sales Model	Serial Number Prefix	Filter Element	Oil Quantity - Liter (Gallon) DEO-ULS	Primary Element	Secondary Element	Primary Element	Secondary Element	Fresh Air Element	Recirculating Element	Filter Element
415F2	HWA / PF4	441-6852	8.8 (2.3)	346-6687	346-6688	311-3901	360-8960	417-8134	211-2660	471-7003
416F2	HWB	7W-2326				479-4133				
420F2 / IT	HWC, HWD									
430F2 / IT	HWE, HWG									

Backhoe Loader		EVERY 1000 HOURS																
		Axle Oil	Front Differential Oil Change		Front Final Drive Oil Change (each side)		Rear Differential Oil Change		Rear Differential Brake Additive		Rear Final Drive Oil Change (each side)		Hydraulic Filter Change			Transmission Oil Change		
Sales Model	Serial Number Prefix	Oil Type	Oil Quantity Liter (Gallon)	O-Ring	Oil Quantity Liter (Gallon)	O-Ring	Oil Quantity Liter (Gallon)	O-Ring	Oil Quantity Liter (Gallon)	Additive	Oil Quantity Liter (Gallon)	O-Ring	Filter Element	Seal (Housing)	Seal (Plug)	Oil Quantity Liter (Gallon) TDTO	Seal	Breather
415F2	HWA / PF4	TDTO	11 (2.9)	6V-6228 (Quantity 2)	0.7 (0.2)	6V-6228	16.5 (4.4)	6V-6228 (Quantity 2)	0.5 (0.13)	197-0017	1.7 (0.45)	6V-6228	362-1163	526-0891	2M-9780	15 (3.9) manual	238-5080	9G-5127
416F2	HWB															19 (5) powershift 20 (5.3) lock up	5P-6718 powershift / lock up	7T-3251 powershift / lock up
420F2 / IT	HWC, HWD															15 (3.9) manual 19 (5) powershift 20 (5.3) lock up	238-5080 manual 5P-6718 powershift / lock up	9G-5127 manual 7T-3251 powershift / lock up
430F2 / IT	HWE, HWG																	

Backhoe Loader		EVERY 1500 HOURS			
		Engine Crankcase Change	Diesel Exhaust Fluid (DEF) Filter Change	Belt (Serpentine) Change	
Sales Model	Serial Number Prefix	Breather Element	Filter Element	No A/C	With A/C
415F2	HWA / PF4	-	-	422-0662	370-0041
416F2	HWB	339-1048	495-1507	390-0533	390-0537
420F2 / IT	HWC, HWD				
430F2 / IT	HWE, HWG				

Backhoe Loader		EVERY 12,000 HOURS			
		Cooling System Coolant (ELC) Change			
Sales Model	Serial Number Prefix	No A/C - Quantity Liter (Gallon)		With A/C - Quantity Liter (Gallon)	
415F2	HWA / PF4	14.5 (3.8)		16.5 (4.4)	
416F2	HWB	21.5 (5.7)		22.5 (5.9)	
420F2 / IT	HWC, HWD				
430F2 / IT	HWE, HWG				

Backhoe Loader		EVERY 2000 HOURS	
		Hydraulic Oil Change	
Sales Model	Serial Number Prefix	Oil Quantity Hydo Advance Liter (Gallon)	Breather
415F2	HWA / PF4	40 (10.6)	9R-9925
416F2	HWB		
420F2 / IT	HWC, HWD		
430F2 / IT	HWE, HWG		

COMMON GROUND ENGAGING TOOLS F2 Series

Loader		
Description (Width)	Qty	Part Number
Edge Group - Bolt-On (2262mm)		
Cutting Edge	2	9W-8215
Hex Head Nut	8	4K-0367
Washer Hard	8	8T-4122
Plow Bolt	8	3F-5108
Edge Group - Bolt-On (2406mm)		
Cutting Edge	2	118-7110
Hex Head Nut	8	4K-0367
Washer Hard	8	8T-4122
Plow Bolt	8	3F-5108
Edge Group - Bolt-On (2434mm)		
Cutting Edge	2	220-4691
Hex Head Nut	8	4K-0367
Washer Hard	8	8T-4122
Plow Bolt	8	3F-5108
Edge Group - Bolt-On (2434mm)		
Cutting Edge	2	9U-9665
Hex Head Nut	12	4K-0367
Plow Bolt	12	3F-5108
Cutting Edge MP (2262mm)	1	233-3757
Cutting Edge MP (2406mm)	1	233-0859
Cutting Edge MP (2434mm)	1	515-9970
Cutting Edge MP (2434mm)	1	517-1305
Tooth Group-Uni		
Unitooth Tip	8	135-8203
Hex Head Nut	16	4K-0367
Plow Bolt	16	4F-3657

Hoe	
Description	Part Number
Diagonal Retention System (DRS230)	
Retainer	201-1239
Pin - GET	500-0269
Diagonal Pin Adapter	
Adapter (25mm for Rock Buckets)	201-1234
Adapter (20mm)	201-1235
Adapter (25mm for Soil Buckets)	253-0234
Tip	
Penetration	208-5235
Chisel	208-5232
Soil Digging	208-5234
Long	208-5236
Twin Sharp	208-5237
Sharp	208-5239
Wide	208-5240
Cutting Edge	
Cutting Edge (1200mm)	311-6221
Cutting Edge (1500mm)	311-9239
Cutting Edge (1800mm)	556-3598



WEARPADS AND SHIMS F2 Series

Location	Part Number
Stabilizer (Rock Guard Option)	
Pad	188-3953
Extendable Stick	
Pad (Side)	233-5169
Shim (0.25 mm)	293-9884
Shim (0.5 mm)	233-5166
Shim (1 mm)	293-9882
Shim (2 mm)	233-5167
Pad (Head - Wedge)	289-9426
Pad (Nose - Wedge)	217-1577
Shim (1 mm)	287-5667
Pad (Top)	226-9764

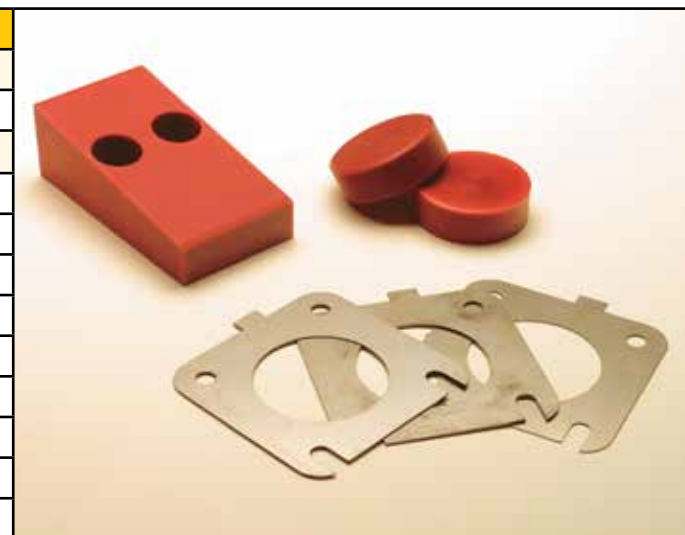

BATTERY F2 Series

Backhoe Loader		Battery	Part Number
Sales Model	Serial Number Prefix	Standard	230-6368
415F2/ 415F2 IL	HWA / PF4		
416F2	HWB		
420F2 / IT	HWC, HWD		
430F2 / IT	HWE, HWG		



ENGINE PARTS F2 Series

Backhoe Loader		Part Number / Reman										
Sales Model	Serial Number Prefix	Engine	Long Block	Alternator	Fuel Injector	Fuel Injection Pump	Water Pump	Starting Motor	Turbo-charger			
415F2/ 415F2 IL	HWA / PF4	352-4213	-	390-2384	392-0708	390-3122	433-1684	417-8509	498-1550			
416F2	HWB	436-5176	20R-7184	321-8927	20R-3601	418-3229	370-8363	20R-4783	397-5683	331-7010	20R-4762	450-1871
420F2 / IT	HWC, HWD	436-5177										
430F2 / IT	HWE, HWG	436-5178	20R-7185									



MIRRORS, LIGHTS AND FUSES F2 Series

Mirrors		Part Number
Rearview	External	180-0448
Bracket	Right	382-2497
Bracket	Left	382-2498
Rearview	Internal	472-9218

Fuses	Part Number
3 Amp Mini	395-9584
10 Amp	9W-1442
10 Amp Mini	113-8490
15 Amp	9W-1441
15 Amp Mini	113-8491
20 Amp	9W-1446
25 Amp	1Q-1905
30 Amp	192-7727
40 Amp	232-6313
50 Amp	418-0363

Lights	Lamp Type	Part Number
Flood Lamp (Front and Rear) Long Range	Halogen Light	214-2969
	Halogen Bulb	9W-0607
Flood Lamp (Front and Rear) Wide Range	Halogen Light	214-2968
	Halogen Bulb	9W-0607
Flood Lamp LED (Front and Rear) Wide Range		479-8445
Lamp Signal (Stop, Tail and Turn) (Rear)	Lamp Assembly	336-9096
	Halogen Bulb (Stop)	7S-1800
	Halogen Bulb (Signal)	9W-3326
	Lens	352-4645
Lamp Signal (Stop, Tail and Turn) LED (Rear)		387-6627
Lamp Signal (Turn) (Front)	Lamp Assembly	449-3759
Dome Lamp	Lamp Assembly	426-0976
Dome Lamp LED	Lamp Assembly	431-9515
Lamp 12V (Dome)	Lamp	210-8754
Beacon (Warning) Strobe Light	Roof Mounted	140-3668
Beacon (Rotating Warning)	Roof Mounted	180-3664
	Halogen Bulb	9X-8118
Beacon (Rotating Warning)	Roof Mounted	309-1325
	Halogen Bulb	9X-8118

CAB GLASS F2 Series

Position	Part Number	Sales Model	Serial Number Prefix
Windscreen (Top)	382-2342	All	All
Windscreen (Bottom Right)	382-2344		
Windscreen (Bottom Left)	382-2343		
Left Door (Top)	382-2261		
Left Door (Bottom)	382-2263		
Right Door (Top)	382-2274		
Right Door (Bottom)	382-2269		
Left Rear (Top)	382-2249		
Left Rear (Bottom)	382-2310		
Right Rear (Top)	382-2250		
Right Rear (Bottom)	382-2311		
Rear Glass (Top Section)	438-6984	415F2 416F2 420F2 / IT 430F2 / IT	HWA1-780 HWB1-1997 HWC1-4554 / HWD1-3661 HWE1-1035 / HWG1-692
Rear Glass (Top Section)	564-7654	415F2 416F2 420F2 / IT 430F2 / IT	HWA781-UP HWB1998-UP HWC4555-UP / HWD3662-UP HWE1036-UP / HWG693-UP
Rear Glass (Bottom Section)	441-4184	415F2 416F2 420F2 / IT 430F2 / IT	HWA HWB HWC / HWD HWE / HWG

QUICK DISCONNECTS

Get the most out of your Cat F2 Series Backhoe Loader with a wide range of hydraulic work tool attachments that can be easily interchanged with Quick Disconnects. Contact your Cat dealer for a complete list of all available attachments.

Function	Twist to connect – Connect under pressure			
	Male	Cap	Female	Cap
Loader	439-1589	471-1018	439-1588	471-1017
Hoe	439-1591		439-1590	



LINKAGE PIN AND BEARING PART NUMBERS F2 Series

See part numbers on following pages

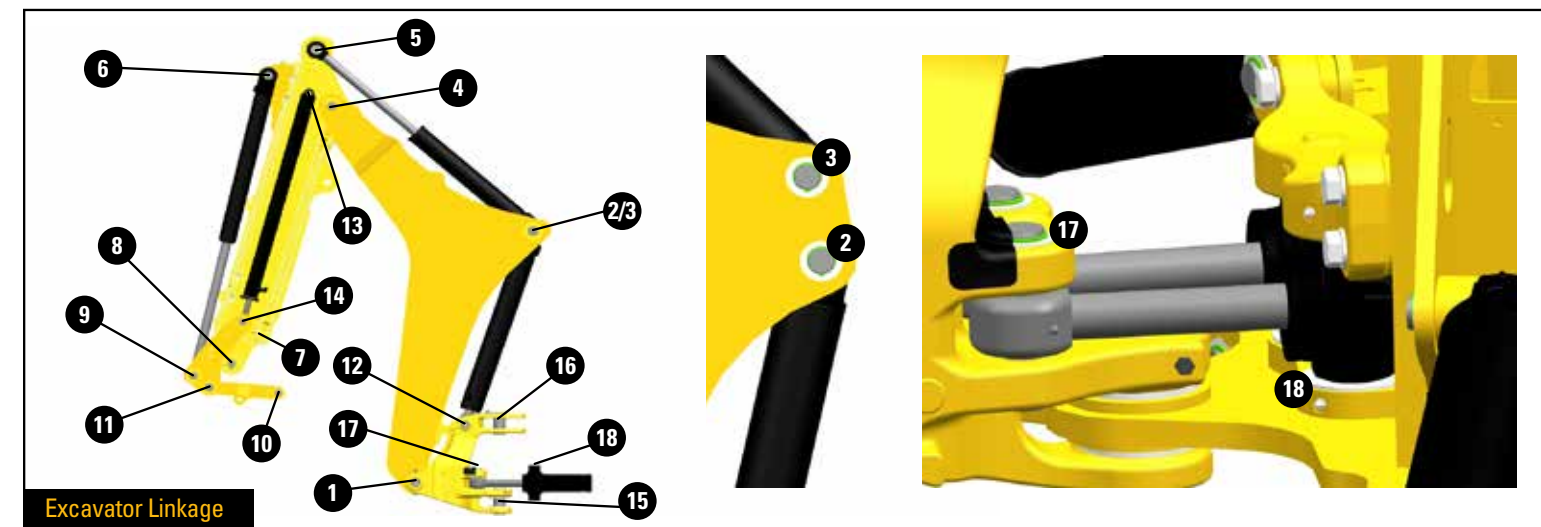
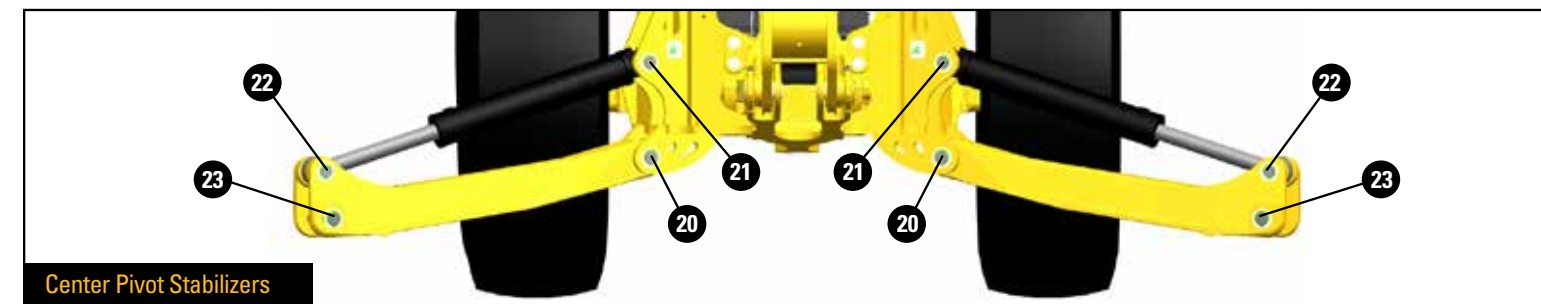
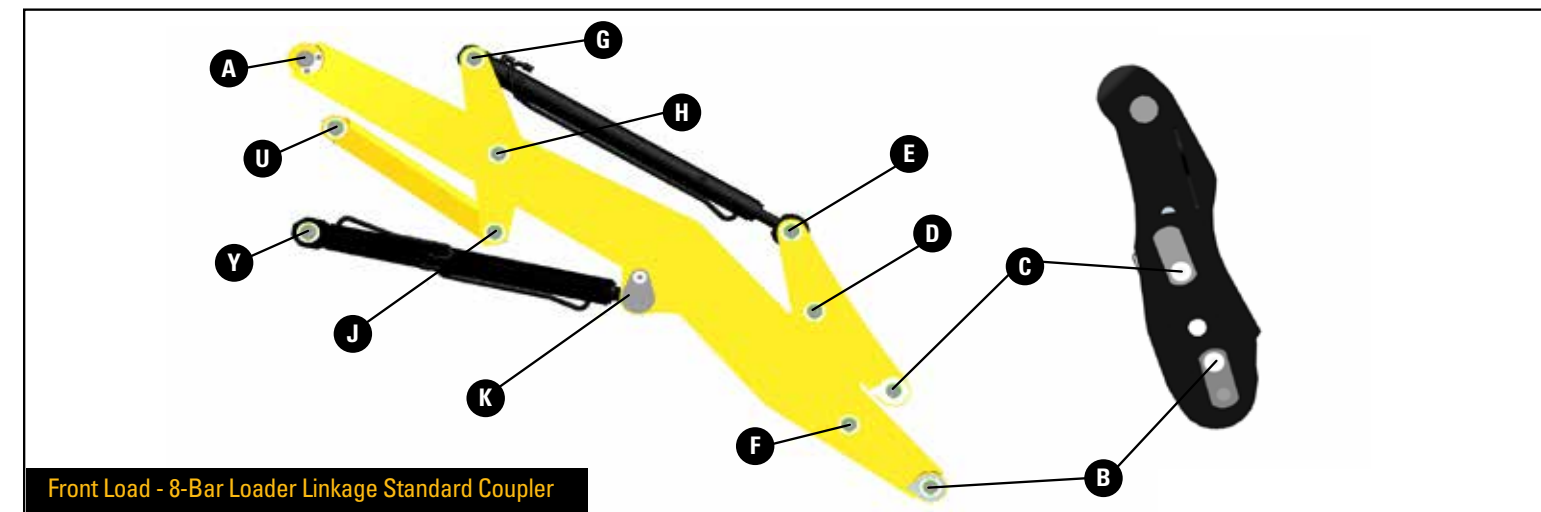
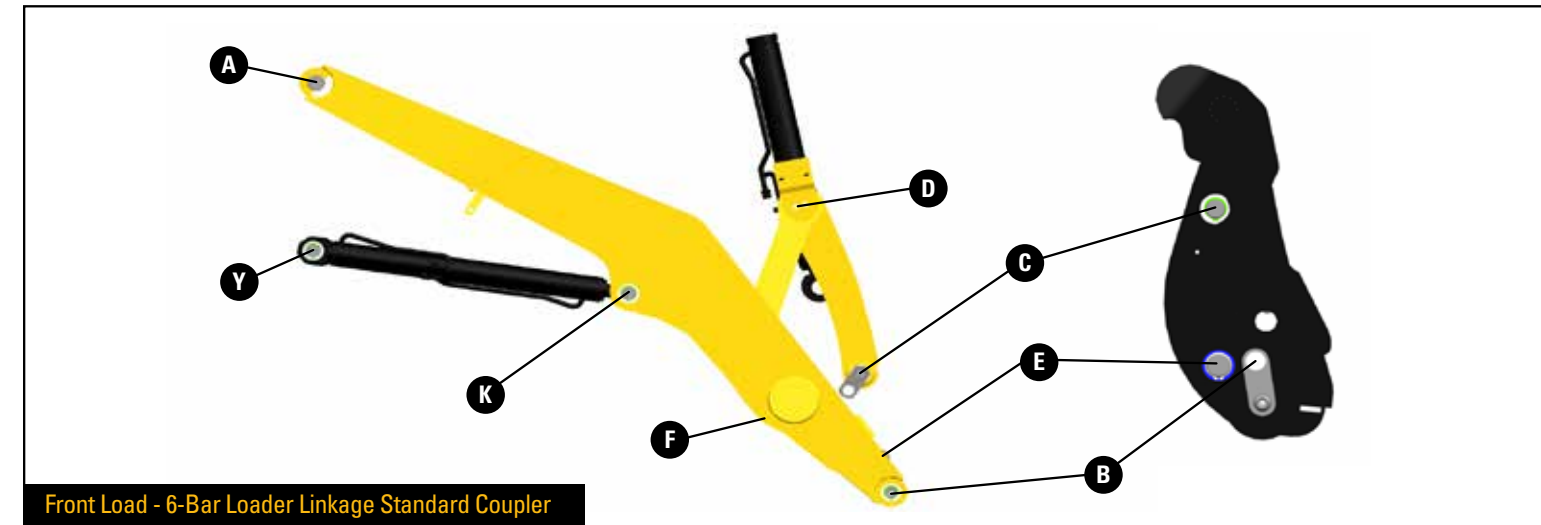

FRONT LOAD – 6-BAR LOADER LINKAGE STANDARD COUPLER F2 Series

Linkage Pins									
Sales Model	Serial Number Prefix	A	B Arm	C Arm	D	E Arm	F	K	Y
415F2 / 415F2 IL	HWA / PF4	341-6152 Pin	360-2821 Pin (QTY 2)	360-2823 Pin Assembly	361-0415 Trunnion	364-3011 Pin Assembly	360-2822 Pin	362-3269 Pin (Right) 362-3270 Pin (Left)	360-2816 Pin (QTY 2)
416F2	HWB								
420F2 / IT	HWC								
430F2 / IT	HWE								
Bearings									
Sales Model	Serial Number Prefix	A	B Arm	C Arm	D	E Arm	K	Y	
415F2/415F2 IL	HWA / PF4	278-7066 Bearing (QTY 4)	9R-0411 Bushing (QTY 4)	9R-5828 Bushing (QTY 2)	531-3531 Bearing (QTY 2) 361-4673 Bearing (QTY 2) 362-5025 Bushing (QTY 2)	362-5027 Bushing (QTY 2)	362-5024 Bushing (QTY 2)	362-5024 Bushing (QTY 2)	
416F2	HWB								
420F2 / IT	HWC								
430F2 / IT	HWE								
Seals and Grease Fittings									
Sales Model	Serial Number Prefix	B Arm							
415F2/415F2 IL	HWA / PF4	3B-8489 Grease Fitting (QTY 2)							
416F2	HWB								
420F2 / IT	HWC								
430F2 / IT	HWE								
Retention Hardware									
Sales Model	Serial Number Prefix	A	B Arm	C Arm	D	E Arm	F	K	Y
415F2/415F2 IL	HWA / PF4	372-5024 Plate (QTY 2) 8T-4139 Bolt (QTY 4) 8T-4223 Washer (QTY 4) 128-7903 Spacer (QTY 2) 128-7905 Spacer (QTY 2)	111-4337 Washer (QTY 6) 6V-3213 Retaining Ring (QTY 4) 9R-0158 Washer (QTY 4) 363-2856 Shim (QTY 2) 363-2855 Shim (QTY 3)	111-4337 Washer (QTY 2) 7X-0618 Washer 9R-0158 Washer (QTY 4) 361-7826 Tube 8T-4956 Bolt	358-1472 Spacer (QTY 2) 101-0117 Plate 362-1201 Plate 8T-4121 Washer (QTY 4) 8T-4137 Bolt (QTY 4)	7X-0618 Washer 9R-1502 Washer 8T-4956 Bolt	111-4337 Washer (QTY 5) 6V-3213 Retaining Ring (QTY 2) 9R-0158 Washer (QTY 2)	373-8390 Shim (QTY 6) 7X-0542 Washer (QTY 7) 6V-4364 Retaining Ring (QTY 4)	6V-7744 Lock Nut (QTY 2) 105-3479 Bolt (QTY 2) 373-8390 Shim (QTY 4) 6V-4364 Retaining Ring (QTY 2) 7X-0542 Washer (QTY 6)
416F2	HWB								
420F2 / IT	HWC								
430F2 / IT	HWE								

CENTER PIVOT STABILIZERS F2 Series

Linkage Pins					
Sales Model	Serial Number Prefix	20	21	22	23
415F2	HWA	374-7900 Pin (QTY 2)	376-7520 Pin (QTY 2)	380-9478 Pin (QTY 2)	238-9546 Shaft (QTY 2)
416F2	HWB				
420F2 / IT	HWC / HWD				
430F2 / IT	HWE / HWG				
Bearings					
Sales Model	Serial Number Prefix	20	21	22	23
415F2	HWA	9R-0411 Bushing (QTY 4)	9R-0321 Bushing (QTY 4)	9R-0321 Bushing (QTY 4)	
416F2	HWB				
420F2 / IT	HWC / HWD				
430F2 / IT	HWE / HWG				
Retention Hardware					
Sales Model	Serial Number Prefix	20	21	22	23
415F2	HWA	111-4337 Washer (QTY 2) 6V-3213 Retaining Ring (QTY 4) 9R-0158 Washer (QTY 12)	119-4594 Washer (QTY 2) 6V-8144 Retaining Ring (QTY 4) 9R-0109 Washer (QTY 8)	6V-8144 Retaining Ring (QTY 4) 9R-0109 Washer (QTY 8)	6V-3213 Retaining Ring (QTY 4) 9R-0158 Washer (QTY 14)
416F2	HWB				
420F2 / IT	HWC / HWD				
430F2 / IT	HWE / HWG				

EXCAVATOR LINKAGE F2 Series

Linkage Pins																									
Sales Model	Serial Number Prefix	Stick Type Standard Stick: Areas 4,5,6,7 Extendable Stick: Areas 4,5,6,7,13 and 14	Linkage Type (Areas 7,8,9,10 and 11)	1	2	3	4	5	6	7	8	9	10	11	12	13	14	15	16	17	18				
415F2	HWA	Standard	Fabricated	237-5330 Pin (QTY 2)	445-5660 Pin	-	473-0239 Pin Assembly	213-6714 Pin	213-6696 Pin	213-6697 Pin	154-5280 Pin	154-5278 Pin	154-5279 Pin	213-6698 Pin	209-6850 Pin Assembly	-	-	341-9483 Pin	341-9484 Pin Assembly	341-9488 Pin (QTY 2)	381-8085 Cylinder Assembly 381-8086 Cylinder Assembly				
		Extendable				-			220-1019 Pin	220-1018 Pin						214-6143 Pin	220-1018 Pin								
416F2	HWB	Standard				-			213-6696 Pin	213-6697 Pin						214-6143 Pin	220-1018 Pin								
		Extendable				-			220-1019 Pin	220-1018 Pin															
420F2 / IT	HWC / HWD	Standard				-			426-0422 Pin	473-0238 Pin Assembly						213-6695 Pin	213-6696 Pin					213-6697 Pin	214-6143 Pin	220-1018 Pin	
		Extendable				-											220-1019 Pin					220-1018 Pin			
430F2 / IT	HWE / HWG	Standard				-			130-2533 Pin (QTY 2)	213-6717 Pin						213-6728 Pin Assembly	213-6718 Pin					213-6696 Pin	213-6697 Pin	214-6143 Pin	220-1018 Pin
		Extendable				-																220-1019 Pin	220-1018 Pin		

EXCAVATOR LINKAGE F2 Series

Bearings																																																												
Sales Model	Serial Number Prefix	Stick Type Standard Stick: Areas 4,5,6,7 Extendable Stick: Areas 4,5,6,7,13 and 14	Linkage Type (Areas 7,8,9,10 and 11)	1	2	3	4	5	6	7	8	9	10	11	12	15	16	17	18																																									
415F2	HWA	Standard	Fabricated							9R-0162 Bushing (QTY 2) 213-6687 Bushing (QTY 2)																																																		
		Extendable								286-7166 Bushing (QTY 2) 213-6687 Bushing (QTY 2)																																																		
416F2	HWB	Standard								209-6181 Bushing (QTY 2) 237-0944 Bushing (QTY 2) 278-5454 Bushing (QTY 2)										214-3855 Bearing (QTY 2)	214-2255 Bushing (QTY 2)	9R-0170 Bushing (QTY 2)	9R-3092 Bushing (QTY 2)	9R-0139 Bushing (QTY 2)	9R-0162 Bushing (QTY 2) 213-6687 Bushing (QTY 2)	9R-0162 Bushing (QTY 2)	9R-0162 Bushing (QTY 4)	213-6703 Bearing (QTY 2)	9R-0170 Bushing (QTY 4)	326-3362 Bushing	220-1013 Bushing	220-1013 Bushing	213-6702 Bushing (QTY 4) 274-4274 Bushing (QTY 2)	9T-2883 Bushing (QTY 4) 363-0528 Bearing (QTY 4)																										
		Extendable								286-7166 Bushing (QTY 2) 213-6687 Bushing (QTY 2)																																																		
420F2 / IT	HWC / HWD	Standard																		212-8960 Bearing (QTY 2)	215-1906 Bushing (QTY 2)	213-6683 Bushing (QTY 2)	213-6682 Bushing (QTY 2)		9R-0162 Bushing (QTY 2) 213-6687 Bushing (QTY 2)										286-7166 Bushing (QTY 2) 213-6687 Bushing (QTY 2)	9R-0162 Bushing (QTY 2) 213-6687 Bushing (QTY 2)	9R-0162 Bushing (QTY 4)	213-6703 Bearing (QTY 2)	9R-0170 Bushing (QTY 4)	326-3362 Bushing	220-1013 Bushing	220-1013 Bushing	213-6702 Bushing (QTY 4) 274-4274 Bushing (QTY 2)	9T-2883 Bushing (QTY 4) 363-0528 Bearing (QTY 4)																
		Extendable																																											286-7166 Bushing (QTY 2) 213-6687 Bushing (QTY 2)															
430F2 / IT	HWE / HWG	Standard																																											217-1460 Bushing (QTY 2) 236-8158 Bushing (QTY 2) 278-5455 Bushing (QTY 2)	220-1013 Bearing (QTY 2) 250-1563 Bearing (QTY 2)	217-6046 Bushing (QTY 2)	213-6715 Bushing (QTY 2)	213-6719 Bushing (QTY 2)	9R-0162 Bushing (QTY 2) 213-6687 Bushing (QTY 2)	286-7166 Bushing (QTY 2) 213-6687 Bushing (QTY 2)	9R-0162 Bushing (QTY 2) 213-6687 Bushing (QTY 2)	9R-0162 Bushing (QTY 4)	213-6703 Bearing (QTY 2)	9R-0170 Bushing (QTY 4)	326-3362 Bushing	220-1013 Bushing	220-1013 Bushing	213-6702 Bushing (QTY 4) 274-4274 Bushing (QTY 2)	9T-2883 Bushing (QTY 4) 363-0528 Bearing (QTY 4)
		Extendable																																											250-1561 Bushing (QTY 2)															

EXCAVATOR LINKAGE F2 Series

Seals and Grease Fittings							
Sales Model	Serial Number Prefix	1	2	3	7	15	16
415F2	HWA	3B-8489 Grease Fitting (QTY 2)	6V-9746 Seal	6V-8398 Seal	3B-8489 Grease Fitting (QTY 2)	3B-8489 Grease Fitting	3B-8489 Grease Fitting
416F2	HWB						
420F2 / IT	HWC / HWD						
430F2 / IT	HWE						
430F2 / IT	HWG					-	-

EXCAVATOR LINKAGE F2 Series

Retention Hardware																																	
Sales Model	Serial Number Prefix	Stick Type Standard Stick: Areas 4,5,6,7 Extendable Stick: Areas 4,5,6,7,13 and 14	Linkage Type (Areas 7,8,9, 10 and 11)	1	2	4	5	6	7	8	9	10	11	12	13	15	16	17	18														
415F2	HWA	Standard	Fabricated	6V-7687 Lock Nut (QTY 2) 8T-7930 Bolt (QTY 2)	176-0626 Washer (QTY 4) 375-1442 Retaining Ring (QTY 2)	286-3086 Spacer (QTY 3) 473-0240 Plate (QTY 2) 8T-4192 Bolt 8T-4895 Washer	6V-4364 Retaining Ring (QTY 2) 9R-1510 Washer (QTY 4)	6V-8344 Retaining Ring (QTY 2) 9R-1502 Washer (QTY 6)	6V-4364 Retaining Ring (QTY 2) 9R-1502 Washer (QTY 4) 220-7108 Washer (QTY 2)	9R-1510 Washer (QTY 5) 3B-5319 Cotter Pin (QTY 2) 220-7108 Washer (QTY 2)	6V-4364 Retaining Ring (QTY 2) 9R-1510 Washer (QTY 6)	9R-0158 Washer (QTY 7) 3B-5319 Cotter Pin (QTY 2) 111-4337 Washer (QTY 4)	6V-8344 Retaining Ring (QTY 2)	8T-4139 Bolt 8T-4821 Washer 9R-7882 Spacer	-	6V-7687 Lock Nut 8T-7930 Bolt 280-7732 Washer (QTY 2)	136-1122 Spacer 8T-4139 Bolt 8T-4821 Washer	6V-4364 Retaining Ring (QTY 4) 7X-0542 Washer (QTY 4) 465-3495 Guard (QTY 2)	9R-0481 Washer (QTY 2)														
		Extendable						6V-8344 Retaining Ring (QTY 2) 9R-5238 Spacer (QTY 6)	6V-4364 Retaining Ring (QTY 2) 9R-1502 Washer (QTY 3) 220-7108 Washer (QTY 2)						1L-3768 Retaining Ring (QTY 2) 111-9251 Washer (QTY 2) 233-5169 Pad (QTY 4) 233-5166 Shim (QTY 16) 233-5167 Shim (QTY 4) 293-9882 Shim (QTY 8) 293-9884 Shim (QTY 8)																		
416F2	HWB	Standard						9R-0481 Washer (QTY 4) 95-7950 Retaining Ring (QTY 2)	9R-8292 Spacer (QTY 3) 473-0240 Plate (QTY 2) 8T-4192 Bolt 8T-4895 Washer						375-1442 Retaining Ring (QTY 2) 215-9690 Washer (QTY 4)					6V-8344 Retaining Ring (QTY 2) 9R-1502 Washer (QTY 2)	6V-4364 Retaining Ring (QTY 2) 9R-1502 Washer (QTY 4) 220-7108 Washer (QTY 2)	6V-8344 Retaining Ring (QTY 2) 9R-1502 Washer (QTY 6)	6V-4364 Retaining Ring (QTY 2) 9R-1502 Washer (QTY 3) 220-7108 Washer (QTY 2)	6V-8344 Retaining Ring (QTY 2) 9R-1502 Washer (QTY 4) 220-7108 Washer (QTY 2)	6V-8344 Retaining Ring (QTY 2) 9R-1510 Washer (QTY 6)	9R-0158 Washer (QTY 7) 3B-5319 Cotter Pin (QTY 2) 111-4337 Washer (QTY 4)	6V-8344 Retaining Ring (QTY 2)	8T-4139 Bolt 8T-4821 Washer 9R-7882 Spacer	-	6V-7687 Lock Nut 8T-7930 Bolt 280-7732 Washer (QTY 2)	136-1122 Spacer 8T-4139 Bolt 8T-4821 Washer	6V-4364 Retaining Ring (QTY 4) 7X-0542 Washer (QTY 4) 465-3495 Guard (QTY 2)	9R-0481 Washer (QTY 2)
		Extendable																											6V-8344 Retaining Ring (QTY 2) 9R-5238 Spacer (QTY 6)				
420F2 / IT	HWC / HWD	Standard						9R-0481 Washer (QTY 4) 95-7950 Retaining Ring (QTY 2)	9R-8292 Spacer (QTY 3) 473-0240 Plate (QTY 2) 8T-4192 Bolt 8T-4895 Washer						375-1442 Retaining Ring (QTY 2) 215-9690 Washer (QTY 4)					6V-8344 Retaining Ring (QTY 2) 9R-1502 Washer (QTY 2)	6V-4364 Retaining Ring (QTY 2) 9R-1502 Washer (QTY 4) 220-7108 Washer (QTY 2)	6V-8344 Retaining Ring (QTY 2) 9R-1502 Washer (QTY 6)	6V-4364 Retaining Ring (QTY 2) 9R-1502 Washer (QTY 3) 220-7108 Washer (QTY 2)	6V-8344 Retaining Ring (QTY 2) 9R-1502 Washer (QTY 4) 220-7108 Washer (QTY 2)	6V-8344 Retaining Ring (QTY 2) 9R-1510 Washer (QTY 6)	9R-0158 Washer (QTY 7) 3B-5319 Cotter Pin (QTY 2) 111-4337 Washer (QTY 4)	6V-8344 Retaining Ring (QTY 2)	8T-4139 Bolt 8T-4821 Washer 9R-7882 Spacer	-	6V-7687 Lock Nut 8T-7930 Bolt 280-7732 Washer (QTY 2)	136-1122 Spacer 8T-4139 Bolt 8T-4821 Washer	6V-4364 Retaining Ring (QTY 4) 7X-0542 Washer (QTY 4) 465-3495 Guard (QTY 2)	9R-0481 Washer (QTY 2)
		Extendable																											6V-8344 Retaining Ring (QTY 2) 9R-5238 Spacer (QTY 6)				
430F2 / IT	HWE / HWG	Standard						9R-0481 Washer (QTY 4) 95-7950 Retaining Ring (QTY 2)	9R-8292 Spacer (QTY 3) 473-0240 Plate (QTY 2) 8T-4192 Bolt 8T-4895 Washer						375-1442 Retaining Ring (QTY 2) 215-9690 Washer (QTY 4)					6V-8344 Retaining Ring (QTY 2) 9R-1502 Washer (QTY 2)	6V-4364 Retaining Ring (QTY 2) 9R-1502 Washer (QTY 4) 220-7108 Washer (QTY 2)	6V-8344 Retaining Ring (QTY 2) 9R-1502 Washer (QTY 6)	6V-4364 Retaining Ring (QTY 2) 9R-1502 Washer (QTY 3) 220-7108 Washer (QTY 2)	6V-8344 Retaining Ring (QTY 2) 9R-1502 Washer (QTY 4) 220-7108 Washer (QTY 2)	6V-8344 Retaining Ring (QTY 2) 9R-1510 Washer (QTY 6)	9R-0158 Washer (QTY 7) 3B-5319 Cotter Pin (QTY 2) 111-4337 Washer (QTY 4)	6V-8344 Retaining Ring (QTY 2)	8T-4139 Bolt 8T-4821 Washer 9R-7882 Spacer	-	6V-7687 Lock Nut 8T-7930 Bolt 280-7732 Washer (QTY 2)	136-1122 Spacer 8T-4139 Bolt 8T-4821 Washer	6V-4364 Retaining Ring (QTY 4) 7X-0542 Washer (QTY 4) 465-3495 Guard (QTY 2)	9R-0481 Washer (QTY 2)
		Extendable																											6V-8344 Retaining Ring (QTY 2) 9R-5238 Spacer (QTY 6)				

LET'S DO THE WORK.™

AEXQ1594-05
September 2022
North America

© 2022 Caterpillar. All Rights Reserved. CAT, CATERPILLAR, LET'S DO THE WORK, their respective logos, "Caterpillar Corporate Yellow," the "Power Edge" and Cat "Modern Hex" trade dress, as well as corporate and product identity used herein, are trademarks of Caterpillar and may not be used without permission.

