

Perkins M300C & M250C Marine Diesel Engine
 Shown with ZF80A gearbox with reduction ratios up to
 and including 2.5:1 ratios (622 mm transverse mounting centres)

WIMBORNE MARINE POWER CENTRE
 Wimborne, Dorset, England.
 Tel. +44(0)1202 893720
 Fax. +44(0)1202 851700
 E-mail. Wimborne_MPC_post@cat.com
www.Perkins-Sabre.com

Total Dry Weight: 768kg

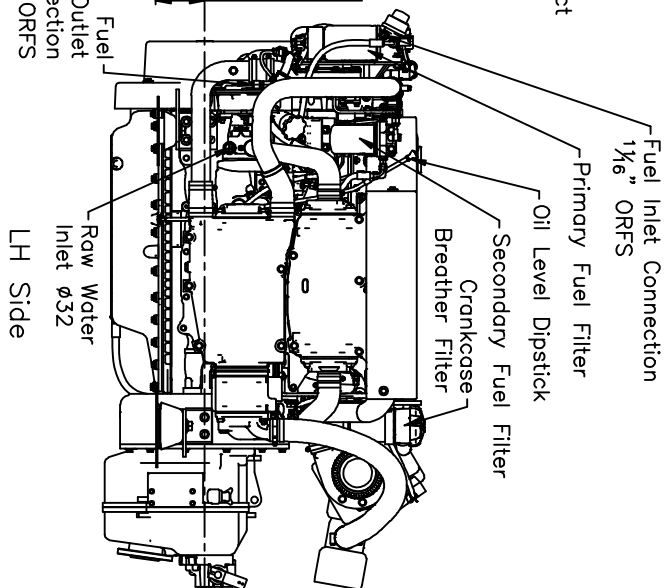
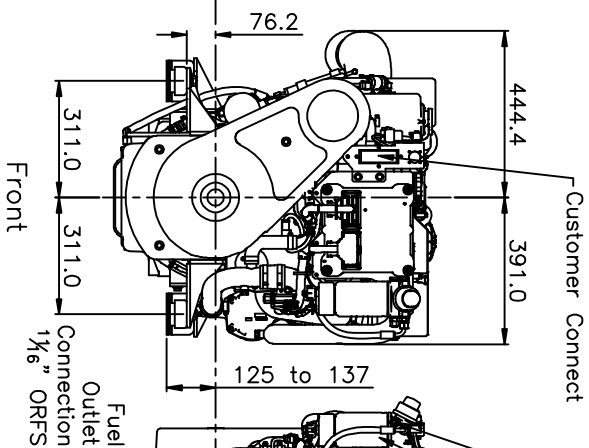
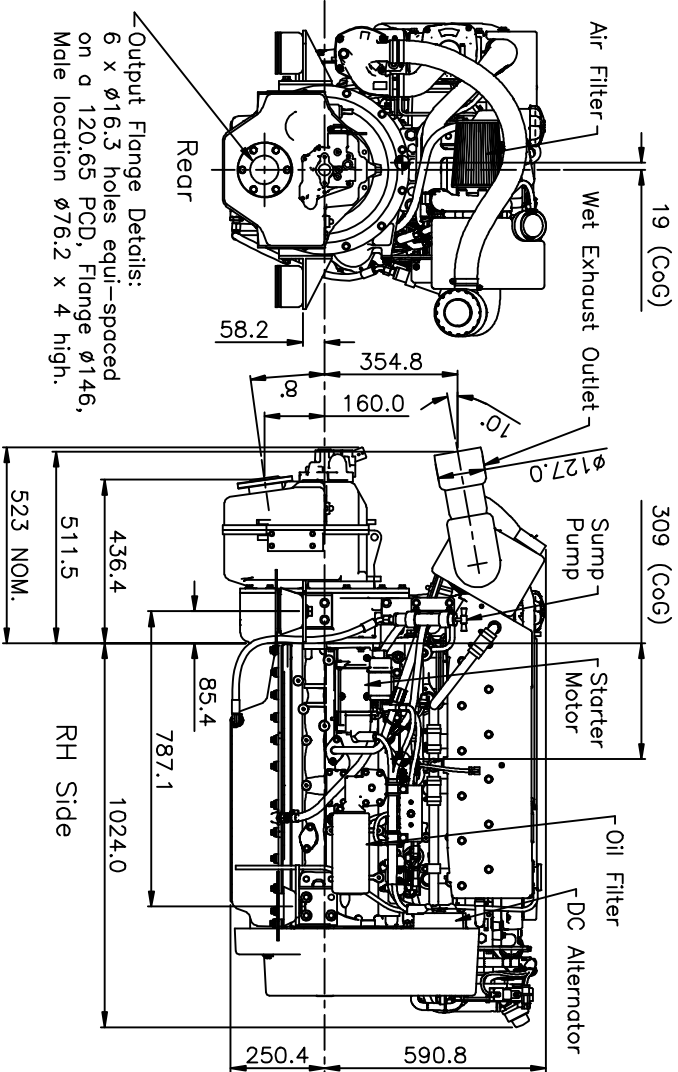
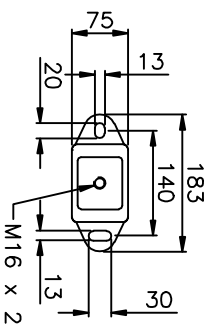
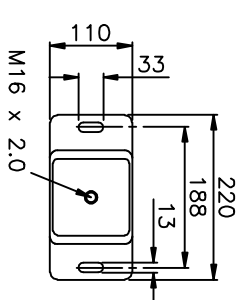
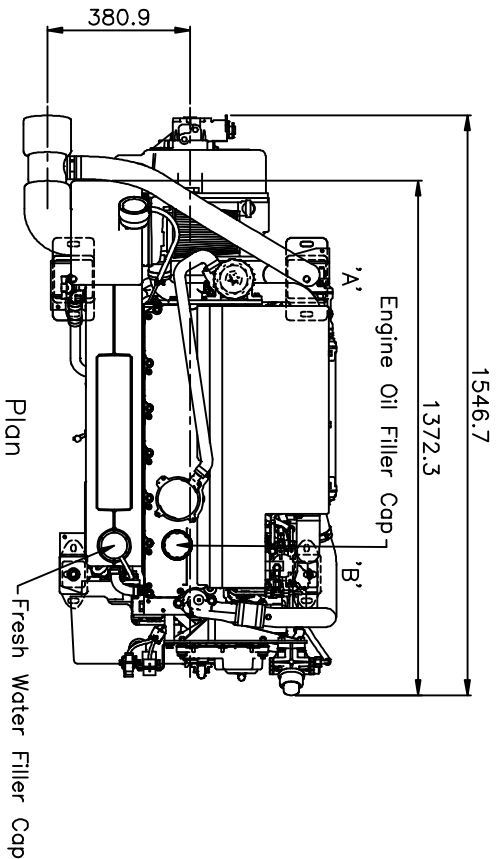

Output Flange Details:
 6 x ø16.3 holes equi-spaced
 on a 120.65 PCD, Flange ø146,
 Male location ø76.2 x 4 high.