

Perkins M300C & M250C Marine Diesel Engine
 Shown with ZF280-1A gearbox with reduction ratios up to
 and including 2.476:1 ratios (622 mm transverse mounting centres)

WIMBORNE MARINE POWER CENTRE
 Wimborne, Dorset, England.
 Tel. +44(0)1202 893720
 Fax. +44(0)1202 851700
 E-mail. Wimborne_MPC_post@cat.com
 www.Perkins-Sabre.com

Total Dry Weight: 777kg

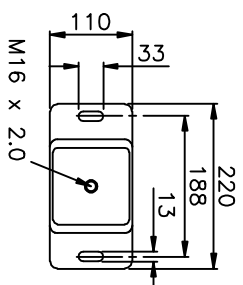
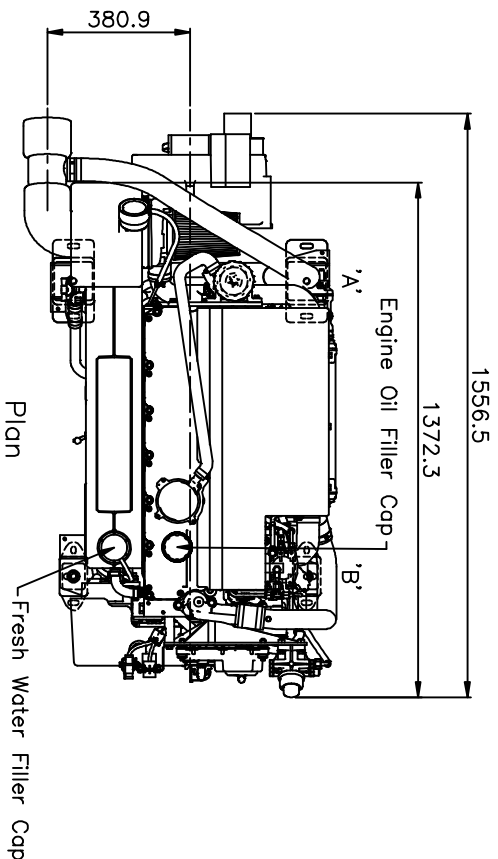

FLEXIBLE ENGINE MOUNT 'A'

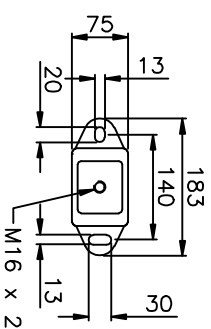

FLEXIBLE ENGINE MOUNT 'B'

