

Perkins Sabre M185, M215C & M225Ti Marine Diesel Engine
 shown with the PRM 1000D gearbox (Ratios above 2:1)
 (622mm transverse mounting centres)

CATERPILLAR MARINE POWER UK LTD
 Wimborne, Dorset, England.
 Tel. +44(0)1202 893720
 Fax. +44(0)1202 851700
 E-mail. Wimborne_MPC_post@cat.com
 www.Perkins-Sabre.com

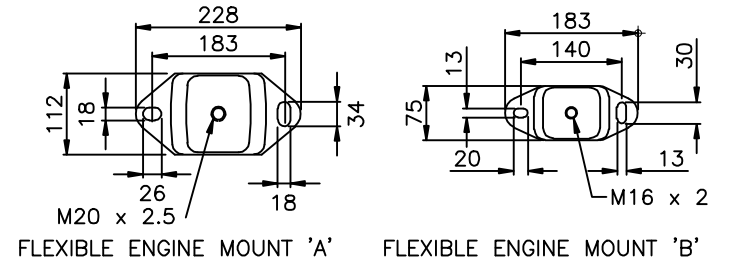

FLEXIBLE ENGINE MOUNT
 Weights on each mount
 Front 166.2kg
 Rear 202.1kg
 Total Wet Weight 736.6kg

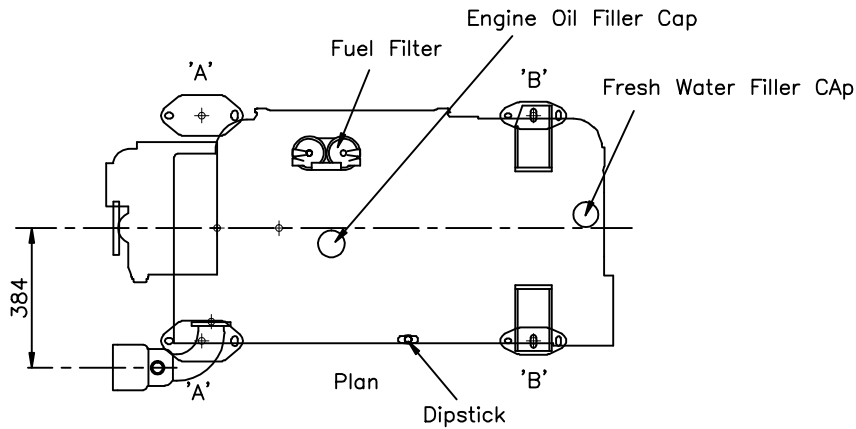
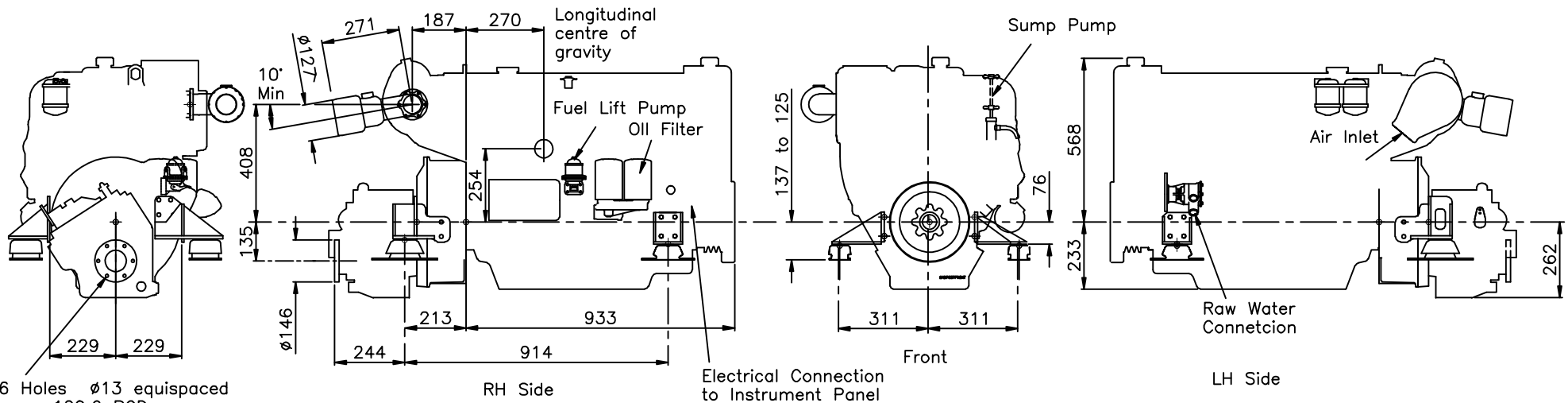

6 Holes $\phi 13$ equispaced
 on a 120.6 PCD
 Female location $\phi 76.23/\phi 76.26$

Rear

Doc 7029-8-08