

# Cat® Three60 Pod 650



**Cat® Three60 Pod 650** is designed for the Cat C8.7 electronically controlled marine propulsion engine, providing unmatched response and performance.

The joystick and the lever head provide smooth operation and high confidence when maneuvering, using two modes:

#### The Lever Mode

- Controls the Pod propeller drive trains using the lever head
- Pod vectoring is controlled by the digital steering helm

#### The Joystick Mode

- Controls engine speed, gear, and Pod angle using intuitive fingertip movements of the joystick for slow vessel maneuvering

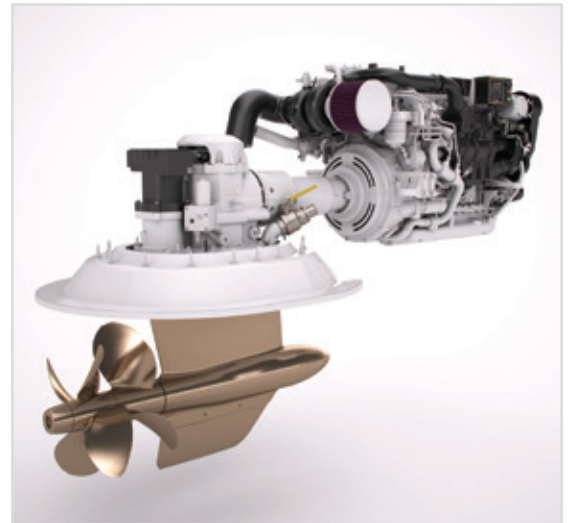

## CUSTOMER BENEFITS

- Remarkably easy to learn
- “Push, twist, and go” directional maneuvering
- Superior slow-speed vessel control
- Access to full or incremental power in any direction
- Smooth shifting from forward to reverse
- Easy “plug and play” installation

## FEATURES

- Revolutionizes docking and slow-speed maneuvering for diesel-powered vessels
- Simultaneously actuates and controls engines, transmissions, and Pod thrust vector with intuitive, easy fingertip movements
- Instantaneously controls all aspects of vessel direction and speed
- Optional Three60 Hold station keeping

## SYSTEM COMPONENTS

### Electrical System

- Master controller (one per system)
- Powertrain controller (one per Pod)
- Digital lever control head and button panel (min. 1 – max. 3)
  - Standard top mount dual lever style
  - Optional Palm Beach style
- Integrated digital steering helm (min. 1 – max. 3)
  - Three different steering wheel finishes
- Digital joystick (min. 1 – max. 6)
  - Standard forward facing
  - Optional aft facing
- Integrated color touchscreen display (min. 1 – max. 6)

### Optional:

- Interface to popular autopilot systems
- GPS antenna for Three60 Hold station keeping function

### Mechanical System

- Cat Three60 Pod 650:
  - 12 or 24 Volt system configurations
  - 2.25:1 gear ratio
  - Contra-rotating propellers
  - Breakaway lower unit
  - Replaceable nose cone and skeg
  - Optional PTO
- Multiple jackshaft lengths for flexible engine space installation
- Engine water intake and shutoff
- Equipped with quick-connect lube ports for easy oil service



# Cat® Three60 Pod 650

## DIMENSIONS

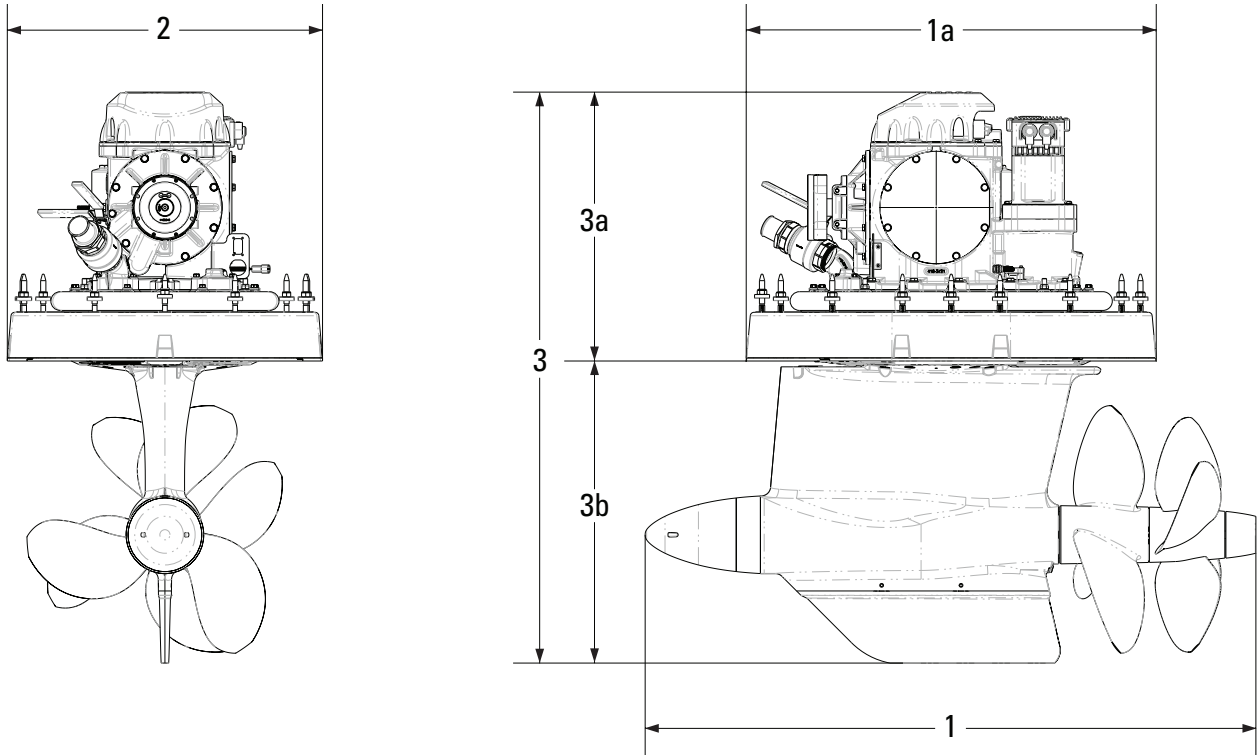

<b>1</b>	Length lower unit	1630 mm (64.2 in)
<b>1a</b>	Length hull seal area	1094 mm (43.1 in)
<b>2</b>	Width of hull seal area	841 mm (33.1 in)
<b>3</b>	Height overall	1524 mm (60 in)
<b>3a</b>	Height above hull seal	718 mm (28.3 in)
<b>3b</b>	Height below hull seal	806 mm (31.7 in)
Weight Pod w/o propellers (approx)		695 kg (1532 lb)
Weight Pod w/propellers, coupling, driveshaft, and covers (approx)		837 kg (1845 lb)
Weight C8.7 and Three60 Pod 650, dry (approx)		1867 kg (4116 lb)
Installation angle (dead rise angle)		up to 19°

## PERFORMANCE DATA

